

SYMBOL	DESCRIPTION	PRIME FARMLAND	HIGHLY ERODIBLE	HYDRIC	HSG
57B	CHILLUM SILT LOAM 3-8% SLOPES	YES	NO	NO	B
57C	CHILLUM SILT LOAM 8-15% SLOPES	YES	NO	NO	B
57D	CHILLUM SILT LOAM 15-25% SLOPES	NO	YES	NO	B
59B	BELTSVILLE SILT LOAM 3-8% SLOPES	YES	NO	NO	C

BORING NO.	DEPTH OF PIPE BELOW GRADE (FT)	APPROXIMATE ELEVATION OF BOTTOM OF PIPE	AVERAGE INFILTRATION RATE (IN/HR)	USDA TEXTURE CLASS
ST-1	8.2	446.63	0.3	CLAY LOAM
ST-2	10.5	450.98	15.2	LOAMY SAND
ST-3	10.0	450.42	13.3	SANDY LOAM
ST-4	13.5	449.89	11.4	SANDY LOAM
ST-5	9.3	441.34	23.5	SANDY SANDY CLAY LOAM
ST-6	4.3	439.11	0.03*	SANDY SANDY CLAY LOAM
ST-7	9.5	435.77	12.1	SANDY LOAM
ST-8	10.3	443.43	20.4	SANDY LOAM

* IT SHOULD BE NOTED THAT SURFACE RUNOFF MAY HAVE AFFECTED THE INFILTRATION RATE AT TEST BORING NO. ST-6.

STORMWATER MANAGEMENT NOTE

THE GEOTECH PROVIDED EIGHT (8) SOIL BORINGS THROUGHOUT THE PROPERTY AT LOCATIONS WHERE THE STORMWATER FACILITIES ARE BEING PROPOSED. SOIL BORING ST-1 AND ST-6 WERE NOT SUITABLE TO PROVIDE STORMWATER INFILTRATION PRACTICES IN THOSE AREAS. THIRTEEN MICRO-BIORETENTION FACILITIES ARE PROPOSED TO PROVIDE STORMWATER MANAGEMENT TO THE MAXIMUM EXTENT POSSIBLE.

THE OUTFALL FROM THE STORM DRAIN SYSTEM WILL NOT DRAIN TO THE EXISTING MCDEP ASSET #23148 SHALLOW MARSH WETLAND POND. THE MICRO-BIORETENTION PRACTICES WILL OUTFALL TO A STORM DRAIN SYSTEM THAT DRAINS TO AN EXISTING UNNAMED TRIBUTARY AT THE REAR OF THE PROPERTY, WHICH DRAINS TO LITTLE PAINT BRANCH, AND EVENTUALLY TO THE ANACOSTIA RIVER. THE UNNAMED TRIBUTARY BY PASSES MCDEP ASSET #23148 SHALLOW MARSH WETLAND POND.

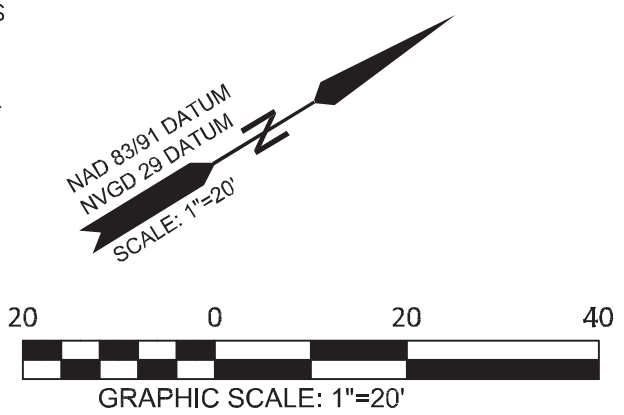

LEGEND

- STREET R/W LINES
- EASEMENT LINES WATER AND SEWER
- PROPERTY LINES (OTHER THAN STREETS, LOTS)
- INTERNAL LOT LINES
- PROP. SOIL BORING
- EX. CONTOURS
- PROP. CONTOURS
- LIMIT OF DISTURBANCE
- EX. SIDEWALK LINES
- PROP. SIDEWALK LINES
- EX. ROAD EDGE OF PAVEMENT
- EX. CURB
- PROP. CURB
- EX. FENCE LINE
- PROP. FENCE LINE
- EX. WALLS (STONE, BRICK OR CONC.)
- EX. TREES (LABEL SIZE AND TYPE)
- TREE LINE
- GAS MAINS
- UNDERGROUND ELECTRIC CABLE OR CONDUIT
- EX. STORM DRAINS
- PROP. STORM DRAINS
- EX. STORM INLETS (ACTUAL SIZE)
- EX. STORM MANHOLES (SD)
- EX. SEWER MAINS
- PROP. SANITARY SEWER
- EX. SEWER MANHOLES (SMH)
- EX. SEWER CLEAN OUTS (CO)
- EX. WATER MAINS
- PROP. WATER MAINS
- EX. WATER VALVES (V)
- EX. WATER FIRE HYDRANTS (FH)
- PROP. SPOT ELEVATIONS
- EX. ASPHALT ROADWAY / DRIVEWAY HATCH
- EX. CONCRETE PAVEMENT HATCH
- SLOPES 15% TO 25%
- SLOPES 25% OR GREATER
- DRAINAGE DIVIDE
- DOWNSPOUT TO SPLASH BLOCK

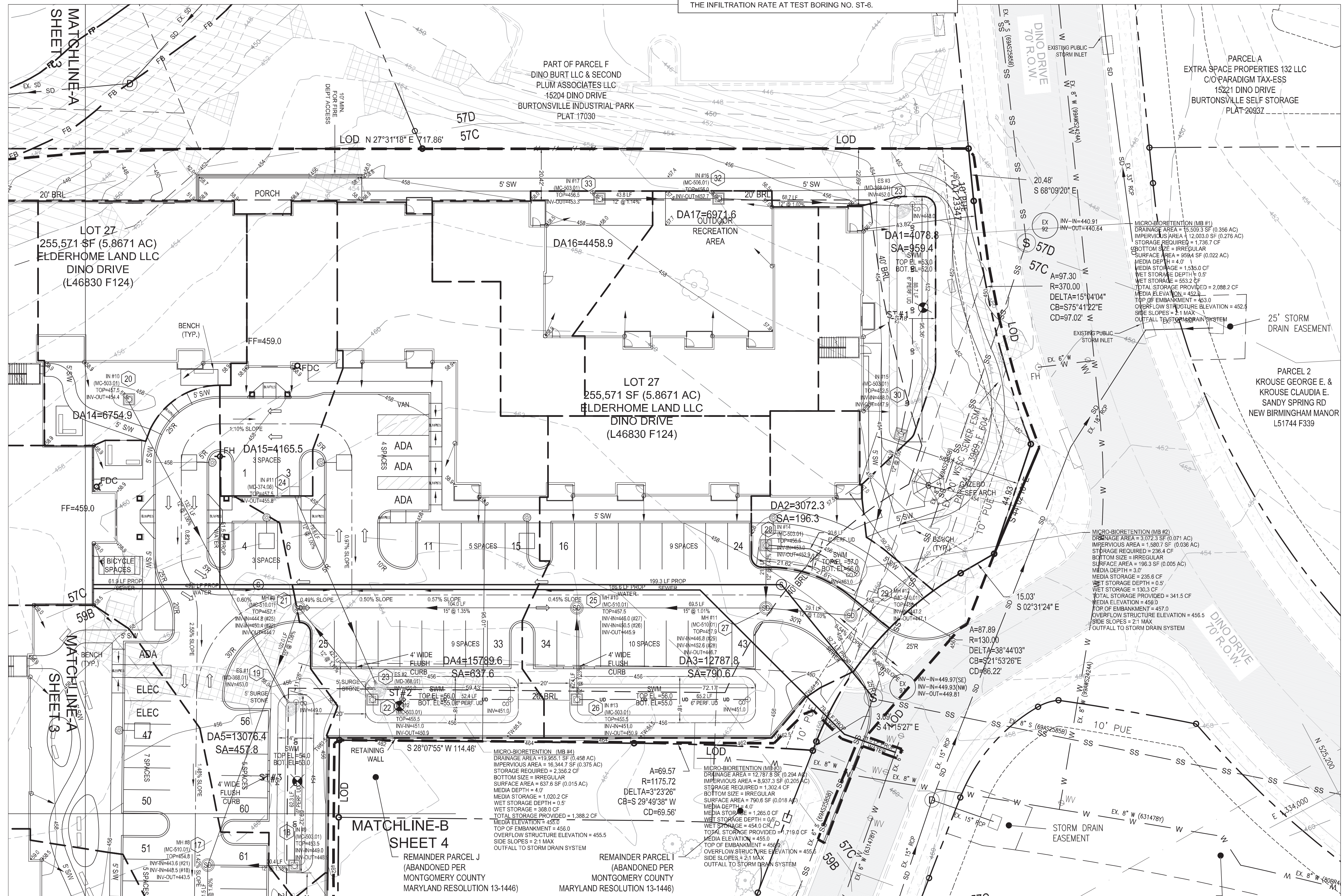

PACKARD & ASSOCIATES LLC.
 CIVIL ENGINEERS * SURVEYORS * LAND PLANNERS
 16220 FREDERICK ROAD, SUITE 300
 GAITHERSBURG, MARYLAND 20877
 PHONE (301) 208-0250 FAX (301) 208-1270



05/19/23

STORMWATER MANAGEMENT CONCEPT PLAN - SHEET 2
CONDITIONAL USE
BROOKSTONE SENIOR LIVING
 LOT 27, BLOCK B, VALLEY STREAM ESTATES
 RECORDED IN LIBER 46830 AT FOLIO 124
 BURTONSVILLE ELECTION DISTRICT No. 5 MONTGOMERY COUNTY, MARYLAND

OWNER ELDERHOME LAND, LLC P.O. BOX 310 ASHTON, MD 20861	SCALE 1"=20'	DRWN PW
CHECKED DP	DATE 05/19/23	ACAD FILE NAME
JOB NO.		DRAWING NO. SHEET 11 OF 20

Exhibit 29 (b)
 OZAH Case No: CU 23012

PROFESSIONAL CERTIFICATION

I HEREBY CERTIFY THAT THESE DOCUMENTS WERE PREPARED OR APPROVED BY ME, AND THAT I AM DULY LICENSED PROFESSIONAL ENGINEER UNDER THE LAWS OF THE STATE OF MARYLAND, LICENSE No. 16518, EXPIRATION DATE: 06/10/2023.

Sean Packard
 DEAN PACKARD, P.E.

05/19/23
 DATE

MISS UTILITY
 CALL "MISS UTILITY" AT 1-800-257-777, 48 HOURS PRIOR TO THE START OF WORK. THE EXCAVATOR MUST NOTIFY ALL PUBLIC UTILITY COMPANIES WITH UNDER GROUND FACILITIES IN THE AREA OF PROPOSED EXCAVATION AND HAVE THOSE FACILITIES LOCATED BY THE UTILITY COMPANIES PRIOR TO COMMENCING EXCAVATION. THE EXCAVATOR IS RESPONSIBLE FOR COMPLIANCE WITH THE REQUIREMENTS OF CHAPTER 36A OF THE MONTGOMERY COUNTY CODE.