



Isiah Leggett  
Montgomery County Executive

Arthur Holmes, Jr., Director  
Department of Transportation

Division of  
Transportation Engineering  
100 Edison Park Drive  
4th Floor  
Gaithersburg, MD 20878  
Phone: 240-777-7223  
Fax: 240-777-7271

Bruce Johnston, P.E.  
Division Chief

Holger Serrano, P.E.  
Engineering Services  
Specialist

Sogand Sairafi, P.E.  
Planning & Design Chief

Tom Reise  
Property Acquisition Chief

Girum Awoke, Ph.D., P.E.  
Construction Chief

## Feasibility Study FOREST GLEN PASSAGEWAY

April 10, 2012

### <<<< PUBLIC MEETING >>>>



Tuesday, April 10, 2012  
7:00PM - 9:00PM

Sligo Middle School  
1401 Dennis Avenue  
Silver Spring, MD 20902

1



## Feasibility Study FOREST GLEN PASSAGEWAY

April 10, 2012

### <<<< PURPOSE OF PUBLIC MEETING >>>>

- Introduce project team
- Outline project purpose and need
- Share background data
- Present alternatives and draft concepts
- Explain project procedure and schedule
- Listen to community's concerns and gather feedback

2



## FOREST GLEN PASSAGEWAY

### <<<< PURPOSE OF PROJECT >>>>

- To provide a grade separated pedestrian passageway across Georgia Avenue at Forest Glen Road for improved safety
- To provide direct access to Forest Glen Metro Station and improved ADA accessibility to the mezzanine of the Metro Station



## FOREST GLEN PASSAGEWAY

### <<<< NEED FOR PROJECT >>>>

- There is a need for improved pedestrian safety at the intersection and improved access to the Metro Station
  - Highly congested intersection
  - Frequent conflicts between pedestrians and vehicles
  - 90% of pedestrians crossing Georgia Ave are to/from the Metro Station
  - No existing direct ADA access to the mezzanine of the Metro Station



# Feasibility Study FOREST GLEN PASSAGEWAY

April 10, 2012

## <<<< EXISTING SITE CONDITIONS >>>>



5



# Feasibility Study FOREST GLEN PASSAGEWAY

April 10, 2012

## <<<< EXISTING VEHICULAR TRAFFIC CONDITION >>>>

- Highly congested intersection 80,000 vehicles/day
- Long signal cycle – 150 seconds
- Potential pedestrian delay ≈ 140 seconds
- Long delay encourages jaywalking



6





# Feasibility Study FOREST GLEN PASSAGEWAY

April 10, 2012

<<<< ALIGNMENT OPTIONS >>>>

- Counts performed Tuesday, April 26, 2011
- Significant crossings of all 4 legs of the intersection
- > 800 crossings of Georgia Avenue
  - 90% of pedestrian activity is to/from Metro

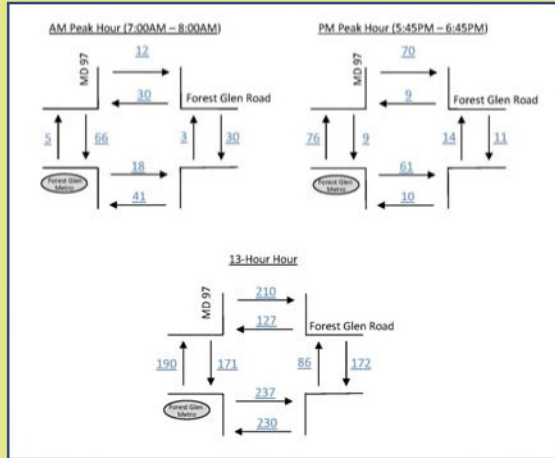

# Feasibility Study FOREST GLEN PASSAGEWAY

April 10, 2012

<<<< ALIGNMENT OPTIONS >>>>





# Feasibility Study FOREST GLEN PASSAGEWAY

April 10, 2012

<<<RETURN TO TABLE OF CONTENTS>>>

- 90% of pedestrian traffic is related to Metro
- Preferred Alternatives should provide direct access to Metro



# Feasibility Study FOREST GLEN PASSAGEWAY

April 10, 2012

<<<RETURN TO CONTENTS>>>

## SOUTHEAST QUADRANT TO METRO STATION

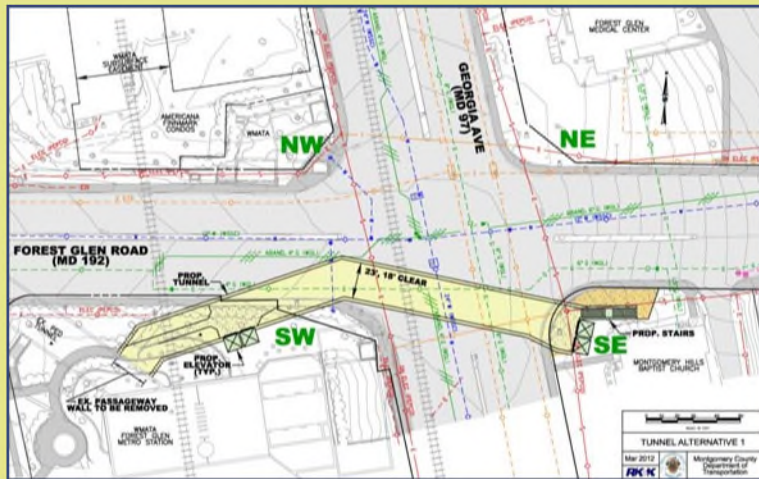







# Feasibility Study FOREST GLEN PASSAGEWAY

April 10, 2012

◀◀<PREVIOUS>>▶▶

## SOUTHEAST QUADRANT TO METRO STATION

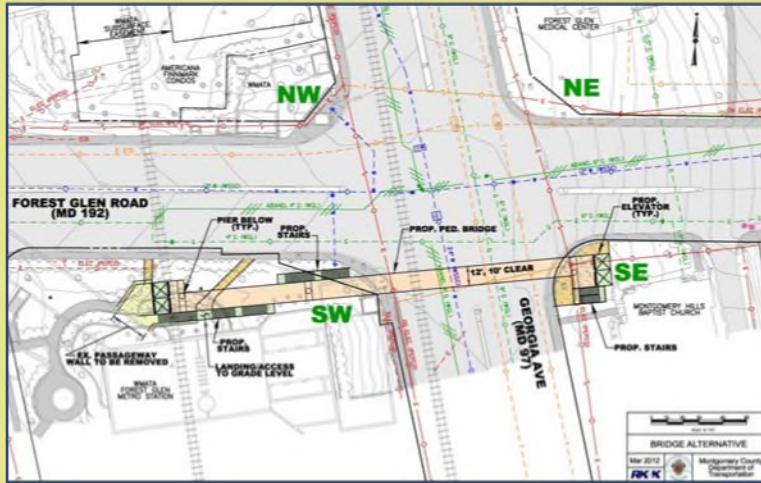

13



# Feasibility Study FOREST GLEN PASSAGEWAY

April 10, 2012

◀◀<PREVIOUS>>▶▶

## SOUTHEAST QUADRANT TO METRO STATION

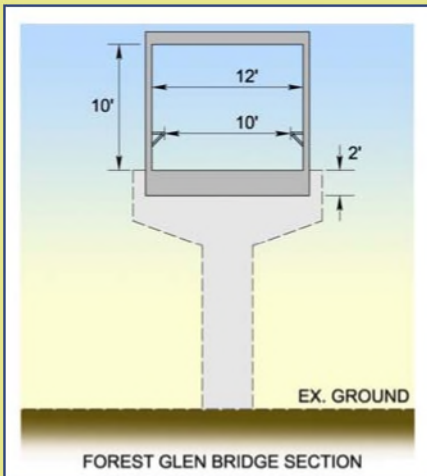

14

# Feasibility Study FOREST GLEN PASSAGEWAY

## <<<< ALTERNATIVE COMPARISON >>>>

|   | Tunnel Alternative 1<br>(SE Quadrant to Metro)  | Tunnel Alternative 2<br>(NE Quadrant to Metro)  | Bridge Alternative 1<br>(SE Quadrant to Metro)  |
|---|---|---|---|
| Length (Ft)   | •303  | •324  | •270  |
| Width (Ft)  | •23 (18 Ft Clear)   | •23 (18 Ft Clear)   | •12 (10 Ft Clear)   |
| Estimated Pedestrian Usage<br>(Crossing MD 97/ Day) | •759  | •461  | •683  |
| Average Travel Time<br>Savings (Sec/Pedestrian)     | •119  | •103  | •57   |
| Construction Duration                               | •39 months  | •39 months  | •15 months  |
| Maintenance of Traffic                              | •Partial Night Time Work (18 months)<br>•Overnight Lane Closures to 2-3 Lanes on Georgia Ave and Forest Glen Rd | •Partial Night Time Work (18 months)<br>•Overnight Lane Closures to 2-3 Lanes on Georgia Ave and Forest Glen Rd | •Partial Night Time Work (3 months)<br>•Overnight Lane Closures to 2-3 Lanes on Georgia Ave.<br>•Single overnight complete closure of Georgia Ave |
| Properties Impacted                                 | •1 Property, 2200 Square Feet   | •1 Property, 4100 Square Feet   | •1 Property, 1500 Square Feet   |
| Utility Impacts                                     | •High - Underground, overhead, and traffic signal   | •High - Underground, overhead, and traffic signal   | •Moderate - Overhead and traffic signal   |
| Construction Cost                                   | •\$11.5M  | •\$12.1M  | •\$5.8M   |

**Recommendation:**  
(Note: A recommendation for a preferred alternative will be made after consultation with the project team, solicitation of public comment, and review by county officials.)

# Feasibility Study FOREST GLEN PASSAGEWAY



## <<<< PROJECT PROCEDURE & SCHEDULE >>>>

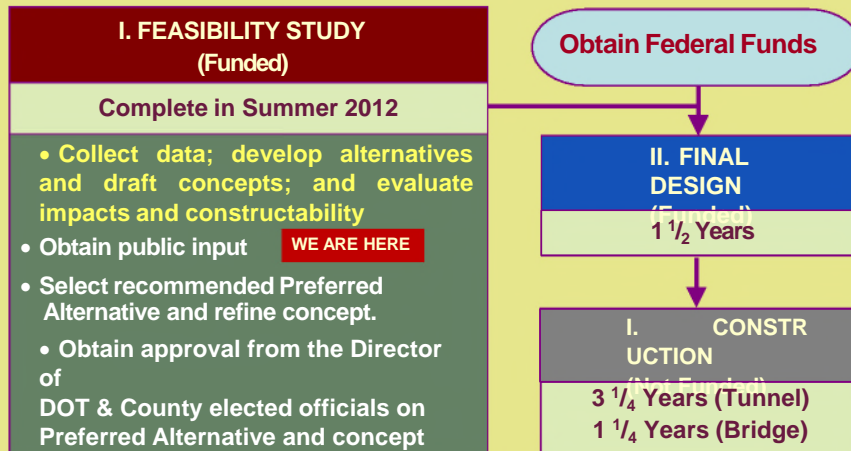





## Feasibility Study FOREST GLEN PASSAGEWAY

April 10, 2012

<<<<RETURN>>>>

- Public Meeting on April 10, 2012
- Comment Period thru April 24, 2012
  - By postage paid comment card
  - By mail or e-mail to Project Manager

Project Manager: Greg Hwang  
Mailing Address: Department of Transportation Division of  
Transportation Engineering 100  
Edison Park Drive, 4th Floor  
Gaithersburg, Maryland 20878  
E-mail: [Greg.Hwang@montgomerycountymd.gov](mailto:Greg.Hwang@montgomerycountymd.gov)  
Phone: 240-777-7279 Fax: 240-777-7277

Division of Transportation Engineering Home Page:  
<http://www.montgomerycountymd.gov/dot-dte/index.html>