

**Prepared By: Montgomery County DEP/DSWS**

**Date Prepared: 8/16/18**

## **GUDE LANDFILL REMEDIATION**

### **GLCC/DEP MEETING NO. 49**

DATE: Thursday, June 14, 2018  
TIME: 7:00 PM to 8:30 PM  
LOCATION: Montgomery County Transfer Station

#### **ATTENDANCE:**

<u>Name</u>	<u>Organization</u>	<u>Designation</u>
Laszlo Harsanyi	Gude Landfill Concerned Citizens (GLCC)	Member
Keith Ligon	Gude Landfill Concerned Citizens (GLCC)	Member
Dave Peterson	Gude Landfill Concerned Citizens (GLCC)	Member
Nick Radonic	Gude Landfill Concerned Citizens (GLCC)	Member
George Wolohojian	Gude Landfill Concerned Citizens (GLCC)	Member
Dom Perez	Capital Area Soaring Association	CASA Member
Don Birnesser	Montgomery County Dept. of Env. Protection (DEP)	Section Chief
Stephen Lezinski	Barton & Loguidice, D.P.C. (B&L)	DEP Consultant

The Meeting Agenda is included as Attachment 1.

Contact information for attendees is included as Attachment 2.

Historical documentation for the Capital Area Soaring Association is included as Attachment 3.

The updated Gude Landfill Aerial Map is included as Attachment 4.

The Gude Landfill Gas Monitoring Well Location Map is included as Attachment 5.

#### **1. WELCOME AND OPENING REMARKS**

- a. Don Birnesser opened the meeting by welcoming and thanking the participants for attending.
- b. Mr. Birnesser turned the meeting over to Stephen Lezinski to address the agenda items.
- c. Mr. Lezinski indicated that the minutes from GLCC/DEP Meeting No. 48 were accepted by GLCC on 5/20/18.

#### **2. PURPLE LINE / GUDE LANDFILL SOIL STOCKPILE PROJECT**

- a. Mr. Lezinski gave an update on the Purple Line Soil Stockpile Project. The Purple Line Contractor is awaiting acceptable excavation locations. The County required additional permitting for the soil stockpile, which caused the Purple Line Contractor to miss the timeframe for one of their current excavation areas. The Contractor is waiting for additional excavation areas to open up before hauling can be initiated. The timeframe for starting to haul soil to the Landfill is now the end of June to early July 2018.
- b. Laszlo Harsanyi asked if the Purple Line project is behind schedule. Mr. Lezinski responded that we do not know if the overall Purple Line project is behind schedule. The Purple Line has multiple areas under construction and other sequences of operations can impact their schedule.

- c. Mr. Harsanyi asked if there are other requirements such as a certain amount of soil to be received before site activities of the remediation project can begin. Mr. Lezinski responded that the capping project schedule is three (3) years away and the project requires a significant amount of clean soil fill. The County can accept soil during the pre-construction period to lessen the need for soil material at the time of construction.
- d. Mr. Harsanyi asked if there are any issues related to the soil drying out or washing away. Mr. Lezinski stated that the Purple Line Contractor is required to maintain the access roads and stabilize the soil material in the stockpile to prevent erosion and sediment transport. This also applies during the future capping project.
- e. Mr. Lezinski noted that an extra sign has been placed along the right-of-way at the Landfill that says, “*Active Construction Access Prohibited.*” There are now 3-4 signs along the perimeter fence line of the site warning unauthorized persons not to enter.

### **3. UPDATE ON GUDE LANDFILL REMEDIATION – DESIGN ENGINEER PROJECT**

- a. The Aerial Survey field work was completed on 4/16/18. Mr. Lezinski reviewed the meeting handout, the Aerial Survey.
- b. Keith Ligon asked if any of the future access points to the landfill site for the community had been identified. Mr. Lezinski indicated that land reuse aspects of the overall project have not been determined yet; however, this will be evaluated under Task 7 of EA Engineering’s services.
- c. George Wolohojian asked two (2) questions: 1) If the aerial survey (4/16/18) was completed by drone, and 2) in mapping out the landscape of the site, how do you do the grading. Mr. Lezinski stated that the survey was not completed by drone; it was performed via plane (aerial flyover). Mr. Lezinski stated that the aerial flyover maps the existing ground surface of the landfill. This data is then imported into a CAD software program to create the drawings with the surfaces of the landfill and the layers of the capping system. The final capping system needs to maintain 4% minimum slope. The discussion continued regarding settlement, the final shape of the landfill surface after capping (the current layout and contours will generally be maintained), stormwater runoff and control, the amount of site capping (110 acres), and land reuse.
- d. Wetlands, Natural Resources Inventory, and Forest Stand field investigations were completed on 4/30/18 – 5/1/18. EA Engineering is in the process of preparing the field investigation reports and the County will be reviewing those reports over the next couple of weeks.
  - Ø Mr. Harsanyi asked if there are wetlands located within the areas of the future capping system. Mr. Lezinski stated that there are no wetlands on top of the landfill or within the capping area. Wetlands are often located along the streams.
- e. Utility Survey field work was completed on 5/7/18 – 5/25/18. The Utility Survey checked the site for underground conduits, piping, and structures along the perimeter of the landfill.
- f. Traffic Study. EA continued coordination efforts with County DOT and City of Rockville for background traffic data. EA’s sub-consultant, T3, conducted traffic counts for the number of vehicles that travel along the major roadways and intersections around the Gude Landfill site in June 2018. Meeting attendees discussed the likely travel routes for the Purple Line trucks as reviewed in previous meetings, the potential concerns with existing traffic from South Lawn Lane’s industrial facilities, and potential traffic volumes.
  - Ø Soil Stockpile Traffic - Mr. Birnesser stated that there are already 10,000+ vehicles that travel along these routes each day, and that an additional 50-150 trucks per day for the soil stockpile project will not significantly impact the roadways. Projected traffic volumes for the larger capping project will be reviewed, and potential issues will be identified and coordinated with applicable permitting agencies.

- g. EA continued coordination efforts with adjacent properties for right-of-way access to perform limited confirmation test pitting to identify limits of waste. This includes several test pits (mid-July 2018) along the Gas pipeline right-of-way. Mr. Lezinski discussed the original waste delineation effort, where EA Engineering performed 161 test pits around the entire perimeter for the landfill property.
- h. Mr. Peterson asked if there is a legal requirement to remove the waste beyond the landfill property boundary. Mr. Lezinski stated that it is MDE's preference the County should maintain control of all waste or all land with waste associated with the landfill. This is why the County conducted the former land transfer with M-NCPPC.
- i. EA Engineering will also be conducting 20-40 test pits within the landfill area to identify locations of excess soil on the existing vegetative cover system, which can potentially be used in the future capping project

**4. LANDFILL FLARE SYSTEM AND PERIMETER GAS MONITORING**

- a. APTIM responded to a LFG exceedance in gas monitoring probe W-16 and adjusted the well field vacuum (E boundary) in early June 2018. The LFG exceedance was resolved.
- b. APTIM is working on a corrective measure for landfill gas exceedances in gas monitoring probe W-18 (SE boundary). W-18 has consistently experienced gas exceedances because it is installed directly into or in close proximity to waste. APTIM may need to investigate passive collection/venting systems for the areas around W-18. Mr. Lezinski reviewed the meeting handout for the landfill gas monitoring well location map.
- c. Mr. Wolohojian asked if we know the age of each area of the landfill. Mr. Lezinski stated that the age of the different areas of the landfill is not known. The Landfill operated from 1964-1982.

**5. LANDFILL SITE MAINTENANCE**

- a. Routine noxious weed spraying, mowing, and roadway repairs are on-going. No issues to report. The Purple Line Contractor will be responsible for maintaining the site roadways along the Southlawn Lane entrance to the soil stockpile.
- b. Mr. Harsanyi asked if there is on-going settlement at the landfill. Mr. Lezinski stated that EA Engineering will be evaluating settlement across the entire landfill site once they get the aerial survey data into the CAD computer programs. Site surveys were completed in 2009, 2015, and 2018. Settlement does generally occur year-to-year at the landfill.
- c. Mr. Harsanyi asked if there are standard corrective measures to fill areas experiencing settlement or surface depressions. Mr. Lezinski stated that if there are depressed areas that are holding standing water, the County would regrade the areas and add suitable soil to allow for positive drainage of the stormwater.

**6. MONTHLY GLCC MEETINGS AND ON-GOING COMMUNITY COMMUNICATION**

- a. Monthly Meetings held on 3<sup>rd</sup> Thursday at the Transfer Station at 7:00 PM.

**7. OPEN ACTION ITEMS**

- a. Dom Perez provided a historical summary of CASA to Mr. Birnesser on 6/13/18. Mr. Perez stated that the CASA club vacated the area at Gude Landfill on 4/30/18 and emptied out the on-site container; leaving them for the County's use.
- b. Mr. Birnesser spoke with the Division Chief concerning CASA's potential use of the Oaks Landfill until the capping project is completed, which is currently under review. If the Oaks Landfill is approved for CASA's usage, a Memorandum of Understanding (MOU) Agreement will be created between the County and CASA, which will have to be signed by the County Attorney. A walk through at the Oaks landfill could then be scheduled with CASA to identify

appropriate locations for club activities. Mr. Birnesser stated that the County may be able to move the CASA container over to the Oaks Landfill, if the MOU agreement is approved.

- c. Mr. Wolohojian asked Mr. Perez regarding the reported vandalism observed by CASA at the landfill site. Meeting attendees discussed the reported vandalism. Mr. Wolohojian stated that if vandalism occurs, GLCC and the nearby neighborhoods need to be informed and that security considerations should be included in the long-term use of the facility once the capping project is completed. Mr. Lezinski stated that EA Engineering will likely prepare a Security Specification for the safety and protection of the project during construction phase including the equipment and staff. Mr. Birnesser stated that once the capping project has been completed, the County may also have to design a security plan to protect the site.

**8. SUMMARIZE NEW ACTION ITEMS FROM THE MEETING**

- a. Mr. Ligon asked if there were any updates on the WSSC Fog Facility. Mr. Birnesser stated that there are no updates at this time. County DEP has a liaison representative that provides updates, which will be shared with GLCC when available. Mr. Birnesser will request contact information for the WSSC Project Manager.

**9. NEXT MEETING**

- a. The July 2018 meeting to be rescheduled to August 16, 2018 at 7:00 PM at the Transfer Station.

*The above summation is the writer's interpretation of the items discussed at the meeting. Comments involving differences in understanding of any of the meeting items will be received for a period of thirty (30) days from the date of these meeting minutes. Clarifications will be made, as deemed necessary. If no comments are received within the specified time period, the minutes will remain as written.*

**Gude Landfill Remediation  
Gude Landfill Concerned Citizens  
Monthly Meeting No. 49**

**Meeting Agenda**

**June 14, 2018  
7:00 PM – 9:00 PM**

- 1. Meeting Sign-In**
- 2. GLCC/DEP Meeting Minutes (Meeting No. 48 held on 4/19/18)**
  - a. GLCC accepted the minutes on 5/20/18.
- 3. Update on Purple Line / Gude Landfill Soil Stockpile Project**
  - a. The Purple Line Contractor is awaiting acceptable excavation locations.
  - b. Estimated start-date for hauling is late-June 2018.
- 4. Update on Gude Landfill Remediation – Design Engineer Project**
  - a. Aerial Survey field work completed on 4/16/18.
  - b. Wetlands, Forest Stand, and Nature Resources field investigations completed on 4/30 – 5/1/18.
  - c. Utility Survey field work completed 5/7/18 – 5/25/18.
  - d. EA continued coordination efforts with County DOT and City of Rockville for background traffic data.
  - e. Traffic Count field work, as part of the Traffic Study, completed in early June.
  - f. EA continued coordination efforts with adjacent properties for right-of-way access. This includes several test pits (mid-July) along the Gas pipeline right-of-way.
- 5. Landfill Flare System and Perimeter Gas Monitoring**
  - a. APTIM responded to a LFG exceedence in W-16 and adjusted the well field vacuum (E boundary) in early June. The LFG exceedence was resolved.
  - b. APTIM is working on a corrective measure for W-18 LFG exceedences (SE boundary).
- 6. Landfill Site Maintenance**
  - a. Routine noxious weed spraying, mowing, and roadway repairs are on-going. No issues to report.
- 7. Monthly GLCC Meetings and On-going Communication with the Community**
  - a. Monthly Meetings on 3<sup>rd</sup> Thursday at the Transfer Station at 7:00 PM.
- 8. Open Action Items**
  - a. Dom Perez provided a historical summary of CASA to Don Birnesser on 6/13/18.
- 9. Summarize New Action Items from the Meeting**
- 10. Next Meeting**
  - a. July meeting to be rescheduled to August 16<sup>th</sup> at 7:00 PM at the Transfer Station.

<b>Date</b>	June 14, 2018	Meeting No. 49
<b>Time</b>	7:00 PM - 9:00 PM	
<b>Meeting</b>	Gude Landfill Remediation: GLCC/DEP	

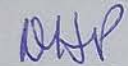
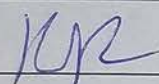
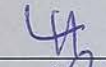
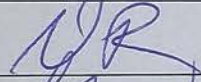
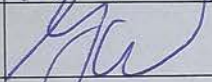
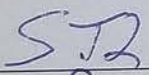
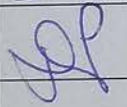
Name	Initial if Present	Affiliation	Phone	Email	Address
Don Birnesser		DSWS	240-777-6569	<a href="mailto:Donald.Birnesser@montgomerycountymd.gov">Donald.Birnesser@montgomerycountymd.gov</a>	
Dave Peterson		GLCC/DS1 HOA	301-921-6357	<a href="mailto:Kmpdhp@hotmail.com">Kmpdhp@hotmail.com</a>	7612 Anamosa Way Derwood, MD 20855
Keith Ligon		GLCC	301-340-3358	<a href="mailto:keligon56@gmail.com">keligon56@gmail.com</a>	15501 Moravia Court Derwood, MD 20855
Julia Tillery		GLCC	202-329-8740	<a href="mailto:Julia@tilleryoffice.com">Julia@tilleryoffice.com</a>	15461 Indianola Drive Derwood, MD 20855
Laszlo Harsanyi		GLCC/DS2 HOA	301-840-3822	<a href="mailto:LaszloH@comcast.net">LaszloH@comcast.net</a>	7228 Titonka Way Derwood, MD 20855
Nick Radonic		GLCC/DSS HOA	301-294-9124	<a href="mailto:Big.Rad@gmail.com">Big.Rad@gmail.com</a>	15408 Indianola Drive Derwood, MD 20855
George Wolohojian		GLCC/DSS HOA	301-738-7148	<a href="mailto:gwolohojian@aol.com">gwolohojian@aol.com</a>	15448 Indianola Drive Derwood, MD 20855
Charles Regan		GLCC/DSS HOA	202-510-1363	<a href="mailto:cregan520@gmail.com">cregan520@gmail.com</a>	15532 Grinnell Terrace Derwood, MD 20855
<b>Other Meeting Attendees</b>					
Stephen T. Lezinski		Barton & Loguidice, D.P.C.	(301) 918-8468	<a href="mailto:slezinski@bartonandloguidice.com">slezinski@bartonandloguidice.com</a>	4601 Presidents Drive, Suite 220 Lanham, MD 20706
Dom Perez		Capital Area Soaring Assoc.		<a href="mailto:domcperez@gmail.com">domcperez@gmail.com</a>	



## CASA FACTS

*To Peter,  
Karlsruhe*

- The Capital Area Soaring Association was founded in 1982.
- CASA is a chartered club under the Academy of Model Aeronautics (AMA), the official national organization for model aviation in the U.S. with 170,000 members. Each CASA member is also a member of the AMA.
- AMA affiliation provides individuals with \$1 million of liability protection and site owners with \$1.5/\$4.0 million of liability protection.
- CASA members have completed well over 60,000 flights of model aircraft without a single injury or incident involving property damage.
- CASA presently has approximately 85 members.
- Members only fly gliders and quiet electrically powered model aircraft.
- While initially comprised of glider enthusiasts, CASA members now fly a variety of aircraft types. Many types of planes, including helicopters, are feasible as a result of recent technological advances in electric power systems.
- CASA maintains a flying area at the East Gude Drive Landfill in Derwood, MD. This site was formerly used for flying model aircraft by another club. Remnants of two runways remain, as do two shelter structures. CASA began using the site in May 1993, and has enhanced the area with a storage container, a new shelter roof, work benches, chairs, a porta potty, and various other amenities.
- CASA membership is open to anyone interested model aviation. Annual dues are used to cover the cost of mowing the flying area (\$4,400 per year), renting the porta-potty, and publishing a newsletter.

### Contacts:

Jim Blanchfield:	703-356-1729	jblanchf@msn.com
Jon Evju:	301-975-2563	ruguy@yahoo.com
Ken Troxell:	301-762-6913	kenclo@webtv.net



## VANDALISM REPORT

May 2006

- There have been numerous incidents at the Gude Drive Landfill flying area beginning in October 2005, and continuing through April 2006.
- They have included:
  - Upsetting the porta-potty (5 or 6 times)
  - Smashing a solar panel used for battery charging
  - Writing graffiti in a log book and subsequently tearing it apart
  - Smashing a Plexiglass panel used to display frequency usage
  - Scattering the contents of a First Aid Kit
  - Scattering frequency pin clips
  - Stealing a wind sock and its support structure
  - Prying open a grillwork vent on the storage container
  - Spraying graffiti on the brick pavilion, porta-potty, and storage unit
- CASA believes it has a responsibility to inform the site manager of the vandalism.
- CASA discussed the vandalism with a Montgomery County Police Officer. The officer took some information and visited the flying area. He indicated he would make random visits to the area.
- Our practice is to lock the gate at the bottom of the hill whenever the last flyer leaves. The gate is left open only when the red pick-up truck is not locked in the fenced area. This is per agreement with the site workers.
- We recognize that there is no way to prevent vandalism on the site.
- CASA accepts the vandalism situation and will repair any and all damage to its property, as deemed necessary.
- CASA is not requesting any action from the site management, nor does it expect any. The purpose of this report is only to provide information about happenings on the property.
- We are very appreciative of being allowed to fly at the site and hope we are regarded as responsible and desirable users.



May 6, 1993

TO: Montgomery County Recreation Department  
Attention: Bob Daniel  
Proposed Field Rules For Gude Landfill Flying Site

FROM: Roy Smith, CASA  
301-279-2966

Montgomery County Sailplane and Electric Power Flying Field

1. Only Sailplanes and Electric Powered Aircraft may be flown at this site.
2. Proof of liability insurance is necessary on request.
3. Flying past the approach road on the Southwest, West and Northwest side of the landfill is prohibited.
4. Do not fly over the designated Pit area.
5. Do not block by over flying the take off and launch areas.
6. Hi-starts and Wenchies for launching sailplanes will be set up in the designated area.
7. All pilots will fly their aircraft from the pilot circle.
8. Frequency Pins must be used at all times.
9. CH 20 and CH 21 will not be used at this site.
10. Field hours 10:00 a.m. to 4:00 p.m.

Approved by Robert Daniel

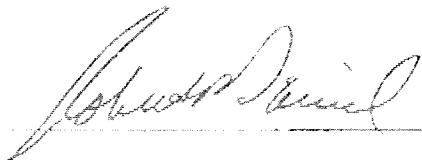

5/26/93

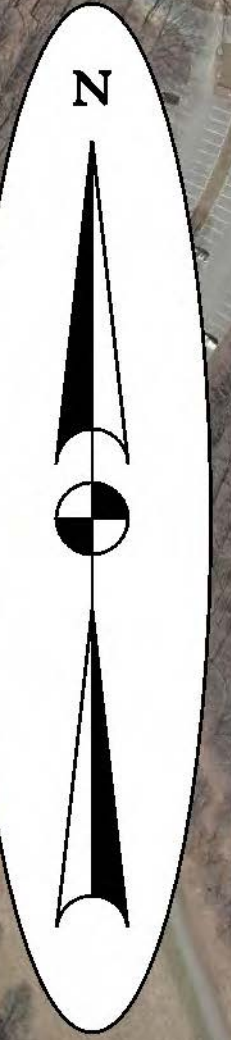

**Gude Landfill**  
**April 16, 2018**

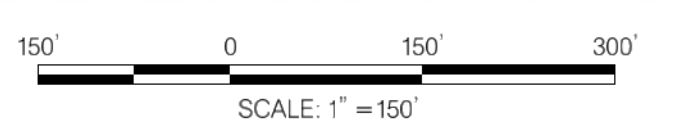

FILE PATH: G:\PROJECTS\1498201 - GUDE PHASE 2 ACM\PROPOSED WELLS AND PROBES\SURVEY MAP.DWG [LFG] 6/14/16

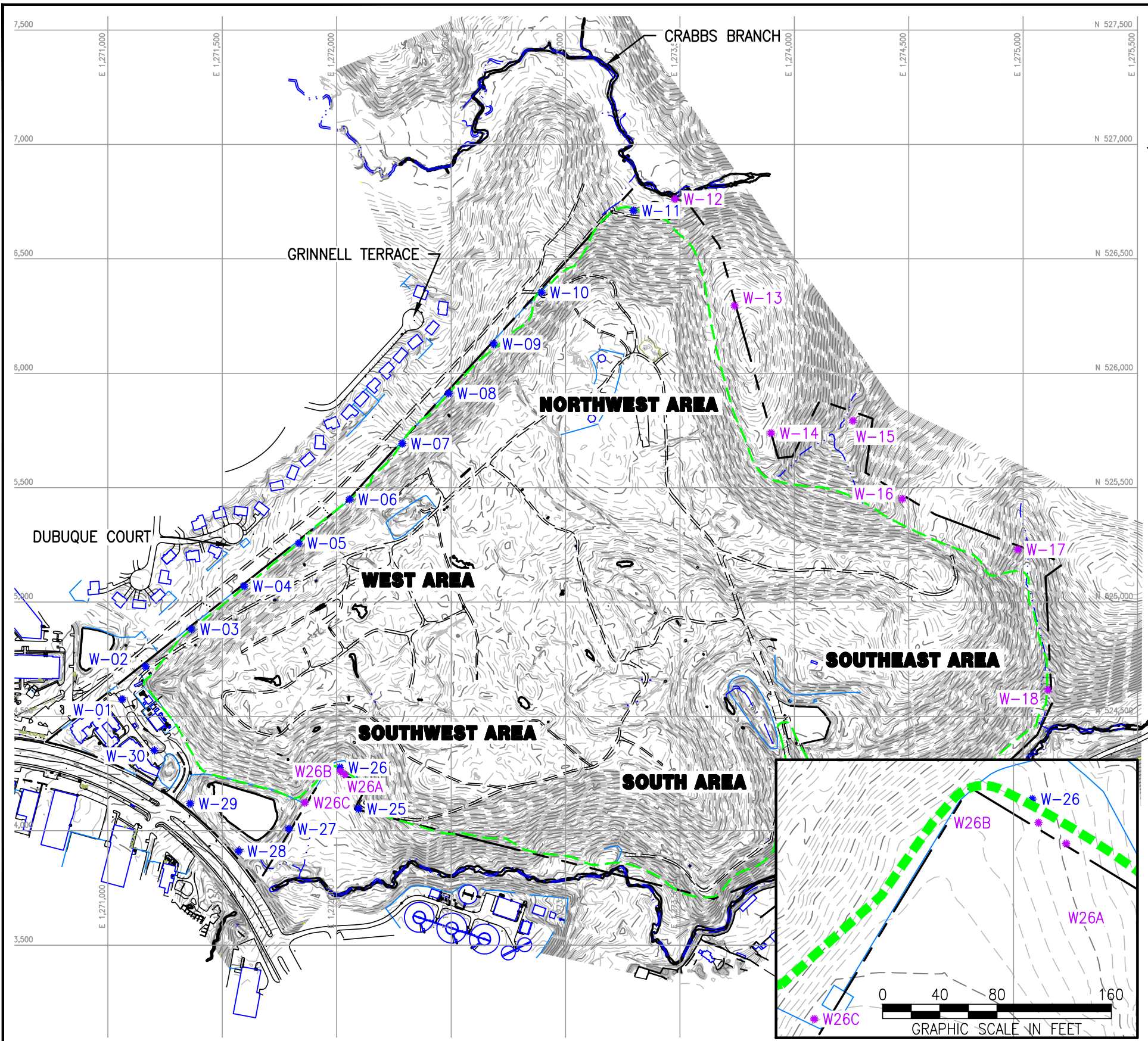

- NOTES:**
1. TOPOGRAPHY COMPILED BY WALLACE MONTGOMERY USING PHOTOGRAMMETRIC METHODS WITH PHOTOGRAPHY DATED APRIL 2015 AND SUPPLEMENTED WITH FIELD SURVEY PERFORMED BY C.C. JOHNSON & MALHOTRA, P.C., OCTOBER 2009 AND WALLACE MONTGOMERY FIELD SURVEY NOVEMBER 2015.
  2. HORIZONTAL DATUM IS NORTH AMERICAN DATUM OF 1983/91 (NAD-83/91). COORDINATE SYSTEM IS MARYLAND STATE PLANE, U.S. SURVEY FEET. VERTICAL DATUM IS NORTH AMERICAN VERTICAL DATUM OF 1988 (NAVD-88) WITH ELEVATIONS SHOWN IN FEET.
  3. TOPOGRAPHY IS APPROXIMATE IN AREAS NOTED "GROUND OBSCURED BY DENSE TREES AND VEGETATION".
  4. THE PROPERTY BOUNDARY SHOWN REFLECTS A LAND EXCHANGE BETWEEN MONTGOMERY COUNTY AND M-NCPPC WHICH OCCURRED ON 21 OCTOBER 2014.
  5. PROPOSED LANDFILL GAS MONITORING WELLS WERE LOCATED AND STAKED ON 04/29/16 UTILIZING A HANDHELD GLOBAL POSITIONING SYSTEM (GPS) DEVICE.

**LEGEND**

- 400--- 10-FT CONTOUR
- 2--- 2-FT CONTOUR
- PROPERTY BOUNDARY
- LIMIT OF WASTE
- STREAM
- TREELINE
- ★ W-X LANDFILL GAS MONITORING WELL
- ★ W-X PROPOSED LANDFILL GAS MONITORING WELL - SURVEYED LOCATION

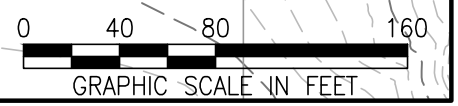
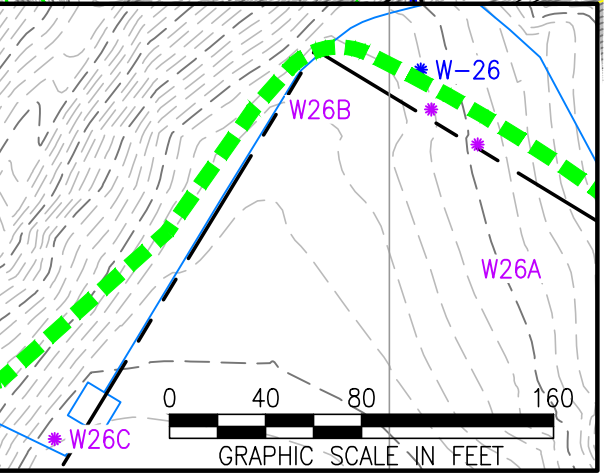

GUDE LANDFILL  
MONTGOMERY COUNTY, MARYLAND

EXISTING AND PROPOSED LFG MONITORING WELL  
LOCATION MAP

DESIGNED BY PL	DRAWN BY JSP	DATE JUNE 2016	PROJECT NO. 14982.01
CHECKED BY BR	PROJECT MGR. MJG	DRAWING NO. -	FIGURE -