

**Prepared By: Montgomery County DEP/DSWS**

**Date Issued: 12/3/2018**

**GUDE LANDFILL REMEDIATION  
GLCC/DEP MEETING NO. 51**

DATE: Thursday, October 18, 2018  
TIME: 7:00 PM to 8:30 PM  
LOCATION: Montgomery County Transfer Station

**ATTENDANCE:**

<u>Name</u>	<u>Organization</u>	<u>Designation</u>
Laszlo Harsanyi	Gude Landfill Concerned Citizens (GLCC)	Member
Keith Ligon	Gude Landfill Concerned Citizens (GLCC)	Member
Dave Peterson	Gude Landfill Concerned Citizens (GLCC)	Member
Nick Radonic	Gude Landfill Concerned Citizens (GLCC)	Member
Don Birnesser	Montgomery County Dept. of Env. Protection (DEP)	Section Chief
Jeannie Oxendine	Maryland Environmental Services (MES)	DEP Support Staff
Stephen Lezinski	Barton & Loguidice, D.P.C. (B&L)	DEP Consultant

The Meeting Agenda is included as Attachment 1.

Contact information for attendees is included as Attachment 2.

The Draft Engineering Design – Northwest Property Boundary is included as Attachment 3.

**1. WELCOME AND OPENING REMARKS**

- a. Stephen Lezinski opened the meeting by welcoming the participants for attending.
- b. Mr. Lezinski asked GLCC to review the minutes from GLCC/DEP Meeting No. 50 for approval. Dave Peterson and Nick Radonic accepted the minutes.

**2. PURPLE LINE / GUDE LANDFILL SOIL STOCKPILE PROJECT**

- a. Mr. Lezinski provided an update on the Soil Stockpile project. He stated that the soil hauling has been intermittent due to inclement weather and availability of suitable soil. He stated that some loads had to be turned away as they contained large rocks and ash. Mr. Lezinski also noted on-going project activities: soil hauling, grading, roadway repairs, site cleanup, etc.
  - Ø Mr. Radonic asked how the project work was going.
  - Ø Mr. Lezinski noted that the project is moving forward as expected and is going well. There have been no site issues or E&S violations to date. When storms have been predicted, the soil stockpile area has been prepped appropriately (i.e., regrading and compacting the surface layer, and re-securing the silt fence).
  - Ø Mr. Peterson asked if MDE has performed any site visits to the Gude Landfill.
  - Ø Mr. Lezinski noted that, to his knowledge, MDE has not visited the landfill for the soil stockpile project. However, M-NCPPC and County DPS have visited the site to inspect E&S control measures.
- b. Mr. Lezinski stated that 1,670 truckloads of soil have been stockpiled from July-October 2018. Approx. 17,000–20,000 Cubic Yards (CY) (avg. of 10-12 CYs per truck load). Gannett Fleming continued to provide construction inspection services to monitor site activities. Mr. Birnesser added that the current soil total is approximately one-fifth of the target capacity for the stockpile.

- c. Laszlo Harsanyi asked if there is a target of how much soil the County will accept.
  - Ø Mr. Birnesser noted that in May 2016, Montgomery County entered into an agreement (MOU) with the Maryland Transit Administration to accept up to 90,000 CY of soil. This amount of soil is approximately one-fifth of what the capping project will need.
  - Ø Mr. Lezinski added that the current Stockpile is permitted for roughly 100,000 CY of soil. If the project was approaching that amount, and the Purple Line had additional suitable material, the County could submit updated plans for an expanded stockpile.
- d. Mr. Harsanyi asked whether EA Engineering had already determined that the area where the stockpile is located would not cause any other problems on the landfill site due to settlement.
  - Ø Mr. Lezinski noted that the County chose the location above the concrete pad mainly because there was a previous soil stockpile adjacent to that area and the grading allowed for an increase in elevation. The County does not envision any impacts to the landfill in that area from the soil stockpile.
- e. Mr. Harsanyi asked, where would the brush go?
  - Ø Mr. Lezinski noted, as of right now, when there is storm debris, it would be placed on the concrete pad area for temporary storage and grinding. In the future, storm debris storage would be located in the NE area of the site (same as current operations).
- f. Mr. Radonic asked how late in the season will Purple Line crews expect to be digging and transporting soil.
  - Ø Mr. Lezinski stated that he did not know their exact schedule; however, because of how large the project is, he estimated that some construction activities may proceed through the winter season.

### **3. GUDE LANDFILL REMEDIATION – DESIGN ENGINEER PROJECT**

- a. Mr. Birnesser provided an update on project work of EA Engineering.
  - Ø Mr. Birnesser stated that Pre-Design activities (Traffic Impact Study, Utility Locating, Geotechnical Investigation, and Landfill Gas Investigation) are nearing completion. Draft Reports will be prepared.
  - Ø Mr. Birnesser stated that the initial concept grading and drainage plans for the capping system were prepared and will be incorporated into the 30% Draft Design, which is due in early-November 2018. The 30% Draft Design will include: the basis of design report, drawings with initial phasing plans, a specification outline, and six (6) specification sections and engineering documents.
  - Ø Mr. Lezinski added that the grading/drainage plans involve the elevation of the ground surface/capping system as well as the diversion of stormwater off the landfill surface to dedicated facilities (such as ponds).
- b. Mr. Harsanyi asked if there are any regulations that stipulate how much parkland or certain types of park usage have to be used for stormwater ponds.
  - Ø Mr. Birnesser stated that if there was further development in certain areas on-site or adjacent to the landfill or community that the stormwater design might have to be altered to accommodate the stormwater requirements.
  - Ø The GLCC asked several questions about where the other stormwater ponds were located on the landfill site. Mr. Lezinski identified the existing ponds on-site and potential areas of modifications to handle the stormwater runoff for the project.
- c. Mr. Birnesser explained the Northwest Slope Draft cross-section (waste relocation, new fence installation, protection of monitoring wells, perimeter stormwater swale, tree/vegetation, access road/walking path, etc.). An access road is proposed for maintenance as well as a walking path.
  - Ø Mr. Lezinski added that the top chart represented a Plan View, and the bottom chart represents a Profile View.

- d. Mr. Birnesser spoke about Land Reuse – the progression of this task depends on the outcomes of the 30% Draft Design grading/drainage and the upcoming MDE Meeting. He noted that the EA Monthly review meeting (30% Design) will take place on November 9, 2018, and a preliminary planning meeting with MDE was scheduled for later that same day to discuss design concepts.
  - Ø Mr. Birnesser asked if GLCC (the HOA leads for Derwood Station Communities) could review the HOA right-of-way access points that border or are located in proximity to the natural gas pipeline. If plat drawings are available, this information would greatly help the County during land reuse design efforts to provide potential locations for access gates along with western/northwestern slope.
- e. Mr. Lezinski noted that the EA Design Engineer Progress Meetings, #5-6-7, were held August-October 2018. The Senior Level Manager Update Meeting #2 was held in October 2018 (the GLCC/DEP Meeting No. 50 presentation was used for the update).
- f. Mr. Radonic asked about the schedule of the two (2) Community meetings that have been discussed for the remediation project.
  - Ø Mr. Lezinski stated that the Community meetings will likely be scheduled in early-mid 2019. The first meeting may be scheduled for late February-March 2019, and the second meeting potentially in May 2019. The schedule is dependent upon the progression of the design phase.
- g. Mr. Peterson asked if EA and the Landscape Designers can provide the literature review of passive land re-uses for the December 2018 meeting.
  - Ø Mr. Lezinski responded in the affirmative and would coordinate with EA.

#### **4. CAPITAL AREA SOARING ASSOCIATION (CASA)**

- a. Mr. Birnesser stated that the County Attorney reviewed CASA's informal request to relocate to the Oaks Landfill. The Attorney confirmed a Memorandum of Understanding, License Agreement, and Insurance would be required.
- b. Mr. Birnesser stated that a meeting has been scheduled with Dom Perez within the last week of October 2018 to visit the Oaks Landfill and review potential locations. Several acres have been identified near the landfill entrance that also has an adjacent parking area.
  - Ø Mr. Radonic asked if the parking area is located within the fenced area of the landfill.
  - Ø Mr. Birnesser stated that the parking area is located outside of the main fenced area of the landfill.

#### **5. LANDFILL FLARE SYSTEM AND PERIMETER GAS MONITORING**

- a. Mr. Lezinski stated that DEP continues the weekly monitoring of the LFG gas probes along the perimeter of the property. The Landfill Flare System is operational (including the LFG collection system).
- b. Mr. Lezinski stated that APTIM responded to short-term intermittent LFG exceedances in the monitoring probes on the northwest, southern, and southeastern areas of the site during August-October 2018. Inclement weather and excessive rains likely contributed to the gas exceedances.
- c. Mr. Radonic asked if there are active vacuum draws across the landfill site in these areas with exceedances.
  - Ø Mr. Lezinski responded that the majority of the landfill site where waste was placed has an active landfill gas management system. The SE area of the landfill site does not have active gas collection as some of the piping was temporarily removed for the soil stockpile project.
  - Ø APTIM typically responds by identifying and inspecting the area of the well field with the exceedance. They may adjust the well field vacuum, repair piping and hosing or pump water from a well to improve gas collection. After APTIM performs this work, the exceedance typically subsides within a few days.

- d. Mr. Harsanyi noted that the gas exceedance problems seem to have gotten worse.
  - Ø Mr. Lezinski stated that during this period (August-October), the excessive rain impacted the collection efficiency of the gas management system.
  - Ø Mr. Birnesser added that some of the heavy rains may have infiltrated into the waste mass, which also could have accelerated gas production. The capping project will prevent the rain water from infiltrating into the waste mass.
- e. Mr. Harsanyi asked where the flare is located.
  - Ø Mr. Lezinski responded that the flare is located in the western corner of the property (west of Pond 1) and across from the Men's Shelter.
- f. Mr. Lezinski stated that APTIM previously prepared a preliminary corrective measure to mitigate LFG exceedances in gas monitoring probe W-18 (SE area of site). To support the Work Plan submission to MDE, APTIM is preparing a comprehensive update to the LFG system site plans along with the draft design of the corrective measure. Prior to the full remediation project, a passive venting system is proposed for this area as former gas piping was removed for the soil stockpile project.
- g. Mr. Lezinski stated that APTIM will be installing a UPS battery backup next week for the auto-dialer that calls the Flare Station emergency contacts when there is a system outage. APTIM will also be winterizing the Flare Station and other areas of the LFG system in late-October to early-November 2018.
  - Ø Mr. Radonic asked what it means to winterize the flare system. Mr. Lezinski stated this work entails insulating the piping to prevent the freeze and thaw process. As the warmer gas travels through the pipes, condensation can occur, which can then freeze in the extreme cold. This may result in pipe breakage. For other mechanical areas, such as valves, heat trace and insulation will be installed.

## **6. GROUNDWATER MONITORING**

- a. Mr. Lezinski stated that the Spring 2018 Semi-Annual Groundwater Monitoring Report was submitted to MDE in August 2018. Monitoring results were similar to historical trends and findings of the Revised ACM Report.
- b. Mr. Lezinski stated that the Fall 2018 Semi-Annual Groundwater Sampling Event was completed by DEP in late-September to early-October 2018. This report is due to MDE by the end of the year. The laboratory will analyze the samples and prepare the raw data, and EA will prepare the Report including the MCL trend plots.
- c. Mr. Radonic asked if there were exceedances in the groundwater monitoring wells in the HOA.
  - Ø Mr. Lezinski noted that one (1) monitoring well in the community (MW-9) near Dubuque Court contained an exceedance of PCE, which is consistent with historical results. There were also exceedances in MW-13A and MW-13B, which are located on M-NCPPC property (in the former "hat" parcel) in the NW Area.
- d. Mr. David Peterson asked about the exceedances from monitoring well OBO3A on the northwest slope.
  - Ø Mr. Lezinski noted that OBO3A consistently exhibits groundwater exceedances, as well as, OBO11 located in the southern area of the site. The levels are consistent with historical trends. The County and MDE will continue to monitor these two (2) wells and all of the other groundwater wells (presently and following the capping project) to verify the impact of the remediation efforts. Significant changes in monitoring results could take 1-5 years.
- e. Mr. Harsanyi asked for an explanation of what Historical Trends means.
  - Ø Mr. Lezinski noted that it pertains to the monitoring data and plotted graphs that go back 20-30 years, which tracked the exceedance levels of groundwater constituents

throughout the semi-annual monitoring events. They represent the data points from the sampling events from 1984 through present day.

- f. Mr. Peterson asked, if before the capping project gets started, would it be possible for EA to produce another diagram that shows the concentration of the constituents from the exceedances. The original diagram held by Mr. Peterson may have been included in a former draft of the Assessment of Corrective Measures (ACM) (Figure 2-3).

Ø Mr. Lezinski and Mr. Birnesser confirmed that EA could prepare the diagram update.

#### **7. LANDFILL SITE MAINTENANCE**

- a. Mr. Lezinski provided an update on site mowing, which has ceased for the 2018 calendar year.
- b. Mr. Lezinski noted that Contractor site inspections have identified leachate seeps along the northwest slope of the landfill. The County has requested a repair cost estimate from the property maintenance contractor to implement repairs.

#### **8. GLCC MEETINGS AND ON-GOING COMMUNITY COMMUNICATION**

- a. Monthly Meetings. 3<sup>rd</sup> Thursday at the Transfer Station at 7:00 PM or a modified schedule as agreed by GLCC and the County.

#### **9. OPEN ACTION ITEMS**

- a. None to report.

#### **10. SUMMARIZE NEW ACTION ITEMS FROM THE MEETING**

- a. Mr. Peterson requested a copy of the aerial flyover map for EA's remediation project.
- b. Mr. Peterson requested for EA to prepare an updated Total VOC Map diagram at the end of design phase.
- c. Mr. Peterson requested a copy of the literature review for passive land re-uses.
- d. Mr. Radonic requested to obtain the photos of the trip to the Fresh Kills Landfill.
- e. Mr. Lezinski to electronically submit EA's 30% Design package to GLCC for review before the December 6<sup>th</sup> meeting.
- f. GLCC (the HOA leads for Derwood Station Communities) to review the HOA right-of-way access points that border or are located in proximity to the natural gas pipeline. The County requested plat drawings with this information, if available.

#### **11. NEXT MEETING**

- a. Due to the upcoming holidays, the County requested to shift the next meeting to December 6, 2018 at the Recycling Center's Education Room.

**Gude Landfill Remediation  
Gude Landfill Concerned Citizens  
Monthly Meeting No. 51**

**Meeting Agenda**

**October 18, 2018  
7:00 PM – 9:00 PM**

**1. Meeting Sign-In**

**2. GLCC/DEP Meeting Minutes (Meeting No. 50 held on 8/16/18)**

- a. Draft Meeting Minutes were distributed to GLCC on 9/17/18 and 10/15/18.
- b. GLCC review/acceptance of minutes.

**3. Purple Line / Gude Landfill Soil Stockpile Project**

- a. Soil hauling has been intermittent due to inclement weather and availability of suitable soil.
- b. 1,670 truckloads of soil have been stockpiled from July-October 2018. Approx. 17,000–20,000 CYs (avg. of 10-12 CYs per truck load). Gannett Fleming continued to provide construction inspection services to monitor site activities.
- c. On-going project activities: soil hauling, in-place grading, roadway repairs, site cleanup, etc.

**4. Gude Landfill Remediation – Design Engineer Project**

- a. EA Engineering Project Work:
  - Ø Pre-Design activities (Traffic Impact Study, Utility Locating, Geotechnical Investigation, and Landfill Gas Investigation) are nearing completion. Draft Reports will be prepared.
  - Ø Initial concept grading and drainage plans for the capping system were prepared and will be incorporated into the 30% Draft Design, which is due in early-November 2018. The 30% Draft Design will include: the basis of design report, drawings with initial phasing plans, a specification outline, and six (6) specification sections.
  - Ø Northwest Slope – Refer to the Draft cross-section of the northwest slope (waste relocation, new fence installation, protection of monitoring wells, perimeter stormwater swale, tree/vegetation, access road/walking path).
  - Ø Land Reuse – progression of this task depends on the outcomes of the 30% Draft Design grading/drainage and the upcoming MDE Meeting.
- b. Project Meetings – Progress Meetings #5-6-7 were held August-October 2018. Senior Level Manager Update Meeting #2 was held in October 2018 (the GLCC/DEP Meeting No. 50 presentation was used).
- c. MDE Meeting – scheduled for November 2018 to review 30% design grading and drainage of the capping system including the northwest slope concept.

**5. Capital Area Soaring Association (CASA)**

- a. County Attorney reviewed CASA's informal request to relocate to the Oaks Landfill. Confirmed a Memorandum of Understanding, License Agreement, and Insurance would be required.
- b. DEP and CASA have a meeting scheduled next week at the Oaks Landfill to review a preliminary location on site.

**6. Landfill Flare System and Perimeter Gas Monitoring**

- a. DEP continues the weekly monitoring of the LFG gas probes along the perimeter of the property.
- b. The Landfill Flare System is operational (including the LFG collection system).

**Gude Landfill Remediation  
Gude Landfill Concerned Citizens  
Monthly Meeting No. 51**

**Meeting Agenda**

**October 18, 2018  
7:00 PM – 9:00 PM**

- c. APTIM responded to short-term intermittent LFG exceedences in monitoring probes on the northwest, southern, and southeastern areas of the site during August-October 2018. APTIM performed field inspections and adjusted the well field vacuum to address the LFG exceedences. Inclement weather and excessive rains likely contributed to the gas exceedences.
- d. APTIM previously prepared a preliminary corrective measure to mitigate LFG exceedences in gas W-18 (SE area of site). To support the Work Plan submission to MDE, APTIM is preparing a comprehensive update to the LFG system site plans along with the draft design of the corrective measure.
- e. APTIM will be installing a UPS battery backup next week for the auto-dialer that calls the Flare Station emergency contacts when there is a system outage. APTIM will also be winterizing the Flare Station and other areas of the LFG system in late-October to early-November 2018.

**7. Groundwater Monitoring**

- a. The Spring 2018 semi-annual groundwater monitoring report was submitted to MDE in August 2018. Monitoring results were similar to historical trends and findings of the Revised Assessment of Corrective Measures Report: seasonal fluctuations with some constituents increasing and decreasing (evidence of natural attenuation, daughter products, etc.).
- b. The Fall 2018 semi-annual groundwater sampling event was completed by DEP in late-September to early-October 2018.

**8. Landfill Site Maintenance**

- a. Property Maintenance (mowing) – Regular mowing has ceased for 2018.
- b. Property Maintenance (leachate seeps) – Seeps were observed on the northwest slope of the landfill. A repair cost estimate has been requested from the property maintenance contractor.

**9. Monthly GLCC Meetings and On-going Communication with the Community**

- a. Monthly Meetings on 3<sup>rd</sup> Thursday at the Transfer Station at 7:00 PM.

**10. Open Action Items**







- a. None to report.

**11. Summarize New Action Items from the Meeting**

**12. Next Meeting**

- a. County request to shift November 15<sup>th</sup> meeting to December 20, 2018.

<b>Date</b>	October 18, 2018	Meeting No. 51
<b>Time</b>	7:00 PM - 9:00 PM	
<b>Meeting</b>	Gude Landfill Remediation: GLCC/DEP	

Name	Initial if Present	Affiliation	Phone	Email	Address
Don Birnesser		DEP/DSWS	240--777-6569	<a href="mailto:Donald.Birnesser@montgomerycountymd.gov">Donald.Birnesser@montgomerycountymd.gov</a>	16101 Frederick Road Derwood, MD 20855
Dave Peterson		GLCC/DS1 HOA	301-921-6357	<a href="mailto:kmpdhp@hotmail.com">kmpdhp@hotmail.com</a>	7612 Anamosa Way Derwood, MD 20855
Keith Ligon		GLCC	301-340-3358	<a href="mailto:kelligon56@gmail.com">kelligon56@gmail.com</a>	15501 Moravia Court Derwood, MD 20855
Julia Tillery		GLCC	202-329-8740	<a href="mailto:julia@tilleryoffice.com">julia@tilleryoffice.com</a>	15461 Indianola Drive Derwood, MD 20855
Laszlo Harsanyi		GLCC/DS2 HOA	301-840-3822	<a href="mailto:laszloh@comcast.net">laszloh@comcast.net</a>	7228 Tironka Way Derwood, MD 20855
Nick Radonic		GLCC/DSS HOA	301-294-9124	<a href="mailto:Big.Rad@gmail.com">Big.Rad@gmail.com</a>	15408 Indianola Drive Derwood, MD 20855
George Wolohojian		GLCC/DSS HOA	301-738-7148	<a href="mailto:gwolohojian@aol.com">gwolohojian@aol.com</a>	15448 Indianola Drive Derwood, MD 20855
Charles Regan		GLCC/DSS HOA	202-510-1363	<a href="mailto:cregan520@gmail.com">cregan520@gmail.com</a>	15532 Grinnell Terrace Derwood, MD 20855
<b>Other Meeting Attendees</b>					
Stephen T. Lezinski		Barton & Loguidice, D.P.C.	(301) 918-8468	<a href="mailto:slezinski@bartonandloguidice.com">slezinski@bartonandloguidice.com</a>	4601 Presidents Drive, Suite 220 Lanham, MD 20706
Dom Perez		Capital Area Soaring Assoc.		<a href="mailto:domcperez@gmail.com">domcperez@gmail.com</a>	
Mark Gutberlet		EA Engineering	410-584-7000	<a href="mailto:mgutberlet@east.com">mgutberlet@east.com</a>	225 Sehillng Circle, Suite 400 Hunt Valley, MD 21031
Jeannie Oxendine		DEP/DSWS Contractor support staff		<a href="mailto:Jeannie.Oxendine@montgomerycountymd.gov">Jeannie.Oxendine@montgomerycountymd.gov</a>	16101 Frederick Road Derwood, MD 20855



# Northwest Property Boundary

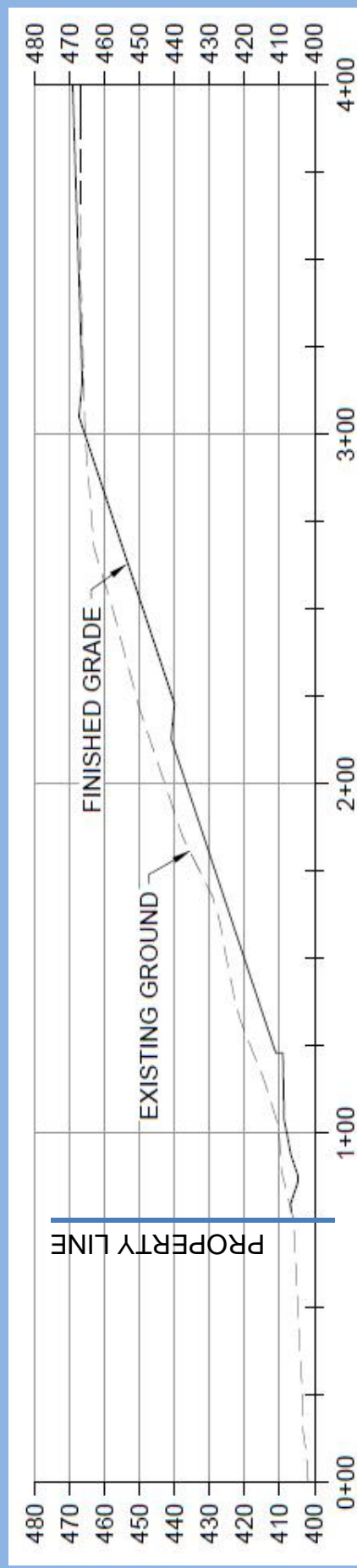
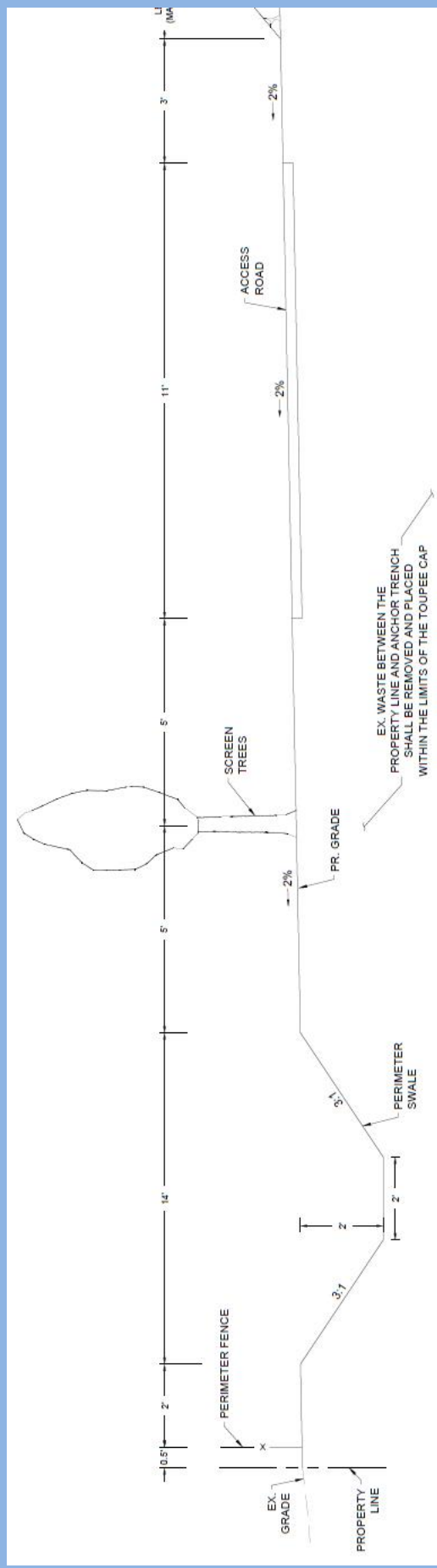

DEPARTMENT OF ENVIRONMENTAL PROTECTION  
MONTGOMERY COUNTY, MARYLAND

