

LICENSE AGREEMENT  
BETWEEN  
MONTGOMERY COUNTY, MARYLAND AND BRIGHT EYES, INC.

TABLE OF CONTENTS

1. Licensed Premises
2. License Term
3. Renewal Option
4. License Fee and Additional License Fee
5. Use of Licensed Premises
6. Assignment
7. Use of Outdoor Playground Areas
8. Licensed Capacity
9. Priority Placement
10. Special Conditions
11. Improvements and Alterations
12. Services
13. Fixtures and Equipment
14. Liability, Property Damage and Fire Insurance
15. Hold Harmless
16. Responsibilities of Licensee
17. Destruction of Licensed Premises
18. Default
19. Eminent Domain
20. Right of Entry
21. Return of the Licensed Premises
22. Notice of Accidents, Defects or Damages
23. Compliance with Laws
24. Waiver
25. Non-Discrimination
26. Public Employment
27. Mailing Notices
28. Resident Agent
29. Prohibition of Hazardous Substances
30. Non-Appropriation
31. American Disabilities Act Requirements
32. Sex Offender Law
33. Pesticides in the School
34. Recycling
35. Contract Solicitation/Broker's Fees or Commissions
36. Force Majeure
37. Entire Agreement
38. Modification
39. Governing Law
40. Claims
41. Indemnity Bond
42. Parking
43. Indemnification
44. Remedies
45. Acknowledgement of Authority

Exhibit A - Licensed Premises

Exhibit B - Provider's Child Care Proposal

Exhibit C - Procedure for Implementing the Revised Policy for Waivers of Capital Cost Fee

Exhibit D - Licensed Premises' Equipment Inventory

Exhibit E - Insurance

Exhibit F- Resource Conservation Policy and Guidelines

Exhibit G- Regulation ECF-RB- Pesticide Use in Schools

Exhibit H- Regulation ECF-RB- Recycling

## LICENSE AGREEMENT

THIS LICENSE AGREEMENT (the "License"), made this 22 day of Feb, 2017, by and between MONTGOMERY COUNTY, MARYLAND, a body corporate and politic and a political subdivision of the State of Maryland (the "County") and BRIGHT EYES, INC., a for profit corporation and a Child Care Provider (the "Licensee" or the "Provider"). (The County and the Licensee or Provider together the "Parties").

### BACKGROUND:

1. The County has a leasehold interest in space located at the Glen Haven Elementary School located at 10900 Inwood Avenue, Silver Spring, Maryland, 20906 ("Glen Haven") for the sole purpose of the operation of a child care center ("Child Care Center") in Montgomery County, Maryland; and
2. The County solicited requests for proposals from organizations interested in providing child care at Glen Haven; and
3. A Child Care Provider Selection Committee reviewed applications and chose the Licensee to provide a child care program appropriate to the needs of the community; and
4. The purpose of the County's Policy on Use of County Buildings for Child Care is:
  - a. To establish consistent and reasonable rental rates for child care in public buildings licensed from the County;
  - b. To establish responsibilities of the County and the Licensee; and
  - c. To establish priority placement for children of County employees; and
5. The Licensee is licensed or certified by the State of Maryland or other bona fide certifying or licensing entity to provide child care services.

1. LICENSED PREMISES: The County does grant the Licensee the privilege, license and right to use approximately 2461 square feet in the premises shown as cross-hatched on the attached **Exhibit A** located at Glen Haven (the "Licensed

Premises”), for the exclusive purpose of providing the child care services described in the Provider’s Childcare Proposal attached as **Exhibit B** and incorporated as if fully set forth (the “Program”). The Licensed Premises shall be delivered to the Licensee in “as is” condition.

2. LICENSE TERM: The term of this License commenced on July 1, 2015 and shall expire on June 30, 2019 (the “License Term”). This License may be terminated at any time during the License Term or any extension of the License Term by the County upon thirty (30) days written notice to the Licensee, unless the Licensee’s license or certification to operate a Child Care Center is suspended or revoked by the issuing entity, in which case the County is not required to provide thirty (30) days written notice to the Licensee. The County is under no obligation to provide alternative space for the Licensee and is not responsible for any moving costs or any expenses incurred by the Licensee as a result of the termination or expiration of this License for any reason. The Parties agree that the License shall only be terminated or revoked by the County on the terms expressly set forth in this License.

3. RENEWAL OPTION: The Licensee may, at its option, extend the License Term for one (1) additional three (3) year term (the “Renewal Term”), provided that: (a) the Licensee has submitted its monthly license fee payment on time; (b) the Licensee has maintained its compliance with all licensing requirements of the Program, whether state, local or federal; (c) the Licensee is using all reasonable efforts to obtain in a timely fashion its accreditation of its Program by the National Association for the Education of Young Children (“NAEYC”) or by Maryland State Department of Education (“MSDE”) or the Licensee is currently maintaining its accreditation of its Program by NAEYC or by the MSDE; (d) the Licensee is maintaining the Licensed Premises, including the playground area, in good condition and repair and free of clutter; (e) the Licensee is not in default of any other provisions of this License; (f) the License is in full force and effect; (g) the County has not given the Licensee notice of the County’s intention to terminate the License; (h) the Licensee’s license to operate a Child Care Center has not been revoked or suspended by the issuing entity; and (i) the Licensee provides the County with written notice that the Licensee intends to exercise Licensee’s option to extend the License Term, one hundred and twenty (120) days prior to the expiration of the current License Term. Licensee shall be required to submit an updated insurance certificate

within thirty (30) days after the renewal of this License. TIME IS OF THE ESSENCE FOR THE LICENSEE'S NOTICE TO THE COUNTY.

4. LICENSE FEE AND ADDITIONAL LICENSE FEE:

A. License Fee: Beginning with the License commencement date, the Licensee will pay to the County as a License Fee, Nine Dollars and Fifty-Six Cents (\$9.56) per square foot for an annual rate of Twenty-Three Thousand Five Hundred Twenty-Seven Dollars and Sixteen Cents (\$23,527.16) payable in equal monthly installments of One Thousand Nine Hundred Sixty Dollars and Fifty-Nine Cents (\$1960.59). All payments are to be made in advance on the first day of each month during each license year, and shall be payable by check to:

Montgomery County, Maryland  
Department of General Services  
Office of Real Estate  
P.O. Box 829464  
Philadelphia, Pennsylvania 19182-9464.

B. License Fee Increase: Commencing with January 1, 2018 and on the 1<sup>st</sup> of January thereafter during the License Term, and any Renewal Term, the County will establish the License Fee rate to be paid by the Licensee for July 1 of the following year, by determining the average per square foot operating cost for all childcare facilities operated and maintained by the County. For purposes of this License, operating costs shall include, but not be limited to, the following:

1. Utilities;
2. Janitorial – At the same level provided to other Montgomery County Board of Education properties. The Licensee must perform day to day programmatic clean up (spills, crumbs, sand, food preparation areas, etc.);

3. Maintenance (major and minor);
4. Pest control;
5. Snow removal;
6. Grounds maintenance;
7. Fire Extinguishers;
8. Trash removal, recycling;
9. Renovations as required to meet State licensing regulations; and
10. Security in the form of locking the facility.

C. Additional License Fees: In addition to the License Fee payable under Paragraph 4 (A), the Licensee shall pay to the County a share of the cost of debt service incurred by the County as a result of improvements and renovations to child care facilities operated and maintained by the County as an Additional Licensee Fee (the "Additional License Fee"). The Additional License Fee shall be equal to One Dollar and Seventy-Nine Cents (\$1.79) per square foot for an annual rate of Four Thousand Four Hundred and Five Dollars and Nineteen Cents (\$4,405.19) payable in equal monthly installments of Three Hundred Sixty-Seven Dollars and Nine Cents (\$367.09).

The Additional License Fee shall be due and payable in the same manner and on the same day as the License Fee. The cost of debt service shall be determined annually by (1) adding all Capital Improvement Program costs for all County-owned and County-maintained child care facilities; (2) multiplying the total cost by the average effective annual repayment rate for twenty (20) year bonds; and (3) dividing that result by the total square footage allocated to the county maintained child care facilities.

D. Waiver of Additional License Fees: Pursuant to the Policy on Use of County Buildings for Child Care, attached hereto and made a part hereof, as **Exhibit C**, a waiver on the repayment of debt service and the Additional License Fee, as stated above in Paragraph 4(C) shall be granted by the County to the Licensee provided that Fifty-one percent (51%) or

more of families served by the Licensee are eligible for or enrolled in the State of Maryland or Montgomery County subsidy programs.

E. Failure to Pay License Fees: If the Licensee fails to submit the monthly License Fee or Additional License Fee payments in the manner as provided for above (collectively the "License Fee Payment"), and if the failure continues for more than ten (10) calendar days after the first day of the month for which the License Fee Payment is due and payable, the Licensee will pay to the County, in addition to and as a part of the License Fee Payment in question, a late penalty of five percent (5%) of the monthly Licensee Fee Payment. If the Licensee's failure to pay continues for more than twenty (20) calendar days after a monthly payment becomes due and payable the Licensee will pay to the County, in addition to and as a part of the License Fee Payment in question, a late penalty of fifteen percent (15%) of the monthly License Fee Payment. If the Licensee's failure to pay continues for more than thirty (30) calendar days after a monthly License Fee Payment becomes due and payable, the County will have the right to terminate this License Agreement, recover possession of the Licensed Premises and pursue any other legal remedies available to the County under all applicable federal, state and local laws.

5. USE OF THE LICENSED PREMISES:

A. The Licensee must use the Licensed Premises only for the provision of infant and child care services and those activities related to such services.

B. The Licensee must abide by any and all rules and regulations concerning the operation of its Program, which may, from time to time, be issued by the County. The Licensee agrees to abide by any and all rules and regulations concerning the operation of the building of which the Licensed Premises are a part, which may from time to time, be issued by the County or the owner operator of the building.

C. The Licensee must implement its Program in the manner set forth in the Providers Child Care Proposal and in its presentation to the Child Care Selection Committee.

D. The Licensee must implement its Program in accordance with any and all applicable state, local and federal laws pertaining to the operation of Child Care Centers and must maintain its license or certification to provide such services in accordance with the requirements of the entity issuing such license or certification.

6. ASSIGNMENT: The Licensee must not assign, transfer, mortgage or otherwise encumber this License or sublet or rent (or permit a third party to occupy or use) the Licensed Premises or any part of the Licensed Premises.

7. USE OF OUTDOOR PLAYGROUND AREAS: The Licensee shall have access to and the right to use the outdoor playground areas (if any) adjacent to the Licensed Premises when used by the Licensee in connection with its Program and during its normal hours of operation. Repair, maintenance and replacement of playground equipment will be the responsibility of the party that provided such playground equipment as described on the Licensed Premises Equipment Inventory attached as **Exhibit D**.

8. LICENSED CAPACITY: The Licensee acknowledges and agrees that the Licensed Premises can be licensed for no more than the maximum number of children permitted by the Maryland State Department of Education Office of Child Care Licensing. The Licensee agrees that a Certificate of Licensed Capacity will be posted in the Licensed Premises at all times.

9. PRIORITY PLACEMENT: The Licensee must provide children of County employees with priority placement in the Licensee's Program.

10. SPECIAL CONDITIONS: In addition to establishing priority placement for children of County employees, the Licensee must:

A. Comply with the Americans with Disabilities Act and all federal, state and local laws regarding providing access and services to disabled persons for the interior of the Licensed Premises and is not related to the building which is Licensor's responsibility;

B. Share its Program enrollment data with the County;

C. Accept children whose parents participate in state or local subsidy programs;

D. Maintain reports relating to the Licensee's license(s) or certification(s) as a child care provider for inspection and evaluation for County and parental review;

E. Maintain compliance with all licensing requirements of its Program, whether state, local or federal; and

F. Obtain in a timely manner and then continue to maintain accreditation of its Program by the Maryland State Department of Education or the National Association for the Education of Young Children.

11. IMPROVEMENTS AND ALTERATIONS: The Licensee must not permit or undertake any alterations, changes, improvements, or additions to the Licensed Premises without the prior written consent of the County ("Licensee's Work"). In order to secure the County's approval of any Licensee's Work, the Licensee must submit to the County written plans and specifications clearly setting forth Licensee's Work to be performed. The plans and specifications for Licensee's Work submitted by the Licensee to the County must demonstrate compliance with all applicable codes and regulations. The County will respond in writing to the Licensee within forty-five (45) days from receipt of said plans and specifications for Licensee's Work. The County may impose any reasonable conditions to its consent, including, but not limited to (1) delivery to the



County by the Licensee of written or unconditional waivers of mechanic's and materialman's liens as to the Licensed Premises or the premises of which the Licensed Premises are a part, for all work, labor and services to be performed and materials to be furnished, signed by all contractors, subcontractors, materialmen and laborers participating in the alterations; (2) prior approval of the plans and specifications and the Licensee's contractors with respect to any Licensee's Work; and (3) the right of the County's representatives to inspect any Licensee's Work during the course of any Licensee's Work to be performed to the Licensed Premises or the premises of which the Licensed Premises are a part. Licensee's Work must conform to the requirements of the County's insurer and of the federal, state and local governments having jurisdiction over the premises of which the Licensed Premises are a part, and must be performed in accordance with the terms and conditions of this License in a good and workmanlike manner and shall not adversely affect the value, utility, or character of the Licensed Premises or the premises of which the Licensed Premises are a part. Notwithstanding the foregoing, if any mechanic's or materialmen's lien is filed against the Licensed Premises or the premises of which the Licensed Premises are a part, for work claimed to have been done for, or materials claimed to have been furnished to or for the benefit of the Licensee, such lien must be discharged of record by the Licensee within sixty (60) days of payment or the filing of any bond required by law. If the Licensee fails to discharge any such lien, the County may (but is not obligated to) discharge the same, the cost of which must be paid by the Licensee upon demand by the County.

The County reserves the right to reject, in its sole discretion, any Licensee's Work proposed by the Licensee. The County will inspect the Licensed Premises upon completion of Licensee's Work to determine adherence to submitted plans and specifications. In the event that Licensee's Work is not reasonably satisfactory to the County, the Licensee must undertake any necessary corrections, at the Licensee's sole risk and expense. Once the consent of the County has been obtained to perform Licensee's Work, the Licensee will be responsible for the acquisition of any and all necessary permits and for the observation of all building and zoning ordinances and regulations then in effect. The Licensee's failure to adhere to any such applicable ordinances or regulations shall be deemed to be a violation of this License Agreement. The cost of any Licensee's Work shall be borne solely by the Licensee.

12. SERVICES:

A. The Licensee, at its risk and expense, will be responsible for the provision of telephone services to the Licensed Premises, as deemed necessary by the Licensee.

B. The County will be responsible, through the Montgomery County Board of Education, for providing to the Licensed Premises regular janitorial services on County workdays as specified in Article 4, Paragraph (B), including refuse removal, recycling, and pest control. Any janitorial services beyond regular County services will be the responsibility of the Licensee. If pest control is required after normal working hours, the Licensee or the Licensee's representative must be available if requested by the County.

C. The County will provide fire extinguishers where needed.

D. The County will be responsible for the payment of utilities necessary for the operation of the building (if applicable) of which the Licensed Premises are a part.

E. The County will be responsible for maintenance of the grounds immediately adjacent to the building of which the Licensed Premises are a part.

F. The County will be responsible for snow and ice removal or treatment of walkways and the parking areas, as it becomes necessary.

G. The County will deliver an ADA compliant Licensed Premises and will be responsible for all renovations required to meet state licensing regulations.

H. The County will be responsible for major structural repairs, and maintenance and repair of the building's mechanical systems.

I. The License Premises will have air conditioning and heat in the License Premises at the same level as provided to the Glen Haven Elementary School.

J. The County and the Licensee agree that the County's maintenance responsibilities, as set forth in items (B), (C), (D), (E), (F), (G), (H) and (I) of this Section will be performed by the County, through the Montgomery County Board of Education, at the County's expense. On days when the County is not required to provide such services, and the Licensee chooses to continue its use of the Licensed Premises it shall do so by contacting directly with the Inter-Agency Coordinating Board ("ICB") for necessary support services. It will be the responsibility of the Licensee to pay for such additional support services on the days that the County or the Montgomery County Board of Education are not required to provide such services either directly to the ICB or through the County. The address of the ICB is 255 Rockville Pike, Suite 201, Rockville, Maryland 20850. Main Office Number: 240-777-03114.  
[cupf@montgomerycountymd.gov](mailto:cupf@montgomerycountymd.gov)

13. FIXTURES AND EQUIPMENT: All items which are attached to the building, or are a part of the building's systems at the time the Licensed Premises are delivered to the Licensee, must remain with the building and shall be delivered to the Licensee along with the Licensed Premises. Plumbing, electrical and heating fixtures and all other fixtures, except trade fixtures, installed by the Licensee shall remain in the Licensed Premises at end of term. All other items installed within the Licensed Premises at the Licensee's expense shall remain the property of the Licensee and shall be removed by the Licensee at the expiration or other termination of this License. The Licensee must repair any damage caused by reason of the removal of the Licensee's property. Any personal property remaining within the Licensed Premises after termination of the License will become property of the County. The County will dispose of any such property in the manner it deems appropriate.

14. LIABILITY, PROPERTY DAMAGE AND FIRE INSURANCE:

A. Insurance: The Licensee agrees to obtain and maintain, during the full term of this License, any Renewal Terms, and until all of the Licensee's obligations which survive termination of this License have been completed, a policy or policies of insurance issued by an insurance company or companies licensed in the State of Maryland and acceptable to the County containing the types of insurance coverages and limitations set forth in the Insurance Requirements, attached hereto as Exhibit E, which is incorporated by reference and made a part of this License Agreement.

B. Licensee's Owned Contents: The Licensee must provide evidence of property, fire, theft and vandalism coverage for their owned contents and any improvements to the Licensed Premises. Coverage shall be on a replacement cost basis for "all risks of direct physical loss or damage except as specifically excluded." The County does not provide any coverage for Licensee's owned contents and improvements to the Licensed Premises.

C. County's Insurance: The County will maintain its normal fire and liability insurance on the Licensed Premises. The County reserves the right to self-insure.

D. Certificate of Insurance: The Licensee must, within thirty (30) days from execution of this License Agreement, deliver to the County a certificate(s) of insurance evidencing the coverages required under this License Agreement. The certificates must be issued to: Montgomery County, Maryland, Department of General Services, Office of Real Estate, 101 Monroe Street, 9th Floor, Rockville, Maryland 20850.

E. Additional Insured: The Licensee's General Liability Policy must list Montgomery County, Maryland as an additional insured and all insurance policies obtained by the Licensee as required by this License Agreement must provide that the Licensee will give the County written notice of amendment, cancellation, termination or

non-renewal, no later than forty-five (45) days prior to amendment, cancellation, termination or non-renewal. The Licensee must provide on an annual basis evidence that is satisfactory to the County of the insurance coverages required under this License Agreement.

F. Subrogation: If a casualty or other occurrence which should be covered by the insurance required by this License Agreement occurs, the Licensee must look solely to its insurer for reimbursement and the Licensee must ensure that such insurance is so written that the Licensee's insurer waives all rights of subrogation and shall have no cause of action against the County, its agents, or employees as a result of such casualty or occurrence. The Licensee waives and releases all right of recovery which it might otherwise have against the County or its agents or employees by reason of any loss or damage resulting from such casualty or other occurrence, to the extent that the Licensee would be covered by insurance if the Licensee complied with the requirements of this License Agreement pertaining to insurance.

G. Security System: In the event the County engages the services of a professional security system for the Licensed Premises or the premises of which the Licensed Premises are a part, it is understood that such engagement in no way increases the County's liability for occurrences and/or consequences which such a system is designed to detect or avert and that the Licensee must look solely to its insurer as set forth above for claims for damages or injury to any person or property.

15. HOLD HARMLESS: The Licensee agrees to hold harmless and defend the County from and against any and all claims of liability, actions, damages and expenses arising out of or related to the Licensee's breach of this License Agreement or use or possession of the Licensed Premises occasioned wholly or in part by any act or omission of the Licensee, its agents, contractors, guests or employees, except such claims arising solely from the negligent acts or omissions of the County, the County's employees,

agents and contractors. The Licensee further specifically agrees to hold the County harmless and defend the County from and against any claim of public liability made in connection with any construction or installation of equipment performed by the Licensee, its agents, employees or contractors, within the Licensed Premises, notwithstanding that any such construction or equipment may or may not be deemed to be a part of the Licensed Premises, or such construction or installation of equipment shall have been approved by the County.

16. RESPONSIBILITIES OF LICENSEE: The Licensee covenants and agrees as follows:

A. The Licensee must not keep gasoline or other flammable material or any explosive within the Licensed Premises which will increase the rate of fire insurance on the Licensed Premises beyond the ordinary risk established for the type of operations described in Article 5. Any such increase in the insurance rate due to the presence of gasoline, other flammable material or explosives, or due to the Licensee's operations within the Licensed Premises, must be borne solely by the Licensee. The Licensee must not willfully do any act or thing in or about the Licensed Premises which may make void or voidable any insurance on the Licensed Premises or the premises of which the Licensed Premises are a part, and the Licensee must conform to all rules and regulations established from time to time by the County, the Maryland Insurance Rating Bureau, or any other authority having jurisdiction over such matters.

B. The Licensee must not use or allow the Licensed Premises or any part of the Licensed Premises to be used for any illegal, unlawful or improper purpose or for any act or thing that may be a nuisance, annoyance, inconvenience, or cause damage to the Licensed Premises, the premises of which the Licensed Premises are a part, adjacent properties or the adjacent neighborhood. The Licensee agrees that it will supervise and

conduct its activities in a manner to ensure no disruption to the learning environment of the school, school activities or operations.

C. The Licensee must not place upon the Licensed Premises any placard, sign, lettering or awning except in such place and manner as shall have been first approved in writing by the County.

D. The Licensee acknowledges that all responsibilities of the Licensee relating to the use or misuse of the Licensed Premises shall be construed to include use or misuse of the Licensed Premises by the Licensee's agents, employees, patrons and residents.

E. The Licensee must not have animals in or about the Licensed Premises. This provision does not limit the Licensee or the Licensee's clients, employee's or guest's right to have bona fide service animals on the Licensed Premises. The Licensee is solely responsible for the proper care of service animals in the Licensed Premises and in keeping the Licensed Premises clean and free of debris and waste associated with the care and feeding of service animals.

F. The Licensee must comply with all rules and regulations with regard to the use of the Licensed Premises that may be from time to time promulgated by the County or the Montgomery County Board of Education. Any violation of said rules and regulations will be deemed to constitute a violation of this License. It is understood that such rules and regulations will not unreasonably interfere with or prevent the intended uses of the Licensed Premises as set forth in this License.

G. The Licensee must maintain in good condition, and promptly and diligently repair any damage to (or replace if reasonably necessary in the circumstances), any trade fixtures, except as provided for in Article 12.

H. The Licensee must close and lock all entrance doors and windows in the Licensed Premises when the Licensed Premises are not in use. Further, before closing and leaving the Licensed Premises at any time, the Licensee must close all windows and doors and secure the Licensed Premises. The Licensee must not place any additional locks or bolts of any kind upon any of the entrance or interior doors or windows. The Licensee must not change any existing locks without prior written approval of the County. In the event an approved change is made to the existing locks, the Licensee must provide the County with keys to the new locks. Upon the termination of this License Agreement, the Licensee must return all keys of the building, offices, and bathrooms, either furnished to, or otherwise procured by, the Licensee to the County. In the event of the loss of any keys provided to the Licensee, the Licensee must pay the County the cost such keys and/or locks.

I. The Licensee must establish and post in the Licensed Premises an appropriate fire evacuation plan and hold fire drills as required. All occupants of the Licensed Premises must be trained regarding the safe and proper operation of all appliances and equipment in the Licensed Premises.

J. The Licensee is responsible for on site management of the Licensed Premises and must keep posted, in a conspicuous place within the Licensed Premises, the Licensee's responsibilities and obligations as specified in Articles 12 and 16 of this License. The Licensee must keep a copy of this License at the Licensed Premises and ensure the Licensee's on site representative is adhering to the terms and conditions of this License.

K. The Licensee must indemnify, defend and hold the County and the County's other tenants, licensees, agents and employees (together the "Indemnities") harmless from and against all liabilities, obligations, damages, judgments, penalties,



claims, costs, charges and expenses, including, without limitation, reasonable architects' and attorney's fees, which may be imposed upon, incurred by, or asserted against any of the Indemnities and arising, directly or indirectly, out of or in connection with (i) The Licensee's breach of its obligations under this License; (ii) the acts or negligence of the Licensee, its agents, contractors, and employees in the premises or on the Licensed Premises; and (iii) the use or occupancy of the Licensed Premises, and by the Licensee, its agents, servants, employees and contractors. In case any action or proceeding is brought against any of the Indemnities by reason of any of the foregoing, the Licensee must reimburse the County the cost of defending such action or proceeding, or upon the County's written demand and at the Licensee's sole cost and expense, the Licensee must defend such action and proceeding by counsel approved by the County. Licensee shall have no liability under this paragraph to the extent any matter described herein results from the negligent acts or omissions of the County or the County's employees or contractors.

L. The Licensee must not strip, overload, damage, or deface the Licensed Premises or any part of the premises of which the Licensed Premises are a part, including, but not limited to, hallways, stairways, or elevators. The Licensee will not permit any waste to, in or upon the Licensed Premises or any part of said building.

M. The Licensee must not permit any trade or occupation to be carried on or use made of the Licensed Premises outside the scope of this License (Article 5). Further the Licensee agrees to and must obey any and all federal, state, county and local laws and regulations relating to their operation of business on and in the Licensed Premises and premises of which the Licensed Premises are a part.

N. The Licensee must not move any furniture or equipment which is the property of the County into or out of the Licensed Premises without the County's prior written consent.

O. The Licensee must pay all of its bills and expenses relating to its use of the Licensed Premises on time and must not permit any disruption in any service, including but not limited to, utilities, to any portion of the Licensed Premises.

P. The Licensee agrees to provide all paper towels, hand soap and toilet tissue in its restrooms, if the restrooms are located within the Licensed Premises.

Q. The Licensee agrees to take appropriate measures to conserve and efficiently use energy and other resources (i.e., heat, cooling, water, and utilities). The Licensee agrees to abide by the Montgomery County Board of Education's standards, policies, rules and regulations for operating and maintaining schools attached hereto and incorporated herein, as Exhibit F, "Resource Conservation Policy and Guidelines".

R. The Licensee agrees to abide by emergency orders requiring that the school facility or school facilities and central offices be closed, during which time no programs will operate in the school.

S. The Licensee agrees that the County and the Board of Education have the authority to review the records of the Maryland Child Care Administration relating to Licensee's operation as permitted by law.

T. The Licensee verifies and acknowledges that the person executing this License on behalf of the Licensee has the legal authority to bind the Licensee to the duties and obligations set forth in this License. The Licensee further verifies and acknowledges that such person's signature creates a binding obligation on the part of the Licensee for the term of this License.

U. The Licensee verifies and acknowledges that it is in good standing and/or qualified to do business in the State of Maryland.

V. The Licensee agrees to and must perform any and all obligations under this License in a timely manner.

X. Upon removal of the Licensee's property from the Licensed Premises, the Licensee at its sole expense must repair any damage to the Licensed Premises caused by such removal so that the Licensed Premises are in substantially the same condition as at the commencement of the License Term, reasonable wear and tear excepted.

17. DESTRUCTION OF LICENSED PREMISES:

A. In the event of damage to or destruction of the Licensed Premises or any part of the Licensed Premises by fire, storm, flood or other casualty which does not require the Licensee to suspend entirely its business, the County shall, as soon as practicable after said damage or destruction, repair and restore the Licensed Premises to the condition they were in immediately prior to said damage or destruction. Should such damage or destruction of said premises or any substantial part of the Licensed Premises render the Licensed Premises wholly unavailable for use by the Licensee for use as a child care facility, the County shall promptly begin and diligently pursue the repairing, restoration and rebuilding of the Licensed Premises as nearly as possible to the condition they were in immediately prior to such damage or destruction or with such changes or alterations as the County may determine appropriate. In the alternative, the County may terminate this License within thirty (30) days following the date of the destruction of the Licensed Premises as described above by sending a termination notice to the Licensee.

B. In the event of damage to or destruction of fifty percent (50%) or more of the building of which the Licensed Premises are a part, the County may elect not to

restore the said building and this License shall automatically terminate and the Parties shall be discharged from all responsibilities arising under this License.

18. DEFAULT: The Licensee shall be considered in default of this License Agreement and the County may terminate this License Agreement upon the occurrence of any of the following:

- i. Failure to perform under any term, covenant or condition of this License;
- ii. The commencement of any action or proceeding for the dissolution or liquidation of the Licensee, or for the appointment of a receiver or trustee of the Licensee's property;
- iii. The making of any assignment for the benefit of the Licensee's creditors;
- iv. The abandonment of the Licensed Premises by the Licensee;
- v. The revocation or suspension of the Licensee's license or certification as a child care provider by the issuing entity; and
- vi. Any other default or breach of the terms and conditions this License.

With respect to any matters described in (i) and (vi) of this Section 18 that does not involve the payment of money to the County, Licensee shall have a period of fifteen (15) business days following written notice from the County to cure such default.

19. EMINENT DOMAIN: The Licensee is not entitled to any condemnation award granted to the County as owner of the Licensed Premises. In the event that the Licensed Premises shall be taken by any governmental or quasi-governmental authority pursuant to its power of eminent domain or sold under threat of such taking, the Licensee will not be entitled to recover from the County any capital expenditures for improvements and betterments made by the Licensee to the Licensed Premises at the Licensee's expense.

20. RIGHT OF ENTRY:

A. Routine Repairs and Inspection: The Licensee must permit the County, its agents or employees, at reasonable times and upon reasonable prior notice (not less than 1 days/24hours prior notice) to enter the Licensed Premises without charge and without diminution of License Fee payments to: (1) examine, inspect and protect the Licensed Premises; (2) to perform maintenance and repairs the County may in its sole discretion consider necessary or desirable; and (3) to exhibit the Licensed Premises to prospective purchasers, tenants, licensees or to present or future mortgagors.

B. Emergency Access: In cases of emergency involving imminent risk of injury or death to persons or damage to property, the County, its agents or employees without prior notice to the Licensee, may enter the Licensed Premises, however the County will attempt, but is not required to notify the Licensee of any such entry under this section as soon as is practicable under the circumstances.

21. RETURN OF LICENSED PREMISES:

A. At the conclusion of the License Term as set forth in Article 2, or following the termination of this License for any other cause, the Licensee must remove all of the Licensee's goods and effects from the Licensed Premises and return to the County all keys, locks, and other fixtures belonging to the County, in good repair, reasonable wear and tear excepted.

B. The Licensee must return the Licensed Premises to the County in the same condition as received at the beginning of the License Term, in "broom clean" condition, reasonable wear and tear excepted.

C. In the event that Licensee's property is not removed from the Licensed Premises within seventy-two (72) hours after the termination of this License, the property remaining will become the property of the County.

D. Following termination of this License, the Licensee must remove any and all signs erected by or on behalf of the Licensee and must pay for or repair any damage caused by the installation or removal of such signage.

E. At the time of termination of this License and at the County's option, the Licensee must participate in a walk-through with the County's agent or employee to inspect the Licensed Premises.

22. NOTICE OF ACCIDENTS, DEFECTS OR DAMAGES: The Licensee must give the County prompt verbal notice of accidents in or damages to the Licensed Premises and, within twenty-four (24) hours following the occurrence of such accident or damage, the Licensee must follow-up with a detailed written report to the County of such accidents or damages.

23. COMPLIANCE WITH LAWS: It is understood, agreed and covenanted by and between the Parties that the Licensee, at the Licensee's expense, will promptly comply with, observe and perform all of the requirements of all of the codes, statutes, ordinances, rules, orders and regulations now in effect or later promulgated whether required by the Federal Government, State of Maryland, Montgomery County Government and the municipality in which Licensed Premises are located, Montgomery County Department of Environmental Protection or Montgomery County Fire Marshal's Office.

24. WAIVER: The waiver of at any time by either of the Parties of any particular covenant, condition, obligation, or duty under this License shall extend to the particular case only, and for the particular time and in the particular manner specified, and such waiver must not be construed or understood as waiving any further or other rights of either Party.

25. NON-DISCRIMINATION: The Licensee agrees to comply with the non-discrimination in policies in County contracts as required by Section 11B-33 and Section 27 of the Montgomery County Code (2014), as amended, as well as all other federal, state and local laws and regulations regarding employment discrimination. By signing this License Agreement, the Licensee assures the County that in accordance with applicable law, it does not, and agrees that it will not engage in any discrimination in violation of the above sections of the Montgomery County Code as well as any other federal, state or local laws, rules and regulations.

26. PUBLIC EMPLOYMENT: The Licensee understands and agrees that unless authorized under Sections 11B-52 and Chapter 19A of the Montgomery County Code (2014), as amended, that it is unlawful for any person or entity transacting business with Montgomery County, Maryland, to employ a public employee for employment contemporaneous with his or her public employment.

27. MAILING NOTICES: All notices required or desired to be given in accordance with this License by either party must be given by first class mail with a nationally recognized receipted delivery service, postage prepaid, addressed to the County or the Licensee, respectively. Notices to the Parties must be addressed as follows:

Licensee:  
Bright Eyes, Inc.  
5123 Pegasus Court, Suite H  
Frederick, Maryland 21704  
Attn: Diane Holzberger  
Executive Director

County:  
Montgomery County, Maryland  
Office of Real Estate  
Department of General Services  
101 Monroe Street, 9<sup>th</sup> Floor  
Rockville, Maryland 20850  
Attn: Director of Real Estate

With a copy, that does not constitute Notice to:  
Montgomery County, Maryland  
Office of the County Attorney  
101 Monroe Street, 3<sup>rd</sup> Floor  
Rockville, Maryland 20850  
Attn: County Attorney

28. RESIDENT AGENT: The Resident Agent for the Licensee is Paul Holzberger and its address for receipt of notices and service of process is 5123 Pegasus Court, Suite H, Frederick., Maryland 21704. The Licensee must immediately notify the County of any change in resident agent or resident agent's address.

29. PROHIBITION OF HAZARDOUS SUBSTANCES: The Licensee agrees not to store or bring hazardous substances onto the Licensed Premises. The Licensee indemnifies the County against any and all claims of any personal injuries or personal and real property damage as a result of any hazardous substance being brought on the premises by the Licensee, its agents, contractors, employees or guests.

30. NON-APPROPRIATION: This License shall terminate automatically on July 1 of any year for which the County, for whatever reason does not appropriate funds to pay the County's obligations provided in this License. The Licensee shall not make or be entitled to any claim for reimbursement of any kind, whether for improvements or prepaid items.

31. AMERICAN DISABILITIES ACT REQUIREMENTS: The County and the Licensee agree that any future modifications made to the Licensed Premises will be made in conformance with the requirements of the Americans with Disabilities Act, the Federal Fair Housing Act, and all safety and accessibility requested in Federal, State and County Laws and regulations. The Licensee must obtain all required permits to make any modifications to the Licensed Premises and must comply with all applicable building and safety codes.

32. SEX OFFENDER LAW: The Licensee agrees to be in compliance with Maryland laws regarding registered sex offenders. A registered sex offender is prohibited from entering onto real property used for a public or non-public elementary or secondary school or on property on which is located a "a licensed child care facility" (§11-722 of Criminal Procedure Article, Md. Ann. Code (2014 Replacement Volume)). The Licensee shall require that any person/contractor/subcontractor that enters a contract to provide



services at the Licensed Premises will not knowingly employ an individual to work at a school if the individual is a registered sex offender.

33. PESTICIDES USE IN SCHOOL: The Licensee agrees to be in compliance and to follow procedures regarding the regulations regarding integrated pest management in schools, labeled ECF-RB, entitled, "Pesticide Use in Schools", attached hereto and incorporated herein as Exhibit "G".

34. RECYCLING: The Licensee agrees to be in compliance and to follow procedures regarding the regulations regarding recycling in schools, labeled Regulation ECF-RC, entitled, "Recycling", attached hereto and incorporated herein as Exhibit "H."

35. CONTRACT SOLICITATION/BROKER'S FEES OR COMMISSIONS:  
The Licensee represents that it has not retained anyone to solicit or secure this License from the County upon an agreement or understanding for a commission, percentage, brokerage or contingent fee, except for bona fide employees or bona fide established, licensed, commercial selling or leasing agencies maintained by the Licensee for the purpose of securing business or an attorney rendering professional legal services consistent with the applicable canons of ethics of the profession.

36. FORCE MAJEURE: Neither Party will be deemed in default with respect to the performance of any terms, covenants, and conditions of this License if same shall be due to any strike, lockout, civil commotion, war-like operation, invasion, rebellion, hostilities, military or upsurged power, sabotage, inability to obtain any material or service, through natural or other cause beyond the control of either party; provided, however, that this provision shall not excuse any non-payment of License Fees. For purposes of this provision, lack of funds shall not be considered a cause beyond the control of a Party.

37. ENTIRE AGREEMENT: This License (which contains and includes the Exhibits) is the entire agreement between the Parties, and no representations, inducements, or agreement, oral or otherwise, between the Parties not contained in this License shall be of any force or effect.

38. MODIFICATION: This License (other than the Rules and Regulations, which may be changed from time to time) must not be modified in any manner except by an instrument in writing executed by both Parties with the same formality as this License.

39. GOVERNING LAW: This License and its performance is to be governed, interpreted, construed and regulated by the laws of Montgomery County and the State of Maryland.

40. CLAIMS: Any action brought by or on behalf of either Party in connection with the performance of this License must be filed and maintained in a court of competent jurisdiction in Montgomery County, Maryland.

41. INDEMNITY BOND: Upon the request of the County, concurrent with the effective date of this License or at any time during the term of this License, the Licensee must obtain and maintain an executed miscellaneous indemnity bond in the amount of the annual rent for the current License Term to remain in full force and effect throughout the remainder of the License Term as security for the Licensee's faithful performance of all terms and conditions of this License. The County shall have the right, but not the obligation, to request such a bond from the Licensee. The County, in its sole discretion, may accept an appropriate substitute surety. The Licensee must, within fifteen (15) business days from the date of the request by the County, deliver to the County, the said surety, evidencing the coverage stated in this Paragraph. Failure to deliver the bond or surety as required is considered by the County to be a default under this License. The Parties agree that the Licensee shall only be required to obtain this Indemnity Bond following an uncured event of default as set forth in Paragraph 18 of this License.

42. PARKING: The Licensee has use of the parking facilities which are a part of the Licensed Premises as of the date of execution of this License, which use shall be determined by the current Principal. Parking for the Licensee and any other occupants of the building, their staff, clients and guests will be confined to the surfaced parking areas in existence as of the date of execution of this License.

43. INDEMNIFICATION: Any indemnification given in this License by the County is subject to the notice requirements and damages limitations stated in the Local

Government Tort Claims Act, Md. Code Ann., Cts. & Jud. Proc. §§ 5-301, et seq. (2015 Repl. Vol.) (the "LGTCA"); Md. Code Ann. Art. 25A, § 1A (2015 Repl. Vol.); and Md. Code Ann., Cts. & Jud. Proc. § 5-509 (2015 Repl. Vol.), (together the "County Indemnification Statutes"), all as amended from time to time, and that any indemnification given by the County in this License is not intended to create any rights or causes of action in any third parties or to increase the County's liability above the caps provided in the County Indemnification Statutes, as applicable.

44. REMEDIES. The rights stated herein and in the License are cumulative and not in limitation of any rights of the County or the Licensee granted in the License or available at law or in equity to the parties, all of which are expressly reserved.

45. ACKNOWLEDGMENT OF AUTHORITY. The County acknowledges that it has the power and the authority to enter into this License and that no consent from the Board of Education of Montgomery County is required in connection with the execution and delivery of this License Agreement by the Parties.

SIGNATURES ON THE FOLLOWING PAGE

IN WITNESS WHEREOF, the Parties have caused this agreement to be properly executed.

WITNESS:

By: 

LICENSEE:  
BRIGHT EYES, INC.

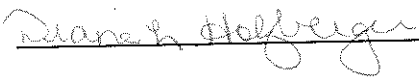
By:   
Its: President, Bright Eyes

Date: 2/14/17

WITNESS:

By: 

COUNTY:  
MONTGOMERY COUNTY,  
MARYLAND

By:   
Ramona Bell-Pearson  
Assistant Chief Administrative  
Officer

Date: 2/22/17

APPROVED AS TO FORM & LEGALITY  
OFFICE OF THE COUNTY ATTORNEY

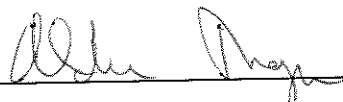
By: 

Date: 1/17/17

RECOMMENDED

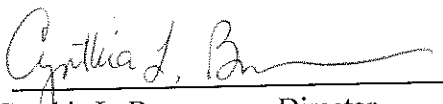
By:   
Cynthia L. Brenneman, Director  
Office of Real Estate

Date: 1/13/17

# EXISTING FIRST FLOOR PLAN

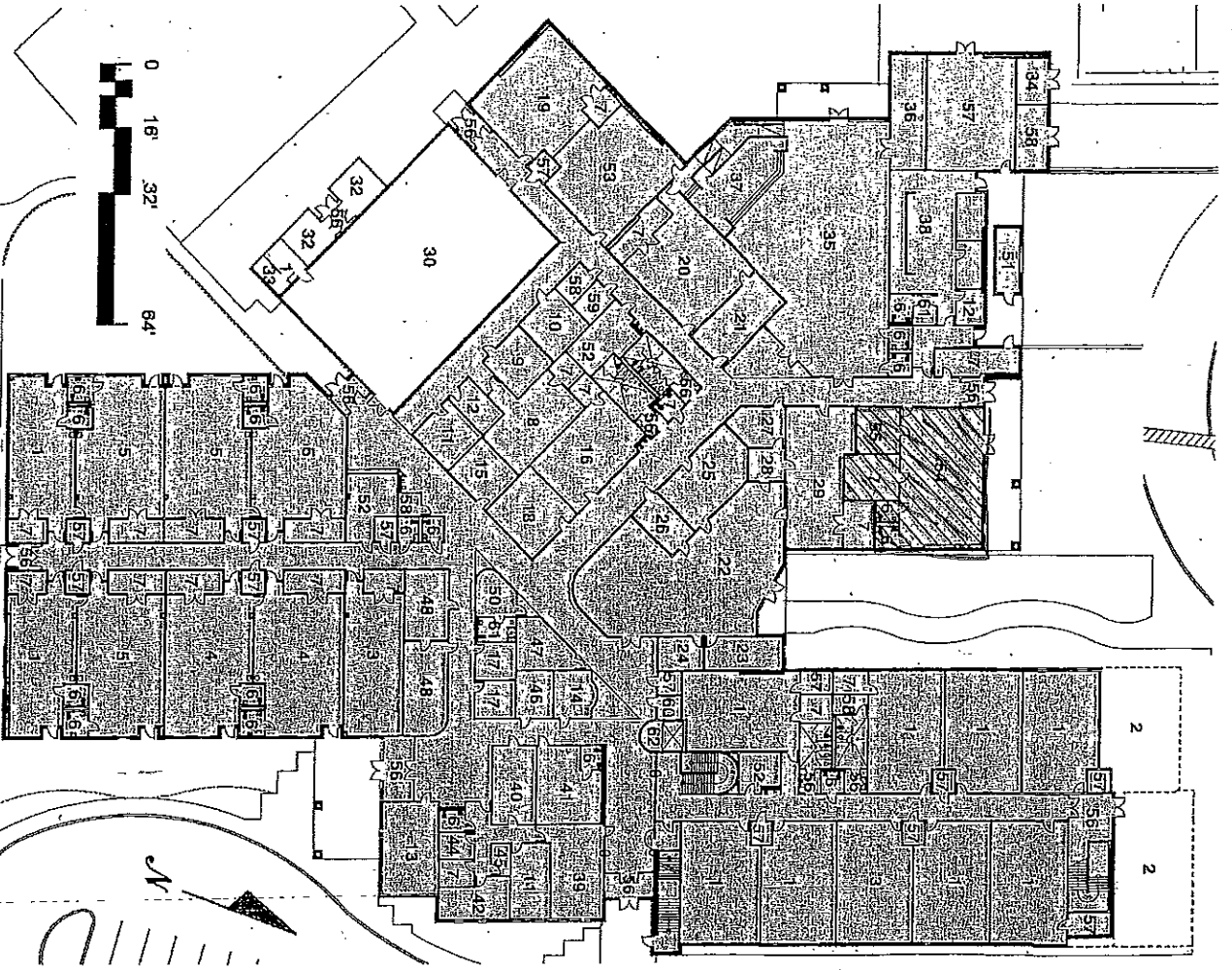

LEGEND	
#	ROOM NAME
1	CLASSROOM
2	MASTER PLANNED CLASSROOM
3	SPECIAL EDUCATION
4	PRE-KINDERGARTEN
5	KINDERGARTEN
6	TOILET
7	STORAGE
8	RESOURCE
9	SPEECH/LANGUAGE
10	THERAPY/SUPPORT
11	CONFERENCE
12	OFFICE
13	TITLE 1 PARENT RESOURCE
14	TESTING/CONFERENCE
15	MATH ASSESSMENT/RECORDS
16	READING/LANGUAGE ARTS
17	SUPPORT STAFF OFFICE
18	ESOL
19	ART
20	MUSIC
21	INSTRUMENTAL MUSIC
22	RESOURCE/CIRCULATION
23	MATERIALS PREPARATION
24	MEDIA OFFICE
25	MEDIA STORAGE
26	TEXTBOOK STORAGE
27	CONTROL/STORAGE
28	HEAD END EQUIPMENT
29	COMPUTER LAB
30	EXG. GYMNASIUM
31	EXG. OFFICE
32	EXG. STORAGE
33	EXG. TOILET
34	OUTSIDE STORAGE
35	MULTIPURPOSE
36	TABLE/CHAIR STORAGE
37	STAGE
38	KITCHEN
39	GENERAL OFFICE
40	WORKROOM
41	HEALTH
42	PRINCIPAL OFFICE
43	RECORD
44	TELEPHONE
45	STAFF DEVELOPMENT OFFICE
46	COUNSELOR OFFICE
47	STAFF WORKROOM
48	STAFF LOUNGE
49	BUILDING SERVICES
50	TRASH
51	GENERAL STORAGE
52	DUAL PURPOSE
53	DAYCARE
54	OFFICE/FOOD PREPARATION
55	VESTIBULE
56	MECHANICAL
57	ELECTRICAL
58	JANITOR
59	EQUIPMENT
60	DRESS
61	ELEVATOR

- ☒ NEW CONSTRUCTION
- ☐ EXISTING TO BE RENOVATED
- ☒ FUNDED BY DEPT. OF HEALTH & HUMAN SERVICES

Glen Haven Elementary School

EXHIBIT B  
CHILD CARE PROPOSAL

"Procedure for Implementing the Revised Policy  
for Waivers of Capital Cost Fee"

In the February 1991 Fee Structure and Debt Service Report certain specific provisions for waiver of capital cost recovery fee were recommended for inclusion in the County policy for Rental Rates for Child Care. These recommendations were approved in April 1991.

Centers which meet any of the following criteria for waiver may apply in writing for waiver of the capital cost fee. The waiver which shall apply to the entire facility. Waiver application must be submitted at annual lease renewal.

- 1) The Center shall enroll and provide care to families eligible for or enrolled in Child Care tuition subsidy programs (D.S.S. Purchase of Care and/or Working Parents Assistance Program); Families receiving subsidy shall comprise at least 30% of licensed capacity; the provider shall accept as full tuition payment the face value of vouchers issued by the DSS Purchase of Care Program. Written verification of meeting this requirement shall be required.
- 2) The provider will serve Infants and Toddlers in Child Care, as defined by the State of Maryland Child Care licensing regulations for Group Child Care; the children served will be in space administered, operated or funded by Montgomery County Government, specifically for Infant Care and/or required by tenant selection for that specific center.

Other sites which may choose to offer care to infants are not automatically granted waiver, but will be considered on a case by case basis. Determination of waiver application will be made jointly by DFS and DFR based on demonstrated community need.

APPLICATION FOR WAIVER OF CAPITAL COST RECOVERY FEE

Indicate which waiver provision(s) your program is applying for

1. 30% Voucher Service
2. Infant Care
3. Special Needs Care

Indicate time period (this should match your annual lease term)

Start date \_\_\_\_\_

End date \_\_\_\_\_

Explain how your program meets the provisions of the waiver policy and present and present documentation for verification by County Government. (you may use additional pages as necessary).

---

---

---

---

---

---



3301 Weller Road  
Silver Spring, Maryland  
Montgomery Child Care Association

[illegible]

Policy Cancellation

Forty-Five (45) days written notice of cancellation or material change of any of the policies is required unless a greater period is required by law.

Certificate Holder

Montgomery County, Maryland  
Department of General Services  
Attention: Real Estate Department  
101 Monroe Street, 9<sup>th</sup> floor  
Rockville, Maryland 20855

**EXHIBIT E**

# POLICY

## BOARD OF EDUCATION OF MONTGOMERY

---

Related Entries: ECM, ECM-RA  
Responsible Office: Supportive Services

### Energy Conservation

#### A. PURPOSE

To ensure that Montgomery County Public Schools pursues energy conservation efforts and practices that continue to preserve our natural resources while providing a safe and comfortable learning environment for all staff and students

#### B. ISSUE

The nation is experiencing a depletion of its natural resources which include crude oil, natural gas, and other energy sources. The Montgomery County Public Schools is committed to reducing its consumption of natural resources and still improving the quality of its educational programs. The Montgomery County Board of Education desires to work with other agencies of government and plan school system activities so that the learning environment of essential education programs are not curtailed or compromised.

#### C. POSITION

1. The superintendent of schools shall continue to establish procedures to ensure the conservation of natural resources by personnel at all levels of the school system, which shall include the following practices:
  - a) Generation of a system-wide resource conservation plan that outlines goals and objectives
  - b) Development of acceptable energy conservation guidelines as outlined in the resource conservation plan
  - c) Continued development and implementation of conservation programs
  - d) Performance of energy studies on all new MCPS construction
  - e) Monitoring the general operation and maintenance of all heating, ventilation and air-conditioning equipment

1 of 2

## ***Electricity***

1. **Temperature Set Point:** The maximum cooling level is 76° F. Set thermostats accordingly. Some temperature variation will occur as equipment cycles on and off. Report cooling problems only if room temperature measured with a thermometer stays three degrees or more above or below set point.
2. **Controls:** Do not attempt to tamper with energy management or HVAC controls on equipment. Any problems with controls or equipment should be dealt with promptly through the work order system. Provide frequent inspection of pneumatic controls, including system filter/dryer, automatic bleed, and compressor run time. Test and calibrate all pneumatic thermostats at the start of each cooling season.
3. **Computers:** Shutting down computers not in use is important. Computers in our schools consume more energy than the lighting. **Teachers and students should shut down the computer at the end of each use, unless a new user is waiting.** Sweeps should be made to shut down all computers immediately after school hours and before weekends, holidays, and breaks. Use of **flat panel monitors** is encouraged whenever procuring new displays. Flat panel monitors use 70 percent less energy than CRT models and help reduce excessive heat build-up in computer labs and closets.
4. **Lights:** Teachers should ensure lights are turned off when leaving the classrooms unoccupied, even for a few minutes. Every effort should be made to avoid accidentally leaving lights on in storerooms, crawl spaces, attics, and other unoccupied spaces. Corridor lighting should be reduced in over-illuminated areas and turned off during unoccupied periods. Gym, auditorium, and stadium lights should be controlled on a tight schedule. Gym lights should be turned off during class periods when the gym is not in use.
5. **Light Levels:** Light levels may be reduced to the acceptable levels for different activities as listed on the attached chart: **Recommended Footcandle Levels.** Your SERT Energy Facilitator will provide you with instruments and instructions to successfully reduce light levels and save energy.
6. **Task Lighting:** Use a desk lamp (with compact fluorescent bulb) instead of overhead lighting as much as possible, especially at teaching stations when students are out. Computer labs should use compact fluorescent uplights (torchiere lamps) to improve visibility of computer screens, and save energy by turning out overhead lights.
7. **Lighting Maintenance:** Maintain automatic lighting controls, occupancy sensors, or daylight sensors where installed. Light fixtures and lenses should be cleaned annually and the date documented.
8. **Daylighting:** Whenever possible, teachers should utilize natural light instead

# Vending Machine Specification for Montgomery County Public Schools

Effective Date: August 1<sup>st</sup>, 2006

Application: This specification applies to all vending machines in Montgomery County Public Schools (MCPS), located inside the buildings or in outside areas surrounding the school buildings. These items include beverages, such as soft drinks, fruit juice and juice beverages, water, sports drinks; and snacks, such as cookies, crackers, chips, ice cream and candy.

References: Maryland Code, Education, Section 7-423, Division II, title 7 subtitle 4, "Health and Safety of Students"

MCPS Policy JPG: *Wellness: physical and Nutritional Health*; MCPS Regulation JPG-RA: *Wellness: physical and Nutritional Health*; MCPS Policy ECA: *Energy Conservation*

Timing Controls: Vending machines in MCPS schools must have an integrated timing device to automatically shut off operation of the machine in accordance with nutrition policies established by the Board of Education and energy conservation policy.

Automatic shut off is to include the following features:

1. Prohibit access to products
2. Turn off all lighting
3. Turn off refrigeration

## Hours of Operation

Machines containing approved items-

- Non-perishable—7:00 a.m. until midnight, with refrigeration timed to resume one hour before access.
- Perishable—Refrigeration units remain on 24 hours; however access by students is limited too 7:00 a.m. until midnight.
- Machines containing items not approved for sale during the instructional day must be programmed for automatic shutoff from midnight until the end of the instructional day. Refrigeration may be timed to resume one hour before access.
- Vending machines in teachers' lounges must be operational from 5:30 a.m. until midnight. Refrigeration may be timed to resume one hour before access.

## Approved Items:

Beverages (container size not to exceed 16 ounces except for unflavored water)

- Flavored, non-carbonated water
- 100% fruit juice
- Fruit juice beverages with a minimum 50% fruit juice
- Low fat or nonfat milk
- Sports drinks (only allowed in the immediate area of the gymnasiums)

## Snacks

- Single-serving size packages
- 7 grams or less of fat (except for nuts and seeds)
- 2 grams or less of saturated fat
- 15 grams or less of sugar (except for fruit)

## MCPs RESOURCE CONSERVATION GUIDELINES

### Heating

1. **Temperature Setpoint:** The maximum heating level is 70° F. Set thermostats accordingly and recheck monthly. Some temperature variation will occur as equipment cycles on and off. Report heating problems only if room temperature measured with a thermometer stays 3° or more below set point.
2. **Controls:** Building staff or occupants should not attempt to manually control equipment by tampering with energy management or HVAC controls of equipment. Any problems with controls or equipment should be dealt with promptly through the work order system. Provide frequent inspection of pneumatic controls, including system filter/dryer, automatic bleed and compressor run time. Test and calibrate all pneumatic thermostats at the start of each heating season.
3. **Hours:** During non-school hours, heat is furnished only for MCPs activities and user groups with reservations through the ICB/CUPF. Consolidate necessary MCPs evening activities into the minimum number of zones possible. HVAC will not be provided for an individual to use a classroom or office outside of normal hours. HVAC systems will remain off during cleaning, except when ventilation is required for waxing or stripping activities.
4. **Filters:** Replace filters of all equipment at recommended intervals. Maintain documentation per your building maintenance plan.
5. **Boiler Maintenance:** Fuel oil burners should be cleaned and tuned for optimum combustion twice yearly.
6. **Pumps:** Only one main heating pump should be operated, except where additional pumps are provided for separate zones. Do not operate main pump and standby pump at the same time.
7. **Unit Ventilators:** Maintain unit ventilators free of obstruction, such as books, plants, and furnishings, both on the top grill and at the bottom intake, so that air can circulate efficiently throughout the room.
8. **Infiltration Control:** All windows and outside doors are to be kept closed when heating systems are in operation. Corridor doors and doors to classrooms should remain closed when HVAC is provided. Doors to gyms and pools are to be kept closed. Report faulty door closers to the maintenance depot.
9. **Storage Spaces:** Close unused storage rooms and set thermostat controls, where installed, to the lowest possible temperature setting that will prevent freezing.
10. **Personal Electric Space Heaters:** Personal space heaters will not be permitted. Such units, in addition to having high energy costs, are a fire and safety hazard. Only heaters installed by the Division of Maintenance for emergency use will be permitted; others will be confiscated.

## **WATER USE**

### **GENERAL**

1. **Be alert for water leaks** and water main breaks. Look for continuous water flow through the water meter at any time, ponding of water around the building, and report leaks to maintenance immediately. A broken water main can release tens of thousands of dollars in water a week until it is repaired.
2. **Report and repair leaking faucets** and faulty flush valves promptly. Check and adjust valves for proper timing annually.
3. **Water is an MCPS resource and not to be given away** or used by outsiders. Users scheduled through ICB are allowed to use water related to their activities. Do not provide free water to road maintenance tankers or any other non-MCPS agency.
4. Do not allow local residents to use school hose bibbs or to control irrigation.
5. **Car washes may not** use school water supplies. Off-site arrangements may be made with a local gas station to hold a car wash for fund raising.
6. The utility budget pays for bottled water only in elementary school portable classrooms.

### **IRRIGATION**

These general guidelines are supplied for the education of individuals operating turf irrigation equipment to help with the successful management of healthy turf.

1. **Avoid Excess Watering.** Excessive watering promotes fungal growth and prevents the development of long, deep root systems needed for healthy turf.
  - a. **Use a simple rain gauge.** Turf in our climate needs only 1" of water per week for optimum health. Use weather reports or your school's rain gauge to determine whether irrigation is needed each week.
  - b. **With timer systems, check zones for proper saturation levels.** Make sure water saturates the root zone when irrigating but no further. No runoff should occur from the area being watered.
  - c. **Make sure irrigation systems are turned off when it rains.** The installation of rain switches on automated irrigation systems is highly recommended.
2. **Irrigate only in early morning or late evening hours.** This timing minimizes evaporation to the air.
3. **Irrigate only two or three times a week.** This interval promotes deeper root growth, which establishes healthier and sturdier turf.

## EXHIBIT "G"

ECF-RB

The Integrated Pest Management Supervisor in the Division of Maintenance will be the contact person and will manage all information on pest control efforts in the school system, including material safety data sheets and product label of each pesticide or bait station that may be used in schools, or on school grounds and site-specific information on pest control activities at each school.

### B. Notification by Schools

1. At the beginning of each school year, schools will include notice of the school's integrated pest management system in information to parents. The notice will include the following information:

- a) A statement that explains the school's integrated pest management system and a list of any pesticides or bait station that may be used in the school building or on school grounds as part of the integrated pest management system
- b) A statement that:
  - (1) The contact person maintains the product label and material safety data sheet of each pesticide or bait station that may be used by the certified applicator in buildings and on school grounds
  - (2) The label and material safety data sheet is available for review by a parent, guardian, staff member, or student attending the school
  - (3) The contact person is available to parents, guardians, and staff members for information and comment
- c) The name, address, and telephone number of the contact person
- d) Instructions for including a parent/guardian or staff member on a pesticide notification list (see Section C)
- e) Information about the opportunity to provide public comments on the Integrated Pest Management practices of the school system during the a public comments segment of each regularly scheduled Board meeting

2. After the start of each school year, written notification will be provided to each newly employed staff member in the orientation packets or to the



## EXHIBIT "G"

ECF-RB

*women and infants (less than two years old), should avoid any unnecessary pesticide exposure."*

### 2. Middle or High Schools

The Integrated Pest Management Supervisor will provide information to the school's principal, allowing sufficient time for the principal to notify students and staff. Principals will provide written notification to each parent, guardian, or staff member on the pesticide notification list, post notices at the site of the application and in conspicuous locations such as bulletin boards commonly seen by students and staff, and make an announcement on the school's public announcement system at least 24 hours before the application of a pesticide.

### 3. Space Spraying of Pesticides

a) Although space spraying of pesticides is not practiced in Montgomery County Public Schools, in the unlikely event that space spraying becomes necessary, the written notification to parents/guardians, staff, and students will be made at least one week before the space spraying.

b) The notice will be on a separate sheet of paper at least 8 1/2 inches by 11 inches in size and shall contain the following information:

- (1) Common name of the pesticide
- (2) Location of the space spraying
- (3) Planned date and time of space spraying
- (4) The following language:

*"The Office of Pesticide Programs of the United States Environmental Protection Agency has stated: Where possible, persons who potentially are more sensitive such as pregnant women and infants (less than two years old) should avoid any unnecessary pesticide exposure."*

- (5) If the pesticide is not addressed in the notice sent at the beginning of the school year, a brief description of the pesticide to be applied

## EXHIBIT "G"

ECF-RB

### E. Use of Bait Stations

Before a bait station is used in a school, the Integrated Pest Management Supervisor and/or his staff will place a notice or sign on the door of the room in which the bait station is placed indicating the date of placement, the name of the contact person for additional information including information on potential adverse effects. The notice or sign will remain posted until the bait station is removed.

### F. Public Comments

The Integrated Pest Management Supervisor or his designee will monitor and address public comments regarding the Integrated Pest Management program practices of MCPS.

*Regulation History:* New Regulation July 17, 2000.

## EXHIBIT H

ECF-RC

A. The director of the Department of Facilities Management is responsible for ensuring that the procedures outlined below are properly implemented.

1. Facility administrators for MCPS facilities will designate a building recycling coordinator to complete the following tasks:
  - a) Establish a comprehensive recycling plan for the facility. The facility administrator will endorse the recycling plan and submit a copy to the recycling material specialist prior to September 30 of each school year.
  - b) Form a team of staff, students, and community members to increase awareness of the need to recycle, build school/community support for the program, and provide oversight for compliance with the recycling plan.
2. Facility administrators will submit the name of the building recycling coordinator and a designated back-up to the recycling material specialist prior to September 15 of each school year.
3. The recycling material specialist will be responsible for assisting the building recycling coordinator and school-based staff in the implementation and maintenance of recycling programs for MCPS facilities.
4. The following items without food contamination will be recycled:
  - a) Paper
    - Office/classroom paper
    - Mixed paper
    - Magazines
    - Printer paper
    - Computer paper
    - Fax paper
    - Corrugated cardboard
    - Phone books
    - Newspaper
  - b) Other
    - Aluminum cans
    - Bi-metal (sheet and tin) cans