

A. Identification and Coding Information

1. Project Number	Agency Number	Update Code
023806	S-84.46	Change

2. Date: October 1, 2009

7. Pre PDF Pg.No.: 8. Req. Adeq. Pub. Fac.

Revised:

5. Agency: **WSSC**

3. Project Name: Clarksburg Triangle Outfall Sewer, Part 1

4. Program: **Sanitation** 6. Planning Area: Clarksburg & Vicinity P.A. 13

B. Expenditure Schedule (000's)

Cost Elements	(8) Total	(9) Thru FY '09	(10) Estimate FY '10	(11) Total 6 Years	(12) Year 1 FY '11	(13) Year 2 FY '12	(14) Year 3 FY '13	(15) Year 4 FY '14	(16) Year 5 FY '15	(17) Year 6 FY '16	(18) Beyond 6 Years
Planning, Design & Supervision	164	78	84	2	2						
Land											
Site Improvements & Utilities											
Construction	1,575	1,546	19	10	10						
Other	17		15	2	2						
Total	1,756	1,624	118	14	14						

C. Funding Schedule (000's)

Contribution/Other	1,756	1,624	118	14	14						
--------------------	-------	-------	-----	----	----	--	--	--	--	--	--

D. Description & Justification

DESCRIPTION

This project provides for the planning, design and construction of approximately 4,220 feet of 24-inch diameter outfall sewer along a tributary west of and parallel to U.S. Interstate 270 and south of West Old Baltimore Road. This sewer is projected to serve new development in Stage 3 of the Clarksburg planning area west of I-270.

Service Area Seneca Creek Drainage Basin **Capacity** 9.4 MGD **Population** 12,250

JUSTIFICATION

Plans & Studies

Clarksburg Master Plan and Hyattstown Special Study Area (1994); Montgomery County Council Resolution Number 14-772; Water and Sewer Plan Service Area Map Amendments for the Clarksburg Master Plan Area (Adopted February 13, 2001); Clarksburg Area Stage 3 and 4 Facility Plan, Rodgers Consulting (December, 2004).

Specific Data

The Cabin Branch neighborhood includes Clarksburg Triangle, and other Stage 3 properties west of I-270 and east of Clarksburg Road.

Cost Change

Not applicable.

STATUS Under Construction (WSSC Contract No. DA3326G02,).

OTHER

The project scope has remained the same. Design and construction will be performed by the developer under a System Extension Permit. Estimated completion schedule is developer dependent. No WSSC rate supported debt will be used for this project.

COORDINATION

Maryland-National Capital Park & Planning Commission, Montgomery County Department of Environmental Protection, Maryland Department of the Environment (Non-Tidal Wetlands Permit), Maryland Department of Natural Resources and U.S. Fish and Wildlife Service.

NOTE This project supports 100% Growth.

E. Annual Operating Budget Impact (000's)

Program Costs	Staff	Other	Maintenance	Debt Service	FY of Impact
Program Costs
Facility Costs			65		10
Total Costs			65		12
Impact on Water or Sewer Rate				

F. Approval and Expenditure Data (000's)

Date First in Capital Program	FY 02
Date First Approved	FY 02
Initial Cost Estimate	22
Cost Estimate Last FY	1,783
Present Cost Estimate	1,756
Approved Request, Last FY	35
Total Expenditures & Encumbrances	1,624
Approval Request FY 11	14
Supplemental Approval Request Current FY (10)	

G. Status Information

Land Status: Site or R/W acquired
 % Project Completion: C-95%
 Est. Completion Date: Developer Dependent

H. Map Map Reference Code:

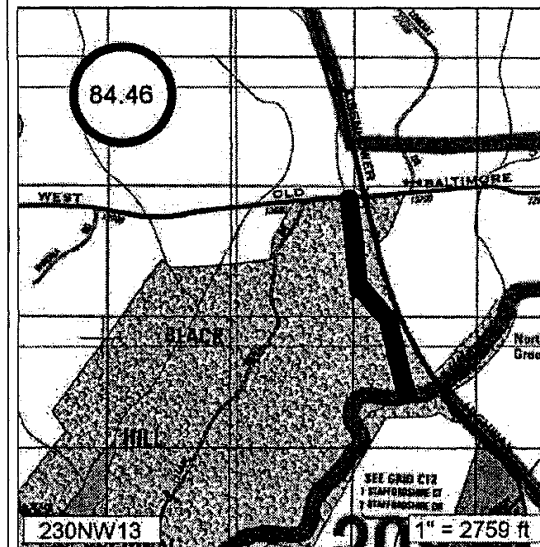

22-10