

A. Identification and Coding Information

1. Project Number	Agency Number	Update Code
083804	S-84.66	Change

2. Date: October 1, 2009

7. Pre PDF Pg.No.: 8. Req. Adeq. Pub. Fac.

Revised:

5. Agency: **WSSC**

3. Project Name: Tapestry WWPS Force Main

4. Program: **Sanitation** 6. Planning Area: **Clarksburg & Vicinity P.A. 13**

B. Expenditure Schedule (000's)

Cost Elements	(8) Total	(9) Thru FY '09	(10) Estimate FY '10	(11) Total 6 Years	(12) Year 1 FY '11	(13) Year 2 FY '12	(14) Year 3 FY '13	(15) Year 4 FY '14	(16) Year 5 FY '15	(17) Year 6 FY '16	(18) Beyond 6 Years
Planning, Design & Supervision	21	8	5	8	5	3					
Land											
Site Improvements & Utilities											
Construction	82		32	50	35	15					
Other	15		6	9	6	3					
Total	118	8	43	67	46	21					

C. Funding Schedule (000's)

Contribution/Other	118	8	43	67	46	21					
--------------------	-----	---	----	----	----	----	--	--	--	--	--

D. Description & Justification

DESCRIPTION

This project provides for the planning, design, and construction of 2,150 feet of 4-inch diameter force main to serve the Tapestry subdivision.

Service Area Seneca Creek Drainage Basin

Population 590

JUSTIFICATION

Plans & Studies

Tapestry Subdivision Hydraulic Planning Analysis (March, 2006)

Cost Change

Not Applicable

STATUS Planning

OTHER

The project scope has remained the same. Expenditures shown in Block B are planning level estimates only, and may change depending on site specific conditions and design constraints. Estimated completion date is developer dependent. No WSSC rate-supported debt will be used for this project.

COORDINATION

Montgomery County Government, Local Community Civic Associations and WSSC Project S-84.65, Tapestry Wastewater Pumping Station.

NOTE This project supports 100% Growth.

E. Annual Operating Budget Impact (000's)

FY of Impact

Program Costs	Staff	
	Other	
Facility Costs	Maintenance	33	13
	Debt Service	
Total Costs.....		33	13
Impact on Water or Sewer Rate.....			

F. Approval and Expenditure Data (000's)

Date First in Capital Program	FY 08
Date First Approved	FY 08
Initial Cost Estimate	110
Cost Estimate Last FY	113
Present Cost Estimate	118
Approved Request, Last FY	45
Total Expenditures & Encumbrances	8
Approval Request FY 11	46
Supplemental Approval Request Current FY (10)	

G. Status Information

Land Status: Not applicable
 % Project Completion: P-100%
 Est. Completion Date: Developer Dependent

H. Map Map Reference Code:

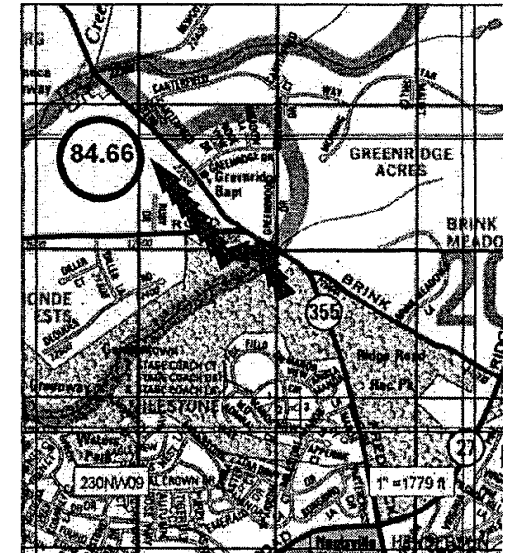

22-31