

The original of this drawing document was prepared by Soltesz, Inc. (SOLTESZ). This document was not obtained directly from Soltesz, Inc. (SOLTESZ). SOLTESZ cannot guarantee that unauthorized changes and/or alterations were not made by others. If verification of the information contained herein is needed, contact should be made directly with SOLTESZ. SOLTESZ makes no warranties, express or implied, concerning the accuracy of any information that has been transmitted by electronic means.

REFERENCE GRID  
A B C D E F G H I J K L M N O

PLANNING DEPARTMENT USE ONLY (E-PLANS)

- LEGEND:**
- ⊙ SPECIMEN TREE (GREATER THAN OR EQUAL TO 30" DBH)
  - SIGNIFICANT TREE (BETWEEN 24-29.9" DBH)
  - ⊗ TREE TO BE REMOVED
  - LOD LIMIT OF DISTURBANCE (LOD)
  - LIMITS OF FOREST STAND
  - ..... PERENNIAL STREAM
  - SVB STREAM VALLEY BUFFER
  - WETLAND
  - WB WETLAND BUFFER
  - FP FLOODPLAIN
  - ZONING LINE
  - █ EXISTING FOREST TO REMAIN
  - ▨ EXISTING FOREST TO BE REMOVED
  - ▩ REFORESTATION AREA
  - EASEMENT/RIGHT OF WAY
  - PROPERTY BOUNDARY LINE
  - TSF TREE SAVE FENCE
  - ..... RP ROOT PRUNE
  - EX CONTOUR MINOR
  - EX CONTOUR MAJOR

AREA OUTSIDE OF  
LOD TO BE USED  
FOR REFORESTATION  
& SUPPLEMENTAL PLANTING

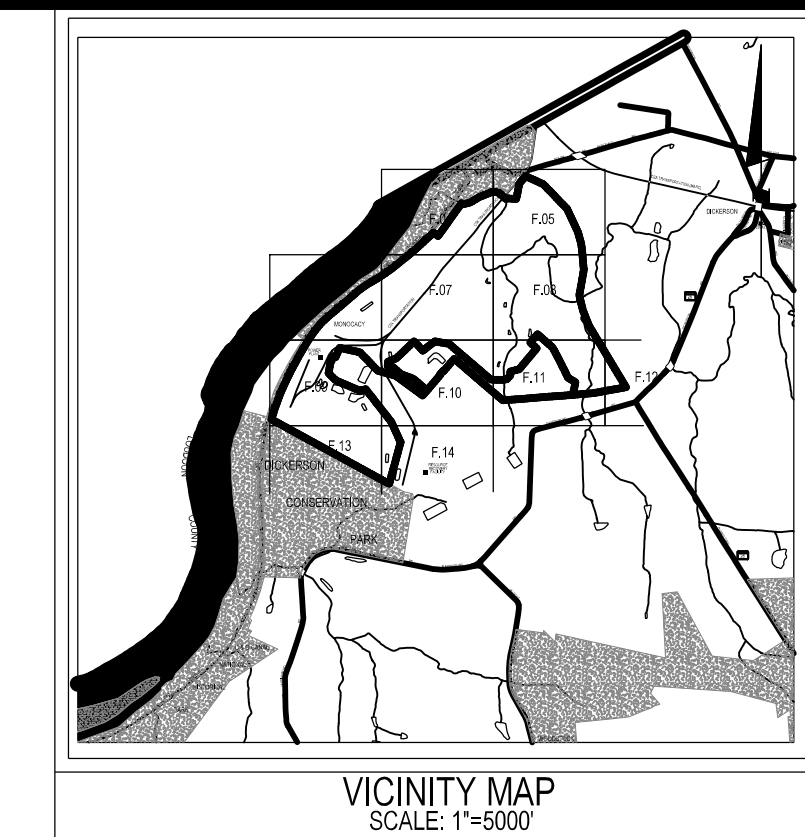

**SOLTESZ, INC.**  
 ROCKVILLE OFFICE  
 2 Research Place, Suite 100  
 Rockville, MD 20850  
 P. 301.948.2750 F. 301.948.9067  
 www.solteszco.com

Engineering  
 Surveying  
 Planning  
 Environmental Sciences

**MISS UTILITY NOTE**  
 INFORMATION CONCERNING EXISTING UNDERGROUND UTILITIES WAS OBTAINED FROM AVAILABLE RECORDS. THE CONTRACTOR MUST DETERMINE THE EXACT LOCATION AND ELEVATION OF ALL EXISTING UTILITIES AND UTILITY CROSSINGS BY USING TEST PITS BY HAND, WELL IN ADVANCE OF THE START OF EXCAVATION. CONTACT MISS UTILITY AT 1-800-251-7777 48 HOURS PRIOR TO THE START OF EXCAVATION. IF CLEARANCES ARE LESS THAN SHOWN ON THIS PLAN OR THESE 120 INCHES, WHOEVER IS LESS, CONTACT THE ENGINEER AND THE UTILITY COMPANY BEFORE PROCEEDING WITH CONSTRUCTION. CLEARANCES LESS THAN NOTED MAY REQUIRE REVISIONS TO THIS PLAN.

**OWNER / DEVELOPER / APPLICANT**  
 Terra Energy, LLC  
 13409 Strawbale Lane  
 Darnestown, MD 20878  
 540 223 3954  
 Jeffrey Ferrel

**PROFESSIONAL CERTIFICATION**  
 I HEREBY CERTIFY THAT THESE DOCUMENTS WERE PREPARED OR APPROVED BY ME AND THAT I AM A FULLY LICENSED PROFESSIONAL ENGINEER UNDER THE LAWS OF THE STATE OF MARYLAND.  
 LICENSE NO. 1074      EXPIRATION DATE: 07/10/2024

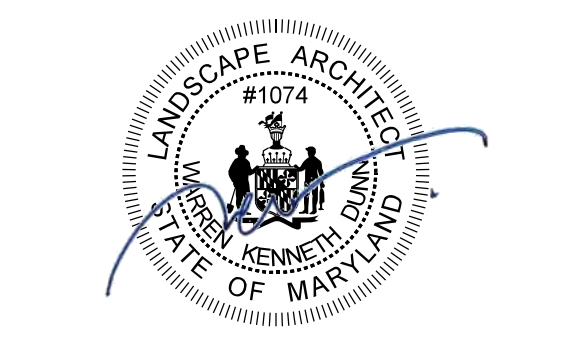

**PRELIMINARY FOREST CONSERVATION PLAN**  
**PRELIMINARY FOREST CONSERVATION PLAN**  
**DICKERSON POWER PLANT**  
**F20240620**  
 POOLSVILLE (PRD) ELECTION DISTRICT, MONTGOMERY COUNTY, MARYLAND

**DEVELOPER'S CERTIFICATE**  
 The Undersigned agrees to execute all the features of the Approved Preliminary Forest Conservation Plan No. F20240620 including, financial bonding, forest planting, maintenance, and all other applicable agreements.  
 Developer's Name: Terra Energy, LLC  
 Printed Company Name  
 Contact Person or Owner: Jeffrey Ferrel  
 Contact Person  
 Address: 13409 Strawbale Lane, Darnestown, MD  
 Phone: (540) 223-3954  
 Signature: *[Signature]*

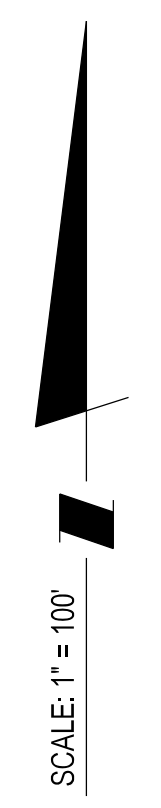
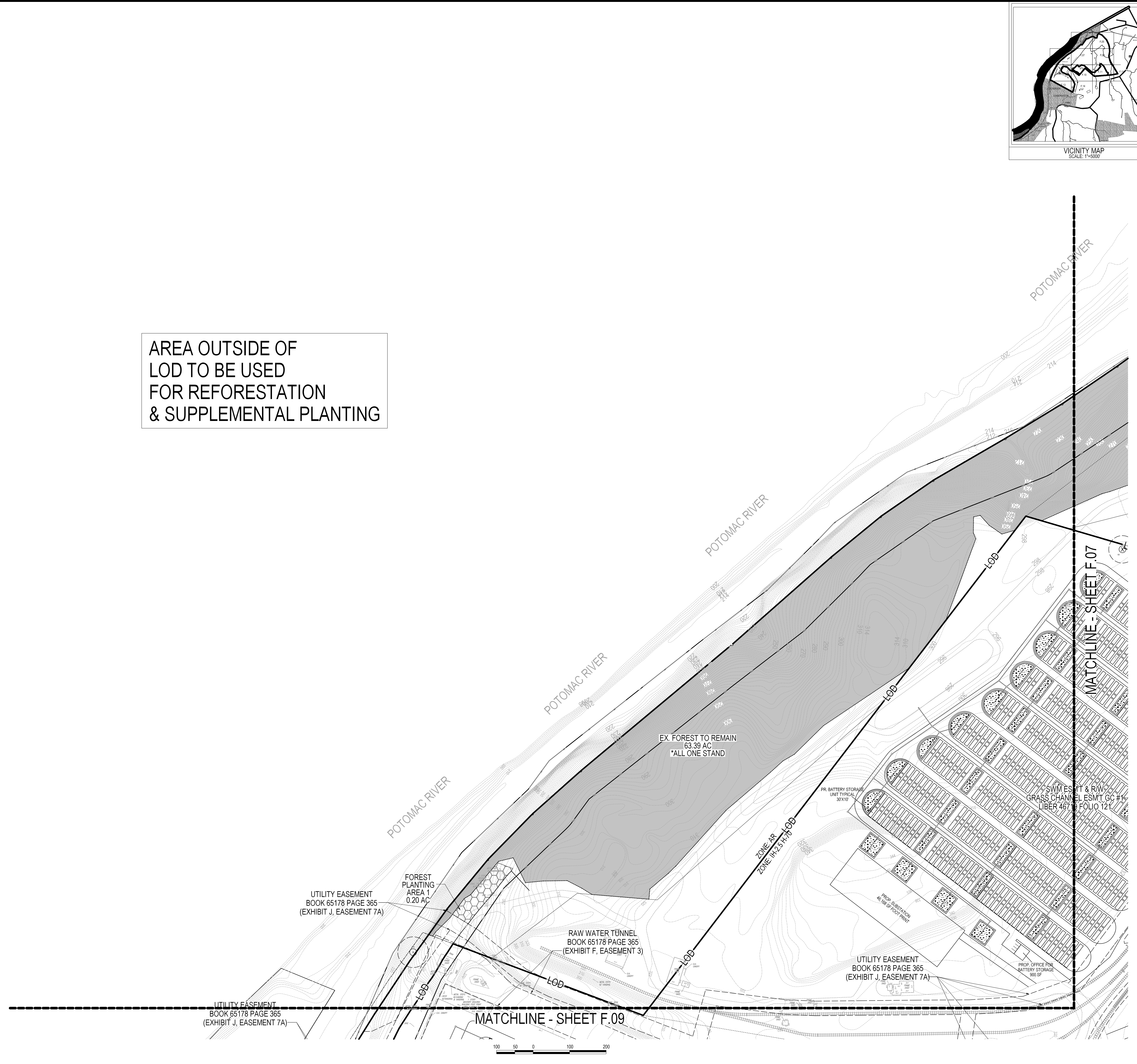

TAX MAP BV341 BV342 BV551 BV552	ZONING CATEGORY: AR IH.25 H-70
NSIC 200 SHEET 229NV22 229NE21 229NV22 229NW21	
SITE DATUM HORIZONTAL: NAD 83/91 VERTICAL: NAVD83	
DATE: 6/21/2024 DESIGNED: NC TECHNICIAN: NC CHECKED: WKD CAD STYL: V8 / NCS VERSION:	
SHEET OF F.06 F.16	
PROJECT NO. 4025-00-00	