

The original of this drawing document was prepared by Soltesz, Inc. (SOLTESZ). This document was not obtained directly from SOLTESZ, and/or it was transmitted electronically. SOLTESZ cannot guarantee that unauthorized changes and/or alterations were not made by others. If verification of the information contained herein is needed, contact should be made directly with SOLTESZ. SOLTESZ makes no warranties, express or implied, concerning the accuracy of any information that has been transmitted by electronic means.

PLANNING DEPARTMENT USE ONLY (E-PLANS)

- LEGEND:**
- ⊙ SPECIMEN TREE (GREATER THAN OR EQUAL TO 30" DBH)
 - SIGNIFICANT TREE (BETWEEN 24-29.9" DBH)
 - ⊗ TREE TO BE REMOVED
 - LOD LIMIT OF DISTURBANCE (LOD)
 - LIMITS OF FOREST STAND
 - PERENNIAL STREAM
 - STREAM VALLEY BUFFER
 - WETLAND
 - WETLAND BUFFER
 - FLOODPLAIN
 - ZONING LINE
 - EXISTING FOREST TO REMAIN
 - EXISTING FOREST TO BE REMOVED
 - REFORESTATION AREA
 - EASEMENT/RIGHT OF WAY
 - PROPERTY BOUNDARY LINE
 - TREE SAVE FENCE
 - ROOT PRUNE
 - EX CONTOUR MINOR
 - EX CONTOUR MAJOR

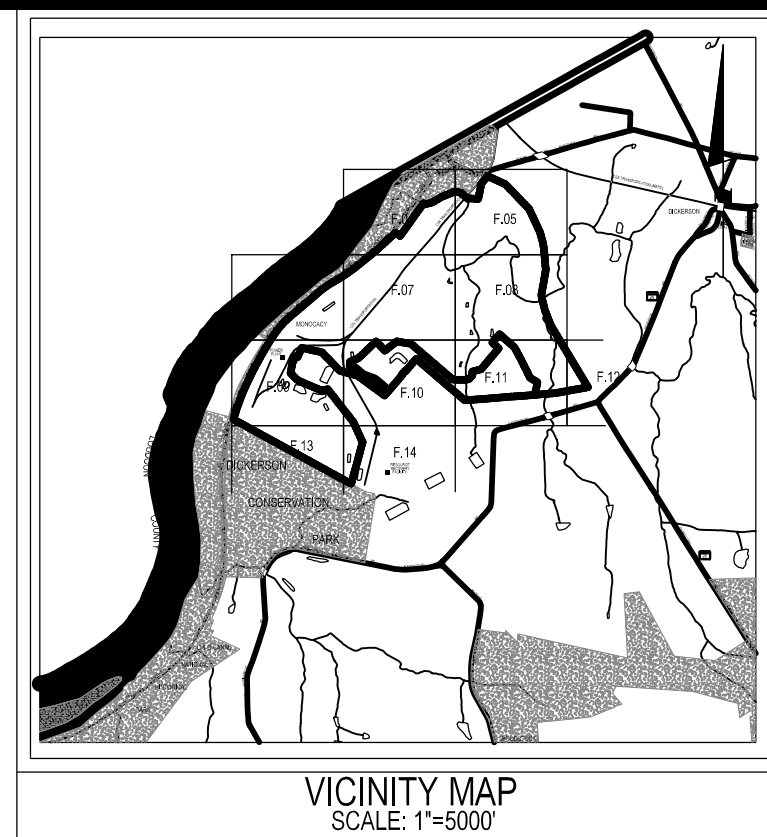
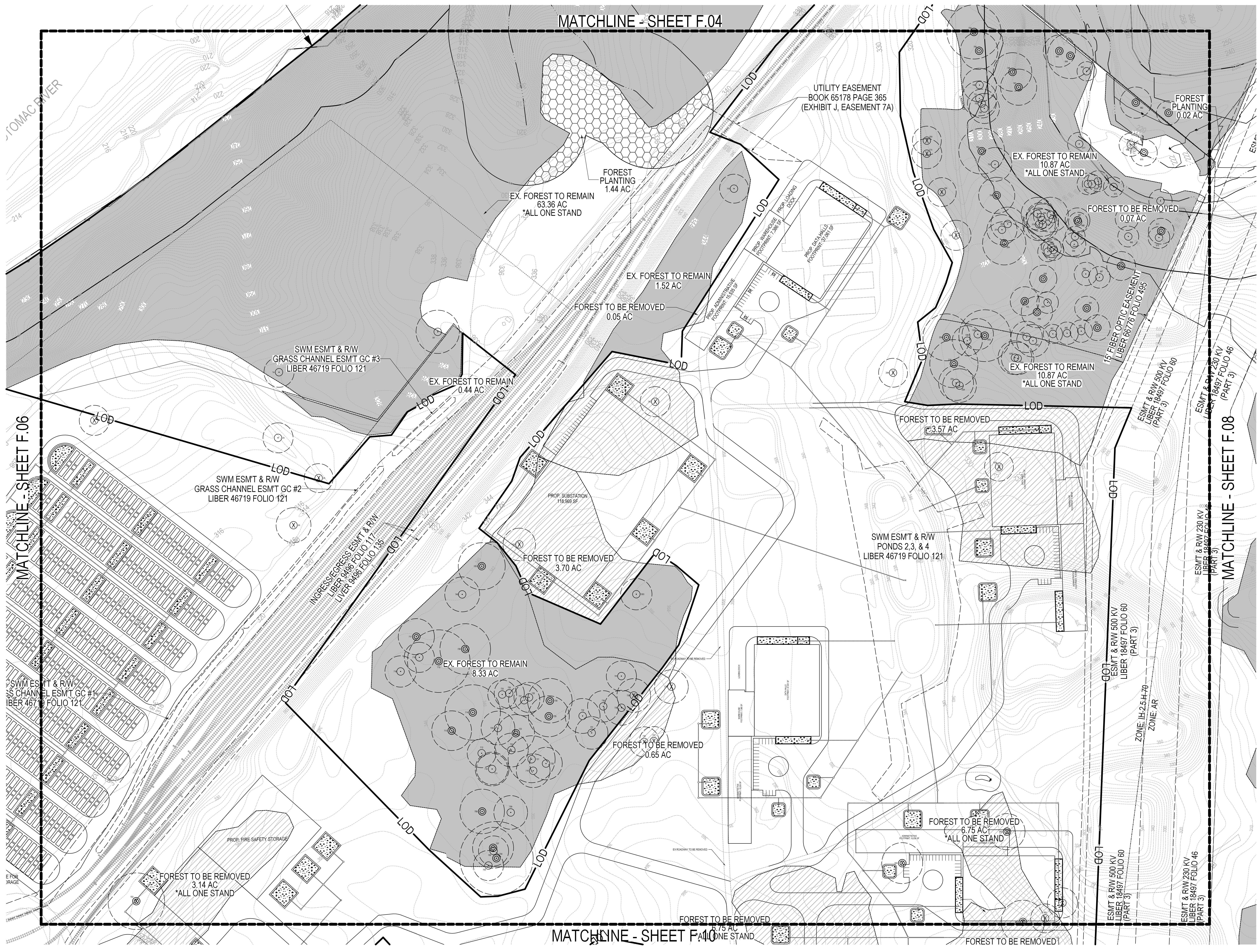
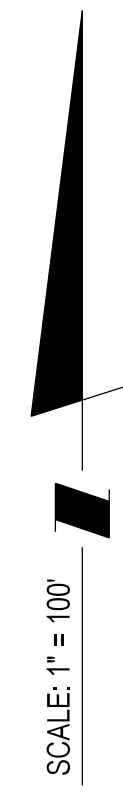

SOLTESZ, INC.
 ROCKVILLE OFFICE
 2 Research Place, Suite 100
 Rockville, MD 20850
 P. 301.948.2750 F. 301.948.9067
 www.solteszco.com

Engineering
 Surveying
 Planning
 Environmental Sciences

MISS UTILITY NOTE

INFORMATION CONCERNING EXISTING UNDERGROUND UTILITIES WAS OBTAINED FROM AVAILABLE RECORDS. THE CONTRACTOR MUST DETERMINE THE EXACT LOCATION AND ELEVATION OF ALL EXISTING UTILITIES AND UTILITY CROSSINGS BY DESIGN TEST PITS BY HAND, WELL IN ADVANCE OF THE START OF EXCAVATION. CONTACT MISS UTILITY AT 1-800-251-7777 48 HOURS PRIOR TO THE START OF EXCAVATION. IF CLEARANCES ARE LESS THAN SHOWN ON THIS PLAN OR THESE 120 INCHES, WHOEVER IS LESS, CONTACT THE ENGINEER AND THE UTILITY COMPANY BEFORE PROCEEDING WITH CONSTRUCTION. CLEARANCES LESS THAN NOTED MAY REQUIRE REVISIONS TO THIS PLAN.

OWNER / DEVELOPER / APPLICANT

Terra Energy, LLC
 13409 Strawbale Lane
 Darnestown, MD 20878
 540 223 3954
 Jeffrey Ferrel

PROFESSIONAL CERTIFICATION

I HEREBY CERTIFY THAT THESE DOCUMENTS WERE PREPARED OR APPROVED BY ME AND THAT I AM A FULLY LICENSED PROFESSIONAL ENGINEER UNDER THE LAWS OF THE STATE OF MARYLAND.
 LICENSE NO. 1074 EXPIRATION DATE: 07/10/2024

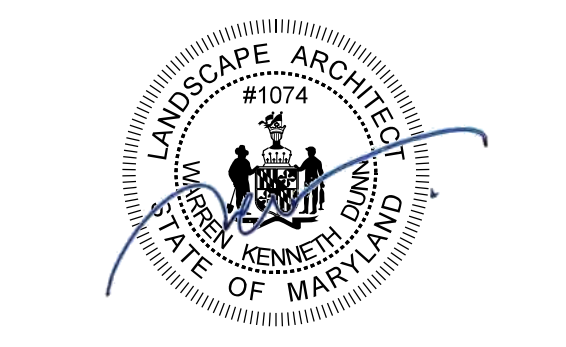

**PRELIMINARY FOREST CONSERVATION PLAN
 PRELIMINARY FOREST CONSERVATION PLAN
 DICKERSON POWER PLANT
 F20240620**

TAX MAP BV341 BV342 BV561 BV562	ZONING CATEGORY: AR IH.25 H-70
NSIC: 200 SHEET 229N022 229N21 229N022 229N21	
SITE DATUM HORIZONTAL: NAD 83/99 VERTICAL: NAVD83	
DATE: 6/21/2024 DESIGNED: NC TECHNICAL: NC CHECKED: WKD CADD STYL: V8 / NCS VERSION:	
SHEET OF F.07 F.16	
PROJECT NO. 4025-00-00	

DEVELOPER'S CERTIFICATE
 The Undersigned agrees to execute all the features of the Approved Preliminary Forest Conservation Plan No. F20240620 including, financial bonding, forest planting, maintenance, and all other applicable agreements.

Developer's Name: Terra Energy, LLC
 Printed Company Name: _____
 Contact Person or Owner: Jeffrey Ferrel
 Contact Person: _____
 Address: 13409 Strawbale Lane, Darnestown, MD
 Phone: (540) 223-3954
 Signature: _____