

The original of this drawing document was prepared by Soltesz, Inc. (SOLTESZ). This document was not obtained directly from SOLTESZ, Inc. SOLTESZ, Inc. is not responsible for any errors or omissions in this drawing. SOLTESZ, Inc. is not responsible for any errors or omissions in this drawing. SOLTESZ, Inc. is not responsible for any errors or omissions in this drawing.

REFERENCE GRID A B C D E F G H I J K L M N O

PLANNING DEPARTMENT USE ONLY (E-PLANS)

- LEGEND:**
- - 
  - 
  - 
  - 
  - 
  - 
  - 
  - 
  - 
  - 
  - 
  - 
  - 
  - 
  - 
  - 
  - 
  - 
  -

# AREA OUTSIDE OF LOD TO BE USED FOR REFORESTATION & SUPPLEMENTAL PLANTING

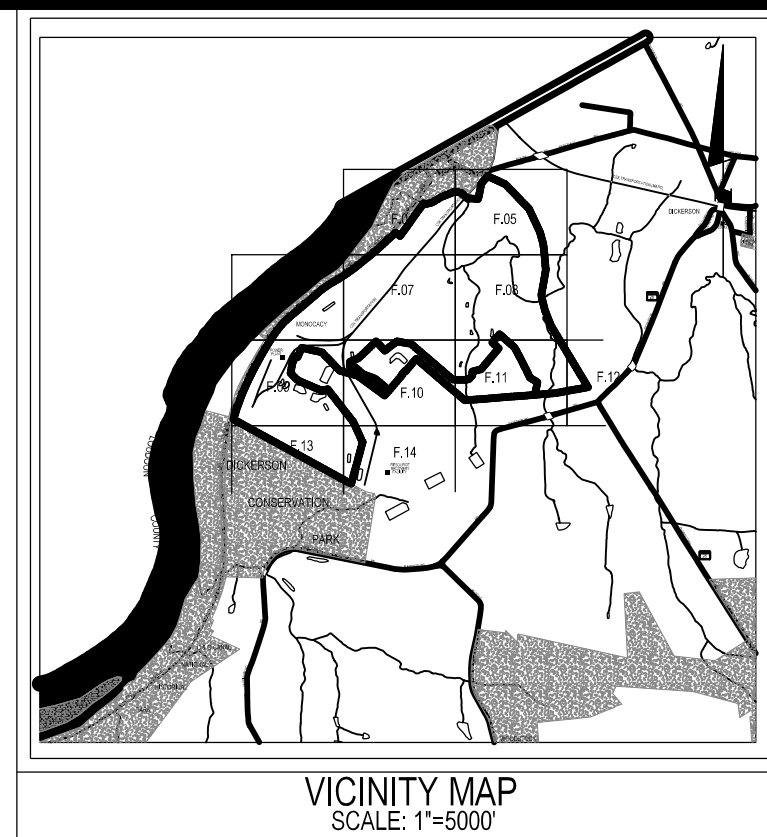

**SOLTESZ, INC.**  
ROCKVILLE OFFICE  
2 Research Place, Suite 100  
Rockville, MD 20850  
P. 301.948.2750 F. 301.948.9067  
www.solteszco.com

Engineering  
Surveying  
Planning  
Environmental Sciences

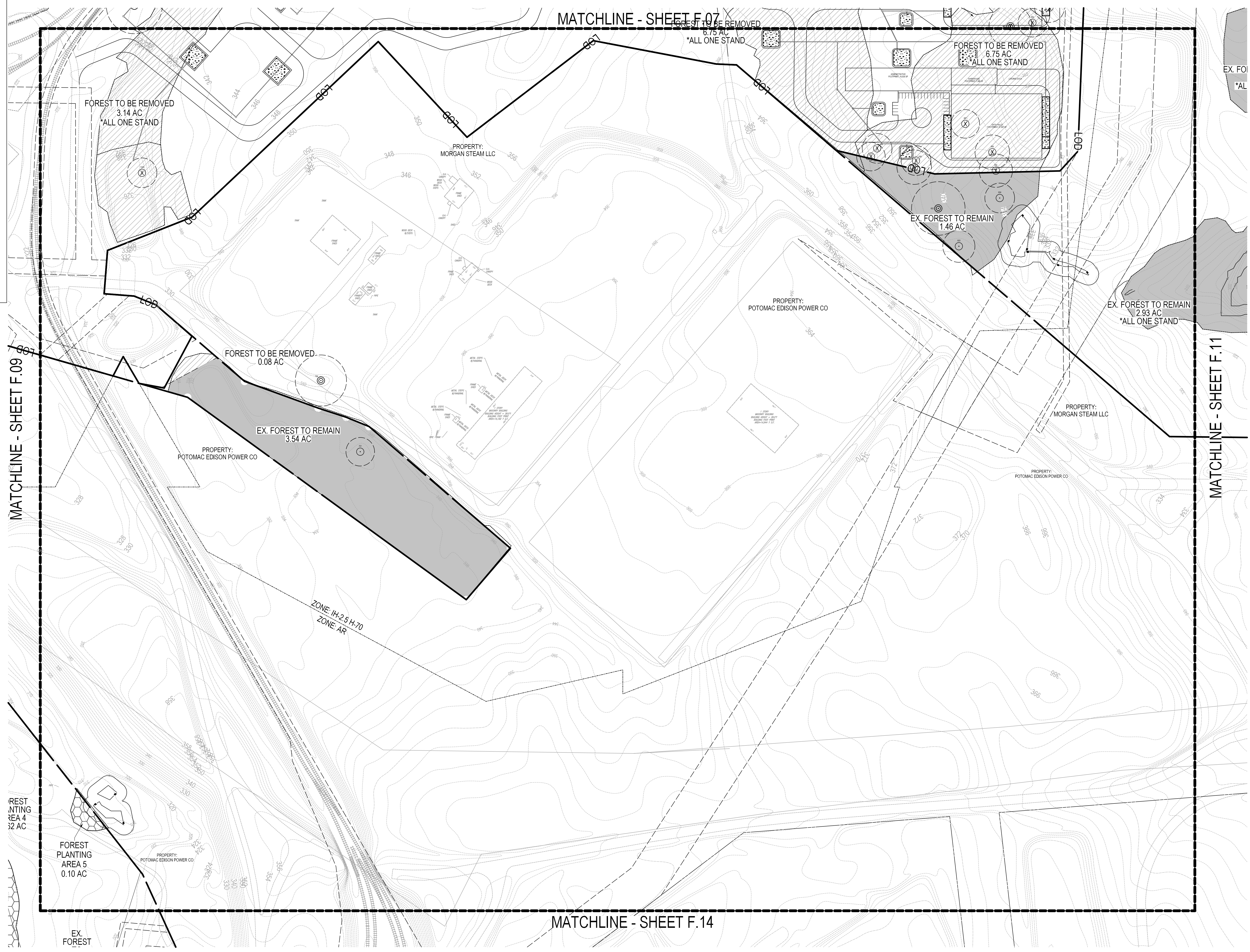

SCALE: 1" = 100'

**DEVELOPER'S CERTIFICATE**  
The Undersigned agrees to execute all the features of the Approved Preliminary Forest Conservation Plan No. F20240620 including, financial bonding, forest planting, maintenance, and all other applicable agreements.

Developer's Name: Terra Energy, LLC  
Printed Company Name

Contact Person or Owner: Jeffrey Ferrel  
Contact Person

Address: 13409 Strawbale Lane, Darnestown, MD  
Phone: (540) 223-3954

Signature: *[Signature]*

NO. REVISIONS BY DATE

**MISS UTILITY NOTE**  
INFORMATION CONCERNING EXISTING UNDERGROUND UTILITIES WAS OBTAINED FROM AVAILABLE RECORDS. THE CONTRACTOR MUST DETERMINE THE EXACT LOCATION AND ELEVATION OF ALL EXISTING UTILITIES AND UTILITY CROSSINGS BY DIGGING TEST PITS BY HAND, WELL IN ADVANCE OF THE START OF EXCAVATION. CONTACT THE UTILITY AT 1-800-251-7777 48 HOURS PRIOR TO THE START OF EXCAVATION. IF CLEARANCES ARE LESS THAN SHOWN ON THIS PLAN OR THINER THAN THE 12" MINIMUM, CONTACT THE ENGINEER AND THE UTILITY COMPANY BEFORE PROCEEDING WITH CONSTRUCTION. CLEARANCES LESS THAN NOTED MAY REQUIRE REVISIONS TO THIS PLAN.

**OWNER / DEVELOPER / APPLICANT**  
Terra Energy, LLC  
13409 Strawbale Lane  
Darnestown, MD 20878  
540 223 3954  
Jeffrey Ferrel

**PROFESSIONAL CERTIFICATION**  
I HEREBY CERTIFY THAT THESE DOCUMENTS WERE PREPARED OR APPROVED BY ME AND THAT I AM A FULLY LICENSED PROFESSIONAL ENGINEER UNDER THE LAWS OF THE STATE OF MARYLAND.  
LICENSE NO. 1074 EXPIRATION DATE: 07/10/2024

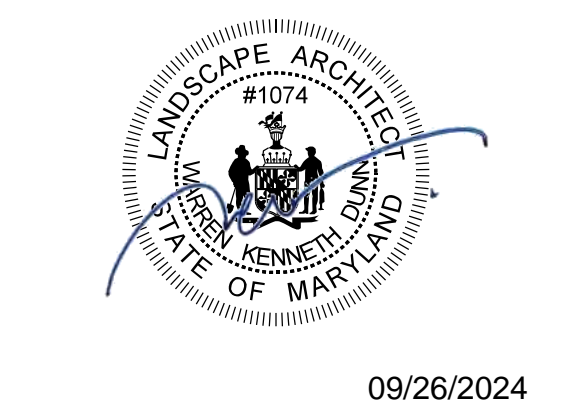

**PRELIMINARY FOREST CONSERVATION PLAN**  
**PRELIMINARY FOREST CONSERVATION PLAN**  
**DICKERSON POWER PLANT**  
**F20240620**  
POOLSVILLE (PMD) ELECTION DISTRICT, MONTGOMERY COUNTY, MARYLAND

TAX MAP BV341, BV342, BV551, BV552	ZONING CATEGORY: AR, IH-2.5 H-70
WSSC 200' SHEET 229NW22, 229NE21, 229NW22, 229NW21	DATE: 6/21/2024
SITE DATUM HORIZONTAL: NAD 83/99 VERTICAL: NAVD83	DESIGNED: NC TECHNICAL: NC CHECKED: WKD CADD STYL: V8 / NCS VERSION:
PROJECT NO. 4025-00-00	

MATCHLINE - SHEET F.14