

**AREA OUTSIDE OF
LOD TO BE USED
FOR REFORESTATION
& SUPPLEMENTAL PLANTING**

PLANNING DEPARTMENT USE ONLY (E-PLANS)

- LEGEND:**
- ⊙ SPECIMEN TREE (GREATER THAN OR EQUAL TO 30" DBH)
 - SIGNIFICANT TREE (BETWEEN 24-29.9" DBH)
 - ⊗ TREE TO BE REMOVED
 - LOC LIMIT OF DISTURBANCE (LOD)
 - LIMITS OF FOREST STAND
 - PERENNIAL STREAM
 - SVB STREAM VALLEY BUFFER
 - WETLAND
 - WB WETLAND BUFFER
 - FP FLOODPLAIN
 - ZONING LINE
 - █ EXISTING FOREST TO REMAIN
 - ▨ EXISTING FOREST TO BE REMOVED
 - ▩ REFORESTATION AREA
 - EASEMENT/RIGHT OF WAY
 - PROPERTY BOUNDARY LINE
 - TF TREE SAVE FENCE
 - RP ROOT PRUNE
 - EX CONTOUR MINOR
 - EX CONTOUR MAJOR

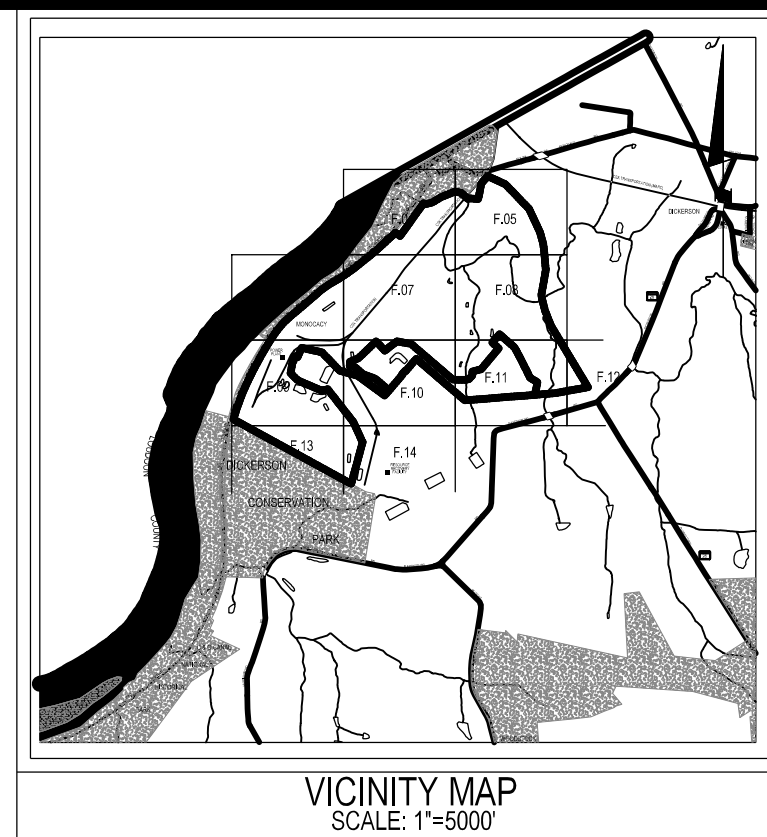

SOLTESZ, INC.
 ROCKVILLE OFFICE
 2 Research Place, Suite 100
 Rockville, MD 20850
 P. 301.948.2750 F. 301.948.9067
 www.solteszco.com

Engineering
 Surveying
 Planning
 Environmental Sciences

MISS UTILITY NOTE

INFORMATION CONCERNING EXISTING UNDERGROUND UTILITIES WAS OBTAINED FROM AVAILABLE RECORDS. THE CONTRACTOR MUST DETERMINE THE EXACT LOCATION AND ELEVATION OF ALL EXISTING UTILITIES AND UTILITY CROSSINGS BY DESIGN TEST PITS BY HAND, WELL IN ADVANCE OF THE START OF EXCAVATION. CONTACT MISS UTILITY AT 1-800-251-7777 48 HOURS PRIOR TO THE START OF EXCAVATION. IF CLEARANCES ARE LESS THAN SHOWN ON THIS PLAN OR THESE 120 INCHES, WHOEVER IS LESS, CONTACT THE ENGINEER AND THE UTILITY COMPANY BEFORE PROCEEDING WITH CONSTRUCTION. CLEARANCES LESS THAN NOTED MAY REQUIRE REVISIONS TO THIS PLAN.

OWNER / DEVELOPER / APPLICANT

Terra Energy, LLC
 13409 Strawbale Lane
 Darnestown, MD 20878
 540 223 3954
 Jeffrey Ferrel

PROFESSIONAL CERTIFICATION

I HEREBY CERTIFY THAT THESE DOCUMENTS WERE PREPARED OR APPROVED BY ME AND THAT I AM A FULLY LICENSED PROFESSIONAL ENGINEER UNDER THE LAWS OF THE STATE OF MARYLAND.
 LICENSE NO. 1074 EXPIRATION DATE: 07/10/2024



09/26/2024

**PRELIMINARY FOREST CONSERVATION PLAN
 PRELIMINARY FOREST CONSERVATION PLAN
 DICKERSON POWER PLANT
 F20240620**

POOLSVILLE (PFD) ELECTION DISTRICT, MONTGOMERY COUNTY, MARYLAND

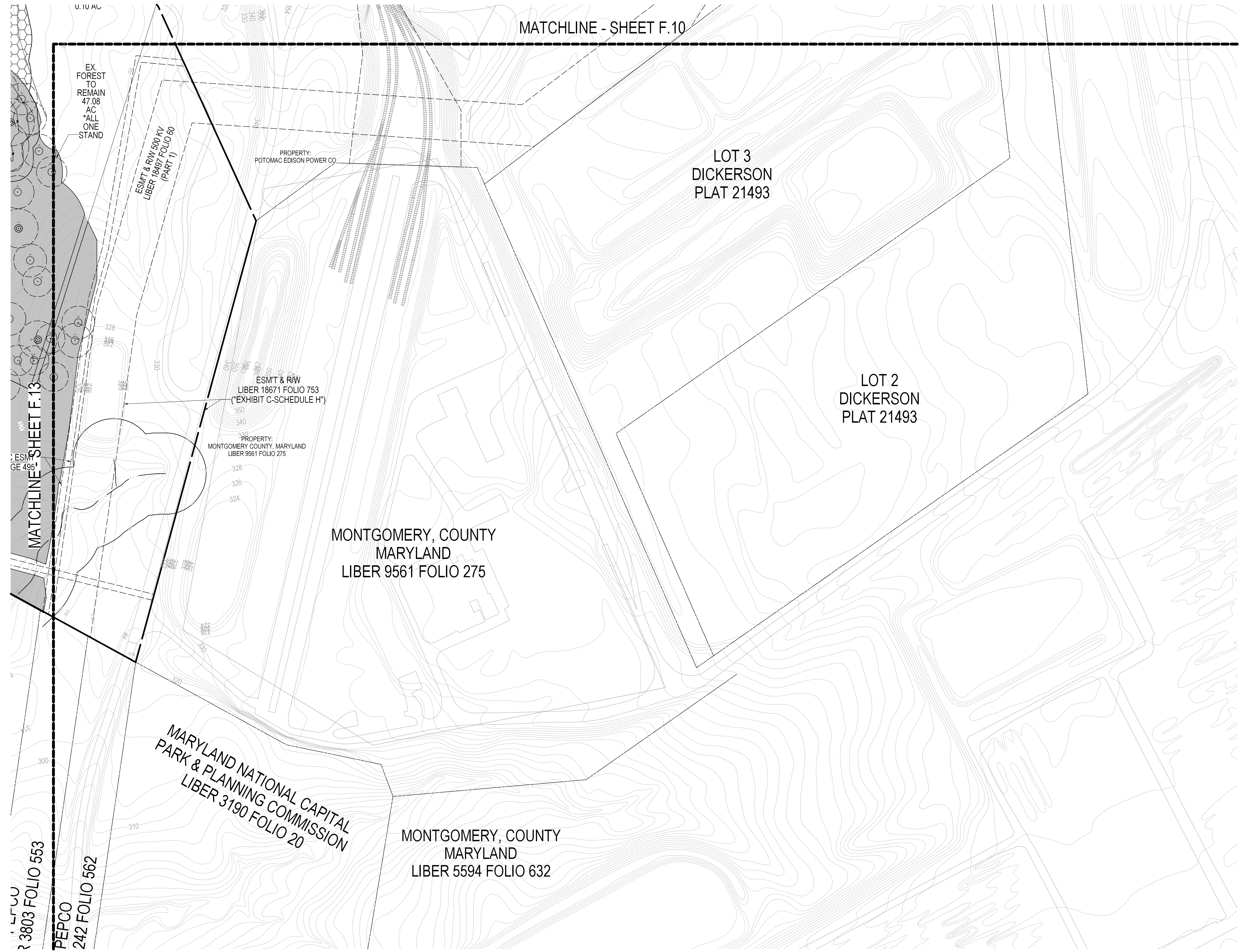

MATCHLINE - SHEET F.10

MATCHLINE - SHEET F.13

MONTGOMERY, COUNTY
 MARYLAND
 LIBER 9561 FOLIO 275

LOT 3
 DICKERSON
 PLAT 21493

LOT 2
 DICKERSON
 PLAT 21493

MARYLAND NATIONAL CAPITAL
 PARK & PLANNING COMMISSION
 LIBER 3190 FOLIO 20

MONTGOMERY, COUNTY
 MARYLAND
 LIBER 5594 FOLIO 632

PEPCO
 242 FOLIO 562

3803 FOLIO 553

SCALE: 1" = 100'



DEVELOPER'S CERTIFICATE
 The Undersigned agrees to execute all the features of the Approved Preliminary Forest Conservation Plan No. F20240620 including, financial bonding, forest planting, maintenance, and all other applicable agreements.

Developer's Name: Terra Energy, LLC
 Printed Company Name

Contact Person or Owner: Jeffrey Ferrel
 Contact Person

Address: 13409 Strawbale Lane, Darnestown, MD
 Phone: (540) 223-3954

Signature: *Jeffrey Ferrel*

TAX MAP BV341 BV342 BV561 BV562	ZONING CATEGORY: AR, IH,25 H-70
WSSC 200' SHEET 228NW22, 228NE21 228NW22, 228NW21	
SITE DATUM HORIZONTAL: NAD 83/99 VERTICAL: NAVD83	
DATE: 6/21/2024 DESIGNED: NC TECHNICIAN: NC CHECKED: WKD CAD STYL: V8 / NCS VERSION:	
SHEET F.14 OF F.16	
PROJECT NO. 4025-00-00	

The original of this drawing document was prepared by Soltesz, Inc. (SOLTESZ). This document was not obtained directly from SOLTESZ, Inc. SOLTESZ, Inc. cannot guarantee that unauthorized changes and/or alterations were not made by others. If verification of the information contained herein is needed, contact should be made directly with SOLTESZ, Inc. SOLTESZ makes no warranties, express or implied, concerning the accuracy of any information that has been transmitted by electronic means.