



APPROVED - 420240750

Joshua Penn
12/08/23

PLANNING DEPARTMENT USE ONLY (E-PLANS)

LEGEND

- NRI/FSD STUDY AREA
- TOTAL TRACT AREA
- EXISTING TREELINE
- SOILS BOUNDARY
- MONOCACY RIVER WATERSHED
- POTOMAC RIVER WATERSHED
- STEEP SLOPES 15-25%
- STEEP SLOPES 25% OR GREATER
- SENSITIVE SPECIES PROJECT REVIEW AREA
- HISTORICAL RESOURCE
- EXISTING PERENNIAL STREAM
- EXISTING INTERMITTENT STREAM
- APPROXIMATE OFF-SITE STREAM CENTERLINE
- EXISTING NON-TIDAL WETLAND
- 25' WETLAND BUFFER
- STREAM VALLEY BUFFER
- FEMA 100-YEAR FLOODPLAIN
- FOREST STAND BOUNDARY
- APPROX FOREST STAND DATA POINT LOCATION
- SPECIMEN TREE LOCATION WITH CRITICAL ROOT ZONE
- SIGNIFICANT TREE LOCATION WITH CRITICAL ROOT ZONE

NOTE: THE NRI/FSD IS ONLY VALID FOR AREAS WITHIN THE STUDY AREA BOUNDARY. ANY DISTURBANCE OUTSIDE THIS AREA WILL REQUIRE A NEW NRI/FSD

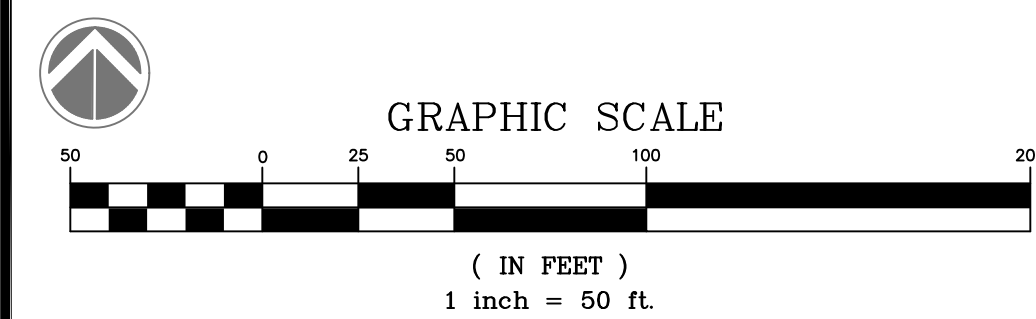

QUALIFIED PROFESSIONAL CERTIFICATION
THIS PLAN COMPLIES WITH THE CURRENT REQUIREMENTS OF MONTGOMERY COUNTY CODE AND THE ENVIRONMENTAL TECHNICAL MANUAL.

SIGNED: *Joshua Penn* DATE: 11/29/2023

HALEY KELLY
WETLAND STUDIES AND SOLUTIONS, INC.
1131 BENFIELD BOULEVARD, SUITE L
MILLERSVILLE, MD 21104
PH: (703) 679-5745 FAX: (410) 672-5993
E-MAIL: HKELLY@WETLANDS.COM

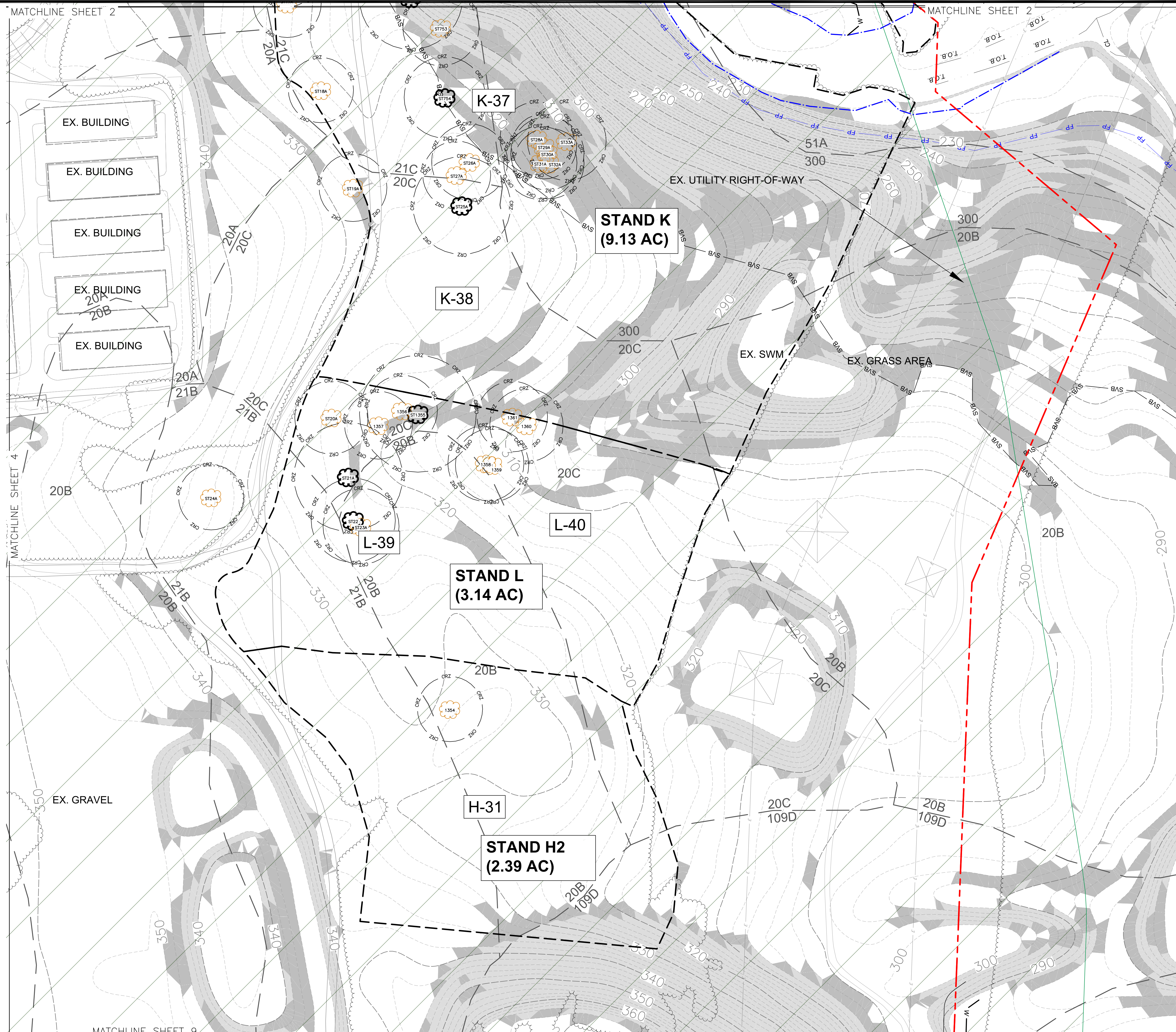

Wetland
Wetland Studies and Solutions, Inc.
1131 Benfield Boulevard • Suite L
Millersville, Maryland 21108
Phone: 410-672-5990 • Fax: 410-672-5993
www.wetlands.com

NATURAL RESOURCE INVENTORY/FOREST STAND
DELINEATION PLAN (NRI/FSD)
Dickerson Power Plant
PLAN NO. 420240750
Montgomery County, Maryland
Copyright © 2023 Wetland Studies and Solutions, Inc.
WSSC Grid Number: 229NW21, 229NW22, 230NW21, 230NW22 Tax Map Grid Number: BV/562

Property Owner Information:
Terra Energy, LLC
13409 Strawbale Lane
Darnestown, MD 20878
540-223-3954

No.	Date	Description	Rev. By	App. By
1	10/6/23	Updated titleblock, added contour labels per MNCPPC comments	HMK/MJK	MJK
2	11/29/23	Updated titleblock, notes, added watersheds, revised flow class, per MNCPPC comments	KH	MJK

DATE: November 29, 2023 SCALE: As Noted C1.1:2

Horizontal Datum: MGS NAD 83
Vertical Datum: NAVD 88
Boundary and Topo Source: Montgomery County Digital Data Sotesz

Design	Draft	Approved
HMK	HMK	MJK

Sheet #
5 of 20

WSSI Project Number:
MD2258.01

C:\WSSI\11_Maryland\Projects\MD2258\01\CADD\05-ENV\FSD\Working\MD2258-NRI_LOD_ONLY_NRIUpdates.dwg 5 Plotted By: Kelly, Haley, 11/29/2023 3:08 PM