

PLANNING DEPARTMENT USE ONLY (E-PLANS)

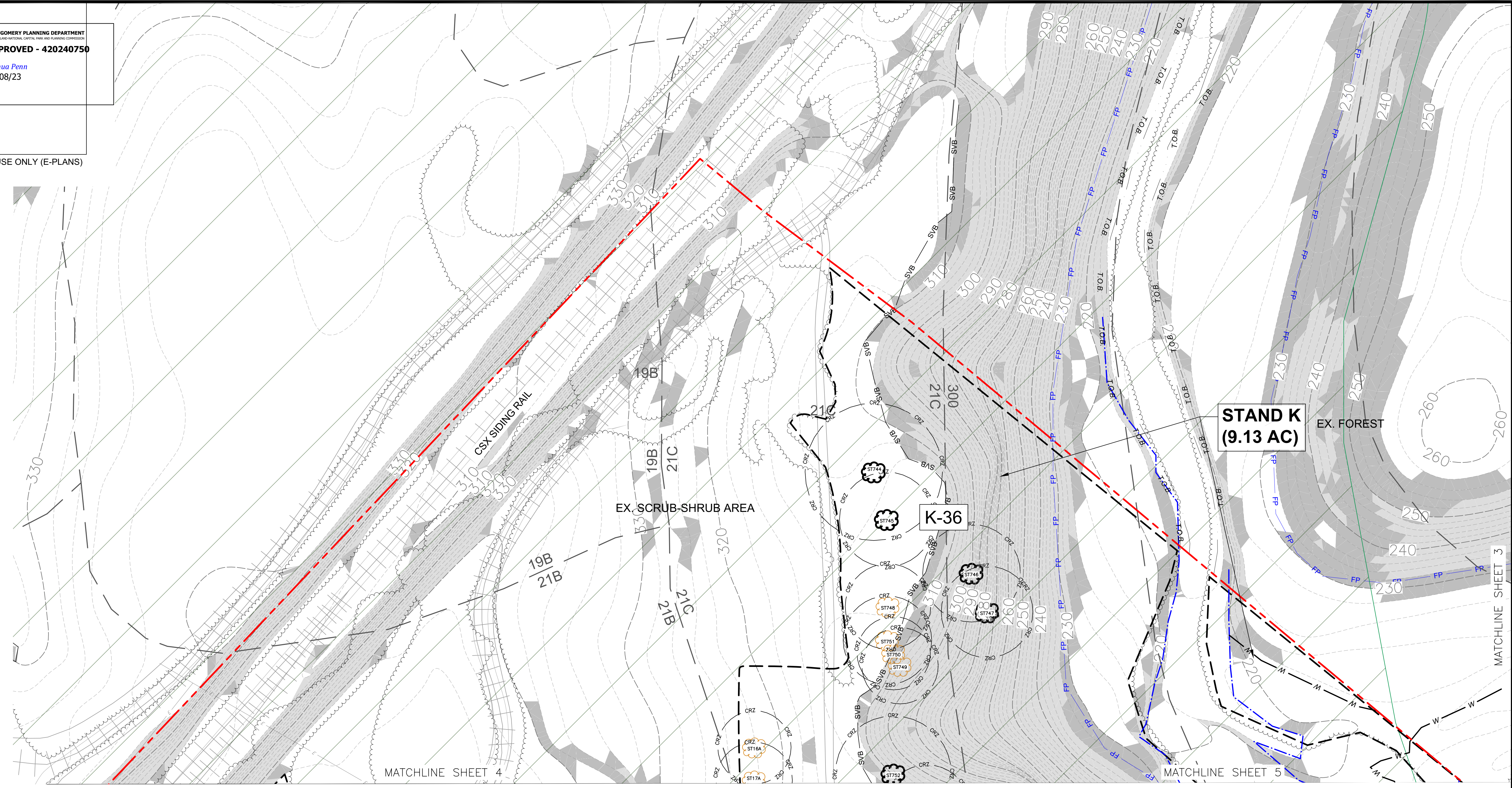

C:\SS\LU_Maryland\Projects\MD202258\01\CADD\05-ENV\FSD\Working\MD2258-NRI_LOD_ONLY_NRIUpdates.dwg 2. Plotted By: Kelly, Haley, 11/29/2023 1:27 PM



MATCHLINE SHEET 4

MATCHLINE SHEET 5

MATCHLINE SHEET 3

LEGEND

- - - - - NRI/FSD STUDY AREA
- TOTAL TRACT AREA
- EXISTING TREELINE
- SOILS BOUNDARY
- MONOCACY RIVER WATERSHED
- POTOMAC RIVER WATERSHED
- WATERSHED BOUNDARY
- STEEP SLOPES 15-25%
- STEEP SLOPES 25% OR GREATER
- SENSITIVE SPECIES PROJECT REVIEW AREA
- HISTORICAL RESOURCE
- EXISTING PERENNIAL STREAM
- EXISTING INTERMITTENT STREAM
- APPROXIMATE OFF-SITE STREAM CENTERLINE
- EXISTING NON-TIDAL WETLAND
- 25' WETLAND BUFFER
- STREAM VALLEY BUFFER
- FEMA 100-YEAR FLOODPLAIN
- FOREST STAND BOUNDARY
- APPROX FOREST STAND DATA POINT LOCATION
- SPECIMEN TREE LOCATION WITH CRITICAL ROOT ZONE
- SIGNIFICANT TREE LOCATION WITH CRITICAL ROOT ZONE

NRI/FSD PLAN NOTES

- 1) Total Tract Area: 758.14 acres
- 2) NRI/FSD Study Area: 291.72 acres
- 3) Current Zoning: I-H
Watershed: Potomac River/Monocacy-Montgomery County
Use class: I-P
- 4) Special Protection Area: No
- 5) Special Protection or Primary Management Area: No
- 6) 100-year Floodplain source: Fema Floodplain Number 24031C0130D
- 7) Streams and Non-tidal wetlands were delineated on-site during a field investigation on August 23, 2023.
- 8) A formal request for an environmental review for rare, threatened, or endangered species on the property was submitted to the Maryland Department of Natural Resources (MDDNR) on August 23, 2023.
- 9) This property is not located on the Locational Atlas and Index of Historic Sites.
- 10) Two hundred (200) specimen trees and three hundred sixty-eight (368) significant trees were identified on or immediately adjacent to the property.
- 11) No trees were identified onsite that are 75% of the State or County Champions.
- 12) The field work for this NRI/FSD Plan was completed by Haley Kelly, PWS, Marius Flemmer, WPIT, Katelyn Hoisington, WPIT, Dan Lekites and Luis Yanez
- 13) A forestry diameter tape was used to measure the diameter of the specimen trees located on the site. The diameter, condition and location of any trees 24-inches or greater located off of the property was estimated.
- 14) Property owner information:
Terra Energy, LLC
13409 Straw Bale Lane, Darnestown, MD 20878
- 15) The NRI/FSD is only valid for areas within the study area boundary. Any disturbance outside this area will require a new NRI/FSD

MAPPED SOIL TYPES

Map Unit	Soil Description	Drainage Class	Highly Erodible	Hydric Rating
19B	Bucks silt loam, 3 to 8 percent slopes	Well-drained	No	0
20A	Brentsville sandy loam, 0 to 3 percent slopes	Well-drained	No	0
20B	Brentsville sandy loam, 3 to 8 percent slopes	Well-drained	No	0
20C	Brentsville sandy loam, 8 to 15 percent slopes	Well-drained	No	0
21B	Penn silt loam, 3 to 8 percent slopes	Well-drained	No	0
21C	Penn silt loam, 8 to 15 percent slopes	Well-drained	No	0
21D	Penn silt loam, 15 to 25 percent slopes	Well-drained	Yes	5
22B	Readington silt loam, 3 to 8 percent slopes	Moderately well-drained	No	--
23A	Croton silt loam, occasionally ponded, 0 to 3 percent slopes	Poorly drained	No	85
47A	Lindside silt loam, 0 to 3 percent slopes, occasionally flooded	Moderately well-drained	No	10
51A	Bowmansville-Melvin silt loams, 0 to 2 percent slopes, occasionally flooded	Poorly drained	No	100
109D	Hyattstown channery silt loam, 15 to 25 percent slopes, very rocky	Well-drained	No	5
300	Rock outcrop-Blocktown complex	--	No	0
400	Urban land	--	No	0
GbB	Goresville and Bucks soils, 3 to 8 percent slopes	Well-drained	No	0
W	Census water	--	No	0

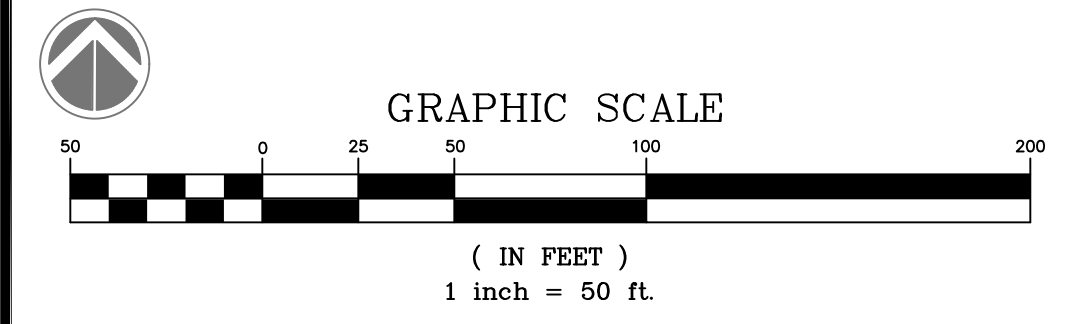

QUALIFIED PROFESSIONAL CERTIFICATION
 THIS PLAN COMPLIES WITH THE CURRENT REQUIREMENTS OF MONTGOMERY COUNTY CODE AND THE ENVIRONMENTAL TECHNICAL MANUAL.
 SIGNED: Haley Kelly DATE: 11/29/2023
HALEY KELLY
 WETLAND STUDIES AND SOLUTIONS, INC.
 1131 BENFIELD BOULEVARD, SUITE L
 MILLERSVILLE, MD 21104
 PH: (703) 679-5745 FAX: (410) 672-5993
 E-MAIL: HKELLY@WETLANDS.COM

NATURAL RESOURCE INVENTORY/FOREST STAND DELINEATION PLAN (NRI/FSD)

Property Owner Information:
 Terra Energy, LLC
 13409 Straw Bale Lane
 Darnestown, MD 20878
 540-223-3954

REVISIONS

No.	Date	Description	Rev. By	App. By
1	10/6/23	Updated titleblock, added contour labels per MNCPPC comments	HMK/MJK	MJK
2	11/29/23	Updated titleblock, notes, added watersheds, revised flow class per MNCPPC comments	KH	MJK

Horizontal Datum: MGS NAD 83
 Vertical Datum: NAVD 88
 Boundary and Topo Source: Montgomery County Digital Data Soltesz
 Design: HMK Draft: HMK Approved: MJK
 Sheet # 2 of 20
 WSSI Project Number: MD2258.01