



PLANNING DEPARTMENT USE ONLY (E-PLANS)

LEGEND

- NRI/FSD STUDY AREA
- TOTAL TRACT AREA
- EXISTING TREELINE
- SOILS BOUNDARY
- MONOCACY RIVER WATERSHED
- POTOMAC RIVER WATERSHED
- STEEP SLOPES 15-25%
- STEEP SLOPES 25% OR GREATER
- SENSITIVE SPECIES PROJECT REVIEW AREA
- HISTORICAL RESOURCE
- EXISTING PERENNIAL STREAM
- EXISTING INTERMITTENT STREAM
- APPROXIMATE OFF-SITE STREAM CENTERLINE
- EXISTING NON-TIDAL WETLAND
- 25' WETLAND BUFFER
- STREAM VALLEY BUFFER
- FEMA 100-YEAR FLOODPLAIN
- FOREST STAND BOUNDARY
- APPROX FOREST STAND DATA POINT LOCATION
- SPECIMEN TREE LOCATION WITH CRITICAL ROOT ZONE
- SIGNIFICANT TREE LOCATION WITH CRITICAL ROOT ZONE

NOTE: THE NRI/FSD IS ONLY VALID FOR AREAS WITHIN THE STUDY AREA BOUNDARY. ANY DISTURBANCE OUTSIDE THIS AREA WILL REQUIRE A NEW NRI/FSD

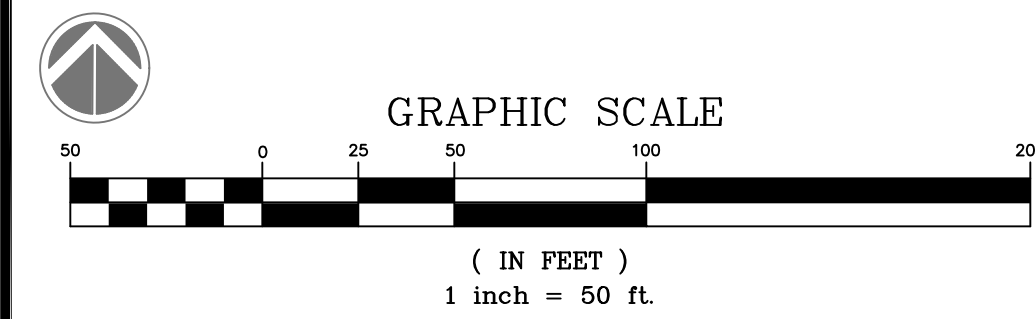

QUALIFIED PROFESSIONAL CERTIFICATION  
THIS PLAN COMPLIES WITH THE CURRENT REQUIREMENTS OF MONTGOMERY COUNTY CODE AND THE ENVIRONMENTAL TECHNICAL MANUAL.

SIGNED: *Haley Kelly* DATE: 11/29/2023

HALEY KELLY  
WETLAND STUDIES AND SOLUTIONS, INC.  
1131 BENFIELD BOULEVARD, SUITE L  
MILLERSVILLE, MD 21044  
PH: (703) 679-5745 FAX: (410) 672-5993  
E-MAIL: HKELLY@WETLANDS.COM

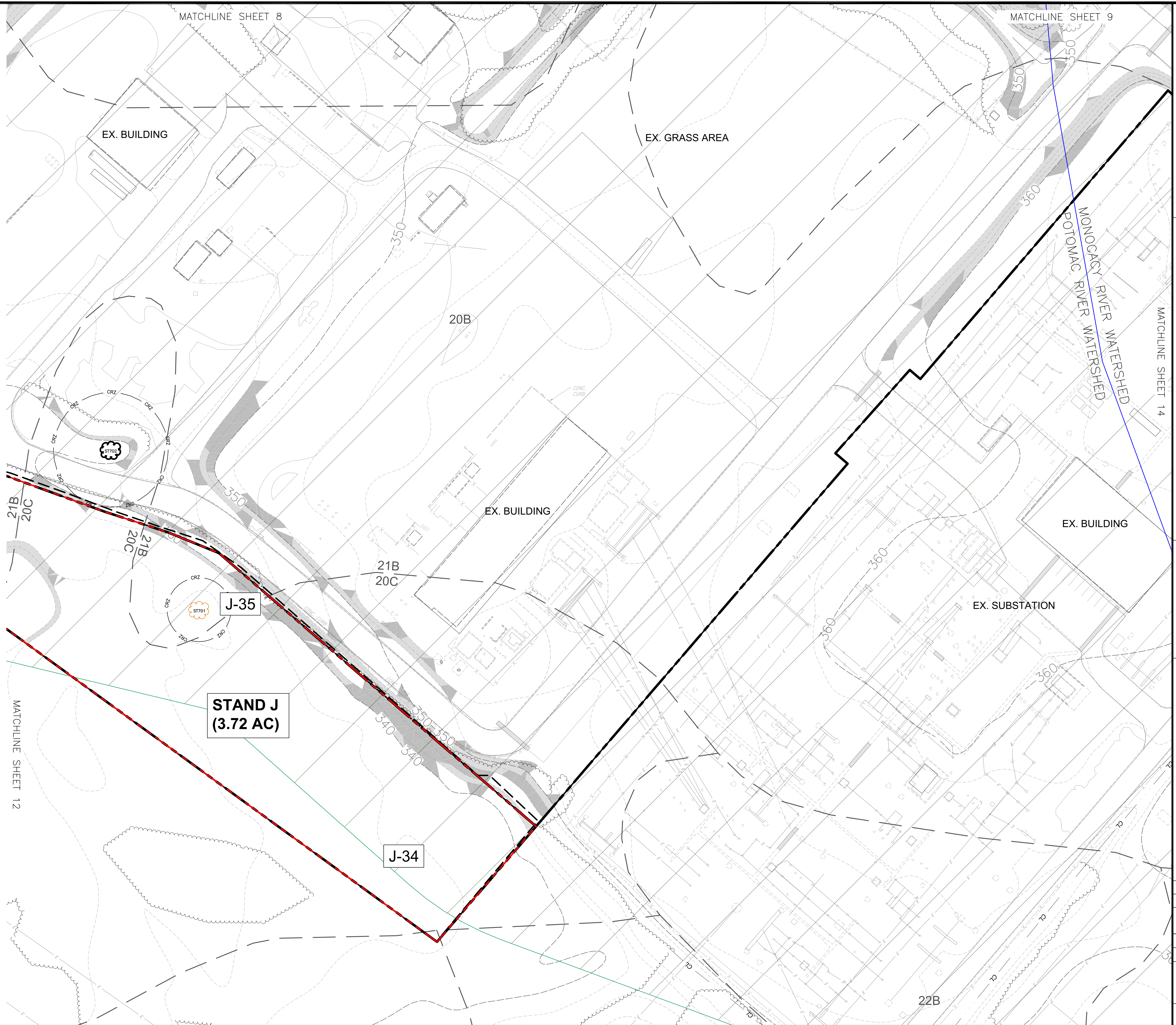

Wetland Studies and Solutions, Inc.  
a DAVEY company  
1131 Benfield Boulevard • Suite L  
Millersville, Maryland 21108  
Phone: 410-672-5990 • Fax: 410-672-5993  
www.wetlands.com

NATURAL RESOURCE INVENTORY/FOREST STAND DELINEATION PLAN (NRI/FSD)

Dickerson Power Plant  
PLAN NO. 420240750  
Montgomery County, Maryland  
Copyright © 2023 Wetland Studies and Solutions, Inc.

Property Owner Information:  
Terra Energy, LLC  
13409 Strawbale Lane  
Darnestown, MD 20878  
540-223-3954

No.	Date	Description	Rev. By	App. By
1	10/6/23	Updated titleblock, added contour labels	HMK/MJK	MJK
2	11/29/23	per MNCPPC comments updated titleblock, notes, added watersheds	KH	MJK
		revised flow class, per MNCPPC comments		

DATE: November 29, 2023 SCALE: As Noted C1:2

Horizontal Datum: MCS NAD 83  
Vertical Datum: NAVD 88  
Boundary and Topo Source: Montgomery County Digital Data Soltesz

Design	Draft	Approved
HMK	HMK	MJK

Sheet #  
13 of 20

WSSI Project Number:  
MD2258.01

C:\WSSI\1\_Maryland\Projects\MD202008\MD2258\01\CADD\05-ENR\FSD\Working\MD2258-NRI\_LOD\_ONLY\_NRIUpdates.dwg 13 Plotted By: Kelly, Haley; 11/29/2023 1:56 PM