

**LEGEND**

	PROPOSED BUILDING
	EXISTING BUILDINGS
	PROPERTY LINE
	EX. CONTOURS
	PROP. CONTOURS
	EX. STREAM
	EX. CURB
	PROP. CURB
	EX. SIDEWALK
	EX. ELECTRIC
	EX. GAS
	EX. SEWER
	PROP. SEWER
	EX. WATER
	PROP. WATER
	EX. STORM DRAIN
	PROP. STORM DRAIN
	PROP. LOD
	EX. OVER HEAD WIRE
	EX. UTILITY POLE
	EXISTING TREE LINE
	PROP. TREE LINE
	MAPPED SOILS BOUNDARY LINE
	FOREST CONSERVATION EASEMENT AREA
	FCE
	EX. FENCE
	WATERS OF US
	EPHEMERAL STREAM
	STREAM BUFFER
	WETLAND
	WETLAND BUFFER
	EXISTING TREE
	PROPOSED 5' ON-SITE SIDEWALK
	PROPOSED 5' PUBLIC SIDEWALK
	EXISTING PUBLIC SIDEWALK
	EXISTING 8' SHARED USE PATH
	PROPOSED 16' WIDE BIKE BREEZEWAY
	PROPOSED 11' SIDEWALK

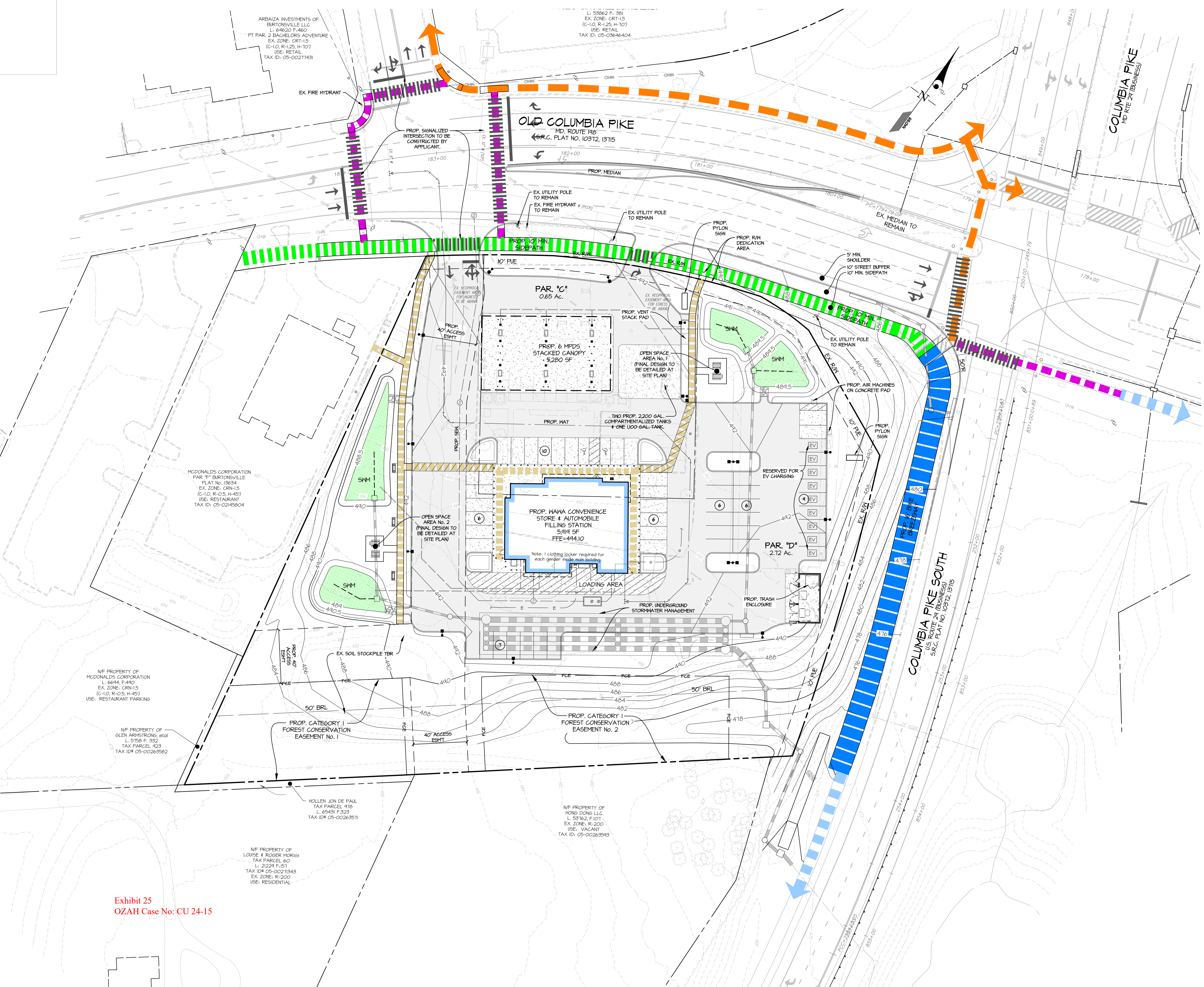
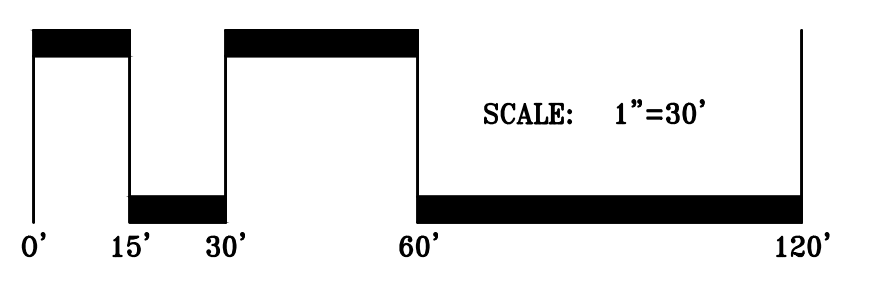

Exhibit 25  
OZAH Case No: CU 24-15

**GLW**  
PLANNING [ENGINEERING] SURVEYING  
3809 NATIONAL DRIVE | SUITE 250 | BURTONSVILLE, MD 20896 | GLWPA.COM  
PHONE: 301-421-4024 | BALT: 410-880-1800 | DCVA: 301-489-2524 | FAX: 301-421-4180

DESIGNED BY	KAF			
DRAWN BY	KAB			
CHECKED BY	KAF			
DATE		REVISION	BY	APPR.



PREPARED FOR:  
HONG CHENG LLC & DONG YA LLC  
8106 SHAD LANE  
POTOMAC, MARYLAND 20854

SCALE	1"=30'
DATE	APRIL 2024
ZONING	CRF-1.5 C-1.0, R-5.0, H-45
TAX MAP - GRID	KS-62

**CIRCULATION EXHIBIT**  
WAWA - BURTONSVILLE  
Automobile Filling Station & Convenience Store  
Parcel C & Parcel D  
L. 15285 F. 145 & L. 50129 F.283  
APRIL 2024  
COLESVILLE ELECTION DISTRICT No. 05  
MONTGOMERY COUNTY, MARYLAND

Conditional Use Plan No. CU2024-xx  
G. L. W. FILE No.  
23078  
SHEET  
1 OF 1