

- GENERAL NOTES:**
- SCOPE OF WORK:**
 - The landscape contractor shall provide all materials, labor and equipment to complete the landscape work as shown on the plans and specifications. The landscape contractor may offer substitutions to the landscape provided they are approved in writing by the owner. Substitutions between the owner and the contractor shall be made prior to construction.
 - Plant materials shall conform to the current issue of the American Standard for Nursery Stock published by the American Association of Nurserymen. All trees to be planted shall be certified by the American Association of Nurserymen. All trees to be planted shall be certified by the American Association of Nurserymen. All trees to be planted shall be certified by the American Association of Nurserymen.
 - Plant materials shall be certified by the American Association of Nurserymen. All trees to be planted shall be certified by the American Association of Nurserymen. All trees to be planted shall be certified by the American Association of Nurserymen.
 - EXISTING UTILITIES:**
 - The landscape contractor shall be responsible for locating and marking all existing utilities. The landscape contractor shall be responsible for locating and marking all existing utilities. The landscape contractor shall be responsible for locating and marking all existing utilities.
 - PERMITS:**
 - The landscape contractor shall be responsible for obtaining all necessary permits. The landscape contractor shall be responsible for obtaining all necessary permits. The landscape contractor shall be responsible for obtaining all necessary permits.
 - WATER:**
 - The owner shall provide water to the site at all times. The landscape contractor shall be responsible for providing water to the site at all times. The landscape contractor shall be responsible for providing water to the site at all times.
 - INSPECTION:**
 - The landscape contractor shall be responsible for providing all necessary documentation for inspection. The landscape contractor shall be responsible for providing all necessary documentation for inspection. The landscape contractor shall be responsible for providing all necessary documentation for inspection.
 - PLANTING:**
 - The landscape contractor shall be responsible for planting all plants and trees. The landscape contractor shall be responsible for planting all plants and trees. The landscape contractor shall be responsible for planting all plants and trees.
 - MAINTENANCE:**
 - The landscape contractor shall be responsible for providing all necessary maintenance. The landscape contractor shall be responsible for providing all necessary maintenance. The landscape contractor shall be responsible for providing all necessary maintenance.

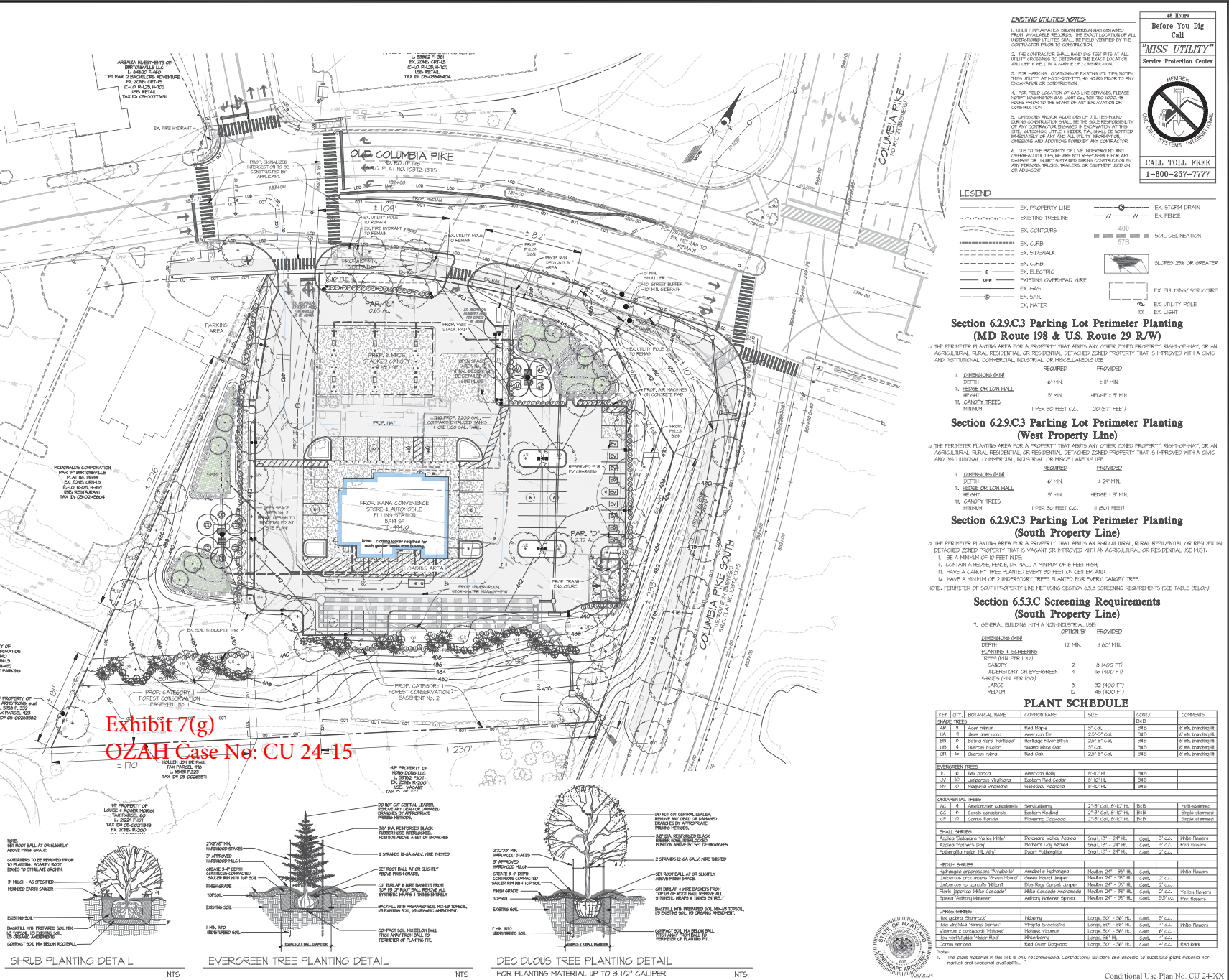

48 Hours

Before You Dig
Call
"MISS UTILITY"
Service Protection Center

MEMBER
MISSISSIPPI UTILITIES ASSOCIATION

CALL TOLL FREE
1-800-257-7777

EXISTING UTILITIES NOTES:

- UTILITY INFORMATION FROM THE RECORDS HAS BEEN OBTAINED FROM AVAILABLE RECORDS. THE EXACT LOCATION OF ALL UTILITIES SHOWN ON THESE PLANS IS NOT GUARANTEED BY THE CONTRACTOR PRIOR TO CONSTRUCTION.
- THE CONTRACTOR SHALL MARK ALL DEEPS TESTS AT ALL UTILITY LOCATIONS TO DETERMINE THE EXACT LOCATION AND DEPTH OF ALL UTILITIES.
- FOR THE LOCATION OF EXISTING UTILITIES NOTIFY MISS UTILITY AT 1-800-257-7777 AT LEAST 48 HOURS PRIOR TO ANY EXCAVATION OR CONSTRUCTION.
- FOR FIELD LOCATION OF GAS LINE SERVICES PLEASE NOTIFY MISSISSIPPI GAS SERVICE AT 1-800-257-7777 AT LEAST 48 HOURS PRIOR TO THE START OF ANY EXCAVATION OR CONSTRUCTION.
- CRACKS AND ADDITION OF UTILITIES FORMER OWNERS OR CONTRACTORS SHALL BE THE RESPONSIBILITY OF ANY CONTRACTOR ENGAGED IN EXCAVATION AT THE TIME OF CONSTRUCTION. THE CONTRACTOR SHALL BE RESPONSIBLE FOR THE PROTECTION OF ALL UTILITIES AND ALL UTILITY INFORMATION, ORIGINALS AND COPIES, PROVIDED BY ANY CONTRACTOR.
- USE OF THE PROPERTY OF LINE INFORMATION AND INFORMATION FROM RECORDS SHALL BE THE RESPONSIBILITY OF ANY CONTRACTOR. RISKY INVESTED SERVICE CONTRIBUTION BY ANY PROVIDER, RECORDS, TRANSMISSIONS OR EQUIPMENT USED OR ADJACENT.

LEGEND

EX. PROPERTY LINE	EX. STORM DRAIN
EXISTING TREE LINE	EX. FENCE
EX. CONTOURS	400' SOIL DELINEATION
EX. CURB	5 FTB
EX. SIDEWALK	SLOPES 25% OR GREATER
EX. CURB	EX. BUILDING STRUCTURE
EX. ELECTRIC	EX. LIGHT
EXISTING OVERHEAD WIRE	EX. LIGHT POLE
EX. GAS	EX. WATER
EX. SAN.	

Section 6.29.C.3 Parking Lot Perimeter Planting (MD Route 198 & U.S. Route 29 R/W)

THE PERIMETER PLANTING AREA FOR A PROPERTY THAT ADJUTS ANOTHER ZONED PROPERTY, RIGHT-OF-WAY, OR AN AGRICULTURAL, RURAL, RESIDENTIAL, OR RESIDENTIAL DETACHED ZONED PROPERTY THAT IS IMPROVED WITH A CURB AND INSTITUTIONAL, COMMERCIAL, INDUSTRIAL, OR MISCELLANEOUS USE.

REQUIRED	PROVIDED
1. DIMENSION: 6" MIN. HEIGHT	6" MIN. HEIGHT
2. HEIGHT: 1' MIN.	EDGE: 1.5' MIN. HEIGHT: 1.5' MIN.
3. CANOPY TREES: 1 PER 30 FEET O.G.	20 5/8" FT

Section 6.29.C.3 Parking Lot Perimeter Planting (West Property Line)

THE PERIMETER PLANTING AREA FOR A PROPERTY THAT ADJUTS ANOTHER ZONED PROPERTY, RIGHT-OF-WAY, OR AN AGRICULTURAL, RURAL, RESIDENTIAL, OR RESIDENTIAL DETACHED ZONED PROPERTY THAT IS IMPROVED WITH A CURB AND INSTITUTIONAL, COMMERCIAL, INDUSTRIAL, OR MISCELLANEOUS USE.

REQUIRED	PROVIDED
1. DIMENSION: 6" MIN. HEIGHT	6" MIN. HEIGHT
2. HEIGHT: 1' MIN.	EDGE: 1.5' MIN. HEIGHT: 1.5' MIN.
3. CANOPY TREES: 1 PER 30 FEET O.G.	1 (BUT FEET)

Section 6.29.C.3 Parking Lot Perimeter Planting (South Property Line)

THE PERIMETER PLANTING AREA FOR A PROPERTY THAT ADJUTS AN AGRICULTURAL, RURAL, RESIDENTIAL, OR RESIDENTIAL DETACHED ZONED PROPERTY THAT IS VACANT OR IMPROVED WITH AN AGRICULTURAL, RURAL, RESIDENTIAL, OR MISCELLANEOUS USE.

- BE A MINIMUM OF 10 FEET HIGH.
- CONTAIN A HEDGE, FENCE, OR WALL A MINIMUM OF 6 FEET HIGH.
- HAVE A CANOPY TREE PLANTED EVERY 30 FEET ON CENTER AND.
- HAVE A MINIMUM OF 2 LANSKY TREES PLANTED FOR EVERY CANOPY TREE.

NOTE: PERIMETER OF SOUTH PROPERTY LINE MUST MEET SECTION 6.53.C SCREENING REQUIREMENTS (SEE TABLE BELOW)

Section 6.53.C Screening Requirements (South Property Line)

GENERAL BILLINGS WITH A NON-RESIDENTIAL USE:

DIMENSION: 6" MIN. HEIGHT	OPTION B	PROVIDED
12" MIN.	1.40' MIN.	

PLANTING & SCREENING

TREES (MIN PER 100')	CANOPY TREES (MIN PER 100')	SHRUBS (MIN PER 100')	LARGE TREES (MIN PER 100')
2	8 (400 FT)	4	4 (400 FT)
2	8 (400 FT)	4	4 (400 FT)
2	8 (400 FT)	4	4 (400 FT)

PLANT SCHEDULE

KEY CITY BOTANICAL NAME	COMMON NAME	SIZE	COMPL.	COMMENTS
SHRUB TREES				
1. 4' Avon japonica	Red Maple	2" Cal.	100%	
2. 4' Ulmus americana	American Elm	2.5" Cal.	100%	4 sh. minimum 1 ft
3. 4' Rhus glabra	Flame Tree	2" Cal.	100%	4 sh. minimum 1 ft
4. 4' Quercus prinus	White Oak	2" Cal.	100%	4 sh. minimum 1 ft
5. 4' Liriodendron tulipifera	Yellow Poplar	2" Cal.	100%	4 sh. minimum 1 ft
6. 4' Liquidambar styraciflua	Sweetgum	2" Cal.	100%	4 sh. minimum 1 ft
7. 4' Nyctaginia flexilis	Black Nightshade	2" Cal.	100%	4 sh. minimum 1 ft
8. 4' Sycamore	Sycamore	2" Cal.	100%	4 sh. minimum 1 ft
9. 4' Fraxinus americana	American Hazel	2" Cal.	100%	4 sh. minimum 1 ft
10. 4' Cornus florida	Flowering Dogwood	2" Cal.	100%	4 sh. minimum 1 ft
11. 4' Magnolia grandiflora	Bald Magnolia	2" Cal.	100%	4 sh. minimum 1 ft
12. 4' Liriodendron tulipifera	Yellow Poplar	2" Cal.	100%	4 sh. minimum 1 ft
13. 4' Liquidambar styraciflua	Sweetgum	2" Cal.	100%	4 sh. minimum 1 ft
14. 4' Nyctaginia flexilis	Black Nightshade	2" Cal.	100%	4 sh. minimum 1 ft
15. 4' Sycamore	Sycamore	2" Cal.	100%	4 sh. minimum 1 ft
16. 4' Fraxinus americana	American Hazel	2" Cal.	100%	4 sh. minimum 1 ft
17. 4' Cornus florida	Flowering Dogwood	2" Cal.	100%	4 sh. minimum 1 ft
18. 4' Magnolia grandiflora	Bald Magnolia	2" Cal.	100%	4 sh. minimum 1 ft
19. 4' Liriodendron tulipifera	Yellow Poplar	2" Cal.	100%	4 sh. minimum 1 ft
20. 4' Liquidambar styraciflua	Sweetgum	2" Cal.	100%	4 sh. minimum 1 ft
21. 4' Nyctaginia flexilis	Black Nightshade	2" Cal.	100%	4 sh. minimum 1 ft
22. 4' Sycamore	Sycamore	2" Cal.	100%	4 sh. minimum 1 ft
23. 4' Fraxinus americana	American Hazel	2" Cal.	100%	4 sh. minimum 1 ft
24. 4' Cornus florida	Flowering Dogwood	2" Cal.	100%	4 sh. minimum 1 ft
25. 4' Magnolia grandiflora	Bald Magnolia	2" Cal.	100%	4 sh. minimum 1 ft
26. 4' Liriodendron tulipifera	Yellow Poplar	2" Cal.	100%	4 sh. minimum 1 ft
27. 4' Liquidambar styraciflua	Sweetgum	2" Cal.	100%	4 sh. minimum 1 ft
28. 4' Nyctaginia flexilis	Black Nightshade	2" Cal.	100%	4 sh. minimum 1 ft
29. 4' Sycamore	Sycamore	2" Cal.	100%	4 sh. minimum 1 ft
30. 4' Fraxinus americana	American Hazel	2" Cal.	100%	4 sh. minimum 1 ft
31. 4' Cornus florida	Flowering Dogwood	2" Cal.	100%	4 sh. minimum 1 ft
32. 4' Magnolia grandiflora	Bald Magnolia	2" Cal.	100%	4 sh. minimum 1 ft
33. 4' Liriodendron tulipifera	Yellow Poplar	2" Cal.	100%	4 sh. minimum 1 ft
34. 4' Liquidambar styraciflua	Sweetgum	2" Cal.	100%	4 sh. minimum 1 ft
35. 4' Nyctaginia flexilis	Black Nightshade	2" Cal.	100%	4 sh. minimum 1 ft
36. 4' Sycamore	Sycamore	2" Cal.	100%	4 sh. minimum 1 ft
37. 4' Fraxinus americana	American Hazel	2" Cal.	100%	4 sh. minimum 1 ft
38. 4' Cornus florida	Flowering Dogwood	2" Cal.	100%	4 sh. minimum 1 ft
39. 4' Magnolia grandiflora	Bald Magnolia	2" Cal.	100%	4 sh. minimum 1 ft
40. 4' Liriodendron tulipifera	Yellow Poplar	2" Cal.	100%	4 sh. minimum 1 ft
41. 4' Liquidambar styraciflua	Sweetgum	2" Cal.	100%	4 sh. minimum 1 ft
42. 4' Nyctaginia flexilis	Black Nightshade	2" Cal.	100%	4 sh. minimum 1 ft
43. 4' Sycamore	Sycamore	2" Cal.	100%	4 sh. minimum 1 ft
44. 4' Fraxinus americana	American Hazel	2" Cal.	100%	4 sh. minimum 1 ft
45. 4' Cornus florida	Flowering Dogwood	2" Cal.	100%	4 sh. minimum 1 ft
46. 4' Magnolia grandiflora	Bald Magnolia	2" Cal.	100%	4 sh. minimum 1 ft
47. 4' Liriodendron tulipifera	Yellow Poplar	2" Cal.	100%	4 sh. minimum 1 ft
48. 4' Liquidambar styraciflua	Sweetgum	2" Cal.	100%	4 sh. minimum 1 ft
49. 4' Nyctaginia flexilis	Black Nightshade	2" Cal.	100%	4 sh. minimum 1 ft
50. 4' Sycamore	Sycamore	2" Cal.	100%	4 sh. minimum 1 ft
51. 4' Fraxinus americana	American Hazel	2" Cal.	100%	4 sh. minimum 1 ft
52. 4' Cornus florida	Flowering Dogwood	2" Cal.	100%	4 sh. minimum 1 ft
53. 4' Magnolia grandiflora	Bald Magnolia	2" Cal.	100%	4 sh. minimum 1 ft
54. 4' Liriodendron tulipifera	Yellow Poplar	2" Cal.	100%	4 sh. minimum 1 ft
55. 4' Liquidambar styraciflua	Sweetgum	2" Cal.	100%	4 sh. minimum 1 ft
56. 4' Nyctaginia flexilis	Black Nightshade	2" Cal.	100%	4 sh. minimum 1 ft
57. 4' Sycamore	Sycamore	2" Cal.	100%	4 sh. minimum 1 ft
58. 4' Fraxinus americana	American Hazel	2" Cal.	100%	4 sh. minimum 1 ft
59. 4' Cornus florida	Flowering Dogwood	2" Cal.	100%	4 sh. minimum 1 ft
60. 4' Magnolia grandiflora	Bald Magnolia	2" Cal.	100%	4 sh. minimum 1 ft
61. 4' Liriodendron tulipifera	Yellow Poplar	2" Cal.	100%	4 sh. minimum 1 ft
62. 4' Liquidambar styraciflua	Sweetgum	2" Cal.	100%	4 sh. minimum 1 ft
63. 4' Nyctaginia flexilis	Black Nightshade	2" Cal.	100%	4 sh. minimum 1 ft
64. 4' Sycamore	Sycamore	2" Cal.	100%	4 sh. minimum 1 ft
65. 4' Fraxinus americana	American Hazel	2" Cal.	100%	4 sh. minimum 1 ft
66. 4' Cornus florida	Flowering Dogwood	2" Cal.	100%	4 sh. minimum 1 ft
67. 4' Magnolia grandiflora	Bald Magnolia	2" Cal.	100%	4 sh. minimum 1 ft
68. 4' Liriodendron tulipifera	Yellow Poplar	2" Cal.	100%	4 sh. minimum 1 ft
69. 4' Liquidambar styraciflua	Sweetgum	2" Cal.	100%	4 sh. minimum 1 ft
70. 4' Nyctaginia flexilis	Black Nightshade	2" Cal.	100%	4 sh. minimum 1 ft
71. 4' Sycamore	Sycamore	2" Cal.	100%	4 sh. minimum 1 ft
72. 4' Fraxinus americana	American Hazel	2" Cal.	100%	4 sh. minimum 1 ft
73. 4' Cornus florida	Flowering Dogwood	2" Cal.	100%	4 sh. minimum 1 ft
74. 4' Magnolia grandiflora	Bald Magnolia	2" Cal.	100%	4 sh. minimum 1 ft
75. 4' Liriodendron tulipifera	Yellow Poplar	2" Cal.	100%	4 sh. minimum 1 ft
76. 4' Liquidambar styraciflua	Sweetgum	2" Cal.	100%	4 sh. minimum 1 ft
77. 4' Nyctaginia flexilis	Black Nightshade	2" Cal.	100%	4 sh. minimum 1 ft
78. 4' Sycamore	Sycamore	2" Cal.	100%	4 sh. minimum 1 ft
79. 4' Fraxinus americana	American Hazel	2" Cal.	100%	4 sh. minimum 1 ft
80. 4' Cornus florida	Flowering Dogwood	2" Cal.	100%	4 sh. minimum 1 ft
81. 4' Magnolia grandiflora	Bald Magnolia	2" Cal.	100%	4 sh. minimum 1 ft
82. 4' Liriodendron tulipifera	Yellow Poplar	2" Cal.	100%	4 sh. minimum 1 ft
83. 4' Liquidambar styraciflua	Sweetgum	2" Cal.	100%	4 sh. minimum 1 ft
84. 4' Nyctaginia flexilis	Black Nightshade	2" Cal.	100%	4 sh. minimum 1 ft
85. 4' Sycamore	Sycamore	2" Cal.	100%	4 sh. minimum 1 ft
86. 4' Fraxinus americana	American Hazel	2" Cal.	100%	4 sh. minimum 1 ft
87. 4' Cornus florida	Flowering Dogwood	2" Cal.	100%	4 sh. minimum 1 ft
88. 4' Magnolia grandiflora	Bald Magnolia	2" Cal.	100%	4 sh. minimum 1 ft
89. 4' Liriodendron tulipifera	Yellow Poplar	2" Cal.	100%	4 sh. minimum 1 ft
90. 4' Liquidambar styraciflua	Sweetgum	2" Cal.	100%	4 sh. minimum 1 ft
91. 4' Nyctaginia flexilis	Black Nightshade	2" Cal.	100%	4 sh. minimum 1 ft
92. 4' Sycamore	Sycamore	2" Cal.	100%	4 sh. minimum 1 ft
93. 4' Fraxinus americana	American Hazel	2" Cal.	100%	4 sh. minimum 1 ft
94. 4' Cornus florida	Flowering Dogwood	2" Cal.	100%	4 sh. minimum 1 ft
95. 4' Magnolia grandiflora	Bald Magnolia	2" Cal.	100%	4 sh. minimum 1 ft
96. 4' Liriodendron tulipifera	Yellow Poplar	2" Cal.	100%	4 sh. minimum 1 ft
97. 4' Liquidambar styraciflua	Sweetgum	2" Cal.	100%	4 sh. minimum 1 ft
98. 4' Nyctaginia flexilis	Black Nightshade	2" Cal.	100%	4 sh. minimum 1 ft
99. 4' Sycamore	Sycamore	2" Cal.	100%	4 sh. minimum 1 ft
100. 4' Fraxinus americana	American Hazel	2" Cal.	100%	4 sh. minimum 1 ft
101. 4' Cornus florida	Flowering Dogwood	2" Cal.	100%	4 sh. minimum 1 ft
102. 4' Magnolia grandiflora	Bald Magnolia	2" Cal.	100%	4 sh. minimum 1 ft
103. 4' Liriodendron tulipifera	Yellow Poplar	2" Cal.	100%	4 sh. minimum 1 ft
104. 4' Liquidambar styraciflua	Sweetgum	2" Cal.	100%	4 sh. minimum 1 ft
105. 4' Nyctaginia flexilis	Black Nightshade	2" Cal.	100%	4 sh. minimum 1 ft
106. 4' Sycamore	Sycamore	2" Cal.	100%	4 sh. minimum 1 ft
107. 4' Fraxinus americana	American Hazel	2" Cal.	100%	4 sh. minimum 1 ft
108. 4' Cornus florida	Flowering Dogwood	2" Cal.	100%	4 sh. minimum 1 ft
109. 4' Magnolia grandiflora	Bald Magnolia	2" Cal.	100%	4 sh. minimum 1 ft
110. 4' Liriodendron tulipifera	Yellow Poplar	2" Cal.	100%	4 sh. minimum 1 ft
111. 4' Liquidambar styraciflua	Sweetgum	2" Cal.	100%	4 sh. minimum 1 ft
112. 4' Nyctaginia flexilis	Black Nightshade	2" Cal.	100%	4 sh. minimum 1 ft
113. 4' Sycamore	Sycamore	2" Cal.	100%	4 sh. minimum 1 ft
114. 4' Fraxinus americana	American Hazel	2" Cal.	100%	4 sh. minimum 1 ft
115. 4' Cornus florida	Flowering Dogwood	2" Cal.	100%	4 sh. minimum 1 ft
116. 4' Magnolia grandiflora	Bald Magnolia	2" Cal.	100%	4 sh. minimum 1 ft
117. 4' Liriodendron tulipifera	Yellow Poplar	2" Cal.	100%	4 sh. minimum 1 ft
118. 4' Liquidambar styraciflua	Sweetgum	2" Cal.	100%	4 sh. minimum 1 ft
119. 4' Nyctaginia flexilis	Black Nightshade	2" Cal.	100%	4 sh. minimum 1 ft
120. 4' Sycamore	Sycamore	2" Cal.	100%	4 sh. minimum 1 ft
121. 4' Fraxinus americana	American Hazel	2" Cal.	100%	4 sh. minimum 1 ft
122. 4' Cornus florida	Flowering Dogwood	2" Cal.	100%	4 sh. minimum 1 ft
123. 4' Magnolia grandiflora	Bald Magnolia	2" Cal.	100%	4 sh. minimum 1 ft
124. 4' Liriodendron tulipifera	Yellow Poplar	2" Cal.	100%	4 sh. minimum 1 ft
125. 4' Liquidambar styraciflua	Sweetgum	2" Cal.	100%	4 sh. minimum 1 ft
126. 4' Nyctaginia flexilis	Black Nightshade	2" Cal.	100%	4 sh. minimum 1 ft
127. 4' Sycamore	Sycamore	2" Cal.	100%	4 sh. minimum 1 ft
128. 4' Fraxinus americana	American Hazel	2" Cal.	100%	4 sh. minimum 1 ft
129. 4' Cornus florida	Flowering Dogwood	2" Cal.	100%	4 sh. minimum 1 ft
130. 4' Magnolia grandiflora	Bald Magnolia	2" Cal.	100%	4 sh. minimum 1 ft
131. 4' Liriodendron tulipifera	Yellow Poplar	2" Cal.	100%	4 sh. minimum 1 ft
132. 4' Liquidambar styraciflua	Sweetgum	2" Cal.	100%	4 sh. minimum 1 ft
133. 4' Nyctaginia flexilis	Black Nightshade	2" Cal.	100%	4 sh. minimum 1 ft
134. 4' Sycamore	Sycamore	2" Cal.	100%	4 sh. minimum 1 ft
135. 4' Fraxinus americana	American Hazel	2" Cal.	100%	4 sh. minimum 1 ft
136. 4' Cornus florida	Flowering Dogwood	2" Cal.	100%	4 sh. minimum 1 ft
137. 4' Magnolia grandiflora	Bald Magnolia	2" Cal.	100%	4 sh. minimum 1 ft
138. 4' Liriodendron tulipifera	Yellow Poplar	2" Cal.	100%	4 sh. minimum 1 ft
139. 4' Liquidambar styraciflua	Sweetgum	2" Cal.	100%	4 sh. minimum 1 ft
140. 4' Nyctaginia flexilis	Black Nightshade	2" Cal.	100%	4 sh. minimum 1 ft
141. 4' Sycamore	Sycamore	2" Cal.	100%	4 sh. minimum 1 ft
142. 4' Fraxinus americana	American Hazel	2" Cal.	100%	4 sh. minimum 1 ft
143. 4' Cornus florida	Flowering Dogwood	2" Cal.	100%	4 sh. minimum 1 ft
144. 4' Magnolia grandiflora	Bald Magnolia	2" Cal.		