

EXISTING UTILITY NOTES

- For marking locations of existing utilities, notify "MISS UTILITY" at 1-800-257-7777, 48 hours prior to any excavation or construction.
- Information concerning underground utilities was obtained from available records. The contractor must determine the exact locations and elevations of the utilities by digging test pits by hand at all utility crossings well in advance of trenching. If clearances are less than specified on this plan or less than 12 inches when not specified, contact the Engineer, and the owner of the other involved utility before proceeding with construction.
- For field location of gas line services, notify Washington Gas Light Co., 703-750-1000, 48 hours prior to the start of any excavation or construction.
- Omissions and/or additions of utilities found during construction shall be the sole responsibility of any contractor engaged in excavation at this site. Gutschick, Little & Weber, P.A. shall be notified immediately of any and all utility information, omissions and additions found by any contractor.
- Due to the proximity of live underground and overhead utilities, we are not responsible for any damage or injury sustained during construction by any persons, trucks, trailers, or equipment used on or adjacent to the site.

ESDv DRAINAGE AREAS & COMPS:

	ESDv REQUIRED (2"):	ESDv PROVIDED:	ESDv PROVIDED IN STRUCTURAL PRACTICES:	EFFECTIVE D.A.:
①	4.19 AC.	20,819 C.F.	10,422 C.F.	1.87 AC.
②	2.44 AC.	9,579 C.F.	6,434 C.F.	0.68 AC.
③	6.44 AC.	28,423 C.F.	5,001 C.F.	5.25 AC.
④	5.62 AC.	24,605 C.F.	9,015 C.F.	2.66 AC.
⑤	4.61 AC.	26,260 C.F.	12,034 C.F.	1.61 AC.
⑥	5.94 AC.	32,475 C.F.	28,905 C.F.	1.15 AC.
⑦	2.20 AC.	12,584 C.F.	5,492 C.F.	1.35 AC.
⑧	3.46 AC.	N/A	N/A	N/A
TOTAL:	34.90 AC.	155,245 C.F.	79,572 C.F.*	14.57 AC.

-REQUIRED R_e FOR SITE = 2.0"
 -OVERALL SITE MEETS MINIMUM REQUIRED R_e OF 1.0"
 -REMAINING VOLUME PROVIDED VIA STRUCTURAL PRACTICES.
 -EFFECTIVE DRAINAGE AREAS ARE AREAS TO BE TREATED BY STRUCTURAL PRACTICES IN ACCORDANCE WITH MCDPS TECHNICAL POLICY NO. 6.
 -ASBUILTS PROVIDED IN PHASE 1
 - * INCLUDES VOLUME OF MBR #2-15 NEXT TO LIBRARY TO BE CONSTRUCTED UNDER PHASE 2

48 Hours
Before You Dig Call
 "MISS UTILITY"
 Service Protection Center

 MEMBER
 ONE CALL SYSTEMS INTERNATIONAL
CALL TOLL FREE
 1-800-257-7777

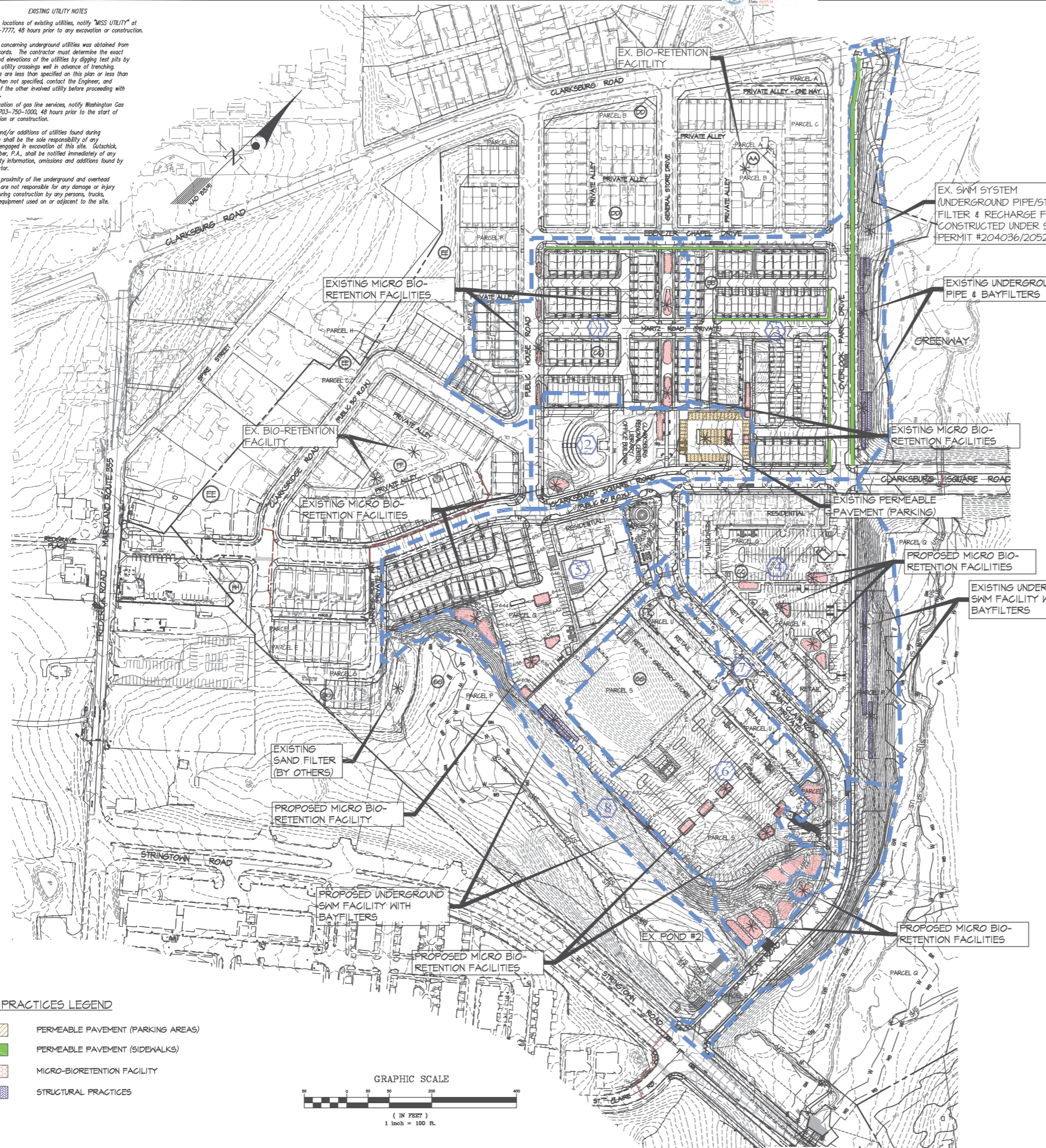

PHASE 1 SUMMARY

ESDv REQUIRED (1") = 28,383 cf	ESDv PROVIDED = 22,357 cf
TOTAL Mgv REQUIRED (2") = 56,767 cf	Mgv PROVIDED = 81,551 cf (29,200 cf IN STRUCTURAL PRACTICES)

PHASE 2 SUMMARY

ESDv REQUIRED (1") = 44,234 cf	ESDv PROVIDED = 51,215 cf
TOTAL Mgv REQUIRED (2") = 88,478 cf	Mgv PROVIDED = 80,431 cf (23,216 cf IN STRUCTURAL PRACTICES)

TOTALS

ESDv REQUIRED (1") = 116,233 cf	ESDv PROVIDED = 74,572 cf
TOTAL Mgv REQUIRED (2") = 155,245 cf	Mgv PROVIDED = 161,988 cf (82,416 cf IN STRUCTURAL PRACTICES)

ESD PRACTICES LEGEND

- PERMEABLE PAVEMENT (PARKING AREAS)
- PERMEABLE PAVEMENT (SIDEWALKS)
- MICRO-BIORETENTION FACILITY
- STRUCTURAL PRACTICES

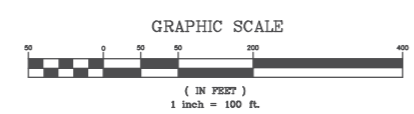

GLW
 PLANNING | ENGINEERING | SURVEYING
 3909 NATIONAL DRIVE | SUITE 250 | BURTONSVILLE, MD 20886 | GLWPA.COM
 PHONE: 301-421-4024 | FAX: 301-421-4024 | TOLL FREE: 1-800-688-2624 | FAX: 301-421-4118

DESIGNED BY: LMW	DATE: 11/8/2023	REVISION: REVISED LAYOUT OF COMMERCIAL AREA	BY: LMW	APPR: [Signature]
DRAWN BY: LMW				
CHECKED BY: MAJ				

PROFESSIONAL CERTIFICATION
 I HEREBY CERTIFY THAT THESE PLANS WERE PREPARED OR APPROVED BY ME, AND THAT I AM A DULY LICENSED PROFESSIONAL ENGINEER UNDER THE LAWS OF THE STATE OF MARYLAND, LICENSE NO. 29814.
 EXPIRATION DATE: JANUARY 22, 2024

 11/23

PREPARED FOR:
 CTC RETAIL, L.C.
 1355 BEVERLY ROAD, SUITE 240
 MCLEAN, VIRGINIA 22101
 ATTN: KATHRYN L. KUBIT
 TEL: 703-734-9730

SCALE: 1" = 10'	ZONING: RMX-2
DATE: NOV., 2023	TAX MAP - GRD: EW-42

STORMWATER MANAGEMENT COMPOSITE PLAN
CLARKSBURG TOWN CENTER WEST SIDE
 BLOCK A - PARCELS Q-R
 BLOCK BB - PARCELS A-H, AA, DD, J-M, LOTS 1-88
 BLOCK CC - PARCELS E, G, H
 BLOCK GG - PARCELS P-V
 CLARKSBURG ELECTION DISTRICT No. 02
 MONTGOMERY COUNTY, MARYLAND
 G. L. W. FILE No. 22074
 SHEET 2 OF 6