

MATCHLINE SEE SHEET 4

MATCHLINE SEE SHEET 6

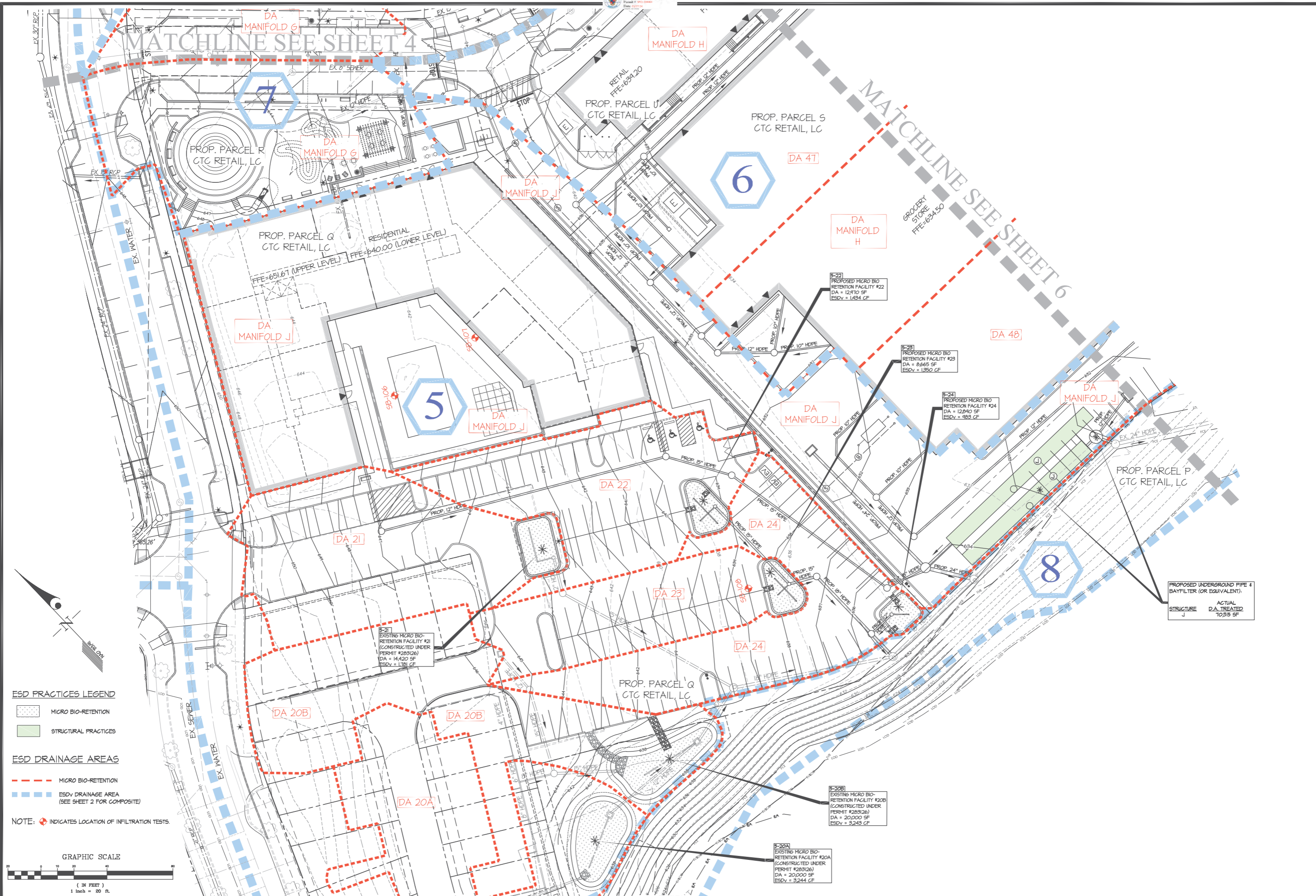

- ESD PRACTICES LEGEND**
- MICRO BIO-RETENTION
 - STRUCTURAL PRACTICES
- ESD DRAINAGE AREAS**
- MICRO BIO-RETENTION
 - ESD DRAINAGE AREA (SEE SHEET 2 FOR COMPOSITE)
- NOTE: INDICATES LOCATION OF INFILTRATION TESTS.

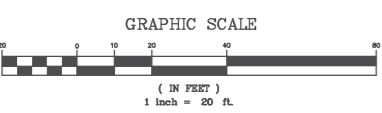

PROPOSED UNDERGROUND PIPE & BAYFILTER (OR EQUIVALENT).
 STRUCTURE J
 ACTUAL D.A. TREATED TO 315 SF

GLW
 PLANNING | ENGINEERING | SURVEYING
 3909 NATIONAL DRIVE | SUITE 250 | BURTONSVILLE, MD 20886 | GLWPA.COM
 PHONE: 301-421-4024 | BALT. 410-830-1020 | DC/VA: 301-688-2524 | FAX: 301-421-4188

DESIGNED BY	LMW	DATE	11/8/2023	REVISION	REVISED LAYOUT OF COMMERCIAL AREA
DRAWN BY	LMW	DATE		REVISION	
CHECKED BY	MAJ	DATE		REVISION	
DATE		DATE		REVISION	

PROFESSIONAL CERTIFICATION
 I HEREBY CERTIFY THAT THESE PLANS WERE PREPARED OR APPROVED BY ME, AND THAT I AM A DULY LICENSED PROFESSIONAL ENGINEER UNDER THE LAWS OF THE STATE OF MARYLAND, LICENSE NO. 29414.
 EXPIRATION DATE: JANUARY 22, 2024

PREPARED FOR:
 CTG RETAIL, L.C.
 1355 BEVERLY ROAD, SUITE 240
 MCLEAN, VIRGINIA 22101
 ATTN: KATHRYN L. KUBIT
 TEL: 703-734-9730

SCALE	1"=20'
DATE	NOV., 2023
ZONING	RMX-2
TAX MAP - GRID	EW-42

COMMERCIAL AREA STORMWATER MANAGEMENT DRAINAGE AREA MAP
 CLARKSBURG TOWN CENTER
 WEST SIDE
 BLOCK A - PARCELS Q-R
 BLOCK BB - PARCELS A-H, AA, DD, J-M, LOTS 1-88
 BLOCK CC - PARCELS E, G, H
 BLOCK GG - PARCELS P-Y
 CLARKSBURG ELECTION DISTRICT No. 02
 MONTGOMERY COUNTY, MARYLAND