

48 Hours
Before You Dig
Call
"MISS UTILITY"
Service Protection Center

MEMBER
ONE CALL SYSTEMS INTERNATIONAL

CALL TOLL FREE
1-800-257-7777

EXISTING UTILITY NOTES

- For marking locations of existing utilities, notify "MISS UTILITY" at 1-800-257-7777, 48 hours prior to any excavation or construction.
- Information concerning underground utilities was obtained from available records. The contractor must determine the exact locations and elevations of the utilities by digging test pits by hand at all utility crossings well in advance of trenching. If clearances are less than specified on this plan or less than 12 inches when not specified, contact the Engineer, and the owner of the other involved utility before proceeding with construction.
- For field location of gas line services, notify Washington Gas Light Co., 703-750-1000, 48 hours prior to the start of any excavation or construction.
- Omissions and/or additions of utilities found during construction shall be the sole responsibility of any contractor engaged in excavation at this site. Gutschick, Little & Weber, P.A., shall be notified immediately of any and all utility information, omissions and additions found by any contractor.
- Due to the proximity of live underground and overhead utilities, we are not responsible for any damage or injury sustained during construction by any persons, trucks, trailers, or equipment used on or adjacent to the site.

PAVING LEGEND
SEE LANDSCAPE DETAIL SHEETS PL-14 TO PL-26)
PAVING SURFACES ARE SHOWN IN GREATER DETAIL ON 10 SCALE PLANS ACCORDING TO THE FOLLOWING:

- SPECIAL SIDEWALK TREATMENT
- ASPHALT PAVING
- CONCRETE
- SHM ACCESS & FIRE ACCESS
- CROSSWALK TREATMENT
- EXISTING BRICK

IF A SPECIFIC DETAIL FOR A PAVING SURFACE IS NOT SHOWN ON THE 10 SCALE PLANS, THE 30 SCALE PLANS CONTROL.

LEGEND

- MFDU
- HIGH VISIBILITY LOT (SEE INDEX SHEET I-01)
- CAR SHARING PARKING SPACES
- ELECTRIC VEHICLE PARKING SPACES

LEGEND

- PUBLIC SIDEWALK
- ON-SITE SIDEWALK OR PATH
- EX. 8' SHARED USE PATH
- SHM ACCESS PATH
- NATURAL SURFACE TRAIL
- PUBLIC TRANSPORTATION STOP
- PROPOSED BUILDING ADDITION
- EXISTING BUILDING

GENERAL NOTES

- FOR ALL DEVELOPMENT STANDARDS GENERAL NOTE, AND OVERALL PROJECT INFORMATION SEE INDEX SHEETS.
- M-NCPPC STAFF MUST INSPECT ALL TREE-SAVE AREAS AND PROTECTION DEVICES PRIOR TO CLEARING AND GRADING.

PROFESSIONAL CERTIFICATION

I hereby certify that to the best of my knowledge, information and the belief that the plan shown hereon is true and correct has been prepared in accordance with the Zoning Regulations of Montgomery County, Maryland. I hereby certify that these plans were prepared or approved by me, and that I am a duly licensed Professional Engineer under the laws of the State of Maryland.

License No. 28414
Expiration Date: January 20, 2026

August 1, 2024
Date



Tin Longfellow
Professional Engineer
Gutschick, Little & Weber, P.A.
Conditional Use Plan No. CU2024-

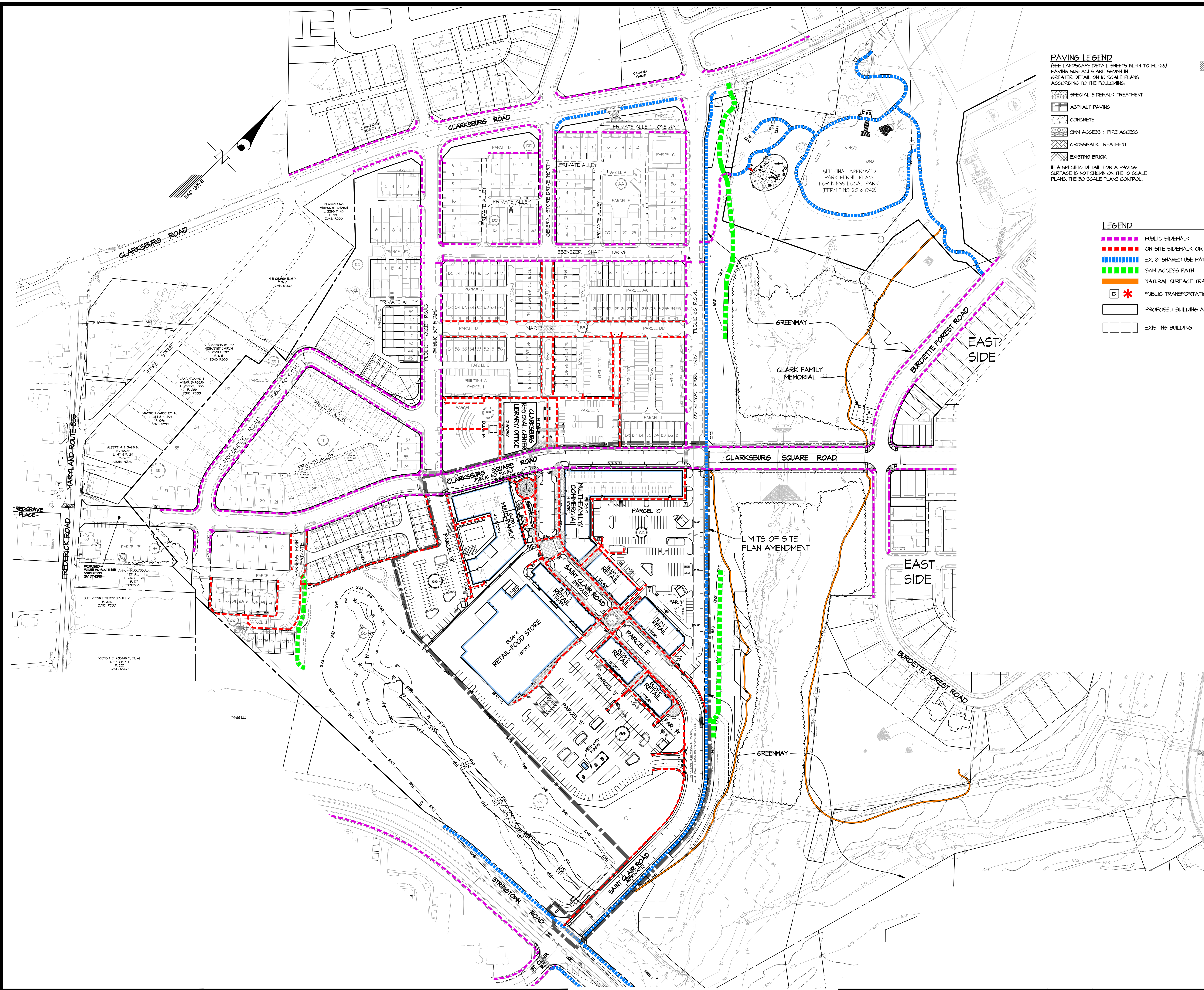

GLW
PLANNING [ENGINEERING] SURVEYING

3809 NATIONAL DRIVE | SUITE 250 | BURTONSVILLE, MD 20896 | GLWPA.COM
PHONE: 301-421-4024 | BALT.: 410-880-1800 | DC/VA: 301-489-2024 | FAX: 301-421-4138

DESIGNED BY	DATE	REVISION	BY	APPR.
KAF				
DRAWN BY				
JGJ				
CHECKED BY				
KAF				

PREPARED FOR:
CTC RETAIL, L.C.
c/o ELM STREET DEVELOPMENT
1355 BEVERLY ROAD, SUITE 240
MCLEAN, VIRGINIA 22101
ATTN: KATHRYN L. KUBIT
703-734-9730

SCALE	ZONING
1"=100'	CRT-0.75 C-0.25, R-0.5, H-65T
DATE	TAX MAP - GRID
JULY 2024	EW-42

CIRCULATION PLAN

CLARKSBURG TOWN CENTER
WEIS GAS PUMPS
Parcel S
Ex. Parcel K - Plat No. 25584

COLESVILLE ELECTION DISTRICT No. 05

MONTGOMERY COUNTY, MARYLAND

G. L. W. FILE No.
23136

SHEET
1 OF 1