

**GLENMONT FOREST  
 CR FLOATING ZONE**

Montgomery County, Maryland, Election District No. 13

Gross Tract Area Tabulation (in Square Feet)		
Glenmont Forest Investors Limited Partnership (L.6584 F.619)		
Area A	1,130,414	Residue of Parcel A - Americana Glenmont Apartments (Plat No. 6337).
Area A-1	6,294	Georgia Avenue (Md. Rt. 97) Dedication (Plat No. 6337).
Area A-2	22,966	Randolph Road (Md. Rt. 183) Dedication (Plat No. 6337).
Area A-3	12,918	1/2 Width of Starling Drive Dedication (Plat No. 6337).
Area A-4	18,408	Georgia Avenue (MD Rt. 97) (See General Note 2)
Area B	291,308	Residue of Parcel B - Americana Glenmont Apartments (Plat No. 8065).
Area B-1	36,634	Randolph Road (Md. Rt. 183) Dedication (Plat No. 8065).
<b>Total</b>	<b>1,518,942</b>	<b>Gross Tract Area</b>

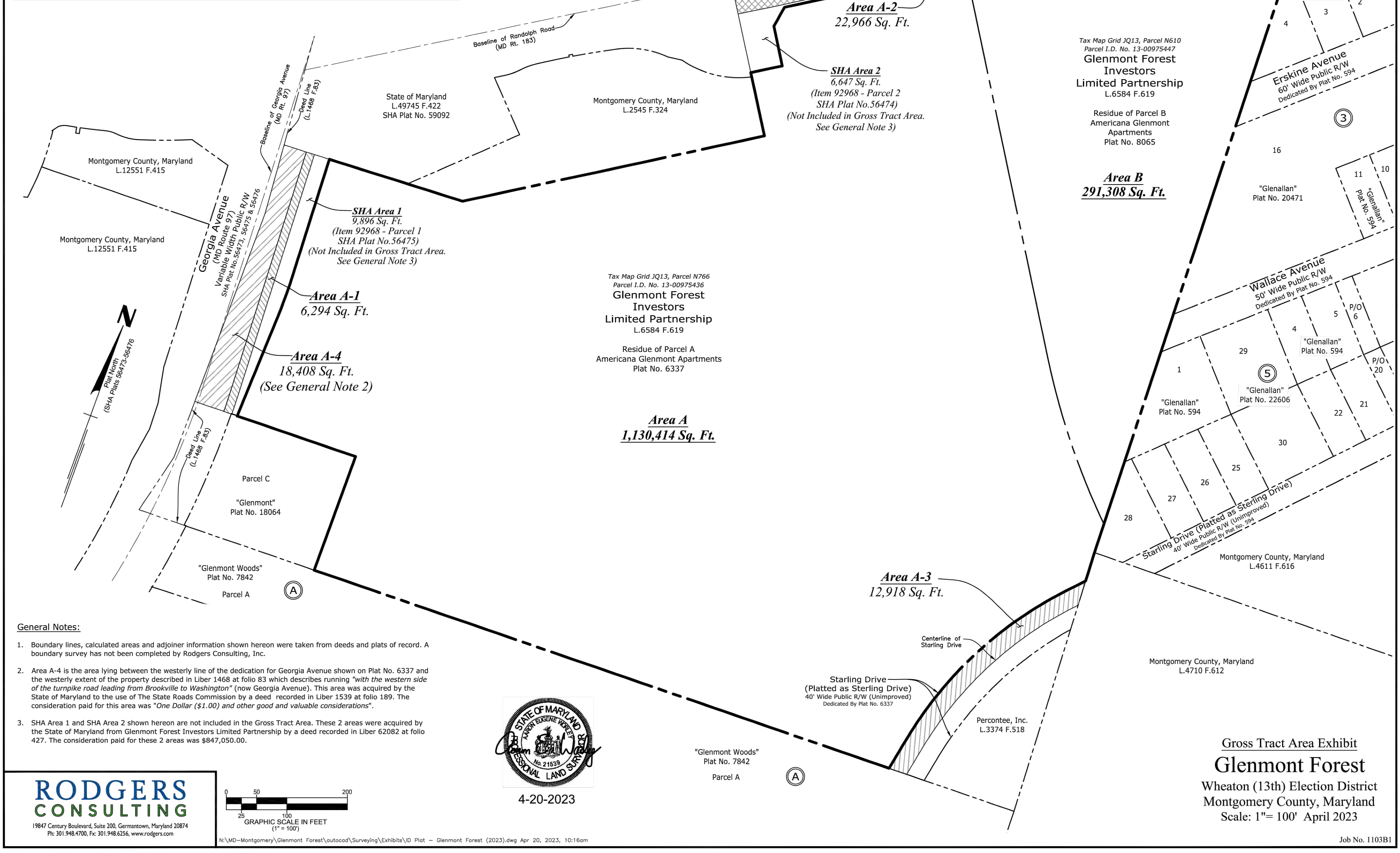

- General Notes:**
- Boundary lines, calculated areas and adjoiner information shown hereon were taken from deeds and plats of record. A boundary survey has not been completed by Rodgers Consulting, Inc.
  - Area A-4 is the area lying between the westerly line of the dedication for Georgia Avenue shown on Plat No. 6337 and the westerly extent of the property described in Liber 1468 at folio 83 which describes running "with the western side of the turnpike road leading from Brookville to Washington" (now Georgia Avenue). This area was acquired by the State of Maryland to the use of The State Roads Commission by a deed recorded in Liber 1539 at folio 189. The consideration paid for this area was "One Dollar (\$1.00) and other good and valuable considerations".
  - SHA Area 1 and SHA Area 2 shown hereon are not included in the Gross Tract Area. These 2 areas were acquired by the State of Maryland from Glenmont Forest Investors Limited Partnership by a deed recorded in Liber 62082 at folio 427. The consideration paid for these 2 areas was \$847,050.00.

**RODGERS CONSULTING**  
 19847 Century Boulevard, Suite 200, Germantown, Maryland 20874  
 Pk: 301.948.4700, Fx: 301.948.6256, www.rodgers.com

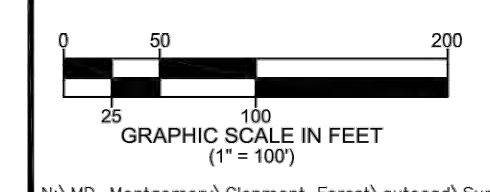

Gross Tract Area Exhibit  
**Glenmont Forest**  
 Wheaton (13th) Election District  
 Montgomery County, Maryland  
 Scale: 1" = 100' April 2023

Job No. 1103B1

**Exhibit 8  
 H-149**

OFFICE OF ZONING AND ADMINISTRATIVE HEARINGS CERTIFICATION  
 THIS IS A TRUE COPY OF THE FLOATING ZONE PLAN (EXHIBIT NUMBER \_\_\_\_\_)  
 APPROVED BY THE DISTRICT COUNCIL ON \_\_\_\_\_, BY RESOLUTION NUMBER \_\_\_\_\_  
 IN APPLICATION NUMBER \_\_\_\_\_  
 HEARING EXAMINER \_\_\_\_\_ DATE \_\_\_\_\_  
 HEARING EXAMINER NAME (PRINTED) \_\_\_\_\_

PROJECT NUMBER	1103B
DATE	OCTOBER 2023
SCALE	1" = 100'
DRAWING TITLE	ID Plat