

PARKLAWN CENTER LLC
L17650 F.88

WASHINGTON ROCKVILLE INDUSTRIAL PARK
LOT 8, BLOCK D
PLAT No. 11545

PDC LEXINGTON LLC
B.67424 P.300

NORTH BETHESDA INDUSTRIAL CENTER
LOT 6
PLAT No. 9530
93,641 sq. ft.
or 2.14970 Ac.

EXTRA SPACE OF ROCKVILLE LLC
L32970 F.131

NORTH BETHESDA INDUSTRIAL CENTER
LOT 10
PLAT No. 20201

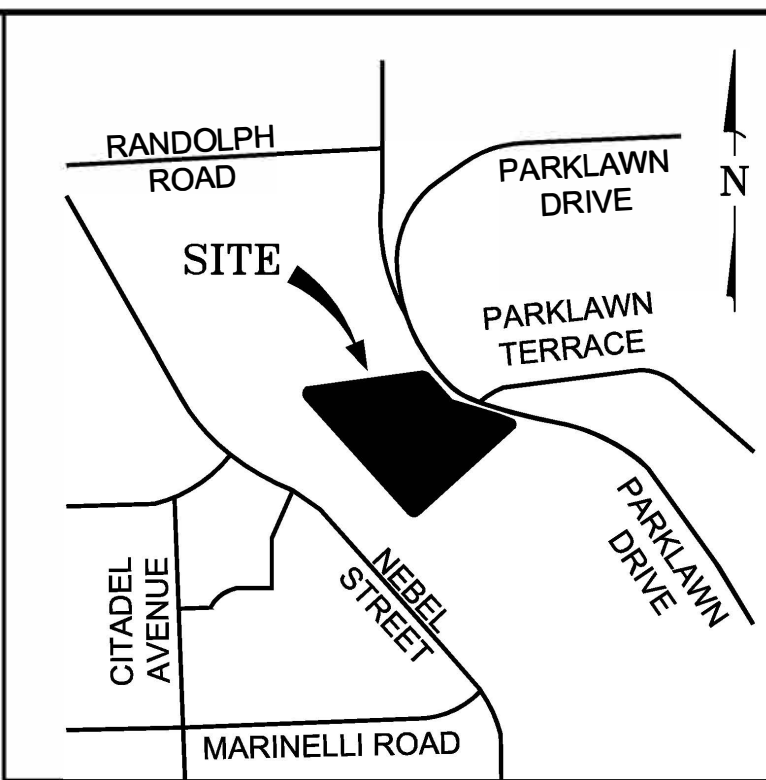

VICINITY MAP
SCALE 1" = 2,000'

CURVE TABLE						
CURVE	LENGTH	RADIUS	DELTA	TANGENT	CHORD BEARING	CHORD
C1	46.65'	888.90'	3°00'25"	23.33'	S 40°30'58" E	46.65'
C2	50.97'	590.00'	4°56'59"	25.50'	S 69°20'06" E	50.95'

NOTES:

- Horizontal Datum is based on the recorded plat of subdivision in the Land Records of Montgomery County, Maryland at Plat Book 59 Plat 9530.
- This plat was prepared with the benefit of a title commitment prepared by Fidelity National Title Insurance Company, Commitment Number DC2400035, effective date December 26, 2023 at 12:00 am, the exceptions listed therein, that were located by deed, as shown hereon. This identification plat may not reflect all easements or encumbrances on the Lot or Parcel shown hereon.
- This plat was prepared as part of a request for a local map amendment to be reviewed by the Office of Zoning and Administrative Hearings (OZAH).

LEGAL DESCRIPTION
EXHIBIT "A"

THE LAND REFERRED TO HEREIN BELOW IS SITUATED IN MONTGOMERY COUNTY, STATE OF MARYLAND, AND IS DESCRIBED AS FOLLOWS:

Lot numbered Six (6) in a subdivision known as "NORTH BETHESDA INDUSTRIAL CENTER", as per plat thereof recorded in Plat Book 89 at Plat 9530 among the Land Records of Montgomery County, Maryland.

SURVEYOR'S CERTIFICATE

I hereby certify the information shown hereon is correct. That it reflects the information recorded among the Land Records of Montgomery County, Maryland for the subject and surrounding properties.

This Identification Plat was prepared by me or under my direct supervision in accordance with the regulations governing land surveying in the State of Maryland.

June 5, 2024

Wayne F. Aubertin
Macris, Hendricks, and Glascock, P.A.
By: Wayne F. Aubertin
Professional Land Surveyor
Maryland Reg. No. 21330
Expiration Date: January 07, 2025

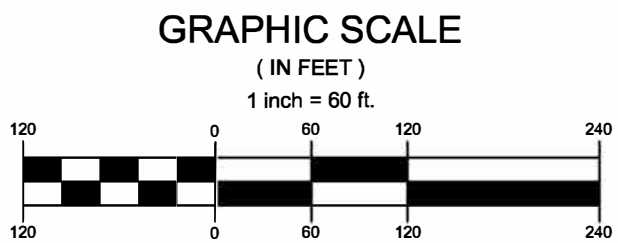

**Exhibit 7
H-154**

IDENTIFICATION PLAT
LOT 6
NORTH BETHESDA INDUSTRIAL CENTER

ELECTION DISTRICT NO. 4
MONTGOMERY COUNTY, MARYLAND

PROJECT NO. 23.193.21
SCALE 1" = 60'
DATE 6/5/2024

MHG CIVIL ENGINEERING
LAND SURVEYING
LANDSCAPE ARCHITECTURE
LAND PLANNING

9220 WIGHTMAN ROAD, SUITE 120
MONTGOMERY VILLAGE, MD 20886

301.670.0840
MHGPA.COM