

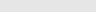

LEGEND

-  Proposed Residential Building
-  Subject Property Limits
-  Proposed Face of Curb
-  Proposed Public Utility Easement
-  Proposed Sidewalk
-  Proposed SWM Facility

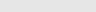
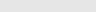

TRAFFIC ENGINEER:
GOROVE SLADE
 4550 MONTGOMERY AVE
 SUITE 400
 BETHESDA MD, 20814
 202.540.1927
 CONTACT: KATIE WAGNER, P.E.
klw@goroveslade.com

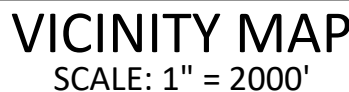
PROFESSIONAL SEAL

SHEET NO.

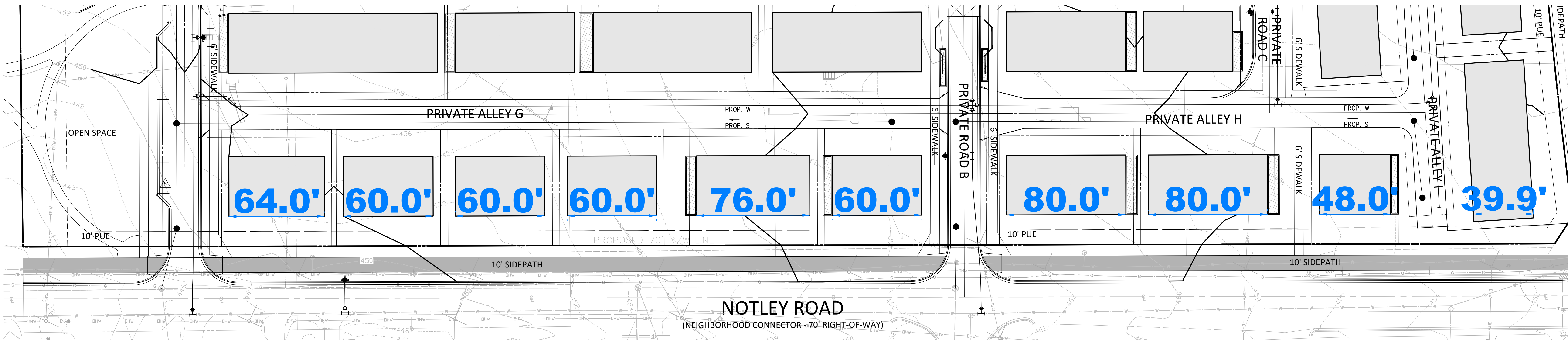

The excavator must notify all public utility companies with underground facilities in the area of proposed excavation and have those facilities located by the utility companies prior to commencing excavation. The excavator is responsible for compliance with requirements of Chapter 36A of the Montgomery County Code.

