

RECORD DRAWING CERTIFICATION

A record set of approved Sediment Control/Stormwater Management plans must be maintained on-site at all times. In addition to stormwater management items, these plans must include the number and location of all trees proposed to be planted to comply with the Tree Canopy Law. Any approved modifications or deletions of stormwater practices or tree canopy plantings or information must be shown on this record set of plans and on the Tree Canopy Requirements table. Upon completion of the project, this record set of plans, including hereon this signed Record Drawing Certification, must be submitted to the MCDPS Inspector. In addition to this Record Drawing Certification, a formal Stormwater Management As-Built submission is required. is not required for this project.

If this project is subject to a Stormwater Management Right of Entry and Maintenance Agreement, that document is recorded in Montgomery County Land Records at:

Liber NA Folio NA. This Record Drawing will serve as referenced in the recorded document.

"This record drawing accurately and completely represents the stormwater management practices and tree canopy plantings as they were constructed or planted. All stormwater management practices were constructed per the approved Sediment Control / Stormwater Management plans or subsequent approved revisions."

Owner/Developer Signature _____ Date _____

FIELD CHECK OF RECORD DRAWING BY MCDPS INSPECTOR: INITIALS: _____ DATE: _____

MONTGOMERY COUNTY
DEPARTMENT OF TRANSPORTATION

MD 198 (SANDY SPRING ROAD)
FROM DINO DRIVE TO MCKNEW ROAD
SIDEWALK IMPROVEMENTS

C. I. P. PROJECT NO. 502406
SHA TRACKING NO. T.B.D.

INDEX OF SHEETS

SHEET NO.	DGN NO.	DGN. DESCRIPTION
1	GT-OI	TITLE SHEET
2	GN-OI	ABBREVIATIONS, CONVENTIONAL SIGNS, & STANDARD SYMBOLS
3	HT-OI	TYPICAL SECTIONS
4	DE-OI	MISCELLANEOUS DETAILS
5	GS-OI	GEOMETRIC LAYOUT
6-8	HD-OI TO HD-O3	ROADWAY PLAN
9-11	SW-OI TO SW-O3	STORMWATER MANAGEMENT PLAN AND DETAILS

TREE CANOPY REQUIREMENTS TABLE	
To be completed by the consultant and placed on the first sheet of the Sediment Control / Stormwater Management plan set for all projects.	
Exempt: Yes <input type="checkbox"/> No <input checked="" type="checkbox"/> If exempt under Section 55-5 of the Code, please check the applicable exemption category below.	
Total Property Area ROW square feet	Total Disturbed Area 53,191 square feet
Shade Trees Required 20	Shade Trees Proposed to be Planted 0
Fee in Lieu (Trees Required - Trees Planted) x \$250	\$ 5,000
Required Number of Shade Trees	
Area (sq. ft.) of the Limits of Disturbance	Number of Shade Trees Required
FROM TO	
1 6,000	3
6,001 8,000	6
8,001 12,000	9
12,001 14,000	12
14,001 40,000	15
If the square footage of the limits of disturbance is more than 40,000, then the number of shade trees required must be calculated using the following formula: (Number of Square Feet in Limits of Disturbance ÷ 40,000) x 15	
EXEMPTION CATEGORIES:	
<input type="checkbox"/> 55-5(a) any activity that is subject to Article II of Chapter 22A;	maintenance has obtained all required permits;
<input type="checkbox"/> 55-5(b) any commercial logging or timber harvesting operation with an approved exemption from Article II of Chapter 22A;	<input type="checkbox"/> 55-5(b) any stream restoration project if the person performing the work has obtained all necessary permits;
<input type="checkbox"/> 55-5(i) any activity conducted by the County Parks Department;	<input type="checkbox"/> 55-5(i) cutting or clearing any tree to comply with applicable provisions of any federal, state, or local law governing safety of dams;
<input type="checkbox"/> 55-5(j) routine or emergency maintenance of an existing stormwater management facility, including an existing access road, if the person performing the	<input type="checkbox"/> OTHER: Specify per Section 55-5 of the Code.

GENERAL NOTES

- ALL CONSTRUCTION SHALL BE DONE IN ACCORDANCE WITH THE LATEST EDITION OF THE STANDARD SPECIFICATIONS OF THE MARYLAND STATE HIGHWAY ADMINISTRATION, MONTGOMERY COUNTY, AND THE WASHINGTON SUBURBAN SANITARY COMMISSION.
- TYPES OF STORM DRAIN STRUCTURES REFER TO THE "DESIGN STANDARDS" OF MONTGOMERY COUNTY DEPARTMENT OF TRANSPORTATION, UNLESS OTHERWISE NOTED.
- ALL STORM DRAIN PIPE SHALL BE INSTALLED WITH CLASS "C" BEDDING UNLESS OTHERWISE SPECIFIED.
- THE CONTRACTOR SHALL MAKE FIELD ADJUSTMENTS TO STORM DRAIN STRUCTURES, WHEN NECESSARY, TO MEET EXISTING CONDITIONS, AS APPROVED BY MONTGOMERY COUNTY DEPARTMENT OF TRANSPORTATION'S PROJECT INSPECTOR.
- INFORMATION CONCERNING UNDERGROUND UTILITIES WAS OBTAINED FROM AVAILABLE RECORDS, BUT THE CONTRACTOR MUST DETERMINE THE EXACT LOCATIONS AND ELEVATIONS OF THE LINES BY DIGGING TEST PITS BY HAND AT ALL UTILITY CROSSINGS, WELL IN ADVANCE OF TRENCHING. IF CLEARANCES ARE LESS THAN SHOWN OR SIX (6) INCHES, WHICHEVER IS LESS, CONTACT MONTGOMERY COUNTY DEPARTMENT OF TRANSPORTATION'S PROJECT INSPECTOR AND THE APPROPRIATE UTILITY OWNER BEFORE PROCEEDING WITH CONSTRUCTION.
- REPAIRS TO UTILITIES OR PROPERTY DAMAGE AS A RESULT OF THE CONTRACTOR'S NEGLIGENCE OR METHOD OF OPERATION MUST BE MADE AT THE CONTRACTOR'S EXPENSE BEFORE PROCEEDING WITH CONSTRUCTION.
- CALL "MISS UTILITY" AT 1-800-257-7777, 48 HOURS PRIOR TO THE START OF WORK. THE EXCAVATOR MUST NOTIFY ALL PUBLIC UTILITY COMPANIES WITH UNDER GROUND FACILITIES IN THE AREA OF PROPOSED EXCAVATION AND HAVE THOSE FACILITIES LOCATED BY THE UTILITY COMPANIES PRIOR TO COMMENCING EXCAVATION. THE EXCAVATOR IS RESPONSIBLE FOR COMPLIANCE WITH REQUIREMENTS OF CHAPTER 36A OF THE MONTGOMERY COUNTY CODE.
- CLEARING IS TO BE LIMITED TO THE "LIMIT OF DISTURBANCE" AS SHOWN ON THE PLANS.
- ALL GRADING SHALL BE DONE IN SUCH A MANNER AS TO PROVIDE POSITIVE DRAINAGE.
- ALL DISTURBED AREAS MUST BE TOPSOILED PER THE MDE "2011 STANDARDS AND SPECIFICATIONS FOR SOIL EROSION AND SEDIMENT CONTROL", PRIOR TO FINAL VEGETATIVE STABILIZATION
- ALL DISTURBED AREAS TO BE STABILIZED PER MDE REQUIREMENTS.
- HORIZONTAL DATUM: MSHA, NAD 83/91 VERTICAL DATUM: NAVD 88

DRAINAGE STATEMENT

I understand that DPS approval of this sediment control/stormwater management plan is for demonstrated compliance with required environmental runoff treatment standards. This DPS sediment control/stormwater management plan approval does not relieve me of professional responsibility. I have analyzed the proposed design for sediment control permit no. _____ and hereby state that, based upon my background, training and experience, I have determined that the proposed improvements shown on this plan meet relevant laws and regulations. I further acknowledge that I have analyzed the post development drainage patterns for this project from the standpoint of my responsibilities under current Maryland Law and have determined that if permission is required from adjacent property owners, it has been obtained and copies of those permissions have been made available to DPS.

Engineer's Signature _____

Date _____

Printed Name _____

GT-OI

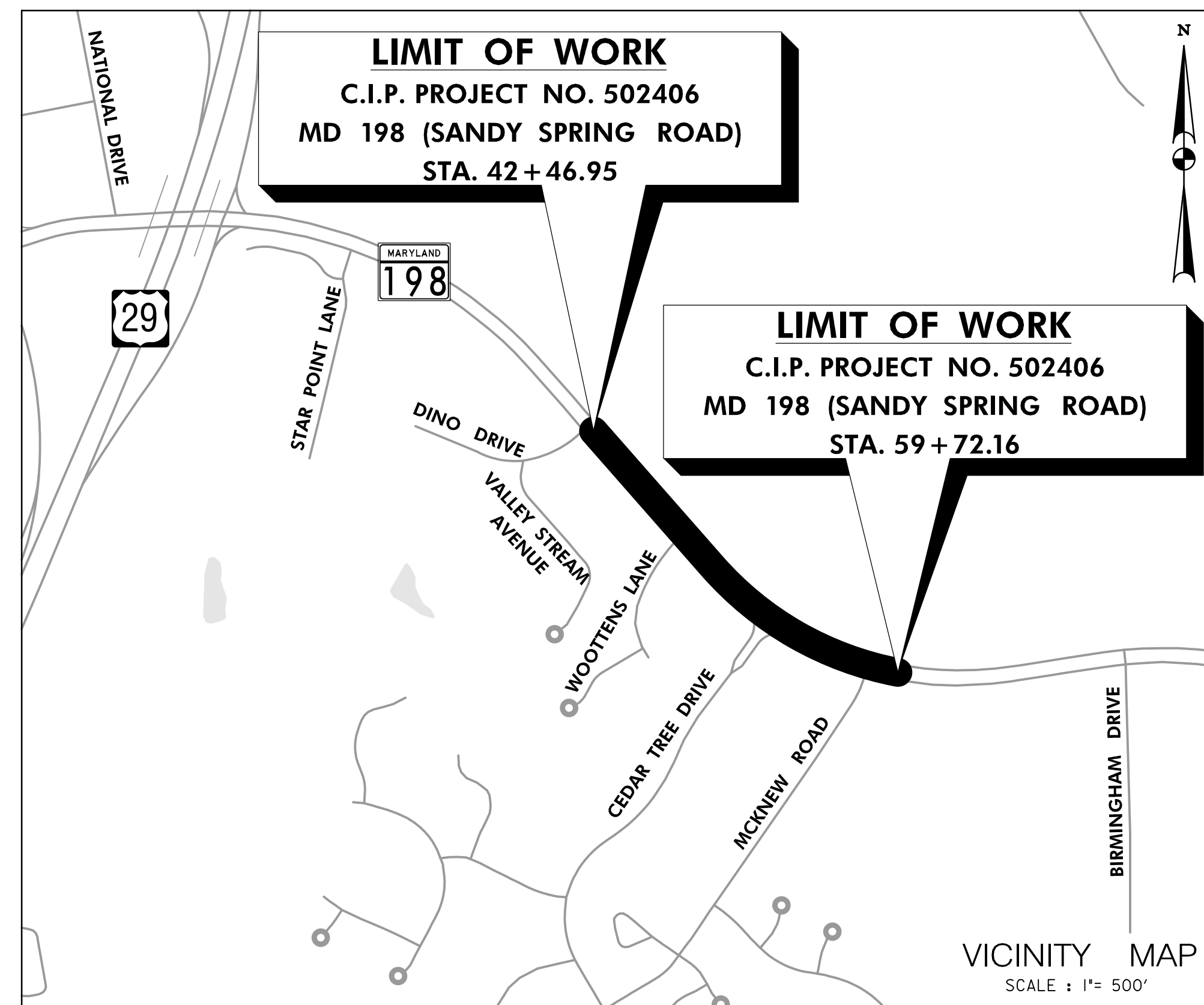

VICINITY MAP
SCALE: 1" = 500'
PROJECT LENGTH = 0.33 MILES

RELATED REQUIRED PERMITS

To be completed by the consultant and placed on the first sheet of the Sediment Control / Stormwater Management plan set for all projects.

IT IS THE RESPONSIBILITY OF PERMITTEE/OWNER OF THIS SITE TO OBTAIN ALL REQUIRED PERMITS PRIOR TO ISSUANCE OF THE APPROVED SEDIMENT CONTROL PERMIT

TYPE OF PERMIT	REQD	NOT REQD	PERMIT #	EXPIRATION DATE	WORK RESTRICTION DATES
MCDPS Floodplain District		<input checked="" type="checkbox"/>			
WATERWAYS/WETLAND(S):		<input checked="" type="checkbox"/>			
a. Corps of Engineers		<input checked="" type="checkbox"/>			
b. MDE		<input checked="" type="checkbox"/>			
c. MDE Water Quality Certification		<input checked="" type="checkbox"/>			
MDE Dam Safety		<input checked="" type="checkbox"/>			
DNR Roadside Tree Care Permit	<input checked="" type="checkbox"/>		T.B.D.	Approval Date T.B.D.	
DPS Roadside Tree Protection Plan	<input checked="" type="checkbox"/>		T.B.D.	Approval Date T.B.D.	
N.P.D.E.S. NOTICE OF INTENT	<input checked="" type="checkbox"/>				DATE FILED
OTHERS (Please List):		<input checked="" type="checkbox"/>			

MONTGOMERY COUNTY DEPARTMENT OF PERMITTING SERVICES APPROVED FOR:

STORMWATER MANAGEMENT:	SEDIMENT CONTROL TECHNICAL REQUIREMENTS	ADMINISTRATIVE REQUIREMENTS
BIOSWALE		
REVIEWED DATE	REVIEWED DATE	REVIEWED DATE
T.B.D.		T.B.D.
APPROVED DATE	APPROVED DATE	SEDIMENT CONTROL PERMIT NO.
T.B.D.		
SM FILE #		

NOTE: MCDPS APPROVAL DOES NOT NEGATE THE NEED FOR A MCDPS ACCESS PERMIT

MCDPS APPROVAL OF THIS PLAN WILL EXPIRE TWO YEARS FROM THE DATE OF APPROVAL IF THE PROJECT HAS NOT STARTED

DPS APPROVAL OF A SEDIMENT CONTROL OR SWM PLAN IS FOR DEMONSTRATED COMPLIANCE WITH MINIMUM ENVIRONMENTAL RUNOFF TREATMENT STANDARDS AND DOES NOT CREATE OR IMPLY ANY RIGHT TO DIVERT OR CONCENTRATE RUNOFF ONTO ANY ADJACENT PROPERTY WITHOUT THAT PROPERTY OWNER'S PERMISSION. IT DOES NOT RELIEVE THE DESIGN ENGINEER OR OTHER RESPONSIBLE PERSON OF PROFESSIONAL LIABILITY OR ETHICAL RESPONSIBILITY FOR THE ADEQUACY OF THE DRAINAGE DESIGN AS IT AFFECTS UPHILL OR DOWNHILL PROPERTIES

"I HEREBY CERTIFY THAT THESE DOCUMENTS WERE PREPARED OR APPROVED BY ME, AND THAT I AM A DULY LICENSED PROFESSIONAL ENGINEER UNDER THE LAWS OF THE STATE OF MARYLAND."

LICENSE NO. 35321

EXPIRATION DATE JANUARY 6, 2026



BY: CuIN

CONCEPT

MONTGOMERY COUNTY DEPARTMENT OF TRANSPORTATION GAITHERSBURG, MARYLAND	
Recommended for Approval:	
Chief, Transportation Planning and Design Section	Date
Approved:	
Chief, Division of Transportation Engineering	Date
Designed By JG	Drawn By JG
Checked By MCG	

MONTGOMERY COUNTY
DEPARTMENT OF TRANSPORTATION
DIVISION OF TRANSPORTATION ENGINEERING

TITLE SHEET

MD 198 (SANDY SPRING ROAD)
FROM DINO DRIVE TO MCKNEW ROAD
SIDEWALK IMPROVEMENTS

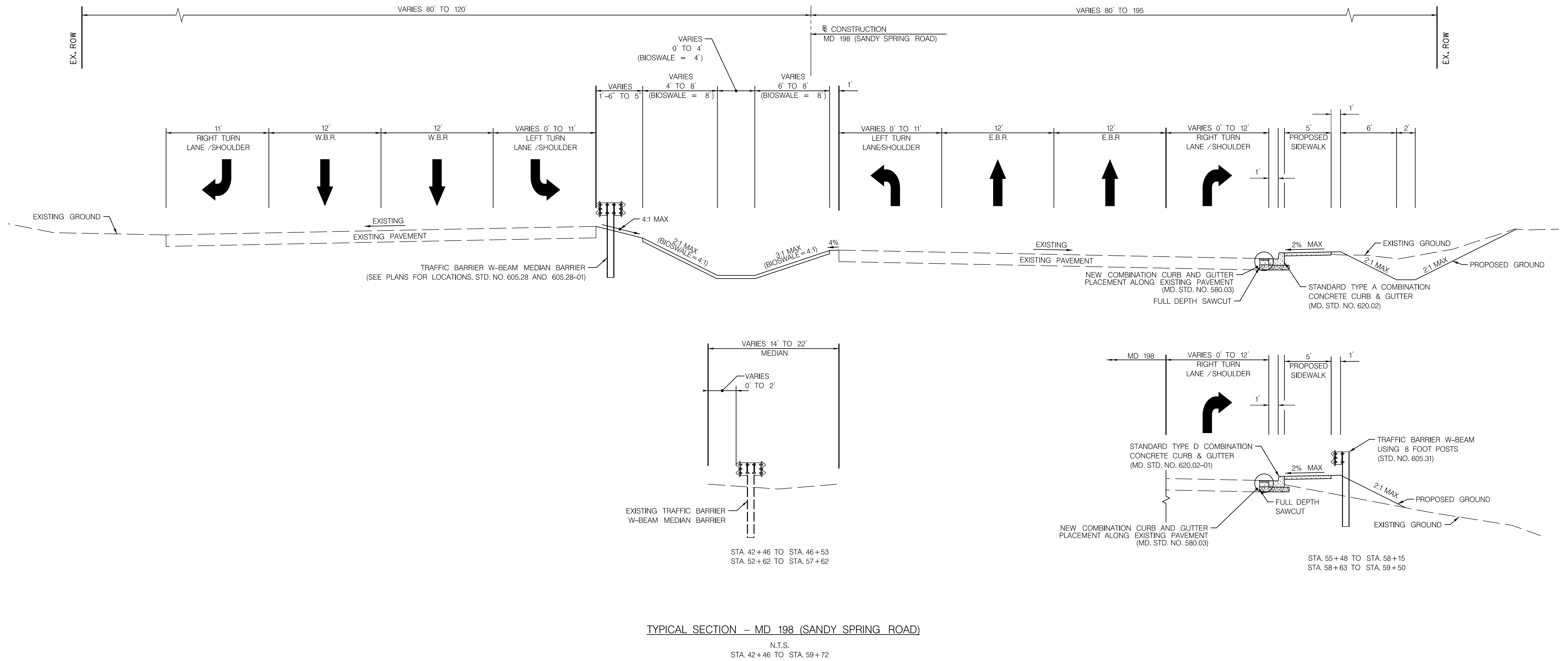

NOTE: PERMANENTLY STABILIZE ALL DISTURBED PERVIOUS AREAS WITH 4 INCH TOPSOIL AND TURFGRASS ESTABLISHMENT, UNLESS NOTED OTHERWISE.

"I HEREBY CERTIFY THAT THESE DOCUMENTS WERE PREPARED OR APPROVED BY ME, AND THAT I AM A DULY LICENSED PROFESSIONAL ENGINEER UNDER THE LAWS OF THE STATE OF MARYLAND."
 LICENSE NO. 33962
 EXPIRATION DATE JANUARY 14, 2025



BY: CuJN

CONCEPT

NO.	REVISION	BY	DATE

Designed By JNS Drawn By CAH Checked By JNS

MONTGOMERY COUNTY
 DEPARTMENT OF TRANSPORTATION
 DIVISION OF TRANSPORTATION ENGINEERING

TYPICAL SECTIONS
 MD 198 (SANDY SPRING ROAD)
 FROM DINO DRIVE TO MCKNEW ROAD
 SIDEWALK IMPROVEMENTS
 SCALE: N.T.S.

HT-01

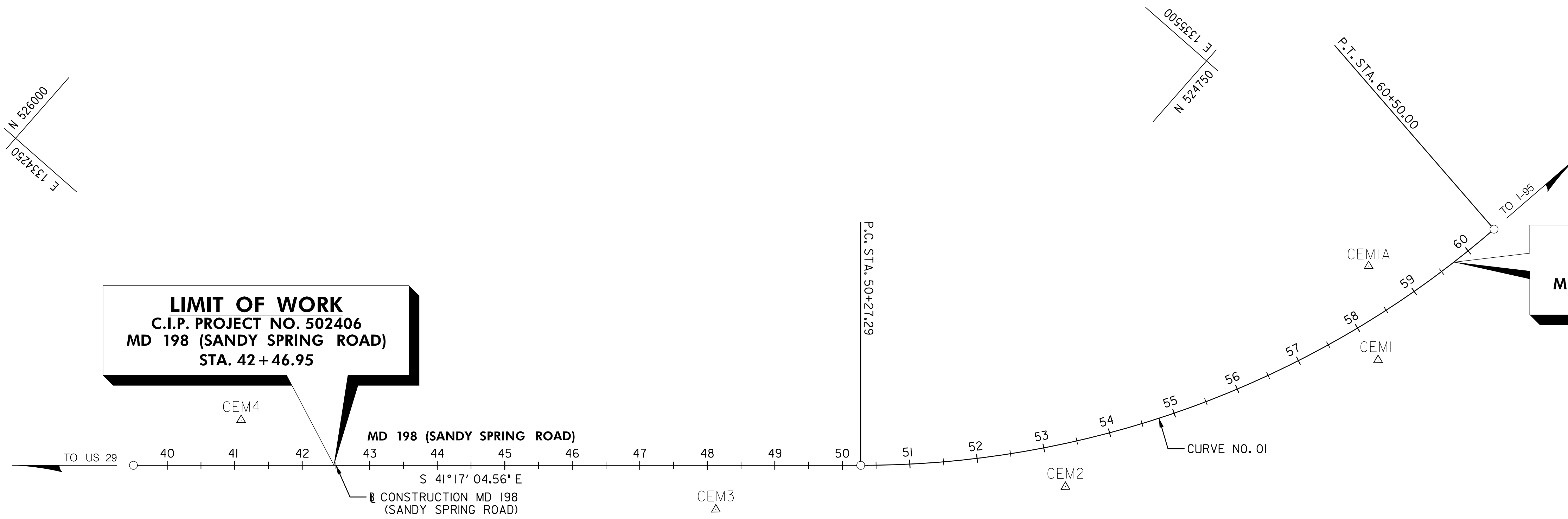
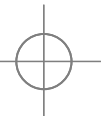
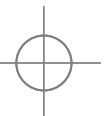
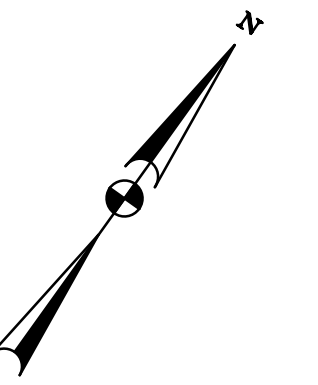

LIMIT OF WORK
 C.I.P. PROJECT NO. 502406
 MD 198 (SANDY SPRING ROAD)
 STA. 42+46.95

LIMIT OF WORK
 C.I.P. PROJECT NO. 502406
 MD 198 (SANDY SPRING ROAD)
 STA. 59+72.16

TRAVERSE POINTS			
POINT NO.	NORTH	EAST	ELEVATION
1	524,266.56	1,335,334.54	447.29'
1A	524,369.00	1,335,430.01	442.97'
2	524,490.70	1,334,887.93	453.65'
3	524,857.62	1,334,521.00	462.23'
4	525,473.41	1,334,156.62	463.37'

BASELINE COORDINATES		
STATION	NORTH	EAST
MD 198		
39+50.00 (P.O.B)	525,549.03	1,334,000.99
50+27.29 (P.C.)	524,739.51	1,334,711.78
60+50.00 (P.T.)	524,265.48	1,335,593.57

CURVE DATA						
CURVE	DELTA	Dc	RADIUS	TANGENT	LENGTH	EXTERNAL
01	40° 54' 30.24"	4° 00' 0.00"	1,432.395'	1,077.29'	1,022.71'	96.39'

GS-01

NO.	REVISION	BY	DATE

Designed By JNS Drawn By CAH Checked By JNS

MONTGOMERY COUNTY
 DEPARTMENT OF TRANSPORTATION
 DIVISION OF TRANSPORTATION ENGINEERING

GEOMETRIC LAYOUT

MD 198 (SANDY SPRING ROAD)
 FROM DINO DRIVE TO MCKNEW ROAD
 SIDEWALK IMPROVEMENTS

SCALE: 1" = 100'



"I HEREBY CERTIFY THAT THESE DOCUMENTS WERE PREPARED OR APPROVED BY ME, AND THAT I AM A DULY LICENSED PROFESSIONAL ENGINEER UNDER THE LAWS OF THE STATE OF MARYLAND."

LICENSE NO. 33962

EXPIRATION DATE JANUARY 14, 2025

CONCEPT

BY: CuJN

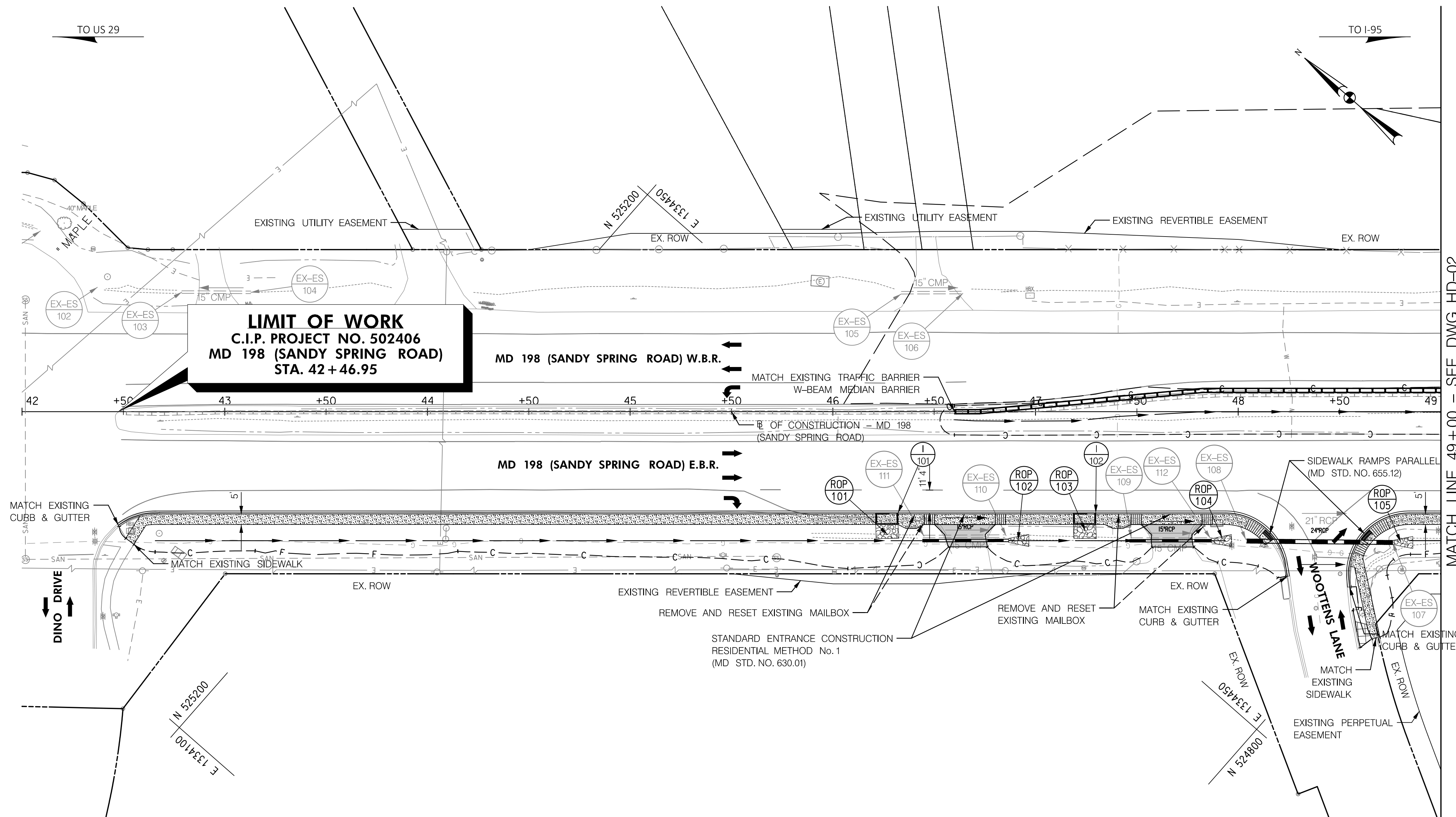

LIMIT OF WORK
C.I.P. PROJECT NO. 502406
MD 198 (SANDY SPRING ROAD)
STA. 42+46.95

MATCH LINE 49+00 - SEE DWG. HD-02

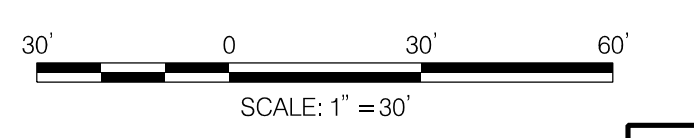

HD-01



"I HEREBY CERTIFY THAT THESE DOCUMENTS WERE PREPARED OR APPROVED BY ME, AND THAT I AM A DULY LICENSED PROFESSIONAL ENGINEER UNDER THE LAWS OF THE STATE OF MARYLAND."
 LICENSE NO. 33962
 EXPIRATION DATE JANUARY 14, 2025

CONCEPT

LEGEND

	PROPOSED SIDEWALK
	CONCRETE DRIVEWAY ENTRANCE
	REMOVAL OF EXISTING SIDEWALK
	FULL DEPTH ASPHALT
	DETECTABLE WARNING SURFACE

NO.	REVISION	BY	DATE

Designed By JNS Drawn By CAH Checked By JNS

MONTGOMERY COUNTY
DEPARTMENT OF TRANSPORTATION
DIVISION OF TRANSPORTATION ENGINEERING

ROADWAY PLAN

MD 198 (SANDY SPRING ROAD)
 FROM DINO DRIVE TO MCKNEW ROAD
 SIDEWALK IMPROVEMENTS

SCALE: 1" = 30'

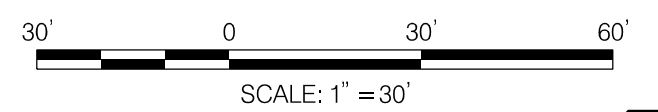
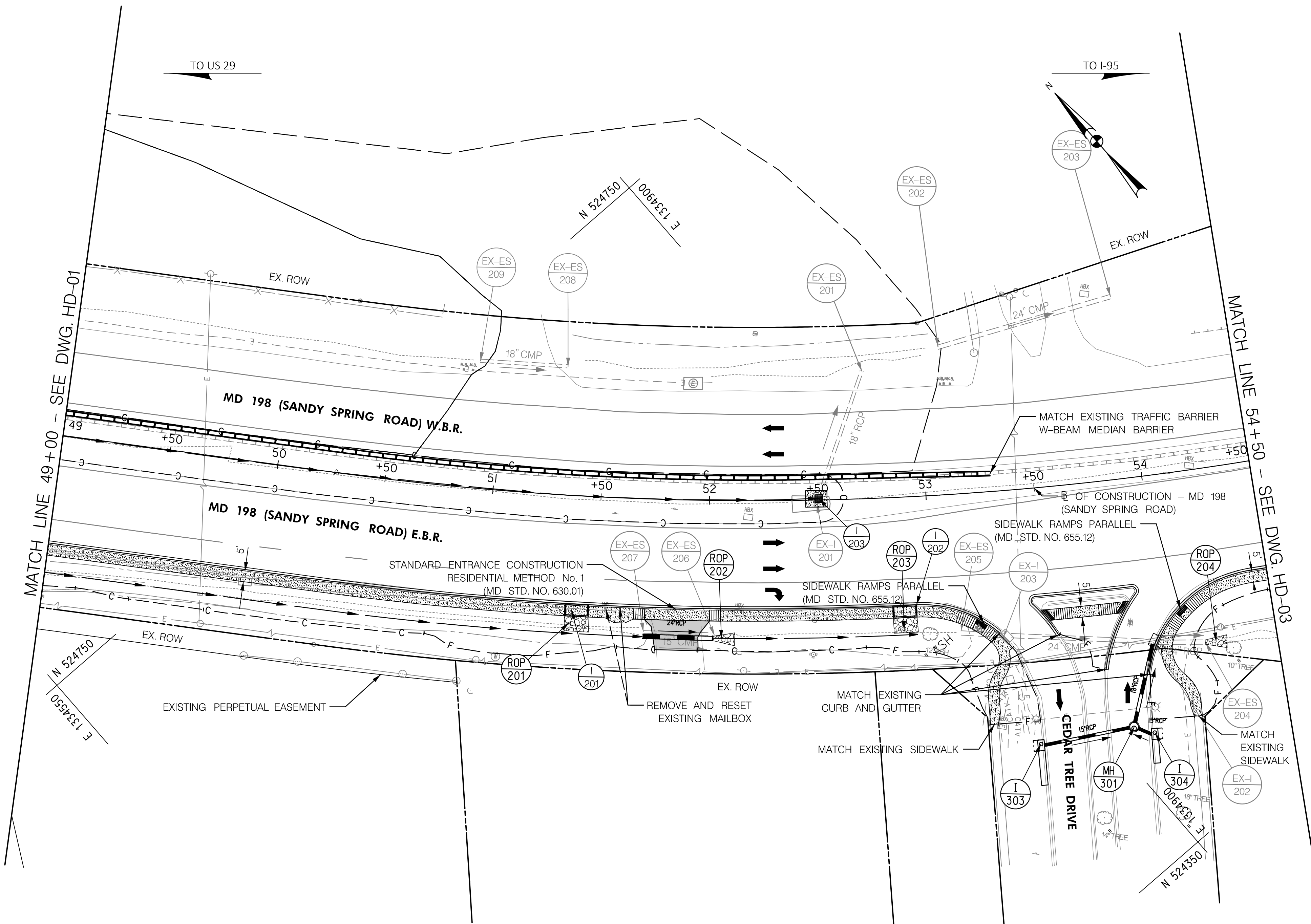

HD-02

LEGEND

	PROPOSED SIDEWALK
	CONCRETE DRIVEWAY ENTRANCE
	REMOVAL OF EXISTING SIDEWALK
	FULL DEPTH ASPHALT
	DETECTABLE WARNING SURFACE

NO.	REVISION	BY	DATE

Designed By JNS Drawn By CAH Checked By JNS

MONTGOMERY COUNTY
DEPARTMENT OF TRANSPORTATION
DIVISION OF TRANSPORTATION ENGINEERING

ROADWAY PLAN

MD 198 (SANDY SPRING ROAD)
FROM DINO DRIVE TO MCKNEW ROAD
SIDEWALK IMPROVEMENTS

SCALE: 1" = 30'



"I HEREBY CERTIFY THAT THESE DOCUMENTS WERE PREPARED OR APPROVED BY ME, AND THAT I AM A DULY LICENSED PROFESSIONAL ENGINEER UNDER THE LAWS OF THE STATE OF MARYLAND."

LICENSE NO. 33962

EXPIRATION DATE JANUARY 14, 2025

CONCEPT

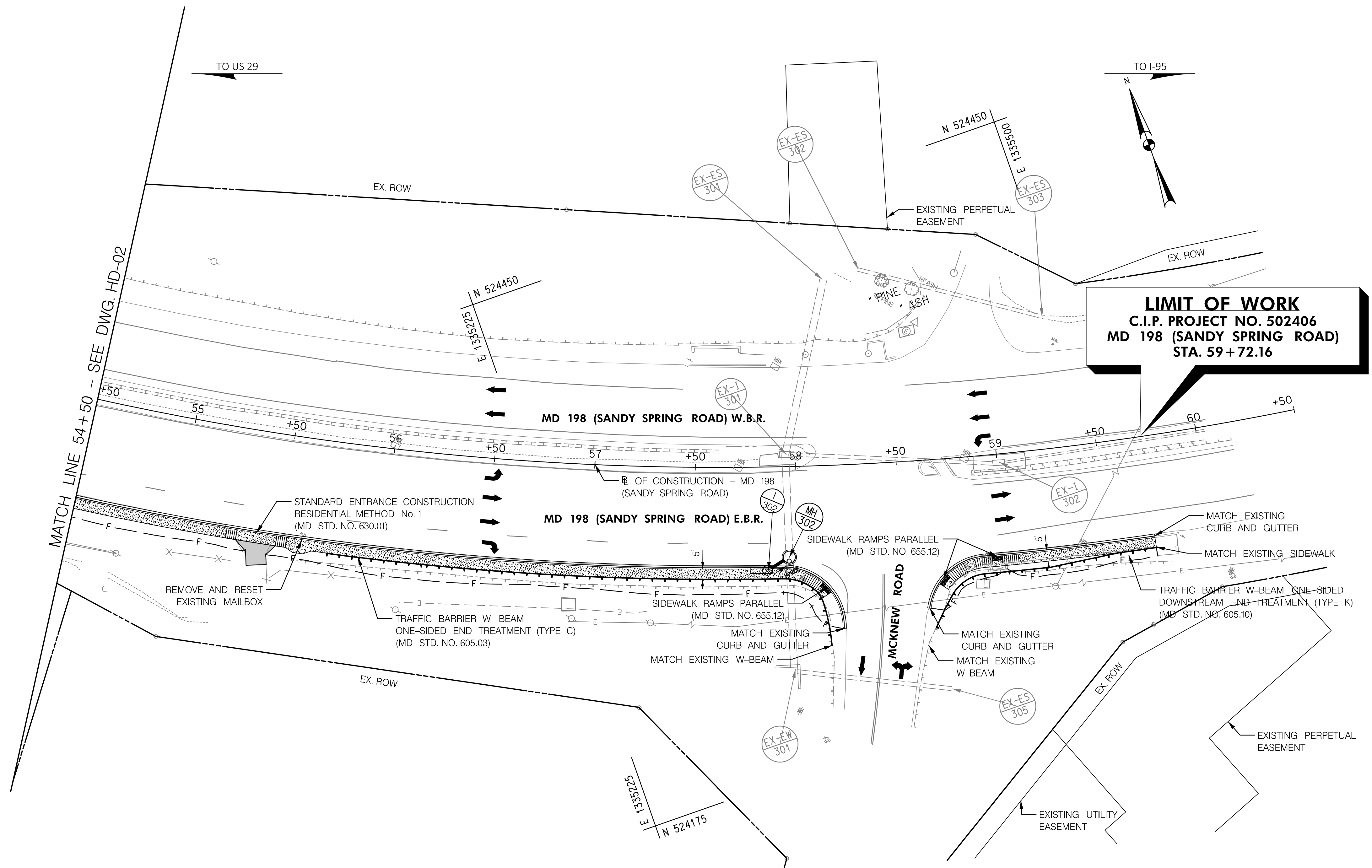

LIMIT OF WORK
C.I.P. PROJECT NO. 502406
MD 198 (SANDY SPRING ROAD)
STA. 59+72.16

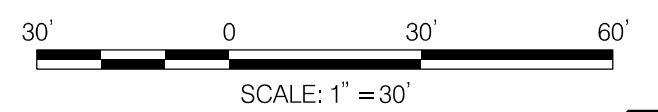

HD-03



"I HEREBY CERTIFY THAT THESE DOCUMENTS WERE PREPARED OR APPROVED BY ME, AND THAT I AM A DULY LICENSED PROFESSIONAL ENGINEER UNDER THE LAWS OF THE STATE OF MARYLAND."
 LICENSE NO. 33962
 EXPIRATION DATE JANUARY 14, 2025

CONCEPT

LEGEND

	PROPOSED SIDEWALK
	CONCRETE DRIVEWAY ENTRANCE
	REMOVAL OF EXISTING SIDEWALK
	FULL DEPTH ASPHALT
	DETECTABLE WARNING SURFACE

NO.	REVISION	BY	DATE

Designed By JNS Drawn By CAH Checked By JNS

MONTGOMERY COUNTY
DEPARTMENT OF TRANSPORTATION
DIVISION OF TRANSPORTATION ENGINEERING

ROADWAY PLAN

MD 198 (SANDY SPRING ROAD)
 FROM DINO DRIVE TO MCKNEW ROAD
 SIDEWALK IMPROVEMENTS

SCALE: 1" = 30'

MONTGOMERY COUNTY APPROVAL BLOCK

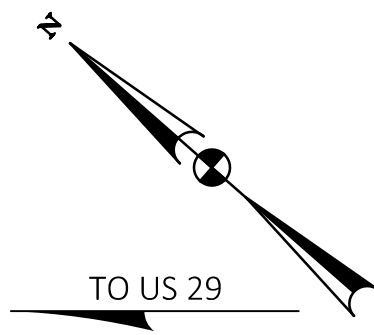

TO I-95

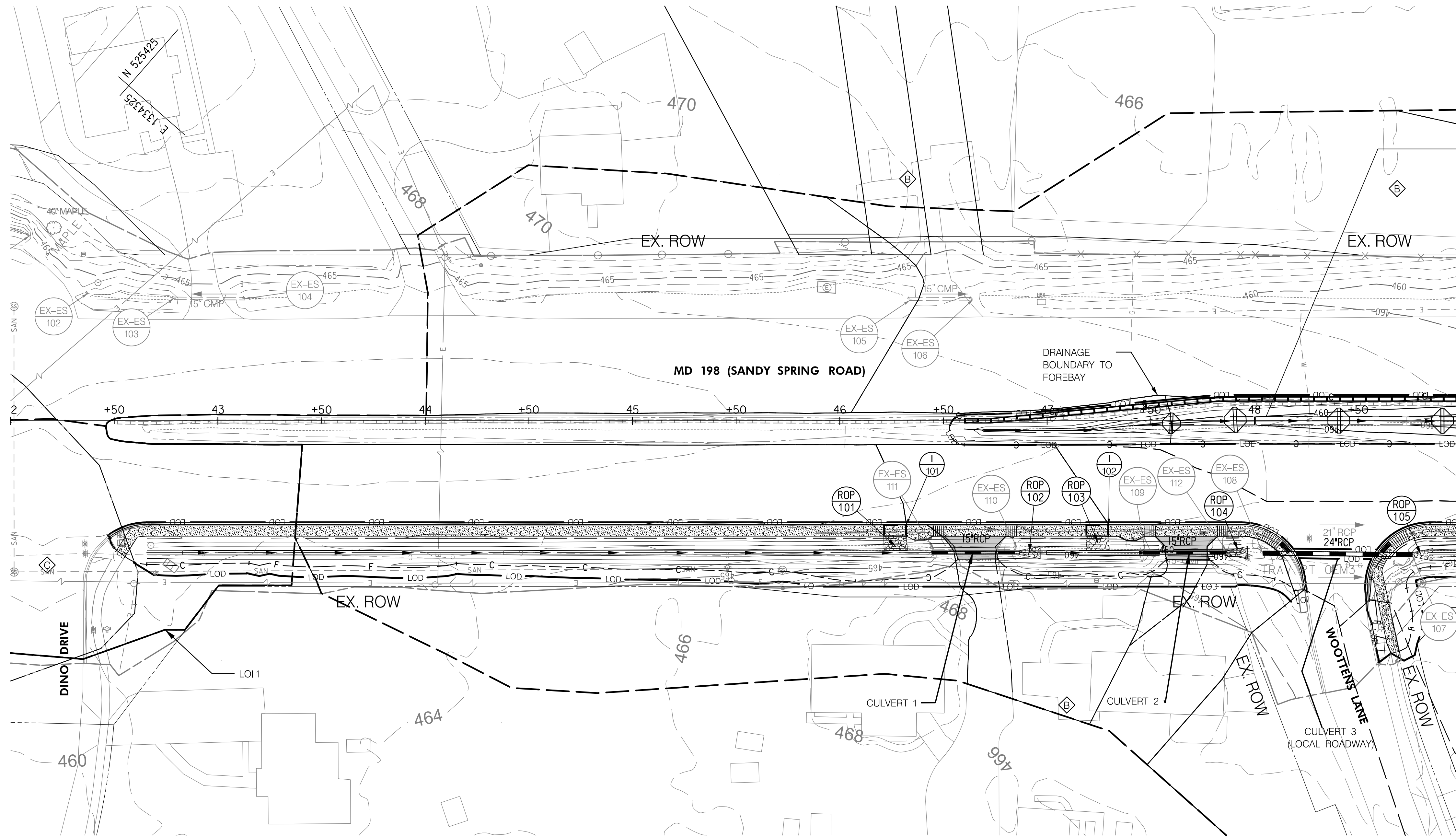

BS-101 BMP (ID. TBD)
DRAINAGE AREA=0.72 AC
PERCENT IMP.=42%
Q10=2.42 CFS
V10=0.42 FPS
V1=0.50 FPS
LONG SLOPE=0.017 FT/FT
SIDE SLOPES=4:1

MATCH LINE 49+00 - SEE DWG. SW-02

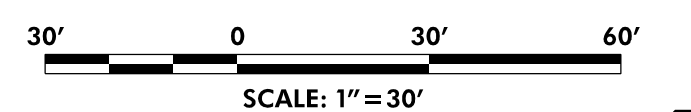

SCALE: 1"=30'

*DRAINAGE BOUNDARIES MAY APPEAR AS A SOLID LINE IN SOME LOCATIONS DUE TO OVERLAPS

LEGEND			
	HSG RATING		LIMIT OF DISTURBANCE (LOD)
	HSG BOUNDARY		DRAINAGE BOUNDARY TO SWM FACILITY OR DRAINAGE STRUCTURE
	BMP FOOTPRINT		DRAINAGE BOUNDARY TO POI*
	PROPOSED SIDEWALK		EXISTING STORM DRAIN
	CONCRETE DRIVEWAY ENTRANCE		LINE OF INVESTIGATION (LOI)
	REMOVAL OF EXISTING SIDEWALK		TOP SOIL CHECK DAMS
			CUT LINE
			FILL LINE

"I HEREBY CERTIFY THAT THESE DOCUMENTS WERE PREPARED OR APPROVED BY ME AND THAT I AM A DULY LICENSED PROFESSIONAL ENGINEER UNDER THE LAWS OF THE STATE OF MARYLAND."
LICENSE NO. 33330
EXPIRATION DATE JUNE 29, 2026

NO.	REVISION	BY	APP'D	DATE

MONTGOMERY COUNTY
DEPARTMENT OF TRANSPORTATION
DIVISION OF TRANSPORTATION ENGINEERING

STORMWATER MANAGEMENT PLAN

MD 198 (SANDY SPRING ROAD)
FROM DINO DRIVE TO MCKNEW ROAD
SIDEWALK IMPROVEMENTS

SCALE: 1"=30'

SW-01



BY: CuJN

MONTGOMERY COUNTY APPROVAL BLOCK

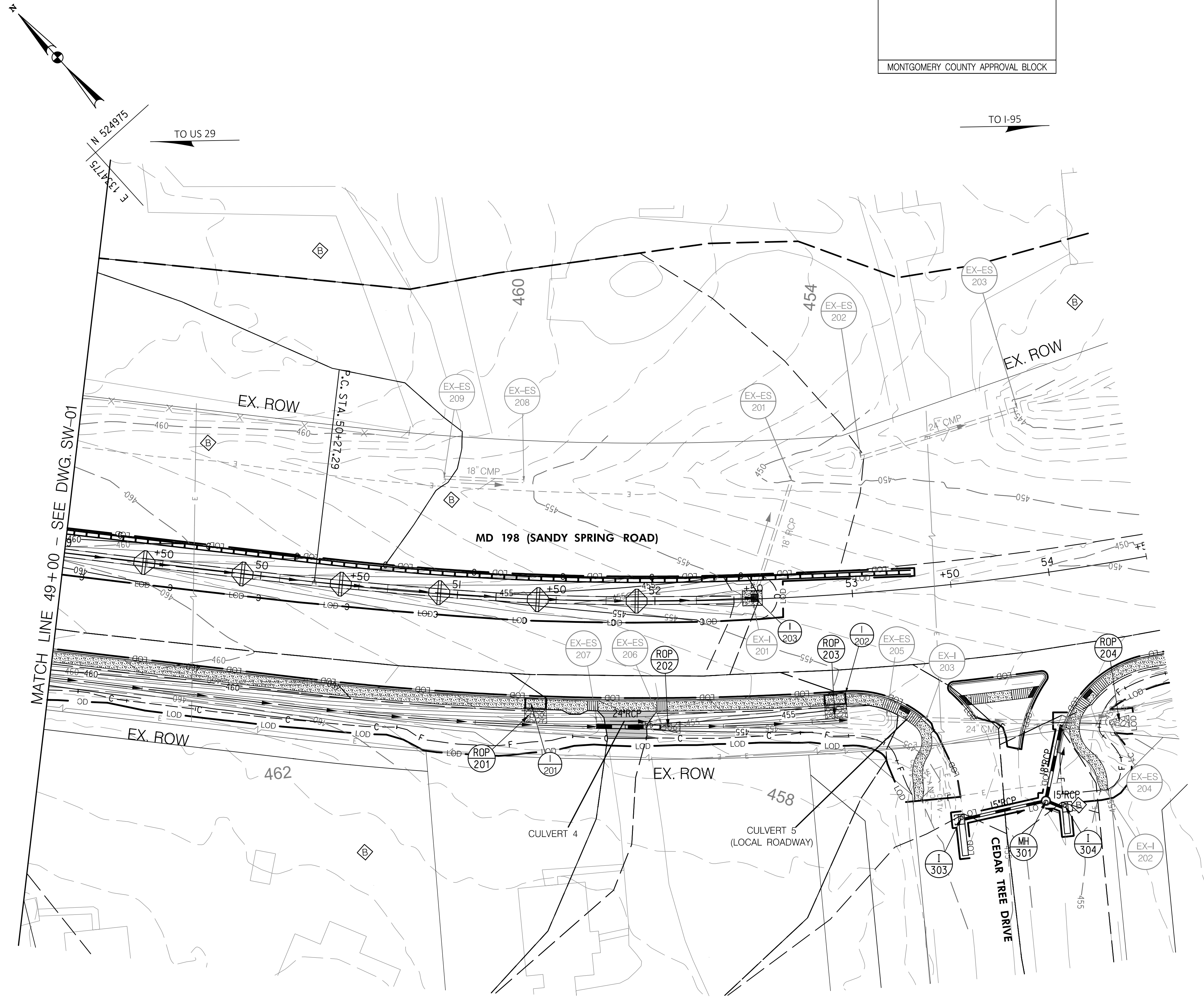

E 1335200
N 5243550

E 1334775
N 5243550

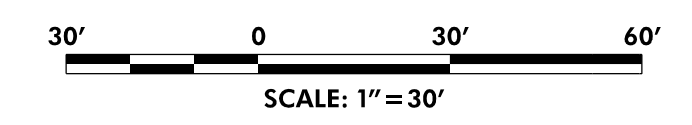

*DRAINAGE BOUNDARIES MAY APPEAR AS A SOLID LINE IN SOME LOCATIONS DUE TO OVERLAPS

LEGEND			
	HSG RATING		LIMIT OF DISTURBANCE (LOD)
	HSG BOUNDARY		2' GIS CONTOURS
	BMP FOOTPRINT		1' CONTOURS
	PROPOSED SIDEWALK		LINE OF INVESTIGATION (LOI)
	CONCRETE DRIVEWAY ENTRANCE		TOP SOIL CHECK DAMS
	REMOVAL OF EXISTING SIDEWALK		CUT LINE
	DRAINAGE BOUNDARY TO SWM FACILITY OR DRAINAGE STRUCTURE		FILL LINE
	DRAINAGE BOUNDARY TO POI*		
	PROPOSED STORM DRAIN		
	EXISTING STORM DRAIN		

"I HEREBY CERTIFY THAT THESE DOCUMENTS WERE PREPARED OR APPROVED BY ME AND THAT I AM A DULY LICENSED PROFESSIONAL ENGINEER UNDER THE LAWS OF THE STATE OF MARYLAND."
 LICENSE NO. 33330
 EXPIRATION DATE JUNE 29, 2026

NO.	REVISION	BY	APP'D	DATE

MONTGOMERY COUNTY
 DEPARTMENT OF TRANSPORTATION
 DIVISION OF TRANSPORTATION ENGINEERING

STORMWATER MANAGEMENT PLAN

MD 198 (SANDY SPRING ROAD)
 FROM DINO DRIVE TO MCKNEW ROAD
 SIDEWALK IMPROVEMENTS

SCALE: 1" = 30'

SW-02



MONTGOMERY COUNTY APPROVAL BLOCK

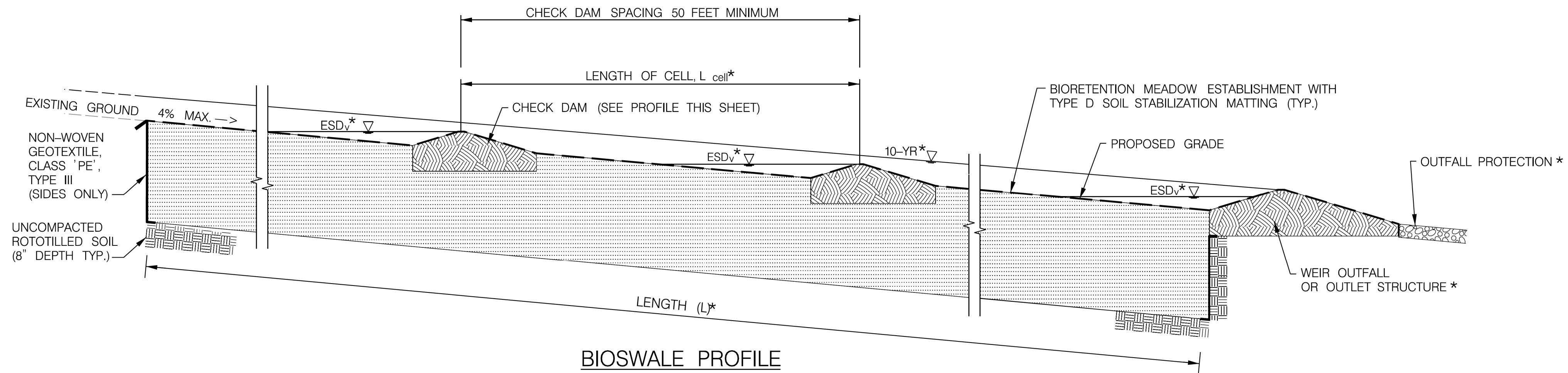

BIOSWALE PROFILE

SHOW ENTIRE PROFILE AS DESIGNED
NOT TO SCALE

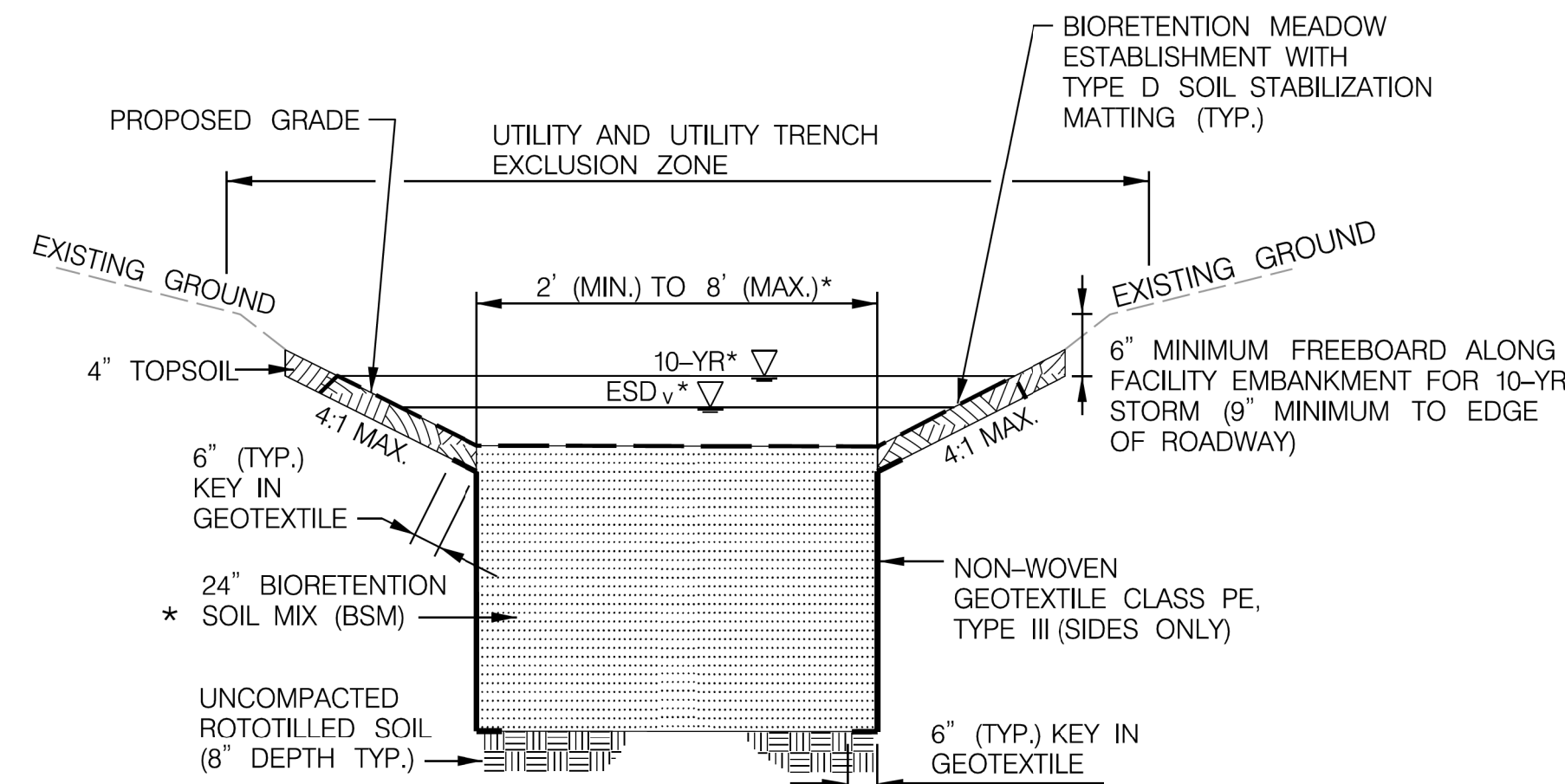

BIOSWALE TYPICAL SECTION

NOT TO SCALE

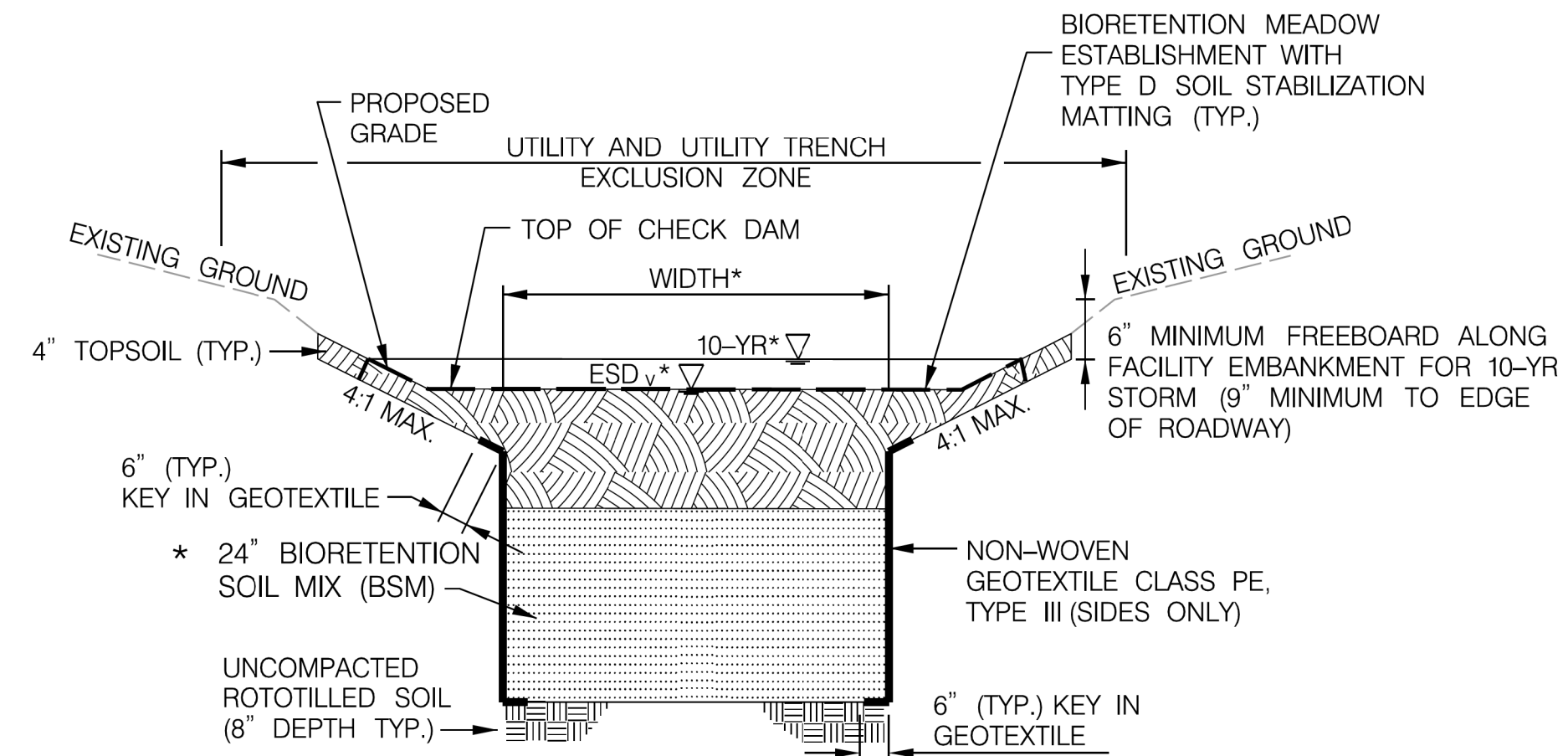

BIOSWALE TYPICAL SECTION AT CHECK DAM

NOT TO SCALE

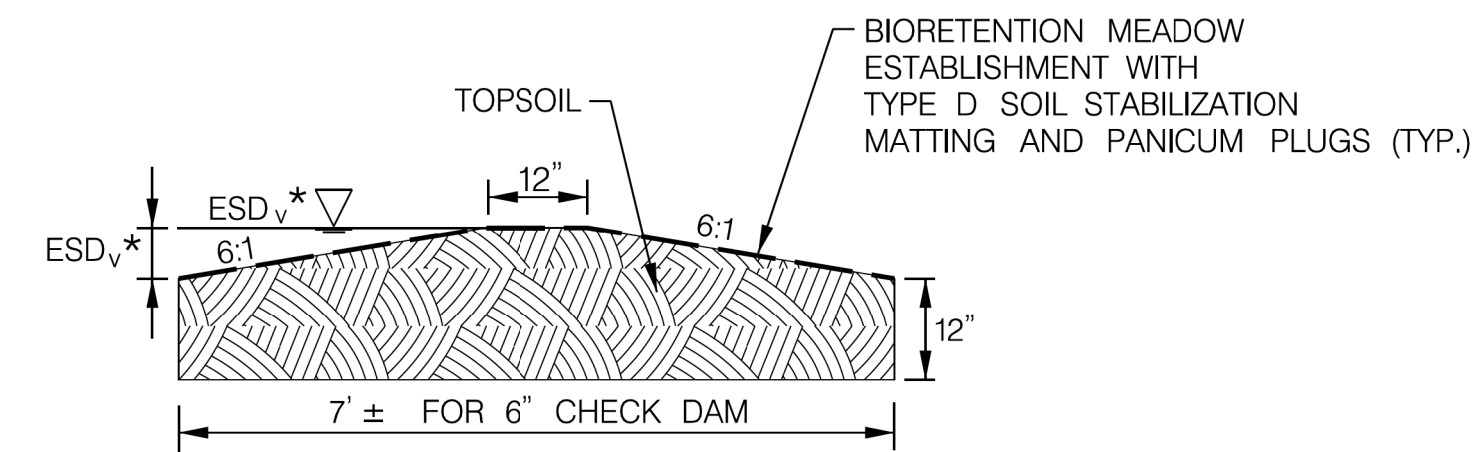

CHECK DAM PROFILE

NOT TO SCALE

NOTE: PROJECT SPECIFIC PROFILES AND TYPICAL SECTIONS WILL BE DEVELOPED ONCE THE PROJECT REACHES THE SITE DEVELOPMENT PHASE.

SW-03

NO.	REVISION	BY	APP'D	DATE

MONTGOMERY COUNTY
DEPARTMENT OF TRANSPORTATION
DIVISION OF TRANSPORTATION ENGINEERING

STORMWATER MANAGEMENT DETAILS

MD 198 (SANDY SPRING ROAD)
FROM DINO DRIVE TO MCKNEW ROAD
SIDEWALK IMPROVEMENTS

SCALE: AS SHOWN

"I HEREBY CERTIFY THAT THESE DOCUMENTS WERE PREPARED OR APPROVED BY ME AND THAT I AM A DULY LICENSED PROFESSIONAL ENGINEER UNDER THE LAWS OF THE STATE OF MARYLAND."
LICENSE NO. 33330
EXPIRATION DATE JUNE 29, 2026

