

WELCOME

MONTGOMERY COUNTY
DEPARTMENT OF TRANSPORTATION
MACARTHUR BOULEVARD
BIKEWAY, SEGMENT III

VIRTUAL PUBLIC HEARING

MARCH 29, 2023

We will begin shortly. The Public Hearing will be recorded.

WELCOME

MONTGOMERY COUNTY
DEPARTMENT OF TRANSPORTATION
MACARTHUR BOULEVARD
BIKEWAY, SEGMENT III

VIRTUAL PUBLIC HEARING

MARCH 29, 2023

The Public Hearing is being recorded.

PUBLIC HEARING FORMAT

- Cameras and microphones have been turned off to reduce the bandwidth of the meeting
- Verbal Testimony
 - Those who signed up to testify will be called on and unmuted when it is their turn to speak
 - If you did not sign up to testify but wish to do so, please “raise your hand”
- Written Testimony
 - May be submitted and will be considered with the same weight as oral testimony
- Questions and Answers will follow the Testimony Portion of the Hearing
 - “Raise your hand” to ask a question or type it into the Q&A Chat Box in the bottom right corner of the screen

PURPOSE OF PUBLIC HEARING

Hearing held pursuant to Section 49-53 of the Montgomery County Code

- Obtain testimony regarding the potential project
- Comments/testimony should be focused entirely on the MacArthur Boulevard Bikeway, Segment III project
- All interested persons are entitled to be heard at this hearing; however, the testimony portion of this hearing is not a forum for dialogue, questions and answers, or cross-examination

PUBLIC HEARING RECORD

The Public Hearing Record will remain open for two weeks to allow any person an opportunity to have their comments included.

Official Closing Date for Comments and Testimony
Wednesday, April 12, 2023
At 6:00 PM

Submissions can be made via:

E-mail

Yasamin.Esmaili@montgomerycountymd.gov

OR

Online comment form on the project website

<https://www.montgomerycountymd.gov/dot-dte/projects/mcarthurseg3>

MACARTHUR BLVD BIKEWAY, SEGMENT III

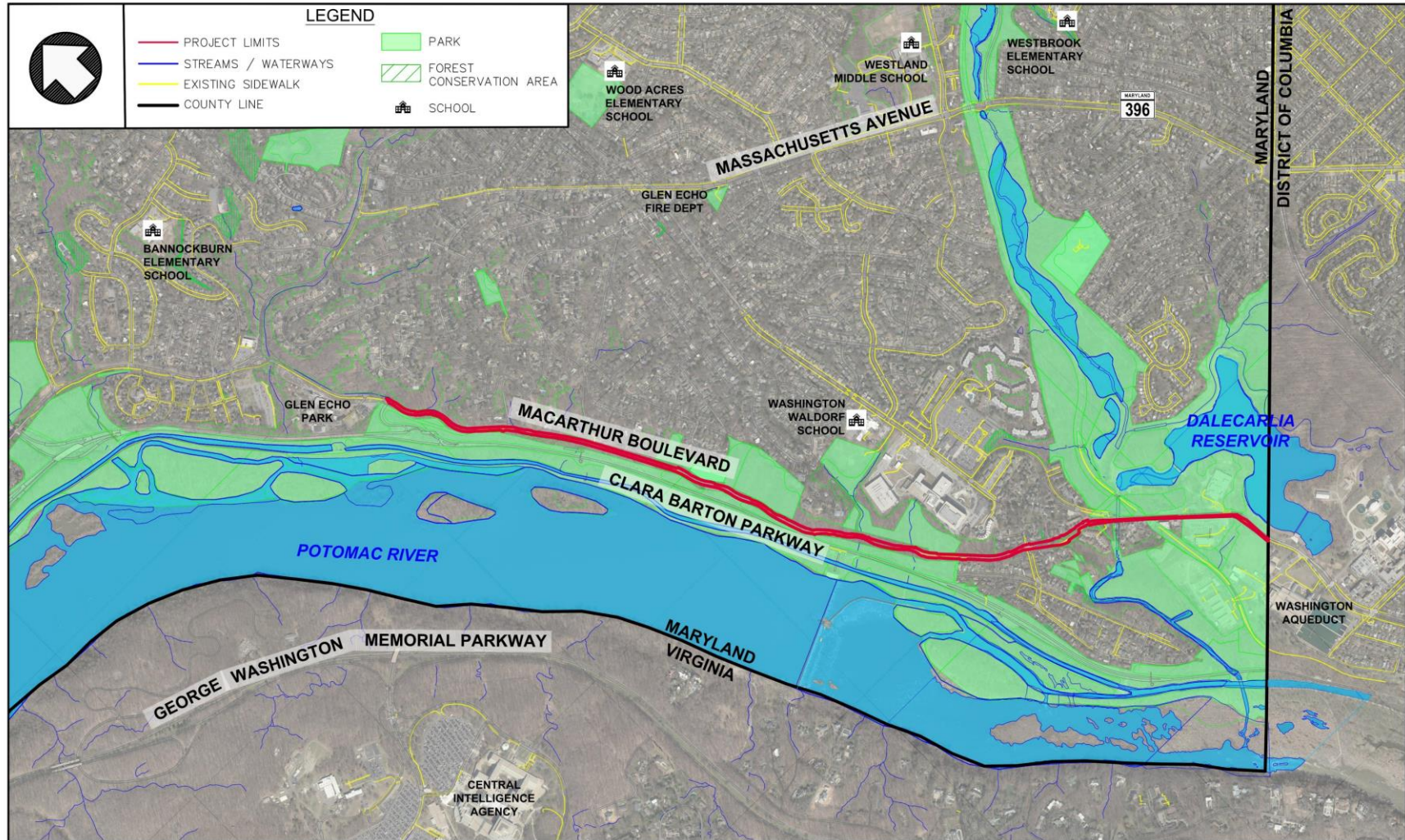

CIP No. 500718

VICINITY MAP
MACARTHUR BOULEVARD BIKEWAY, SEGMENT III

0 500 1000 2000 Feet
SCALE: 1" = 500'

MACARTHUR BLVD BIKEWAY, SEGMENT III

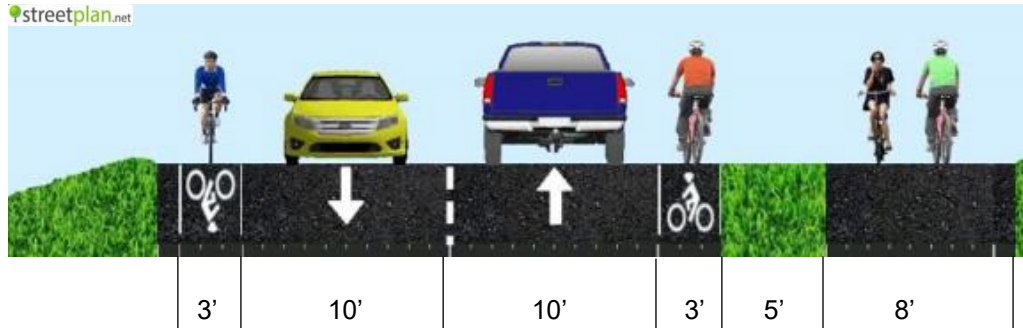

Typical Section 1

- Bicycles can ride on roadway in shoulder
- Shared-use path separated with grass buffer

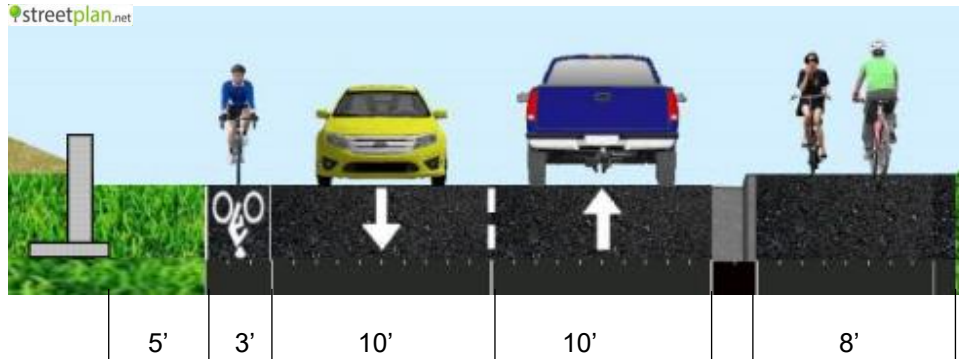

Typical Section 2

- Bicycles can ride on roadway in shoulder
- Shared-use path separated by curb and gutter
- Retaining walls as needed

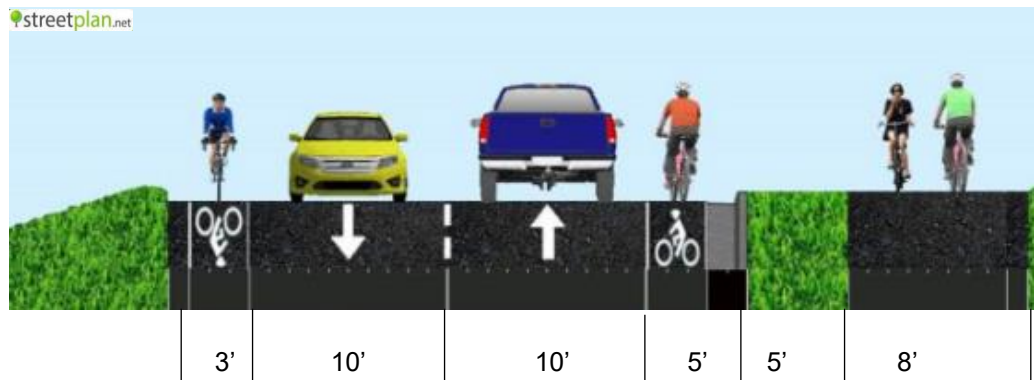

Typical Section 3

- Bicycles can ride on roadway in shoulder
- Bicycles can ride on roadway in bike lane
- Shared-use path separated by curb and gutter as well as grass buffer
- Retaining walls as needed

MACARTHUR BLVD BIKEWAY, SEGMENT III

From Oberlin Rd to north of the multi-home driveway



DISPLAY B: PROPOSED PLAN

LEGEND

	PROPOSED FULL DEPTH PAVEMENT		PROPOSED ASPHALT PATH/TRAIL-IMPERVIOUS		LIMIT OF DISTURBANCE
	PROPOSED MILL AND OVERLAY		PROPOSED ASPHALT DRIVEWAY		POTENTIAL RIGHT-OF-WAY IMPACT
	PROPOSED PAVEMENT REMOVAL		PROPOSED CONCRETE PATH		

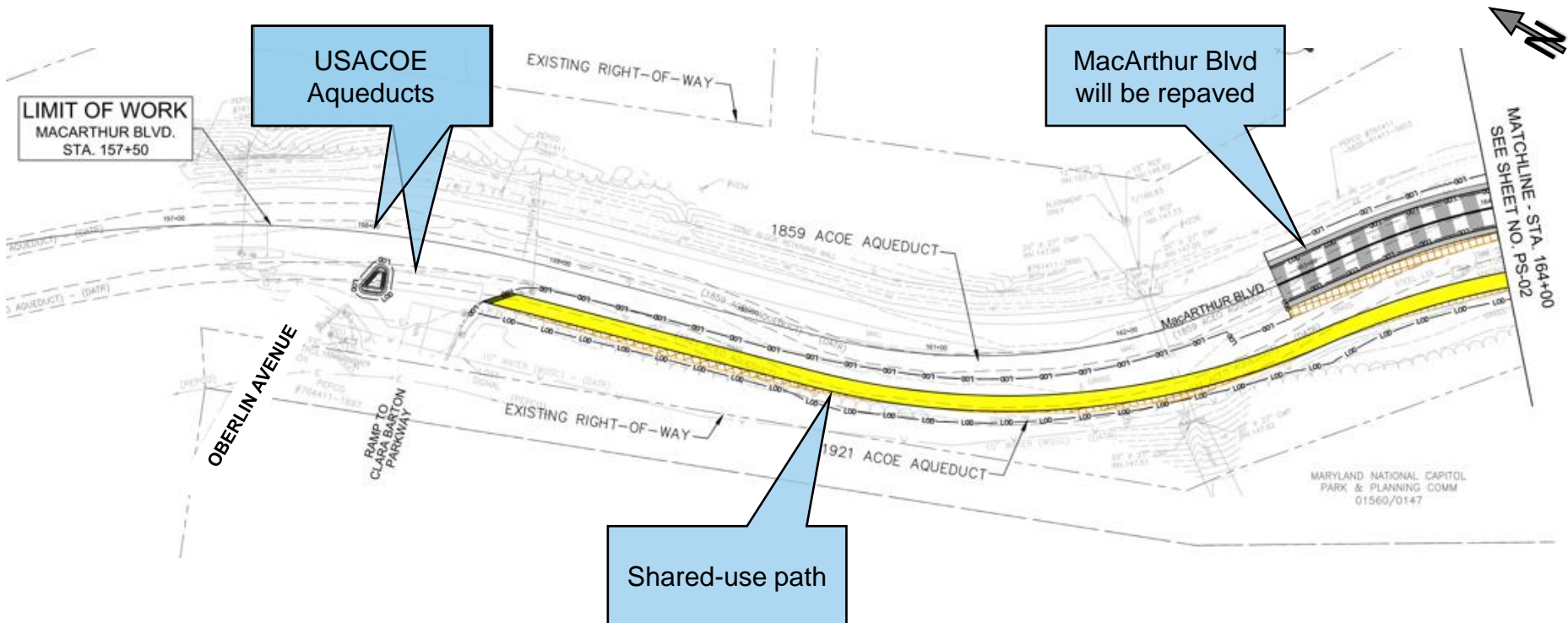







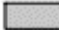

MACARTHUR BLVD BIKEWAY, SEGMENT III

From north of the multi-home driveway to north of Mohican Rd



DISPLAY B: PROPOSED PLAN

LEGEND

	PROPOSED FULL DEPTH PAVEMENT		PROPOSED ASPHALT PATH/TRAIL-IMPERVIOUS		LIMIT OF DISTURBANCE
	PROPOSED MILL AND OVERLAY		PROPOSED ASPHALT DRIVEWAY		POTENTIAL RIGHT-OF-WAY IMPACT
	PROPOSED PAVEMENT REMOVAL		PROPOSED CONCRETE PATH		

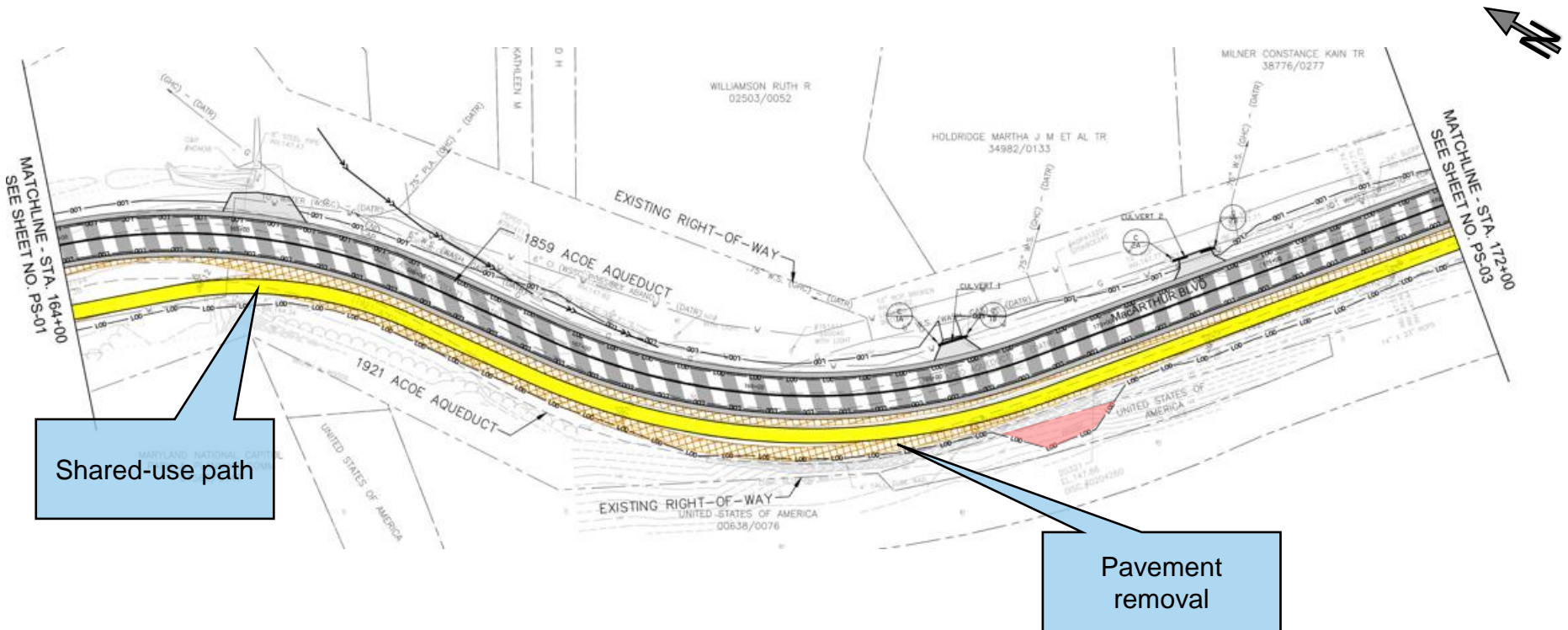

Shared-use path

Pavement removal

MACARTHUR BLVD BIKEWAY, SEGMENT III

From north of Mohican Rd to north of Mohican Swim Club



DISPLAY B: PROPOSED PLAN

LEGEND

	PROPOSED FULL DEPTH PAVEMENT		PROPOSED ASPHALT PATH/TRAIL-IMPERVIOUS		LIMIT OF DISTURBANCE
	PROPOSED MILL AND OVERLAY		PROPOSED ASPHALT DRIVEWAY		POTENTIAL RIGHT-OF-WAY IMPACT
	PROPOSED PAVEMENT REMOVAL		PROPOSED CONCRETE PATH		

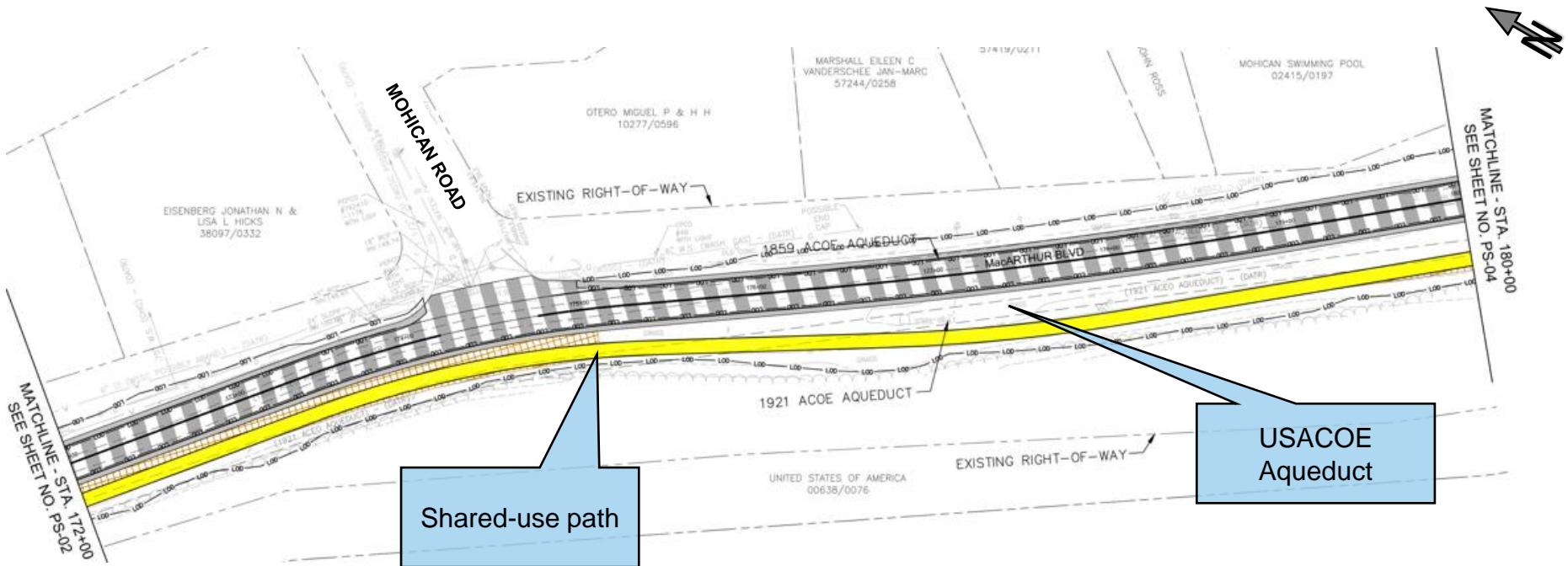

MACARTHUR BLVD BIKEWAY, SEGMENT III

From north of Mohican Swim Club to south of Walhonding Rd



DISPLAY B: PROPOSED PLAN

LEGEND

PROPOSED FULL DEPTH PAVEMENT	PROPOSED ASPHALT PATH/TRAIL-IMPERVIOUS	LIMIT OF DISTURBANCE
PROPOSED MILL AND OVERLAY	PROPOSED ASPHALT DRIVEWAY	POTENTIAL RIGHT-OF-WAY IMPACT
PROPOSED PAVEMENT REMOVAL	PROPOSED CONCRETE PATH	

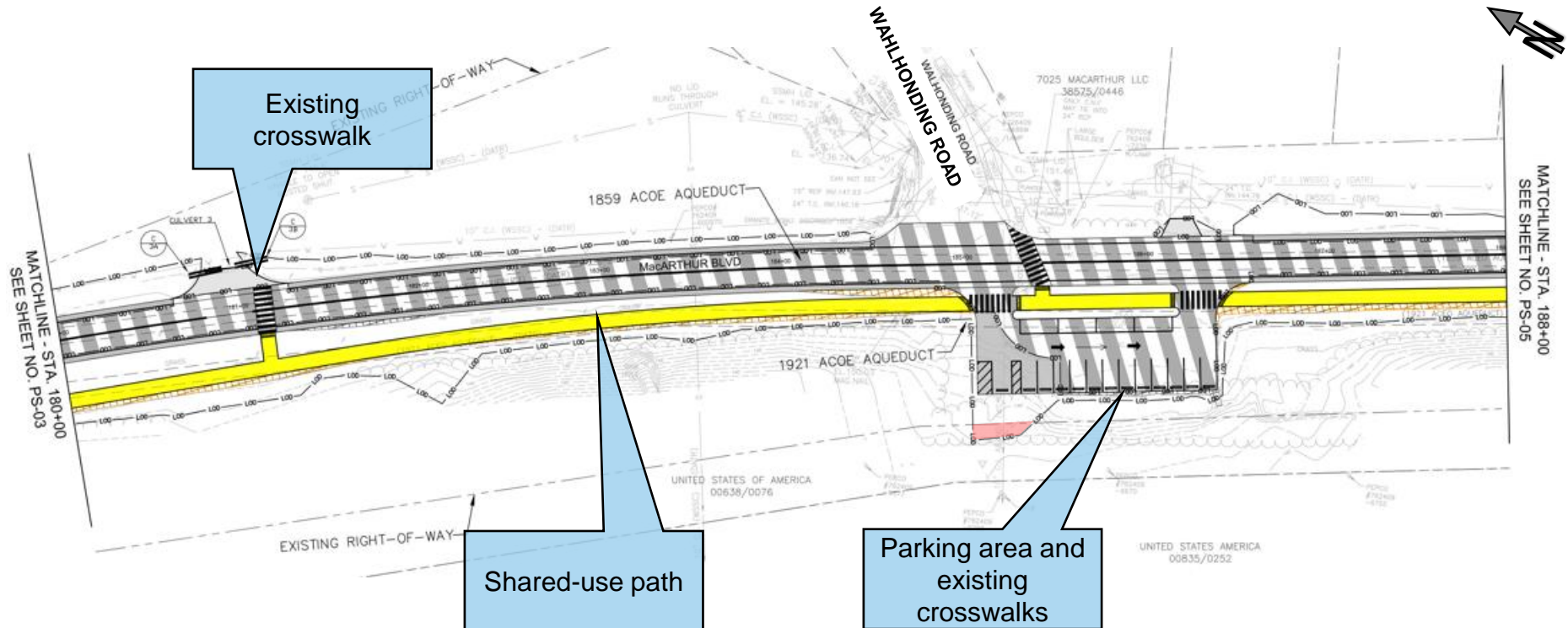

MACARTHUR BLVD BIKEWAY, SEGMENT III

South of Walhonding Rd along MacArthur Blvd



DISPLAY B: PROPOSED PLAN

LEGEND

	PROPOSED FULL DEPTH PAVEMENT		PROPOSED ASPHALT PATH/TRAIL-IMPERVIOUS		LIMIT OF DISTURBANCE
	PROPOSED MILL AND OVERLAY		PROPOSED ASPHALT DRIVEWAY		PROPOSED CONCRETE PATH
	PROPOSED PAVEMENT REMOVAL				POTENTIAL RIGHT-OF-WAY IMPACT

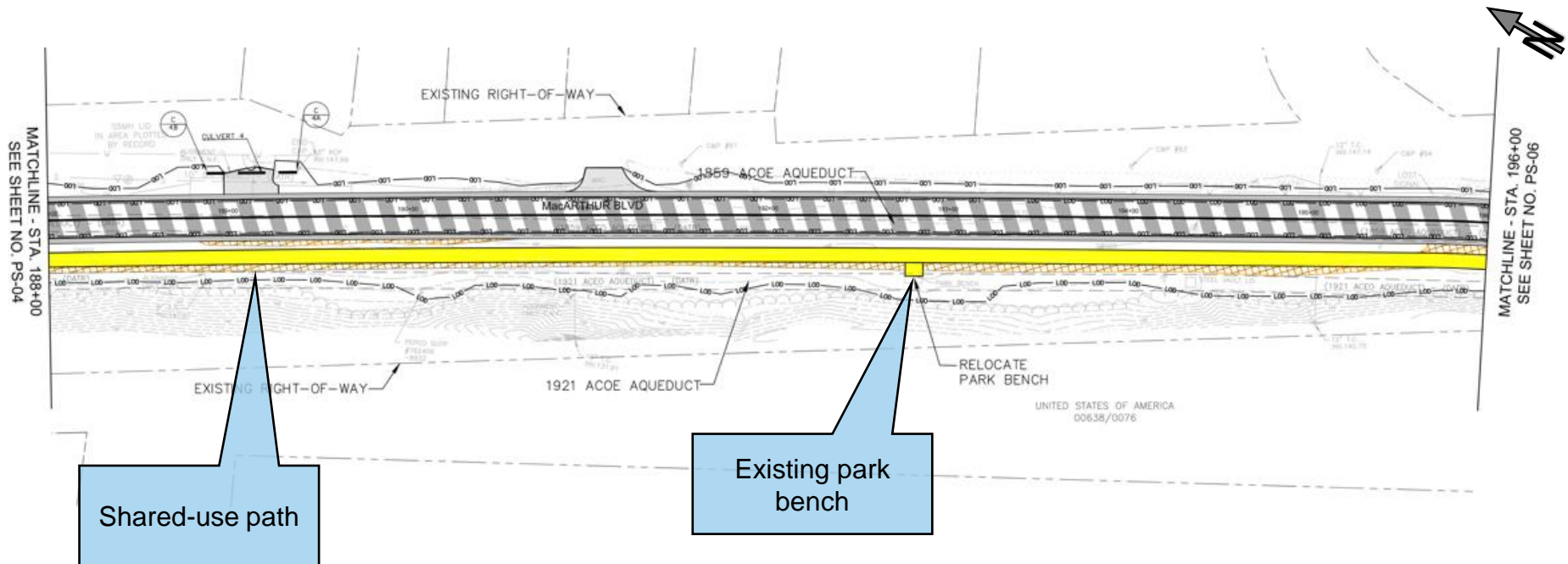







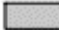

MACARTHUR BLVD BIKEWAY, SEGMENT III

Continuing south on MacArthur Blvd

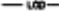

DISPLAY B: PROPOSED PLAN

LEGEND

 PROPOSED FULL DEPTH PAVEMENT	 PROPOSED ASPHALT PATH/TRAIL-IMPERVIOUS	 LIMIT OF DISTURBANCE
 PROPOSED MILL AND OVERLAY	 PROPOSED ASPHALT DRIVEWAY	
 PROPOSED PAVEMENT REMOVAL	 PROPOSED CONCRETE PATH	 POTENTIAL RIGHT-OF-WAY IMPACT

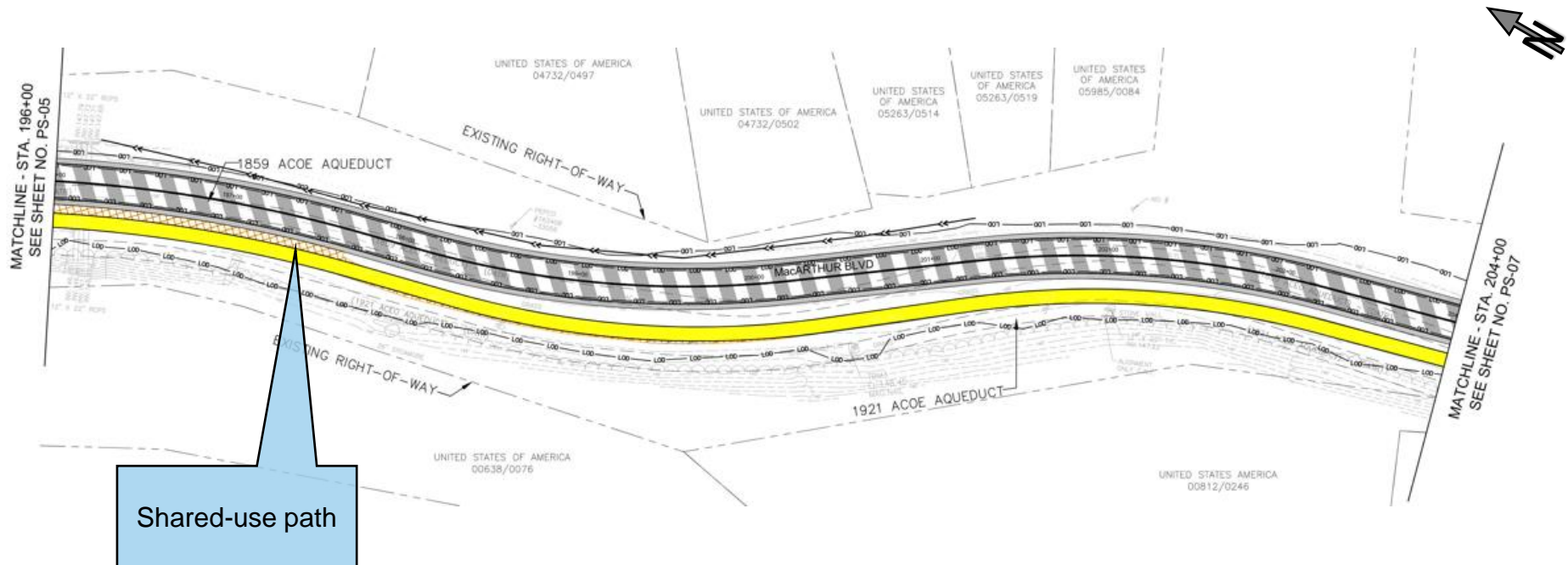

MACARTHUR BLVD BIKEWAY, SEGMENT III

Continuing south on MacArthur Blvd



DISPLAY B: PROPOSED PLAN

LEGEND

	PROPOSED FULL DEPTH PAVEMENT		PROPOSED ASPHALT PATH/TRAIL-IMPERVIOUS		LIMIT OF DISTURBANCE
	PROPOSED MILL AND OVERLAY		PROPOSED ASPHALT DRIVEWAY		PROPOSED CONCRETE PATH
	PROPOSED PAVEMENT REMOVAL				POTENTIAL RIGHT-OF-WAY IMPACT

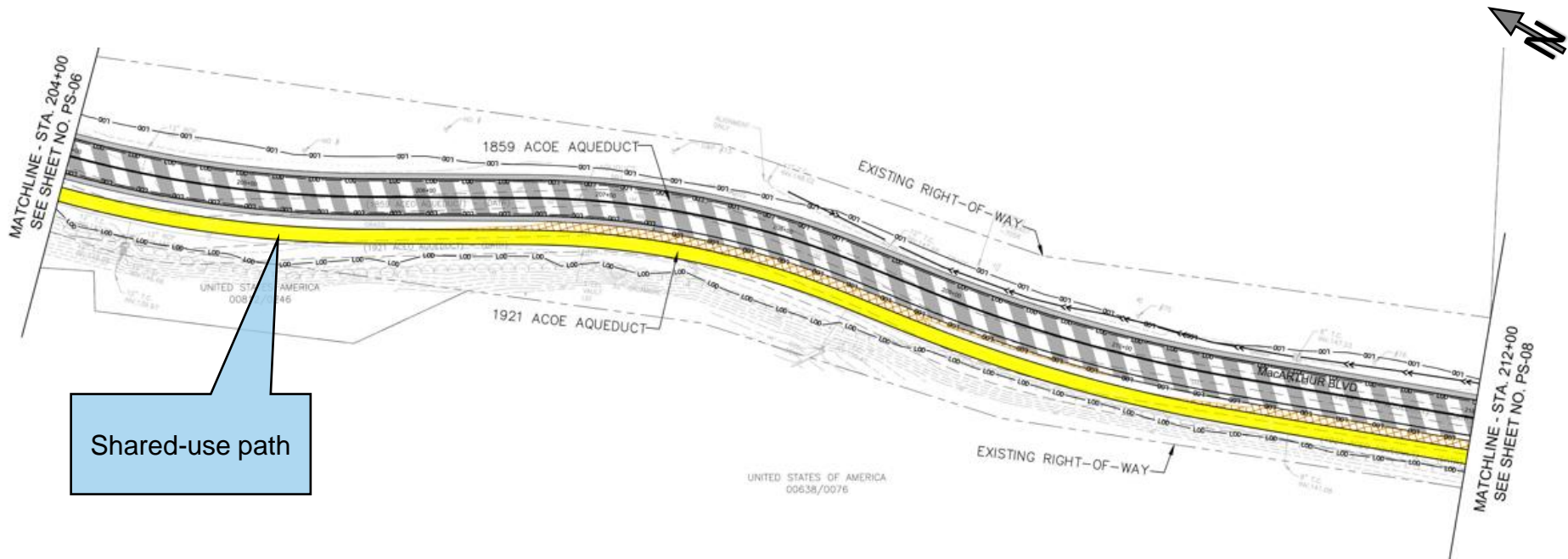

MACARTHUR BLVD BIKEWAY, SEGMENT III

Continuing south on MacArthur Blvd to north of Wapakoneta Rd



DISPLAY B: PROPOSED PLAN

LEGEND

	PROPOSED FULL DEPTH PAVEMENT		PROPOSED ASPHALT PATH/TRAIL-IMPERVIOUS		LIMIT OF DISTURBANCE
	PROPOSED MILL AND OVERLAY		PROPOSED ASPHALT DRIVEWAY		POTENTIAL RIGHT-OF-WAY IMPACT
	PROPOSED PAVEMENT REMOVAL		PROPOSED CONCRETE PATH		

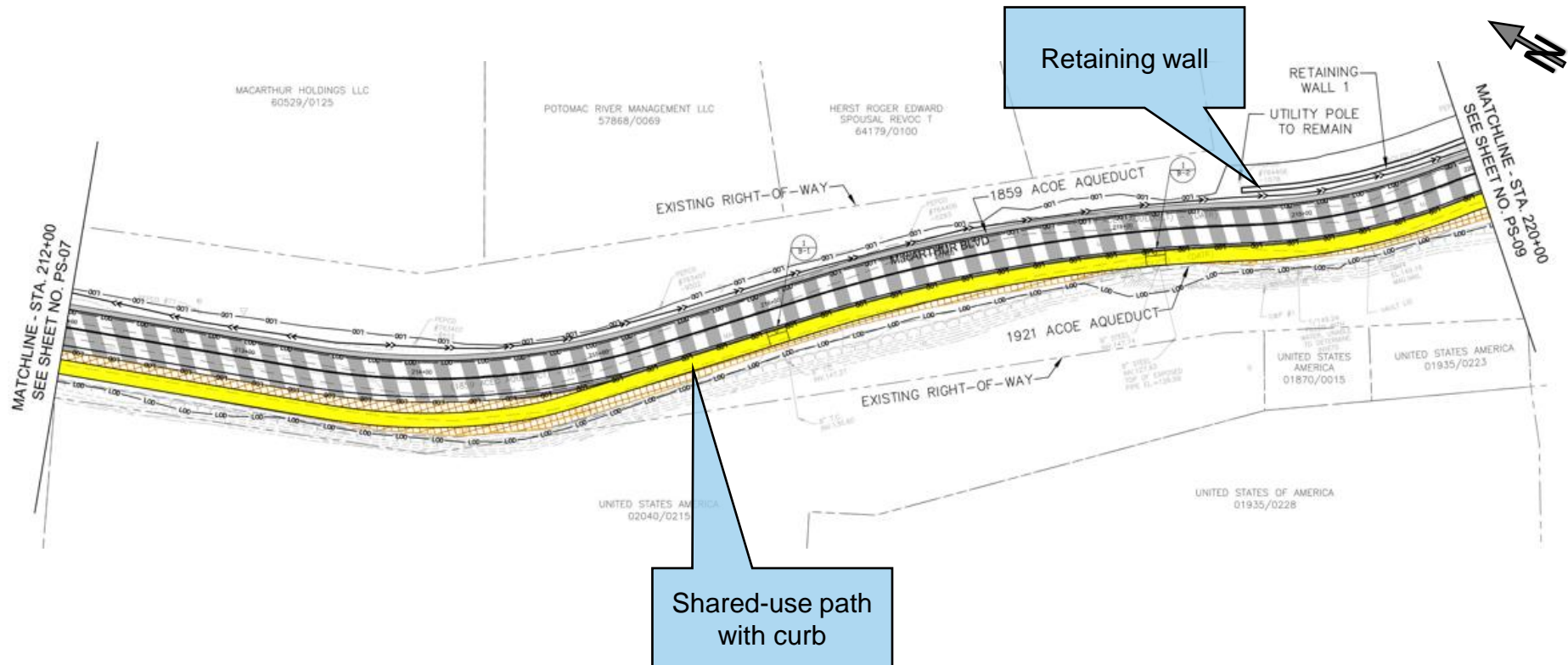

MACARTHUR BLVD BIKEWAY, SEGMENT III

From north of Wapakoneta Rd continuing south



DISPLAY B: PROPOSED PLAN

LEGEND

	PROPOSED FULL DEPTH PAVEMENT		PROPOSED ASPHALT PATH/TRAIL-IMPERVIOUS		LIMIT OF DISTURBANCE
	PROPOSED MILL AND OVERLAY		PROPOSED ASPHALT DRIVEWAY		POTENTIAL RIGHT-OF-WAY IMPACT
	PROPOSED PAVEMENT REMOVAL		PROPOSED CONCRETE PATH		

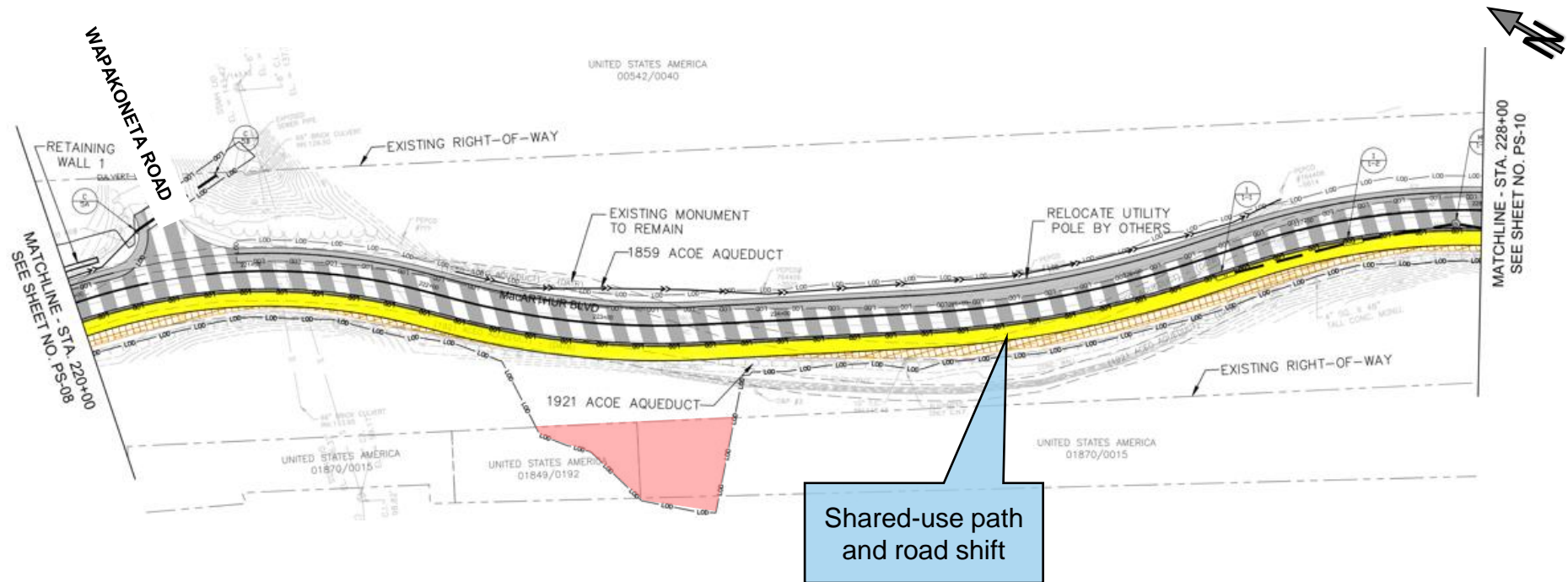

MACARTHUR BLVD BIKEWAY, SEGMENT III

Continuing south on MacArthur Blvd



DISPLAY B: PROPOSED PLAN

LEGEND

	PROPOSED FULL DEPTH PAVEMENT		PROPOSED ASPHALT PATH/TRAIL-IMPERIOUS		LIMIT OF DISTURBANCE
	PROPOSED MILL AND OVERLAY		PROPOSED ASPHALT DRIVEWAY		PROPOSED CONCRETE PATH
	PROPOSED PAVEMENT REMOVAL		POTENTIAL RIGHT-OF-WAY IMPACT		

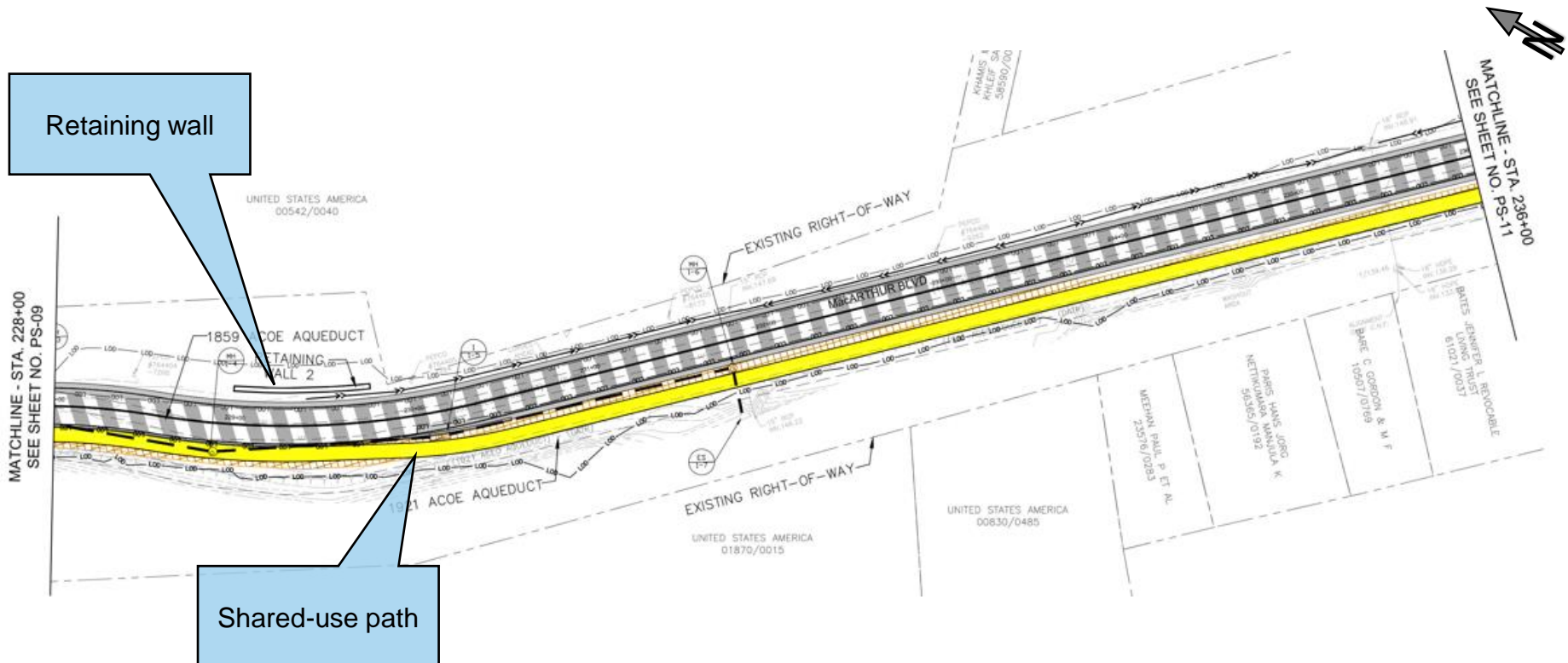

MACARTHUR BLVD BIKEWAY, SEGMENT III

Continuing south on MacArthur Blvd to south of Maryland Ave



DISPLAY B: PROPOSED PLAN

LEGEND

	PROPOSED FULL DEPTH PAVEMENT		PROPOSED ASPHALT PATH/TRAIL-IMPERVIOUS		LIMIT OF DISTURBANCE
	PROPOSED MILL AND OVERLAY		PROPOSED ASPHALT DRIVEWAY		POTENTIAL RIGHT-OF-WAY IMPACT
	PROPOSED PAVEMENT REMOVAL		PROPOSED CONCRETE PATH		

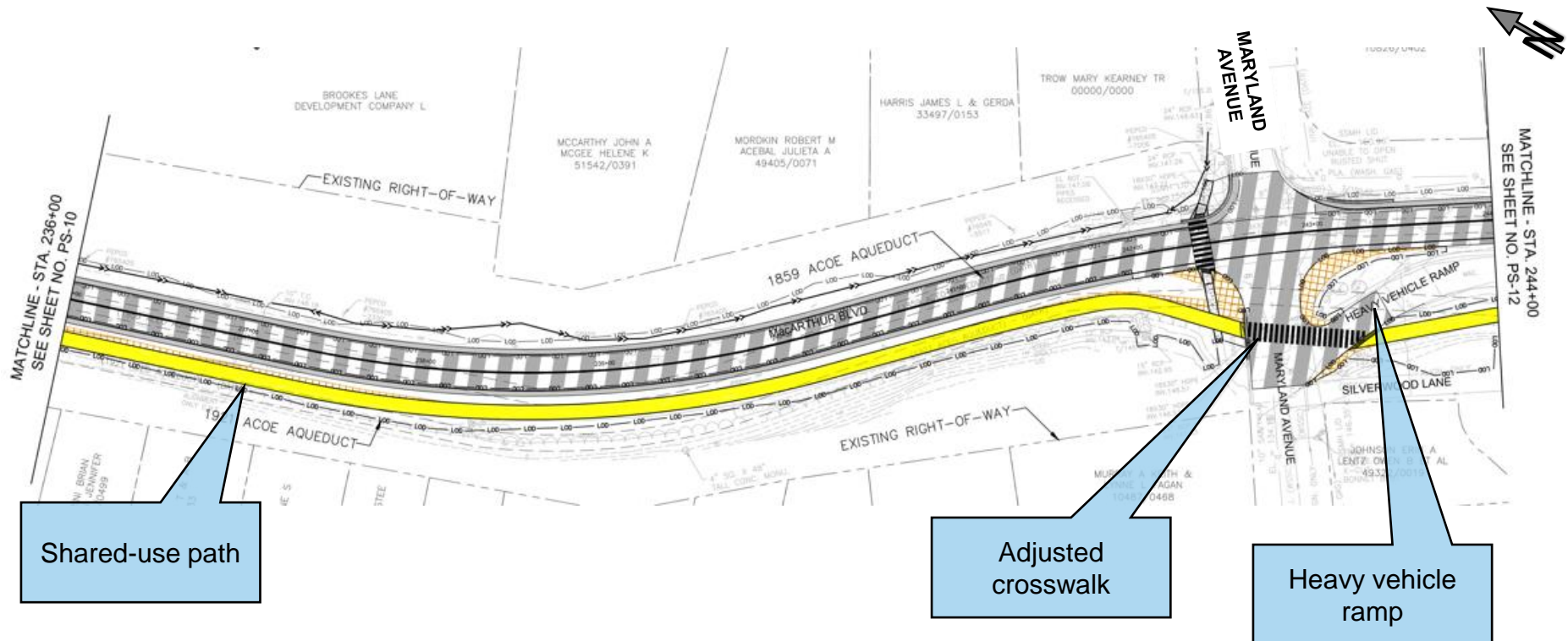

MACARTHUR BLVD BIKEWAY, SEGMENT III

From south of Maryland Ave to north of Sangamore Rd



DISPLAY B: PROPOSED PLAN

LEGEND

	PROPOSED FULL DEPTH PAVEMENT		PROPOSED ASPHALT PATH/TRAIL-IMPERVIOUS		LIMIT OF DISTURBANCE
	PROPOSED MILL AND OVERLAY		PROPOSED ASPHALT DRIVEWAY		PROPOSED CONCRETE PATH
	PROPOSED PAVEMENT REMOVAL				POTENTIAL RIGHT-OF-WAY IMPACT

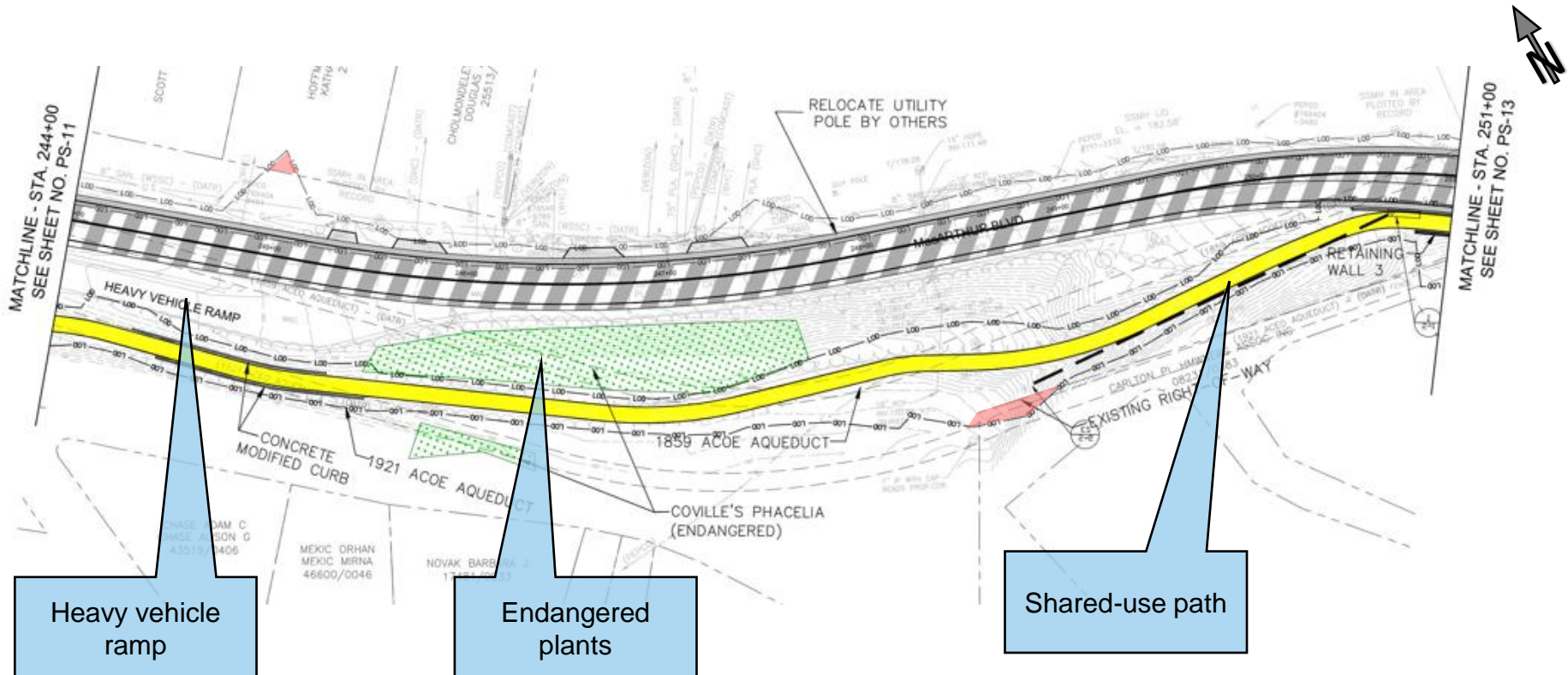

MACARTHUR BLVD BIKEWAY, SEGMENT III

From north of Sangamore Rd to south of Windward Pl



DISPLAY B: PROPOSED PLAN

LEGEND

	PROPOSED FULL DEPTH PAVEMENT		PROPOSED ASPHALT PATH/TRAIL-IMPERVIOUS		LIMIT OF DISTURBANCE
	PROPOSED MILL AND OVERLAY		PROPOSED ASPHALT DRIVEWAY		POTENTIAL RIGHT-OF-WAY IMPACT
	PROPOSED PAVEMENT REMOVAL		PROPOSED CONCRETE PATH		

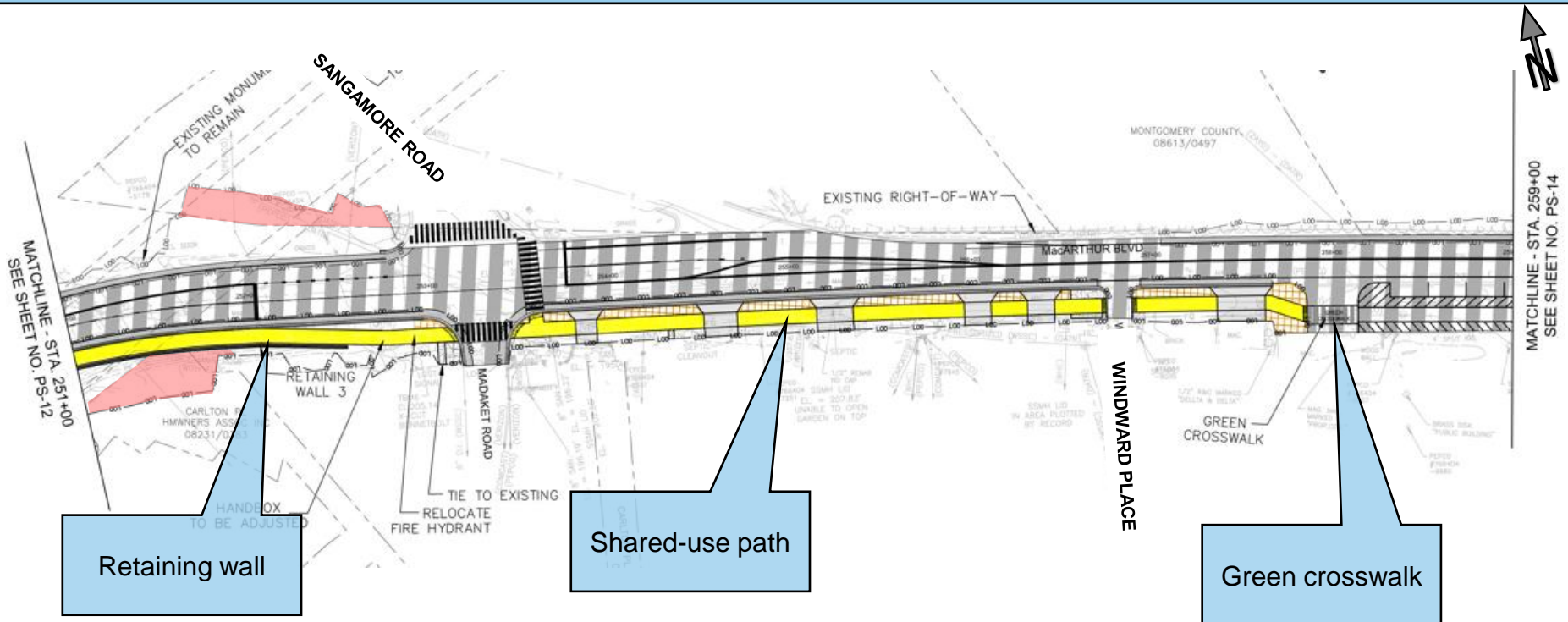









MACARTHUR BLVD BIKEWAY, SEGMENT III

From south of Windward Pl continuing south on MacArthur Blvd

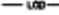

DISPLAY B: PROPOSED PLAN

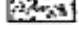
LEGEND

	PROPOSED FULL DEPTH PAVEMENT		PROPOSED ASPHALT PATH/TRAIL-IMPERVIOUS		LIMIT OF DISTURBANCE
	PROPOSED MILL AND OVERLAY		PROPOSED ASPHALT DRIVEWAY		
	PROPOSED PAVEMENT REMOVAL		PROPOSED CONCRETE PATH		POTENTIAL RIGHT-OF-WAY IMPACT

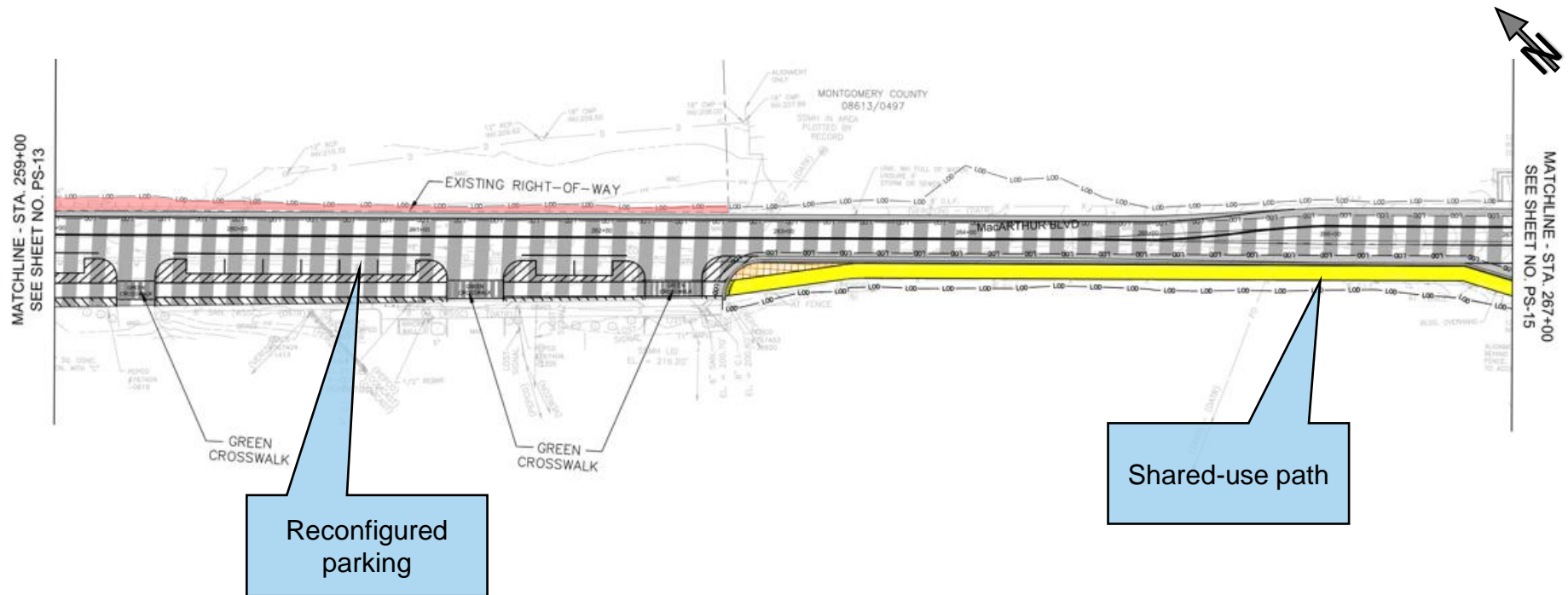

MACARTHUR BLVD BIKEWAY, SEGMENT III

Along MacArthur Blvd to Maryland / District of Columbia line



DISPLAY B: PROPOSED PLAN

LEGEND

	PROPOSED FULL DEPTH PAVEMENT		PROPOSED ASPHALT PATH/TRAIL-IMPERVIOUS		LIMIT OF DISTURBANCE
	PROPOSED MILL AND OVERLAY		PROPOSED ASPHALT DRIVEWAY		PROPOSED CONCRETE PATH
	PROPOSED PAVEMENT REMOVAL				POTENTIAL RIGHT-OF-WAY IMPACT

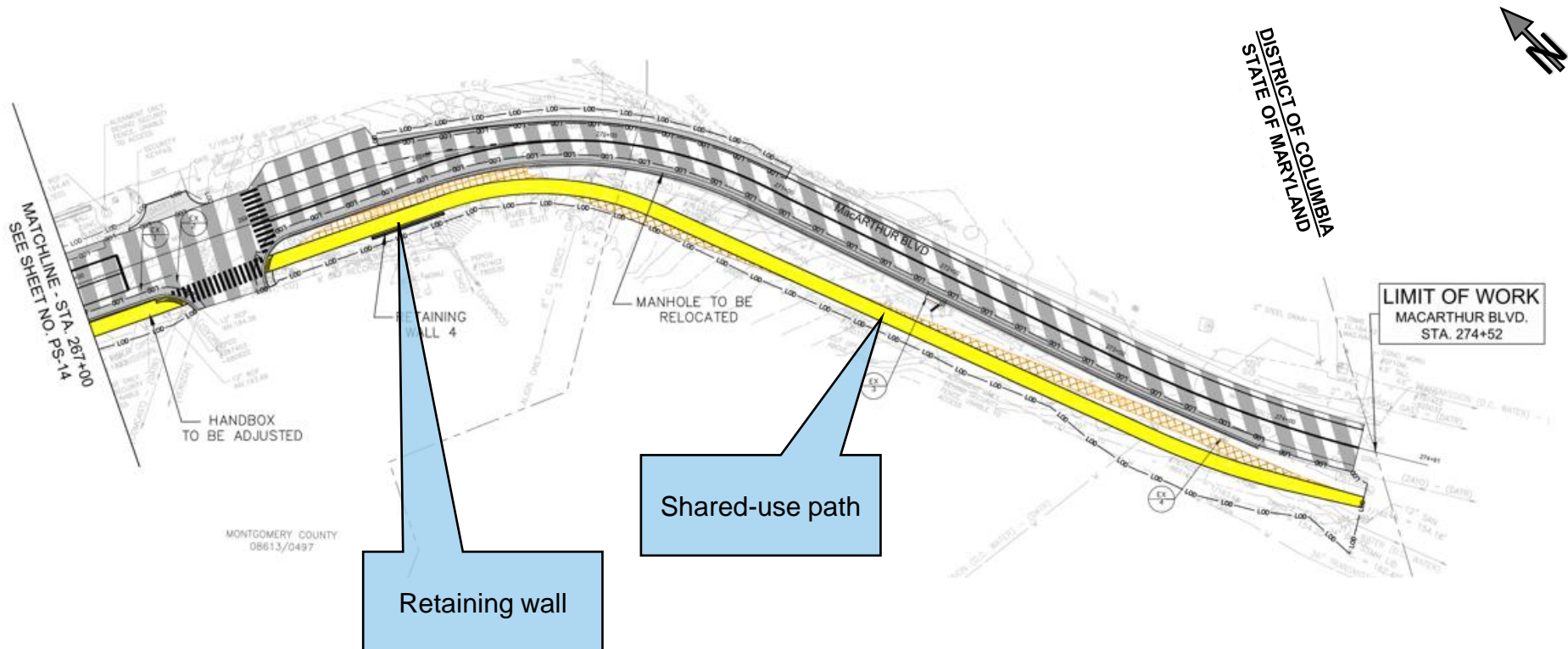

MACARTHUR BLVD BIKEWAY, SEGMENT III

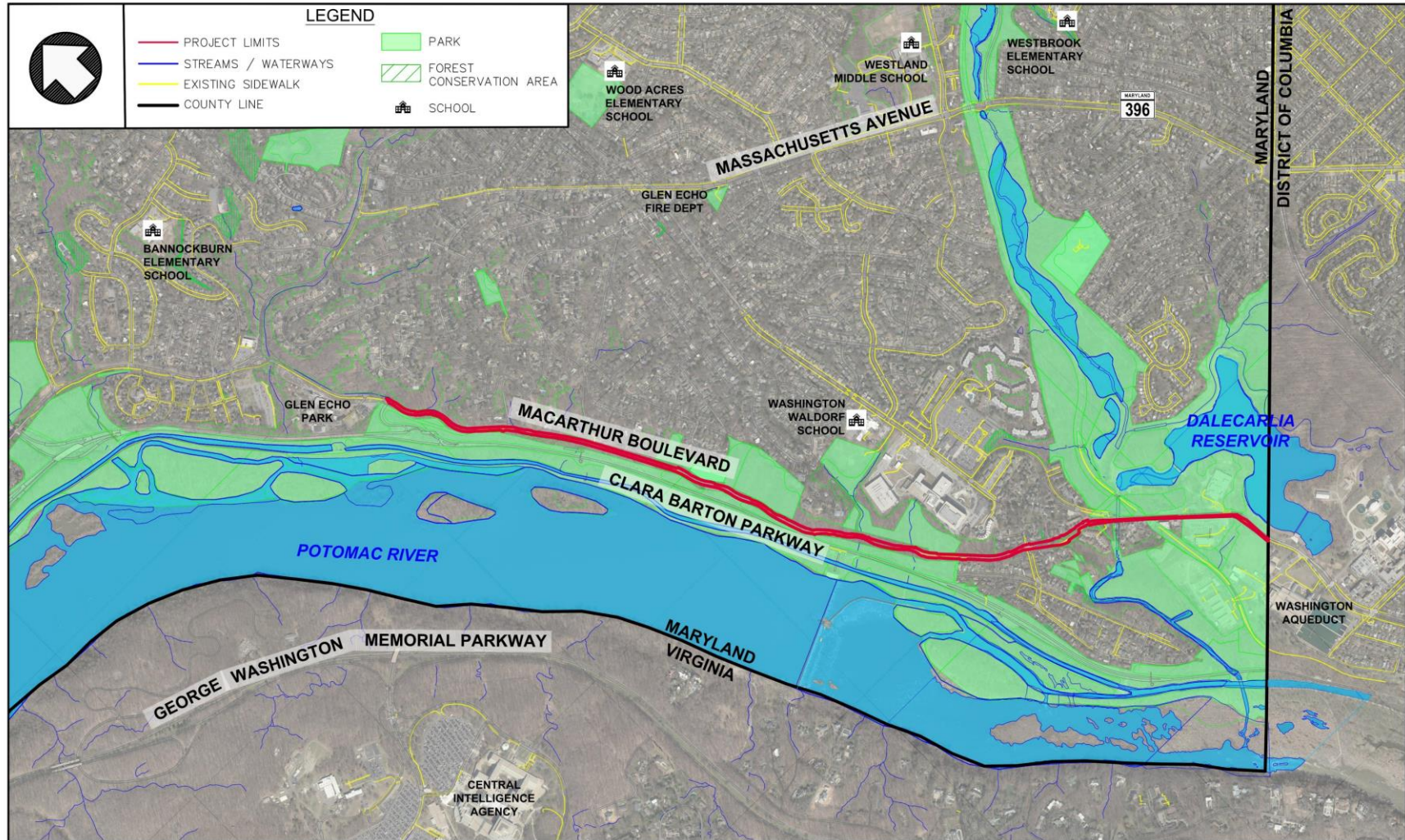

CIP No. 500718

VICINITY MAP
MACARTHUR BOULEVARD BIKEWAY, SEGMENT III

0 500 1000 2000 Feet
SCALE: 1" = 500'

COST AND ASSESSMENTS

- Total project cost currently estimated at \$6,000,000
- Project Cost includes:
 - Engineering
 - Land Acquisition
 - Site Improvements
 - Utilities
 - Construction
- No properties are considered to be specially benefitted by the proposed improvement

PUBLIC RECORD

- Exhibits included in the Public Record Binder:
 1. Office of Management & Budget; MacArthur Boulevard Bikeway, Segment III P500718
 2. MacArthur Boulevard Bikeway, Segment III 70% Design Plans
 3. Written Testimony regarding the MacArthur Boulevard Bikeway, Segment III proposal provided prior to this Public Hearing
 4. Washington Times newspaper and online advertisement proof
 5. List of Attendees, to be added following this Public Hearing
 6. Hearing Transcript; to be added following this Public Hearing
- Project related data and files:
 - Available for download from this virtual hearing platform
 - Available on project website
 - Can be requested digitally from Yasamin.Esmaili@montgomerycountymd.gov
 - Available to the public until the record for this Public Hearing is officially closed

PUBLIC TESTIMONY

- Cameras and microphones have been turned off to reduce the bandwidth of the meeting
- Verbal Testimony
 - Those who signed up to testify will be called on and unmuted when it is their turn to speak
 - If you did not sign up to testify but wish to do so, please “raise your hand” by clicking on the status icon on the top menu bar that looks like a person with their hand raised
 - **Once given speaking rights, please clearly provide your name and address for the record prior to beginning your testimony**
- Written Testimony
 - May be submitted and will be considered with the same weight as oral testimony and can be submitted via:
 - E-mail: Yasamin.Esmaili@montgomerycountymd.gov
 - Online comment form on the project website:
<https://www.montgomerycountymd.gov/dot-dte/projects/mcarthurseg3>

QUESTION AND ANSWER

- Cameras and microphones have been turned off to reduce the bandwidth of the meeting
- To ask a Question
 - Click on the status icon on the top menu bar that looks like a person with their hand raised or;
 - Type your question into the Q&A chat box on the bottom right corner of the screen

PUBLIC HEARING RECORD

The Public Hearing Record will remain open for two weeks to allow any person an opportunity to have their comments included.

Official Closing Date for Comments and Testimony
Wednesday, April 12, 2023
At 6:00 PM

Submissions can be made via:

E-mail

Yasamin.Esmaili@montgomerycountymd.gov

OR

Online comment form on the project website

<https://www.montgomerycountymd.gov/dot-dte/projects/mcarthurseg3>