

REMOVE AND DISPOSE OF EXISTING FENCE		
STATION	LF	REMARKS
107+20 TO 107+86	182	TRAIL RIGHT TO LEFT
107+56 TO 108+44	90	TRAIL LEFT
108+30 TO 109+00	77	TRAIL LEFT

8 FOOT GALVANIZED CHAIN LINK FENCE		
STATION	LF	REMARKS
107+29 TO 108+60	129	TRAIL RIGHT
107+59 TO 109+00	162	TRAIL LEFT

MODIFIED TYPE F CONCRETE CURB		
STATION	LF	REMARKS
107+29 TO 109+00	171	TRAIL RIGHT

LEGEND	
	HOT MIX ASPHALT FULL DEPTH PAVEMENT
	HOT MIX ASPHALT TRAIL
	GRIND AND HOT MIX ASPHALT OVERLAY
	CONCRETE DRIVEWAY
	PAVEMENT REMOVAL
	CONCRETE SIDEWALK
	BRICK EDGER
	HORIZONTAL LINE ID NUMBER
	HORIZONTAL CURVE ID NUMBER

MATCH LINE STA. 109+00 - SEE DRAWING PS02

- NOTES:**
1. SEE GEOMETRY SHEET GS01 FOR HORIZONTAL CURVE AND LINE DATA.
  2. SEE DRAWING TS01 FOR LIMITS OF EARTHWORK MEASUREMENT.
  3. SEE DRAINAGE PROFILE SHEET PP02 FOR STORM DRAIN DETAILS.
  4. SLOPE TRAIL CONNECTION AT A MAXIMUM LONGITUDINAL SLOPE OF 5.0%

MODIFIED TYPE F CURB LAYOUT SCHEDULE						
CONSTRUCTION METROPOLITAN BRANCH TRAIL						
POINT NO.	STATION	OFFSET	NORTHING	EASTING	ELEV.	BACKSIDE CURB HT.
91	107+28.93	7.00' RT	482491.9195	1304238.9806	335.98'	24"
92	107+50.00	7.00' RT	482475.3572	1304251.9087	335.59'	24"
93	108+00.00	7.00' RT	482435.9430	1304282.6743	335.47'	16"
94	108+50.00	7.00' RT	482396.5289	1304313.4400	335.96'	14"
95	109+00.00	7.00' RT	482357.1142	1304344.2060	336.45'	14"

N:\SWH-110\000\Plan\_2\F2-11010101-01.dwg 2/2/2020

SEE SHEET NO. 3 FOR PROFESSIONAL CERTIFICATION SEALS AND SIGNATURES

**OWNER/ADDRESS:**  
MONTGOMERY COUNTY DEPARTMENT OF TRANS.  
100 EDISON PARK DRIVE, 4TH FLOOR  
GAITHERSBURG, MD 20878

**CONTACT:**  
DIVISION OF TRANSPORTATION ENGINEERING:  
240-777-7220  
DESIGN SECTION: 240-777-7221

NO.	REVISION	DATE	BY

MONTGOMERY COUNTY  
DEPARTMENT OF TRANSPORTATION  
GAITHERSBURG, MARYLAND

RECOMMENDED FOR APPROVAL:  
SEE TITLE SHEET FOR SIGNATURE \_\_\_\_\_ Date \_\_\_\_\_  
Chief, Transportation Planning and Design Section

APPROVED:  
SEE TITLE SHEET FOR SIGNATURE \_\_\_\_\_ Date \_\_\_\_\_  
Chief, Division of Transportation Engineering

Designed by:    DDB Drawn by:    DDB Checked by:    JAG

PS01 - ROADWAY PLAN  
METROPOLITAN BRANCH TRAIL  
PHASE II  
FROM SILVER SPRING TRANSIT CENTER  
TO KING STREET

SCALE: 1"=20'  
MARCH 2021

Project No.:    501110 SHEET    16 of    247

TEST HOLE RESULTS								
POINT NO.	@	STATION	OFFSET	NORTHING	EASTING	DESCRIPTION	DEPTH	MATERIAL
*TP-04	GEORGIA	205+09.78	4.34 RT.	481985.2800	1,304,762.3300	8"x14" FO DUCT	4.41'	TERRACOTTA
*TP-05	GEORGIA	203+67.49	4.17 RT.	481843.0000	1,304,708.8000	8"x15" FO DUCT	5.06'	TERRACOTTA
*TP-06	SELM	499+34.72	10.22 RT.	481972.4922	1,304,825.9532	SEWER	UNKN	UNKNOWN
*TP-07	SELM	501+13.56	13.55 LT.	481795.9700	1,304,858.1100	8" SEWER	6.98'	TERRACOTTA
*TP-08	SELM	501+15.25	11.43 LT.	481794.0700	1,304,856.2200	6" WATER	4.97'	CAST IRON
*TP-09	SELM	501+14.17	0.14 LT.	481793.6800	1,304,844.8800	2" GAS	4.50'	STEEL
*TP-11	MBT	117+90.36	17.96 LT.	481724.5200	1,304,851.2900	2" GAS	4.02'	STEEL
*TP-12	MBT	118+08.34	23.05 LT.	481708.0300	1,304,860.0800	2" GAS	3.81'	STEEL
*TP-13	MBT	118+27.39	28.71 LT.	481697.2400	1,304,868.6700	NOT FOUND		
*TP-17	SELM	507+72.78	2.46' LT.	481234.2900	1,305,181.6100	8" WATER	4.02'	PLASTIC
*TP-31	SELM	501+08.50	0.40' LT.	481798.9500	1,304,844.9600	2" GAS	4.42'	STEEL
*TP-33A	GEORGIA	203+80.86	2.19' RT.	481856.4000	1,304,758.9800	UNKNOWN	6.02'	TERRACOTTA
*TP-33B	GEORGIA	203+80.86	2.49' RT.	481856.3700	1,304,759.2200	ROUGH POUR	4.79'	CONCRETE
*TP-34A	GEORGIA	203+76.86	2.79' RT.	481852.3200	1,304,759.2200	***10" WATER	6.29'	CAST IRON
*TP-37A	GEORGIA	203+75.95	1.59' LT.	481851.4700	1,304,755.0800	***10" WATER	5.07'	CAST IRON
*TP-41	GEORGIA	203+45.71	1.56' LT.	481821.4300	1,304,754.8700	29" DUCT	4.18'	CONCRETE

- LOCATED ON PS-03
- LOCATED ON PS-04
- UTILITY FOUND TO BE ABANDONED

8 FOOT GALVANIZED CHAIN LINK FENCE		
STATION	LF	REMARKS
109+00 TO 110+15	118	TRAIL LEFT
111+53 TO 112+78	124	TRAIL LEFT

COMBINATION CONCRETE CURB AND GUTTER TYPE A (STD. NO. MC-100.01)		
STATION	LF	REMARKS
*112+78 TO 113+35	54	TRAIL LEFT
*113+80 TO 113+94	22	TRAIL LEFT
113+80 TO 114+00	13	TRAIL RIGHT

\*SPILL-OUT GUTTER PAN - SLOPE GUTTER PAN AWAY FROM CURB

MODIFIED COMBINATION CONCRETE CURB AND GUTTER (DRAWING DE02)				
STATION	LF	WIDTH	HEIGHT	REMARKS
113+43 TO 113+64	22	3'	0" TO 6"	TRAIL LEFT

CONVERT EX. INLET TO JUNCTION BOX*			
STATION, OFFSET	STRUCTURE TYPE	C.Y.	REMARKS
109+40, 1.0' RT.	INLET - EX I-9	2	

\*SEE NOTE 5.

5" CONCRETE SIDEWALK		
STATION	SF	REMARKS
206+07 TO 206+48	253	GEORGIA AVENUE RIGHT*

\*REPLACE SIDEWALK TO THE NEAREST EXISTING JOINT

LEGEND	
[Pattern]	HOT MIX ASPHALT FULL DEPTH PAVEMENT
[Pattern]	HOT MIX ASPHALT TRAIL
[Pattern]	GRIND AND HOT MIX ASPHALT OVERLAY
[Pattern]	CONCRETE DRIVEWAY
[Pattern]	PAVEMENT REMOVAL
[Pattern]	CONCRETE SIDEWALK
[Pattern]	BRICK EDGER
X-A	HORIZONTAL LINE ID NUMBER
X-1	HORIZONTAL CURVE ID NUMBER

- NOTES:
- SEE GEOMETRY SHEET GS01 FOR HORIZONTAL CURVE AND LINE DATA.
  - BEFORE RESURFACING OF EXISTING TRAIL, THE CONTRACTOR MAY USE THE TRAIL AREA FROM STA. 109+75 TO STA. 112+65 FOR STAGING, STORAGE, OR STOCKPILING. AFTER GRINDING AND OVERLAY IS COMPLETE, MATERIAL STORAGE AND STOCKPILING IS NOT PERMITTED ON THE TRAIL SURFACE.
  - PRIOR TO INSTALLING THE TOP SLAB FOR THE JUNCTION BOX J-1, THE DRAINAGE STRUCTURES EX I-9 AND PR I-9 MUST BE FLUSHED BY BLOCKING THE MOST DOWNSTREAM STRUCTURE AND COLLECTING ALL SEDIMENT-LADEN FLUSHED FLOWS VIA VACUUM TRUCK OR OTHER APPROVED MEANS. ALL SEDIMENT-LADEN WATER SHALL BE REMOVED AND DISCARDED OFFSITE AT AN APPROVED DISPOSAL SITE. PIPE CLEANING FOR NEW PIPES SHALL BE INCIDENTAL TO THE COST OF THE PIPE.
  - SEE DRAWING PP02 FOR STORM DRAIN STRUCTURES AND PIPE SCHEDULES. PIPE CONNECTION TO EXISTING INLET EX I-9 (BELOW JUNCTION BOX J-1 SLAB) SHALL BE MIX NO. 2 CONCRETE FOR INLET CONVERSION.
  - CONVERSION OF EXISTING AT-GRADE INLET TO JUNCTION BOX INCLUDES REMOVAL OF VERTICAL SECTION AND INSTALLATION OF CONCRETE SLAB TO FINAL ELEVATION PER DETAIL ON DRAWING DE04.

MATCH LINE STA. 109+00 - SEE DRAWING PS01

MATCH LINE STA. 114+00 - SEE DRAWING PS03

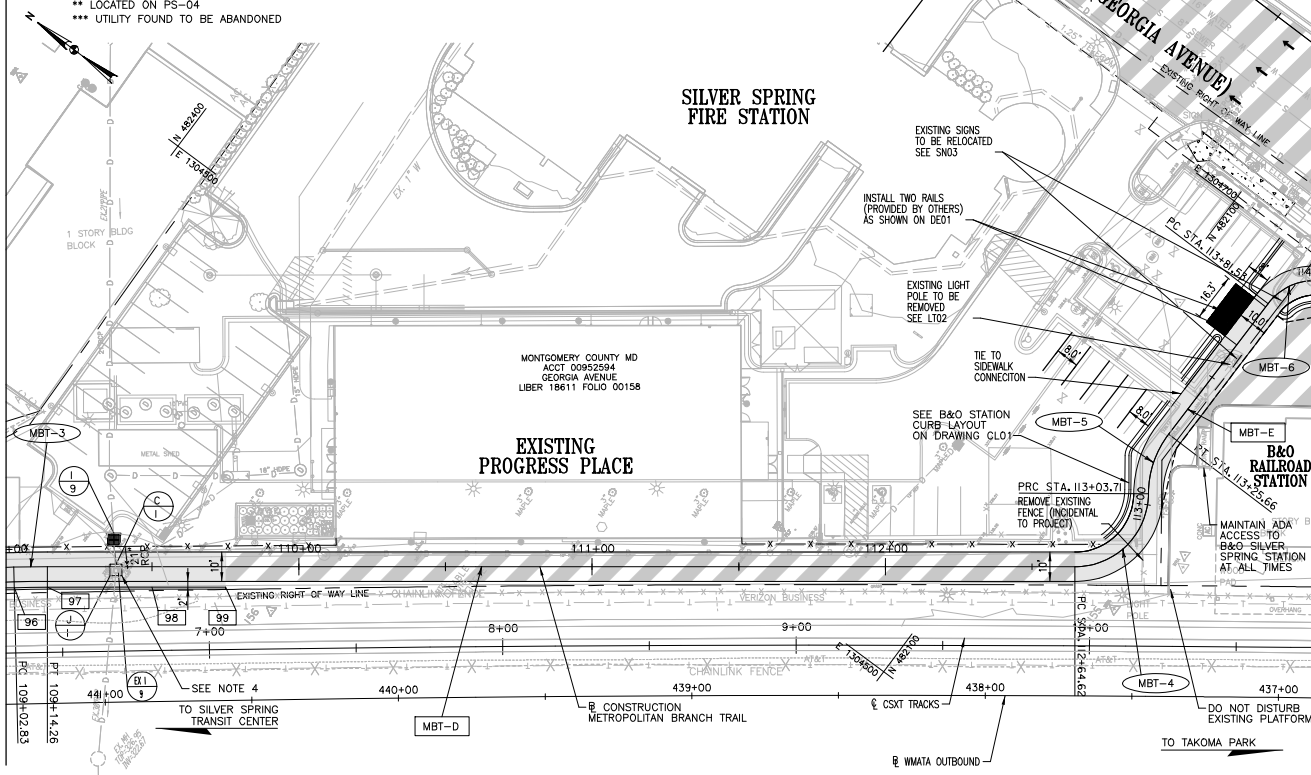

BRICK EDGER		
STATION	SF	REMARKS
113+64 TO 113+80	128	MATCH PATTERN SHOWN ON PLAN

MODIFIED TYPE F CONCRETE CURB		
STATION	LF	REMARKS
109+00 TO 109+75	75	TRAIL RIGHT

MODIFIED TYPE F CURB LAYOUT SCHEDULE						
CONSTRUCTION METROPOLITAN BRANCH TRAIL						
POINT NO.	STATION	OFFSET	NORTHING	EASTING	BACKSIDE CURB HT.	
96	109+02.83	7.00' RT	482354.8872	1304345.9444	336.48'	15"
97	109+14.26	7.00' RT	482345.8247	1304352.7768	336.59'	18"
98	109+50.00	7.00' RT	482317.2529	1304374.1208	336.84'	18"
99	109+75.00	7.00' RT	482297.2010	1304389.0479	337.19'	9"

OWNER/ADDRESS:  
MONTGOMERY COUNTY DEPARTMENT OF TRANS.  
100 EDISON PARK DRIVE, 4TH FLOOR  
GAITHERSBURG, MD 20878

CONTACT:  
DIVISION OF TRANSPORTATION ENGINEERING:  
240-777-7220  
DESIGN SECTION: 240-777-7221

SEE SHEET NO. 3 FOR PROFESSIONAL  
CERTIFICATION SEALS AND SIGNATURES

MONTGOMERY COUNTY  
DEPARTMENT OF TRANSPORTATION  
GAITHERSBURG, MARYLAND

RECOMMENDED FOR APPROVAL:  
SEE TITLE SHEET FOR SIGNATURE \_\_\_\_\_ Date \_\_\_\_\_  
Chief, Transportation Planning and Design Section

APPROVED:  
SEE TITLE SHEET FOR SIGNATURE \_\_\_\_\_ Date \_\_\_\_\_  
Chief, Division of Transportation Engineering

Designed by: DBB Drawn by: DBB Checked by: JAG

PS02 - ROADWAY PLAN  
METROPOLITAN BRANCH TRAIL  
PHASE II  
FROM SILVER SPRING TRANSIT CENTER  
TO KING STREET

SCALE: 1"=20'

MARCH 2021

Project No.: S001110 SHEET 17 of 247

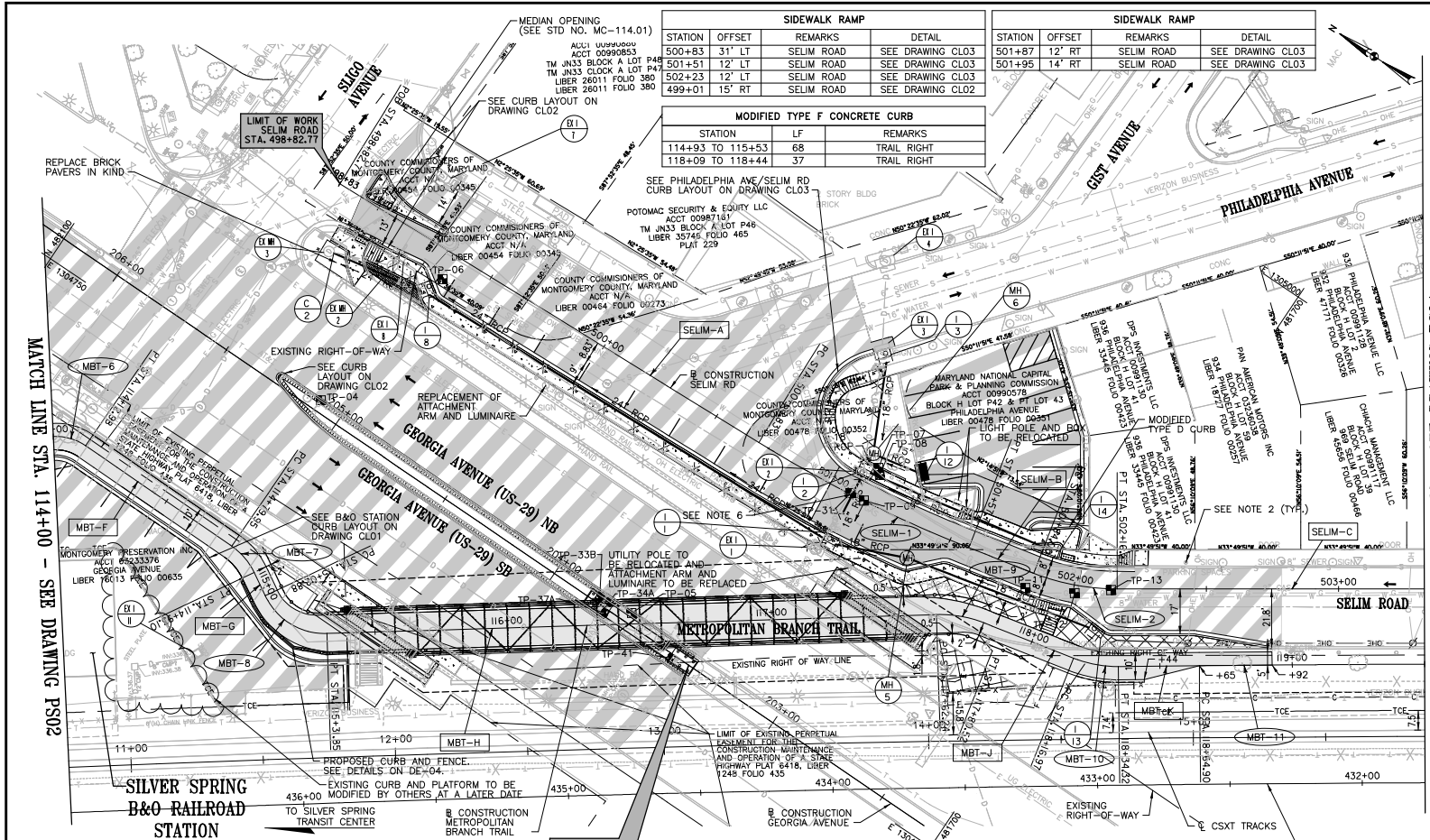

MATCH LINE STA. 114+00 - SEE DRAWING PS02

MATCH LINE STA. 119+50 - SEE DRAWING PS04

BICYCLE RAILING		
STATION	LF	REMARKS
114+87 TO 115+33	40	TRAIL LEFT
114+93 TO 115+54	68	TRAIL RIGHT
117+38 TO 117+81	46	TRAIL LEFT
117+58 TO 118+00	40	TRAIL RIGHT

LEGEND	
	HOT MIX ASPHALT FULL DEPTH PAVEMENT
	HOT MIX ASPHALT TRAIL
	GRIND AND HOT MIX ASPHALT OVERLAY
	CONCRETE DRIVEWAY
	PAVEMENT REMOVAL
	CONCRETE SIDEWALK
	BRICK EDGER
	HORIZONTAL LINE ID NUMBER
	HORIZONTAL CURVE ID NUMBER

REMOVE EXISTING MASONRY				
STATION, OFFSET	STRUCTURE TYPE	INLET - EX	I-1*	C.Y.
501+08, 21.2' RT.	INLET - EX I-1*			2
501+08, 7.0' LT.	INLET - EX I-2*			2
499+46, 11.0' RT.	INLET - EX I-8			2
500+94, 53.0' LT.	INLET - EX I-3*			4
499+16, 16.8' RT.	MANHOLE - EX MH-2			4

\* COST OF REMOVAL OF STRUCTURE IS INCIDENTAL TO COST OF INSTALLATION OF INLETS.

REMOVE EXISTING PIPE - ANY SIZE				
STATION, OFFSET	SIZE	TYPE	LENGTH	
501+08, 21.2' RT. TO 501+08, 7.0' LT.	18"	RCP	28'	
501+08, 21.2' RT. TO 499+16, 16.8' RT.	21"	RCP	190'	
499+16, 11.0' RT. TO 499+16, 16.8' RT.	18"	RCP	2'	
500+94, 53.1' LT. TO 501+08, 7.0' LT.	18"	RCP	42'	
498+93, 24.1' RT. TO 499+16, 16.8' RT.	24"	RCP	21'	

\* COST OF REMOVAL OF PIPE IS INCIDENTAL TO COST OF INSTALLATION OF 18" RCP BETWEEN INLETS.

TYPE A CONCRETE CURB (STD. NO. MD-620.02)		
STATION	LF	REMARKS
203+39 TO 205+29	384	GEORGIA AVENUE LEFT/RIGHT

DETECTABLE WARNING SURFACE (STD. NO. MD-655.40)		
STATION	SF	REMARKS
498+99 TO 499+04	11	SELM ROAD LEFT
498+99 TO 499+04	10	SELM ROAD LEFT
500+81 TO 500+84	16	SELM ROAD LEFT
498+99 TO 499+04	10	SELM ROAD RIGHT
501+92 TO 501+98	10	SELM ROAD LEFT
501+93 TO 501+98	10	SELM ROAD RIGHT

7" CONCRETE DRIVEWAY (STD. NO. MC 302.01)		
STATION	SY	REMARKS
501+50 TO 501+82	18	SELM ROAD LEFT
501+98 TO 502+28	26	SELM ROAD LEFT

OWNER/ADDRESS:  
MONTGOMERY COUNTY DEPARTMENT OF TRANS.  
100 EDISON PARK DRIVE, 4TH FLOOR  
GAITHERSBURG, MD 20878

CONTACT:  
MICHAEL MITCHELL, P.E.  
MONTGOMERY COUNTY DEPARTMENT OF TRANS.  
240-777-7262

SEE SHEET NO. 3 FOR PROFESSIONAL CERTIFICATION SEALS AND SIGNATURES

SIDEWALK RAMP			
STATION	OFFSET	REMARKS	DETAIL
500+83	31' LT	SELM ROAD	SEE DRAWING CLO3
501+51	12' LT	SELM ROAD	SEE DRAWING CLO3
502+23	12' LT	SELM ROAD	SEE DRAWING CLO3
499+01	15' RT	SELM ROAD	SEE DRAWING CLO2

MODIFIED TYPE F CONCRETE CURB			
STATION	LF	REMARKS	
114+93 TO 115+53	68	TRAIL RIGHT	
118+09 TO 118+44	37	TRAIL RIGHT	

SEE PHILADELPHIA AVE/SELM RD CURB LAYOUT ON DRAWING CLO3

SIDEWALK RAMP			
STATION	OFFSET	REMARKS	DETAIL
501+87	12' RT	SELM ROAD	SEE DRAWING CLO3
501+95	14' RT	SELM ROAD	SEE DRAWING CLO3

MODIFIED COMBINATION CONCRETE CURB AND GUTTER (DRAWING DE02)				
STATION	LF	WIDTH	HEIGHT	REMARKS
501+29 TO 501+40	11	0'-3"	11"	SELM ROAD LEFT
501+55 TO 502+02	75	2'	6"	SELM ROAD LEFT

REMOVAL OF EXISTING COMBINATION CURB & GUTTER		
STATION	LF	REMARKS
499+03 TO 502+75	372	SELM ROAD RIGHT

BRICK EDGER		
STATION	SF	REMARKS
203+39 TO 205+29	506	GEORGIA AVENUE LEFT/RIGHT
499+06 TO 499+36	102	SELM ROAD RIGHT

REMOVE AND DISPOSE OF EXISTING FENCE		
STATION	LF	REMARKS
117+64 TO 119+50	182	TRAIL RIGHT

8 FOOT GALVANIZED CHAIN LINK FENCE		
STATION	LF	REMARKS
117+64 TO 118+44	76	TRAIL RIGHT

5" CONCRETE SIDEWALK		
STATION	SF	REMARKS
202+67 TO 203+16	295	GEORGIA AVENUE RIGHT*
204+10 TO 204+70	368	GEORGIA AVENUE LEFT*
498+94 TO 499+27	158	SELM ROAD LEFT
500+81 TO 501+50	475	SELM ROAD LEFT
501+82 TO 501+98	135	SELM ROAD LEFT
498+91 TO 502+00	1722	SELM ROAD RIGHT

\* REPLACE SIDEWALK TO THE NEAREST EXISTING JOINT PAST LIMITS OF ADJUTMENT CONSTRUCTION.

TYPE A COMBINATION CONCRETE CURB AND GUTTER (STD. NO. MC-100.01)		
STATION	LF	REMARKS
114+00 TO 115+40	158	B&O STATION PARKING LOT
500+79 TO 502+23	175	SELM ROAD LEFT
498+91 TO 502+75	396	SELM ROAD RIGHT
501+26 TO 501+56	40	SELM RD LEFT / PARKING LOT
501+57 TO 501+76	98	SELM RD LEFT / PARKING LOT

MODIFIED TYPE D CONCRETE CURB		
STATION	LF	REMARKS
498+91 TO 499+08	20	SELM ROAD RIGHT
499+05 TO 499+36	33	SELM ROAD RIGHT
501+10 TO 501+25	15	SELM ROAD LEFT
501+76 TO 501+98	28	SELM ROAD LEFT

DIVIDER CURB		
STATION	LF	REMARKS
498+94 TO 498+99	5	SELM ROAD RIGHT

MODIFIED TYPE E CONCRETE CURB		
STATION	LF	REMARKS
498+93 TO 499+28	81	SELM ROAD LEFT

REMOVAL OF EXISTING PAVEMENT		
STATION	CY	REMARKS
499+03 TO 502+75	118	SELM ROAD RIGHT
117+57 TO 118+01	7	TRAIL RIGHT

- NOTES:
- SEE GEOMETRY SHEET GS01 FOR HORIZONTAL CURVE AND LINE DATA.
  - THE MCDOT DIVISION OF PARKING MANAGEMENT WILL REMOVE ALL PARKING METERS ALONG EAST SIDE OF SELM ROAD. THE PARKING METERS ALONG THE WEST SIDE OF SELM ROAD WILL BE RELOCATED AS NEEDED BY THE MCDOT DIVISION OF PARKING MANAGEMENT. CONTACT THE MCDOT DIVISION OF PARKING MANAGEMENT AT 240-777-8740 TO COORDINATE PARKING METER REMOVAL OR RELOCATION.
  - SEE STRUCTURE SHEETS FOR STAIR, BRIDGE, AND RETAINING WALL LOCATION.
  - ONCE THE DRAINAGE AREAS ARE STABILIZED, THE STORM DRAIN SYSTEM BETWEEN UPSTREAM INLETS AND EXISTING MANHOLE EX MH-3, INCLUDING EXISTING INLETS EX I-4, EX I-7 AND EX I-11, WILL BE FLUSHED BY BLOCKING THE MOST DOWNSTREAM STRUCTURE AND COLLECTING ALL SEDIMENT-LADEN FLUSHED FLOWS VIA VACUUM TRUCK OR OTHER APPROVED MEANS. ALL SEDIMENT-LADEN WATER SHALL BE REMOVED AND DISCARDED OFFSITE AT AN APPROVED DISPOSAL SITE. PIPE CLEANING FOR NEW PIPES SHALL BE INCIDENTAL TO THE COST OF THE PIPE.
  - SEE DRAWING PP02 FOR STORM DRAIN STRUCTURE AND PIPE SCHEDULES. COST OF PIPE CONNECTIONS TO EXISTING MANHOLE AND C-2, IS INCIDENTAL TO COST OF PIPE INSTALLATION.
  - EXISTING 3" GAS LINE HAS AN APPROXIMATE INVERT ELEVATION OF 337.62'. CONTRACTOR TO VERIFY EXACT LOCATION OF GAS LINE BEFORE EXCAVATION AND INSTALLATION OF 18" RCP. IF RELOCATION OF GAS LINE IS NECESSARY, COORDINATE WITH WASHINGTON GAS.

MONTGOMERY COUNTY DEPARTMENT OF TRANSPORTATION GAITHERSBURG, MARYLAND		PS03 - ROADWAY PLAN  METROPOLITAN BRANCH TRAIL PHASE II FROM SILVER SPRING TRANSIT CENTER TO KING STREET	
RECOMMENDED FOR APPROVAL: SEE TITLE SHEET FOR SIGNATURE Chief, Transportation Planning and Design Section		Date	
APPROVED: SEE TITLE SHEET FOR SIGNATURE Chief, Division of Transportation Engineering		Date	
Designed by: <u>DBB</u> Drawn by: <u>DBB</u> Checked by: <u>JMS</u>		Project No.: <u>501110</u> SHEET <u>18A</u> of <u>247</u>	