

Welcome

Montgomery County Department of Transportation

Shady Grove Road Vision Zero Pedestrian and Bicycle Improvements

Community Meeting

July 9, 2024



*Montgomery County
Department of Transportation*

Project Team

Montgomery County Department of Transportation:

- Cameron McAllister – Sr. Planning Specialist, Project Manager
Cameron.McAllister@montgomerycountymd.gov
- Dan Sheridan – Chief, Transportation Planning & Design
Daniel.Sheridan@montgomerycountymd.gov

Engineering Consultants:

- Mercado Consultants, Inc.
- Toole Design Group



Meeting Agenda

1. Background Information
2. Strategies to Improve Pedestrian and Bicycle Safety
3. Presentation of Preliminary Design Concepts
4. Question and Answer Session



Introduction

The purpose of this concept study is to improve pedestrian and bicycle safety along Shady Grove Road as part of Montgomery County's [Vision Zero Plan](#).

The project limits extend from Darnestown Road to Midcounty Highway.

The segment we will be looking at today begins at **Gaither Road** and extends to **Midcounty Highway**.

This project has not yet been funded for construction and our purpose today is to gather community feedback on the proposed concept.

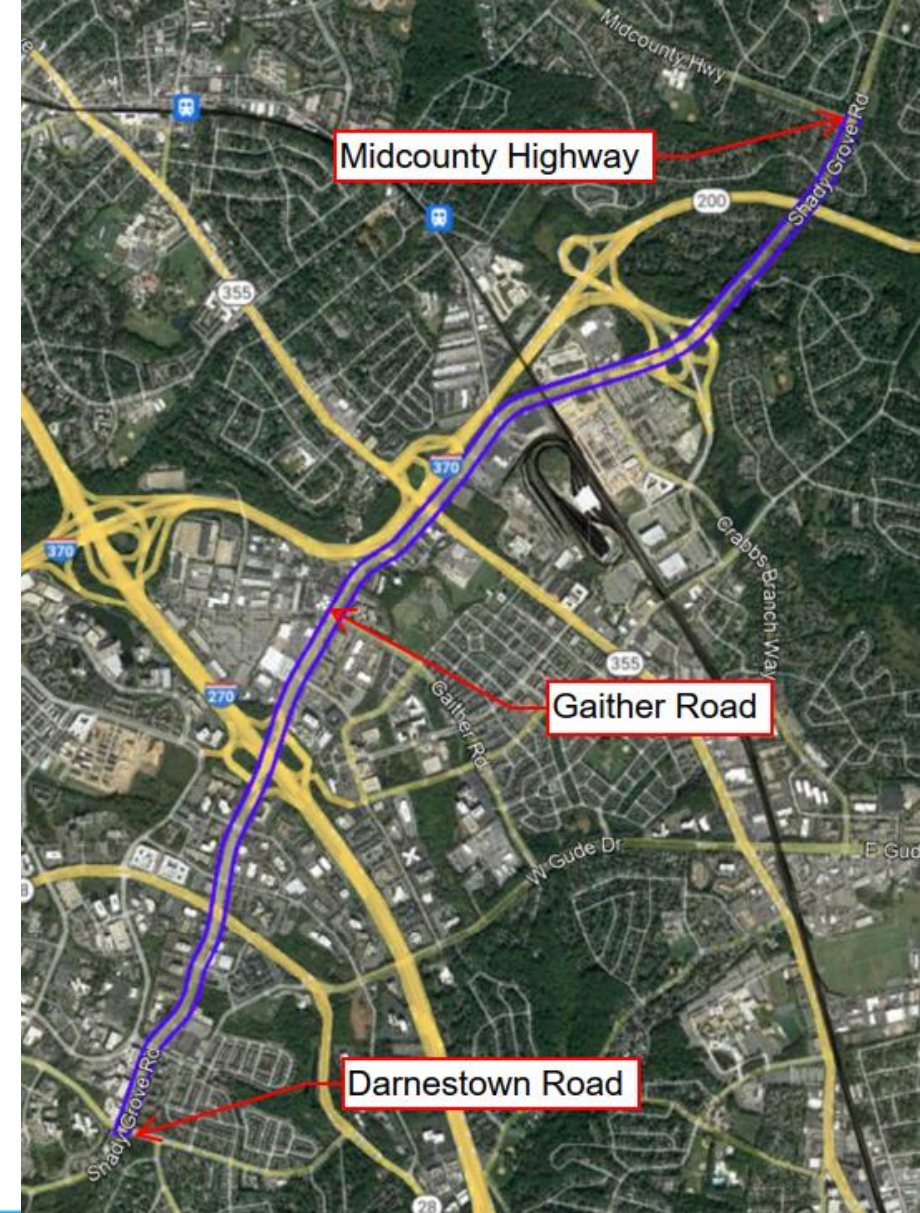

Project Background Information

- Montgomery County Vision Zero Program
 - Bicycle Stress Level has been identified as high
- Improve pedestrian and bicycle safety along Shady Grove Road
- Evaluate existing conditions:
 - Lane configurations
 - Signing
 - Pavement markings
 - Adjacent paths
 - Right-of-Way limitations
 - Utilities



Project Timeline

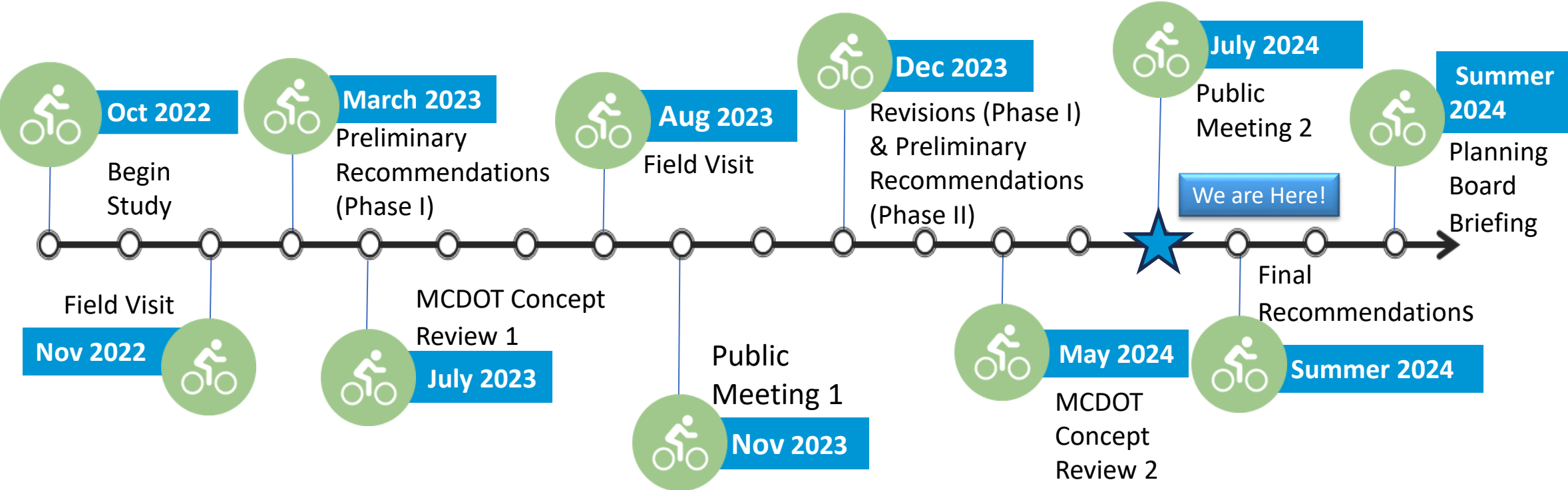

Definitions

- **Breezeway Network:** A high-capacity network of arterial bikeways between major activity centers, enabling bicyclists to travel with fewer delays, and where all users – including slower moving bicyclists and pedestrians – can safely and comfortably coexist.
- **Shared Use Path:** Facility located outside of the road paved surface that provide two-way travel for people walking, bicycling and using other non-motorized modes.
- **Buffer:** Space between vehicular traffic and pedestrian/bicyclist facility.
- **Right-of-Way:** Land owned by MCDOT used for transportation facilities.
- **Vision Zero:** Montgomery County’s goal for zero pedestrian and bicyclist fatalities & serious-injuries by 2030.



Strategies to Implement along Shady Grove Road

Goal

- To reduce conflict points between drivers, pedestrians, and cyclists

Strategies

1. Move on-street bicycle facilities to shared use path.
2. Widen existing sidewalk to accommodate both pedestrians and bicyclists.
3. Reduce lane widths to 10' (inside lanes) or 11' (curb lanes)

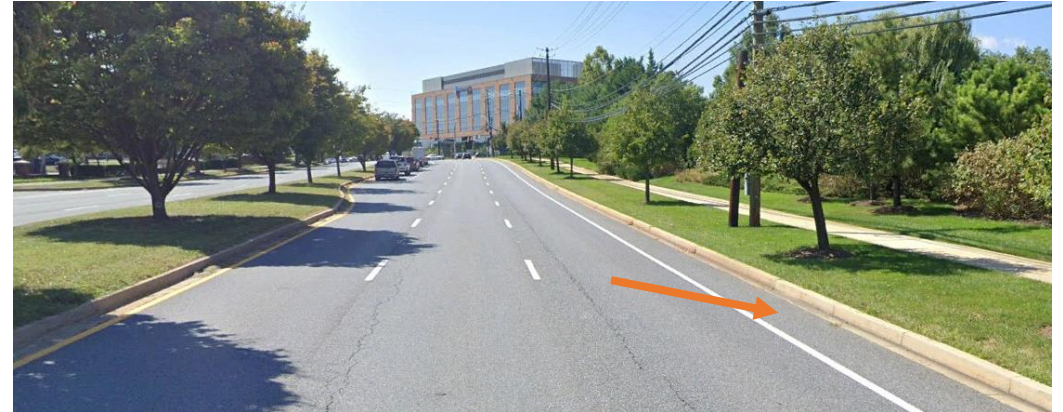

Strategies to Implement at Intersections along Shady Grove Road

Goal

- To improve pedestrian and cyclist safety at intersections

Strategies

1. Extend median nose
2. Reduce Corner Radii
3. Removal of Slip Lanes
4. Hardened Centerlines
5. No Right turn on red
6. Protected Left turns

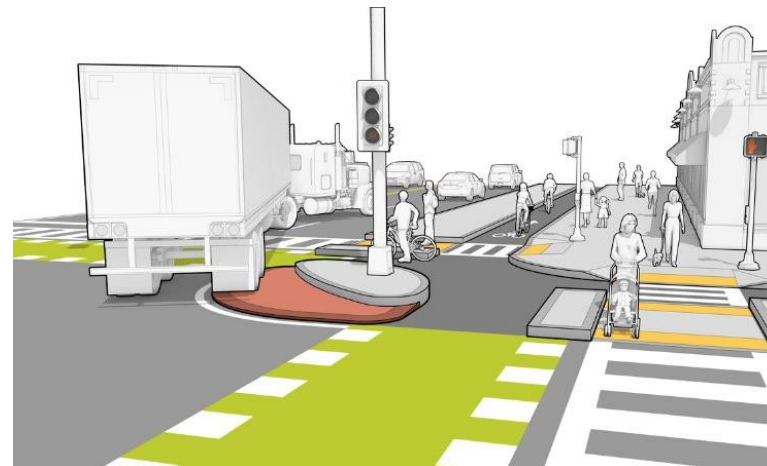
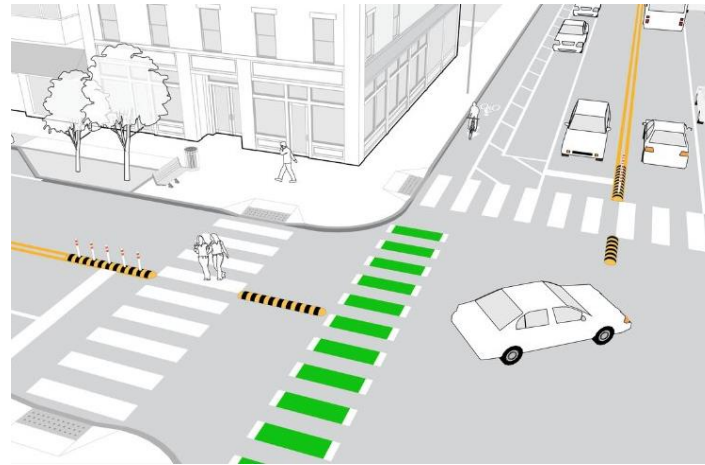

Section 1

Gaither Road to Comprint Court

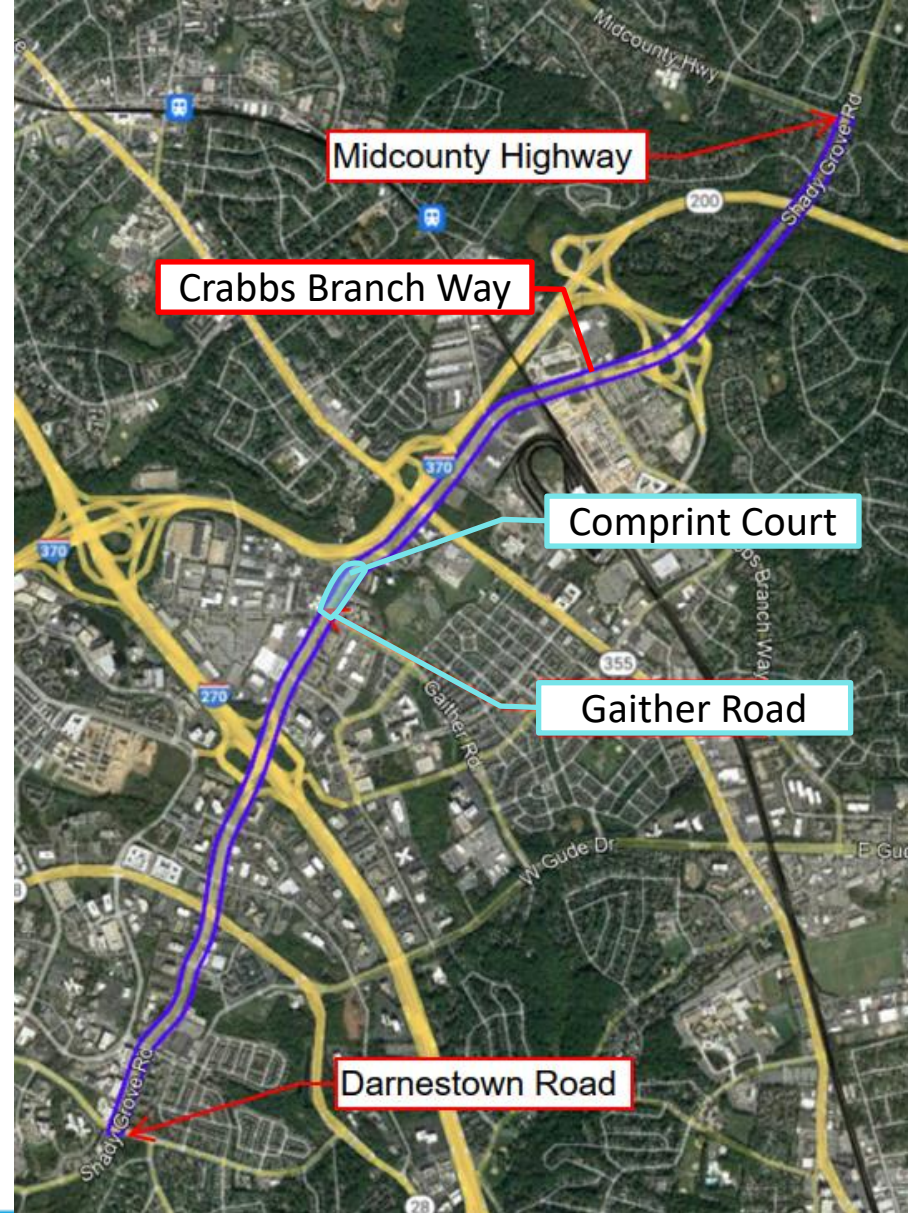

Gaither Road to Comprint Court

Option 1

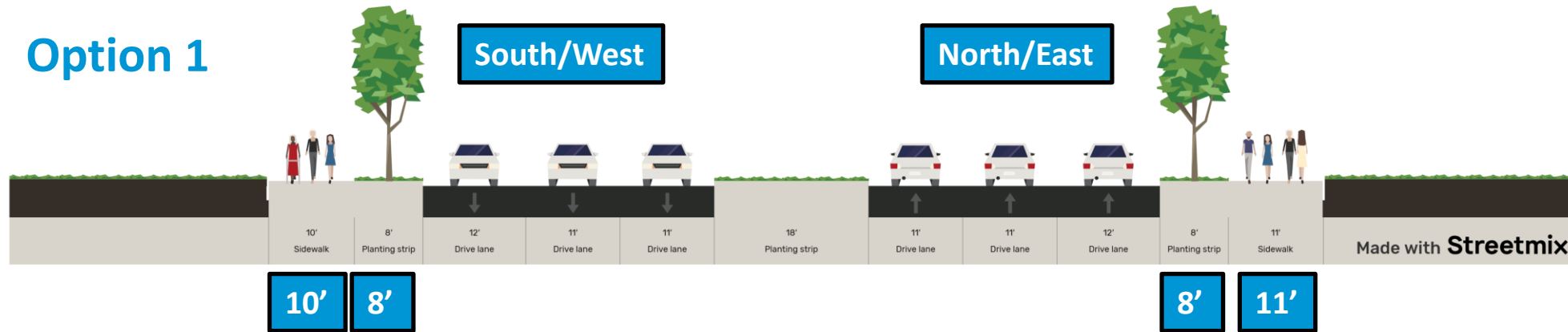

Option 2

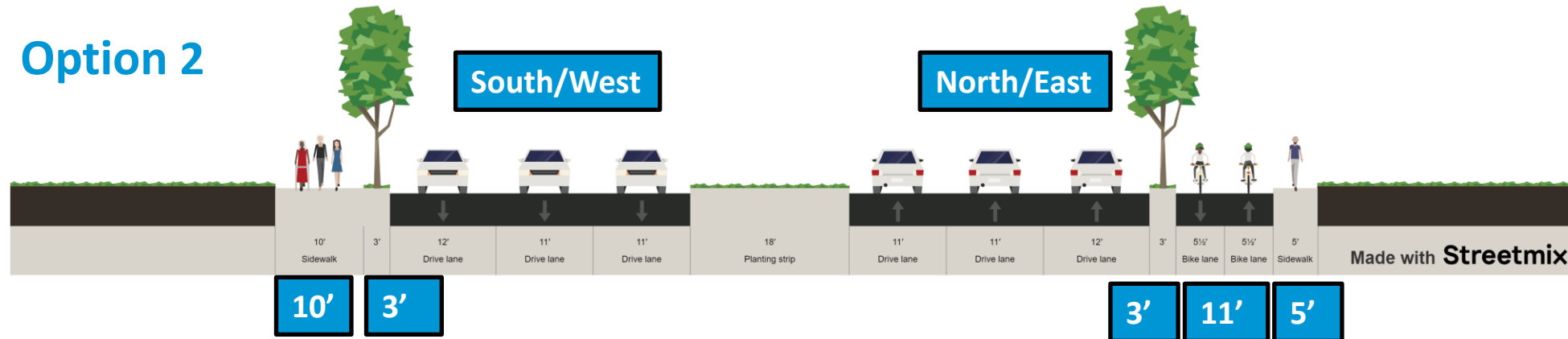

Gaither Road to Comprint Court – Option 1



Gaither Road to Comprint Court – Existing



Gaither Road to Comprint Court – Option 1



8' Grass Buffer

11' Shared Use Path



Section 2

Comprint Court to Crabbs Branch Way

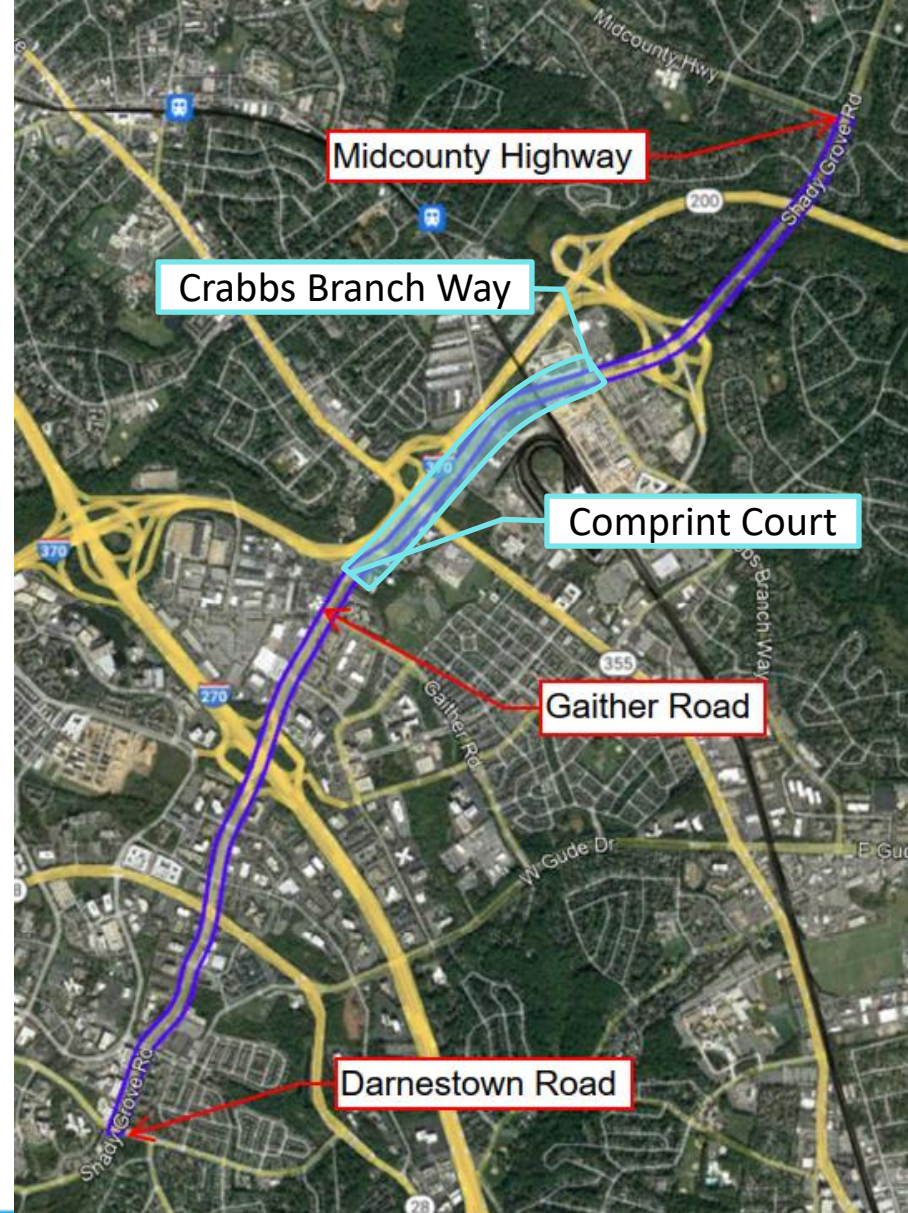

Comprint Court to Crabbs Branch Way

Option 1

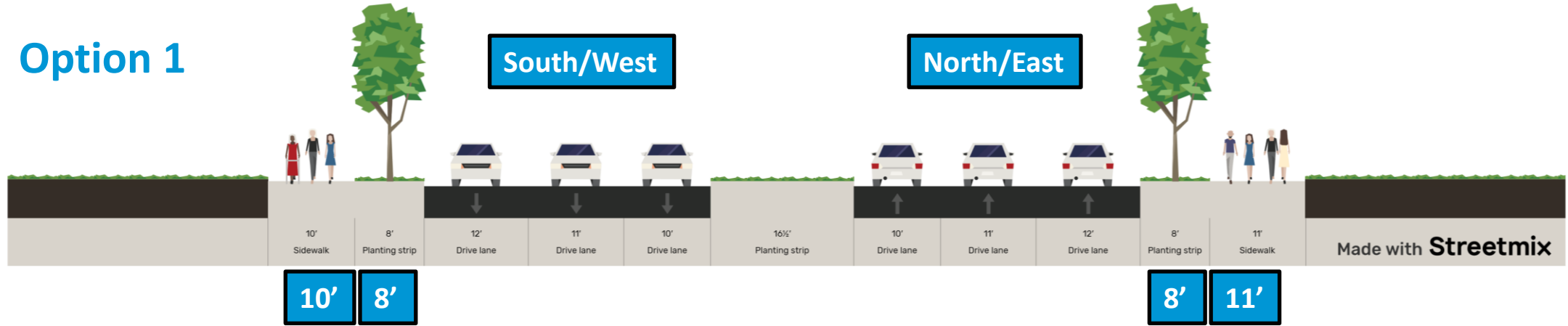

Option 2

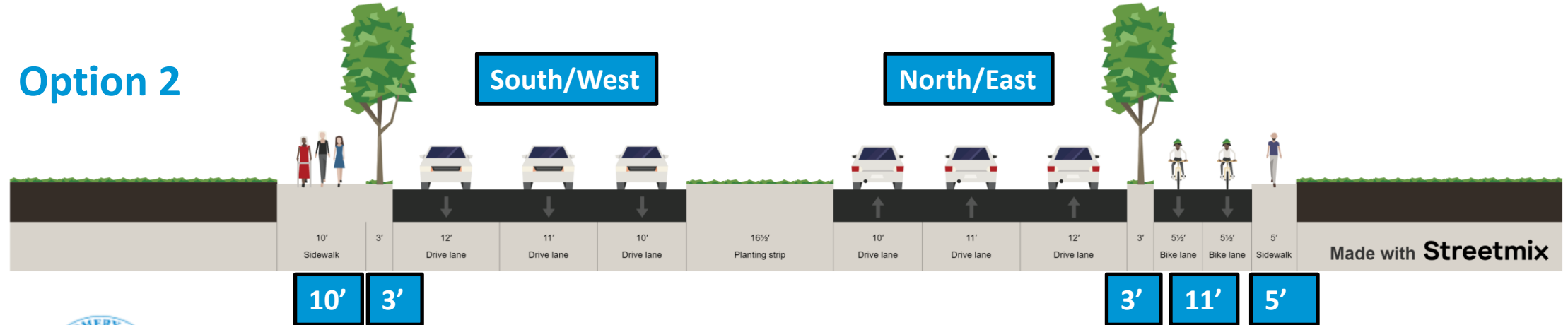

Comprint Court to Crabbs Branch Way – Option 1

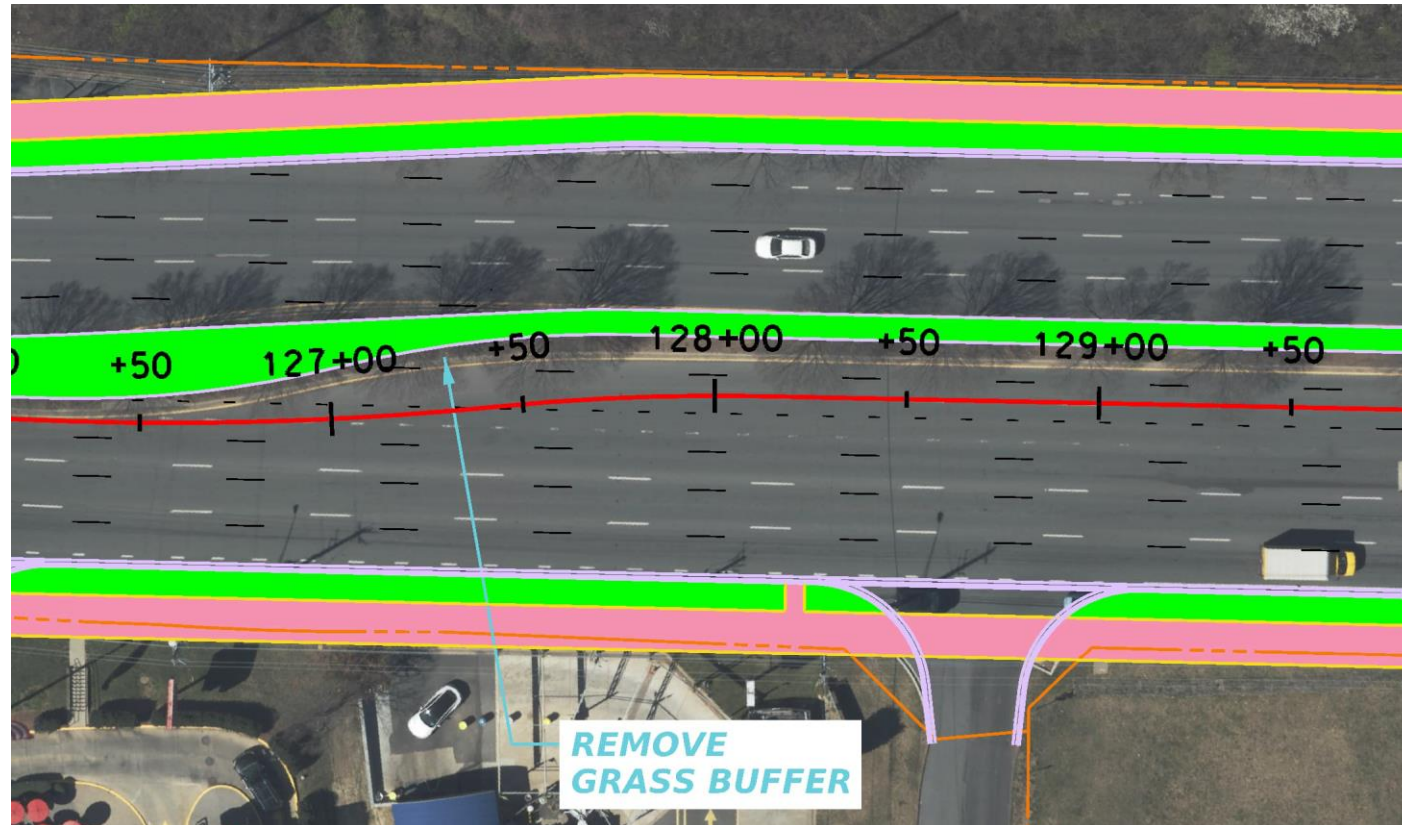

Comprint Court to Crabbs Branch Way – Existing

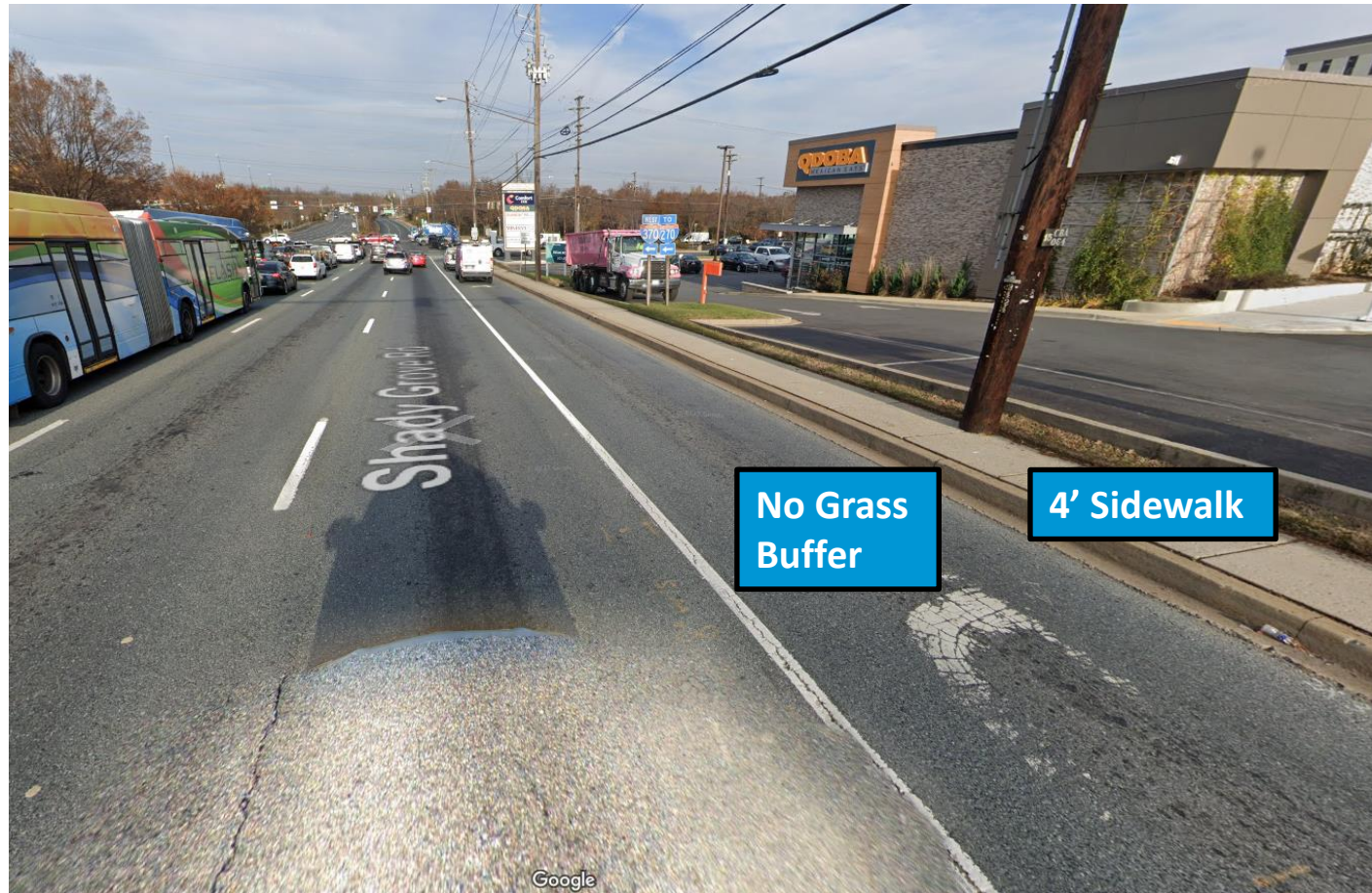

Comprint Court to Crabbs Branch Way – Option 1



Shady Grove at MD 355

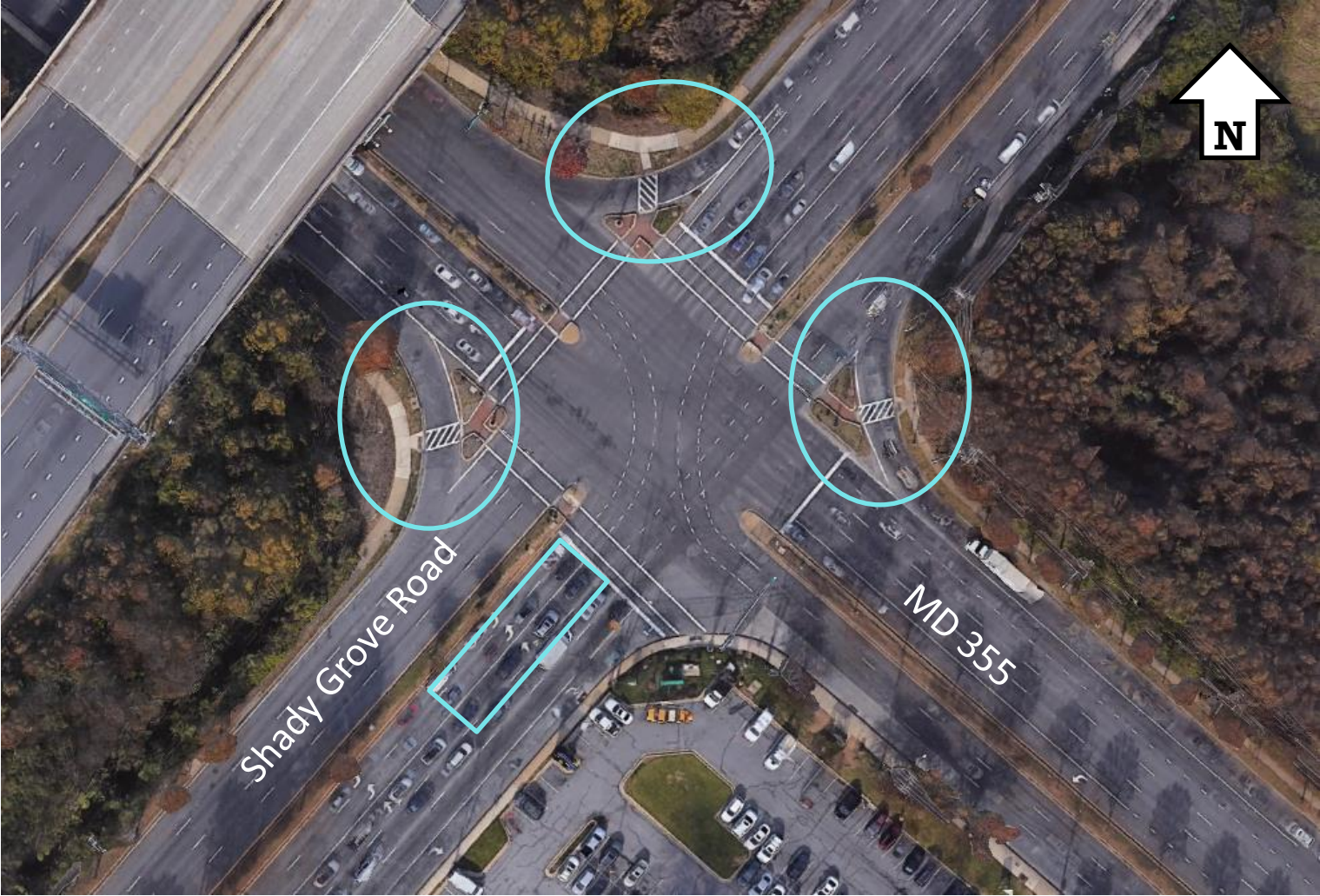

Shady Grove at MD 355 - Improvements

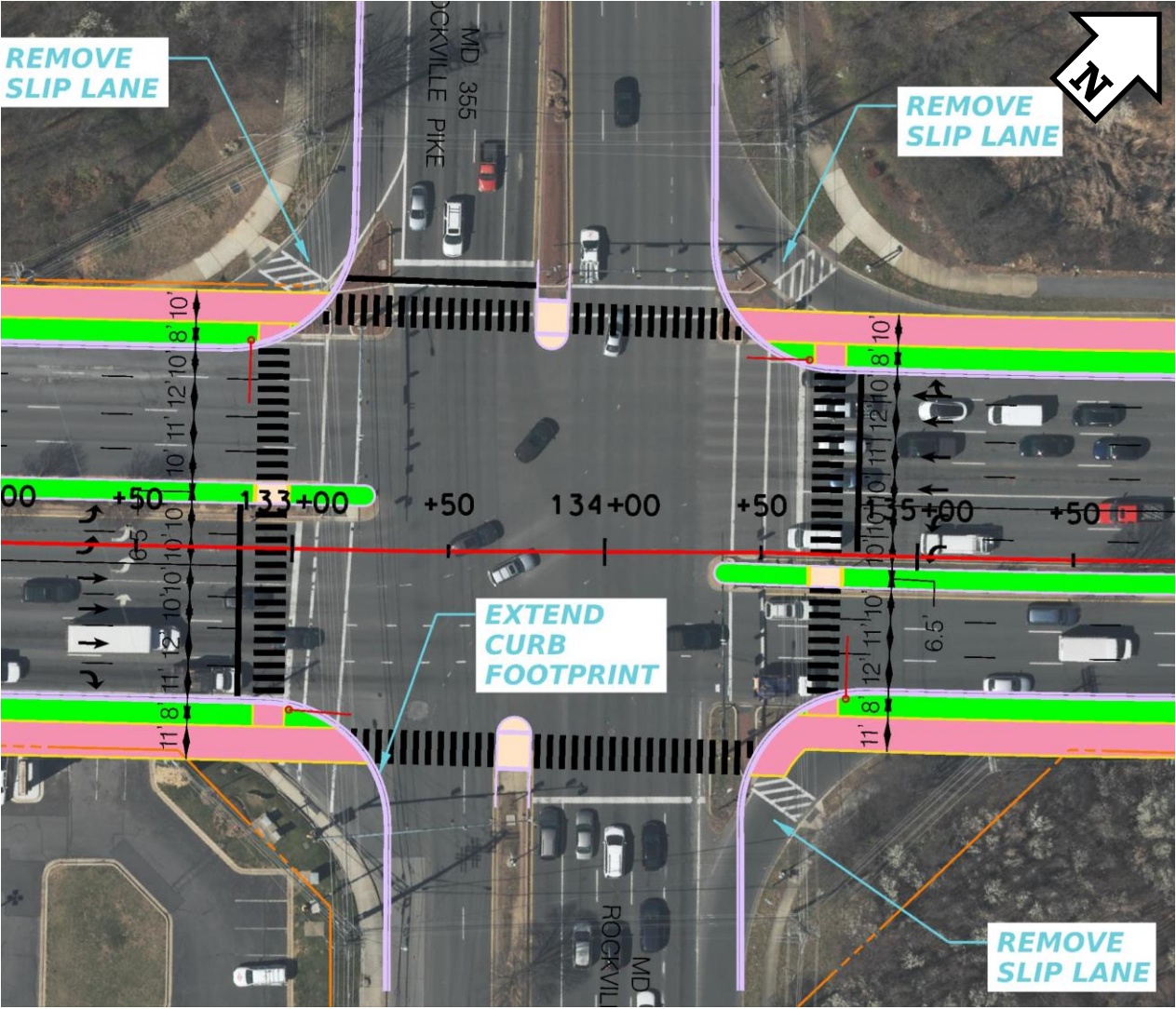

Section 3

Crabbs Branch Way to Midcounty Highway

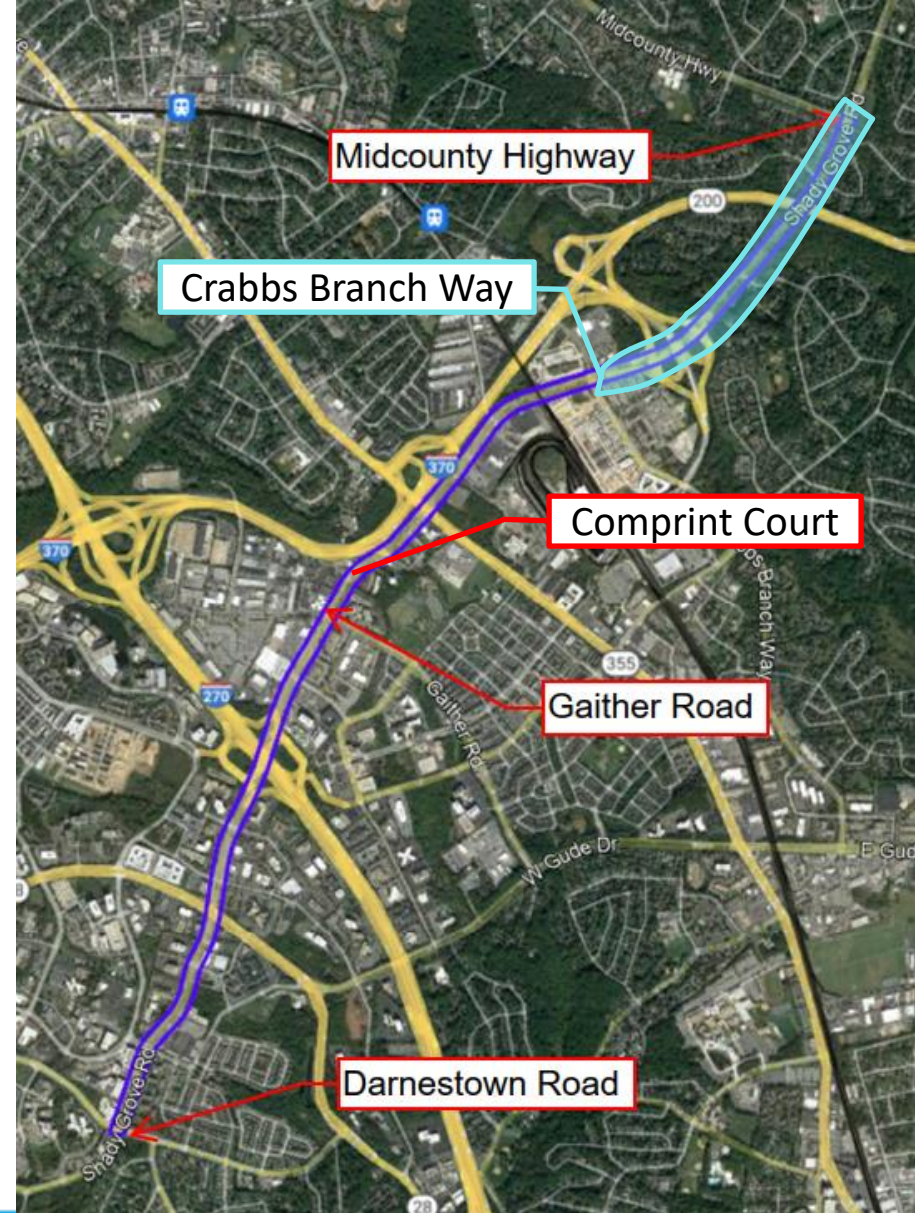

Crabbs Branch Way to Midcounty Highway

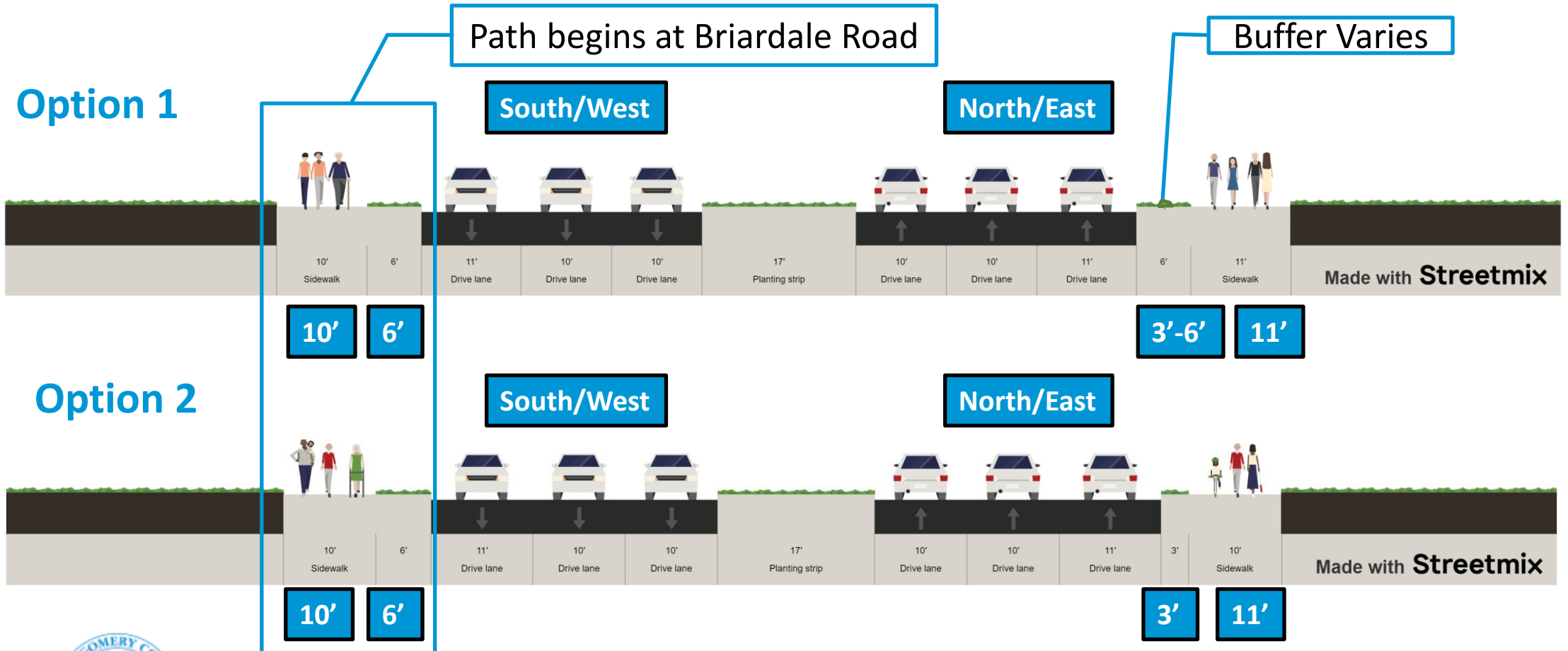

Crabbs Branch Way to Midcounty Highway – Option 1



Crabbs Branch Way to Midcounty Highway – Existing



5' Sidewalk

5' Bike Lane



Crabbs Branch Way to Midcounty Highway – Option 1



Shady Grove Road Metro Access - Existing

- North Side
 - No pedestrian facilities
- South side
 - Pedestrian crossings with large median refuge across signalized intersection
 - Slip ramp crossing with pedestrian warning signage

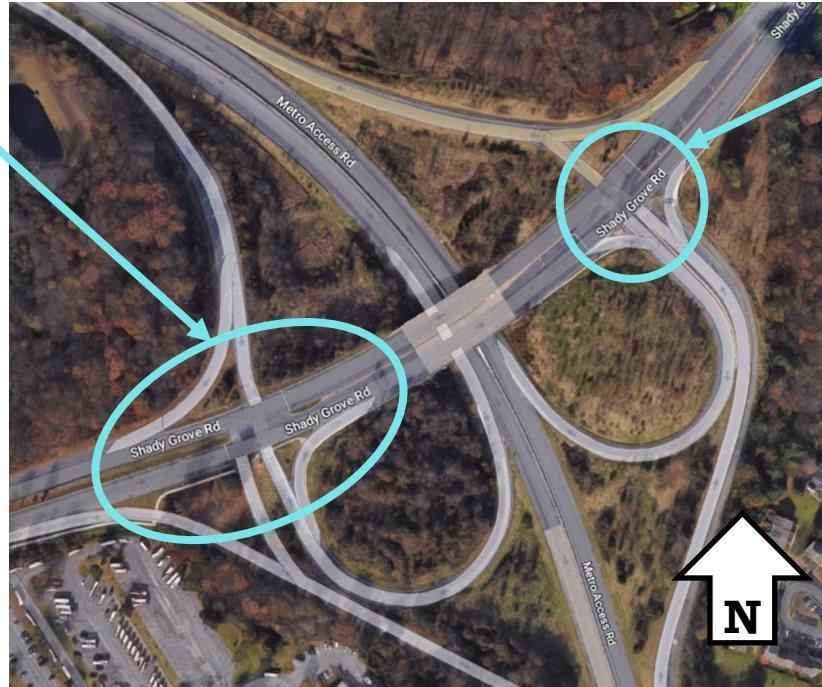

- North/west side
 - No pedestrian facilities
- South/east
 - Two slip ramp crossings with pedestrian warning signage
 - Pedestrian crossings across on/off ramp entrances at signalized intersection



Shady Grove Road Metro Access - Improvements

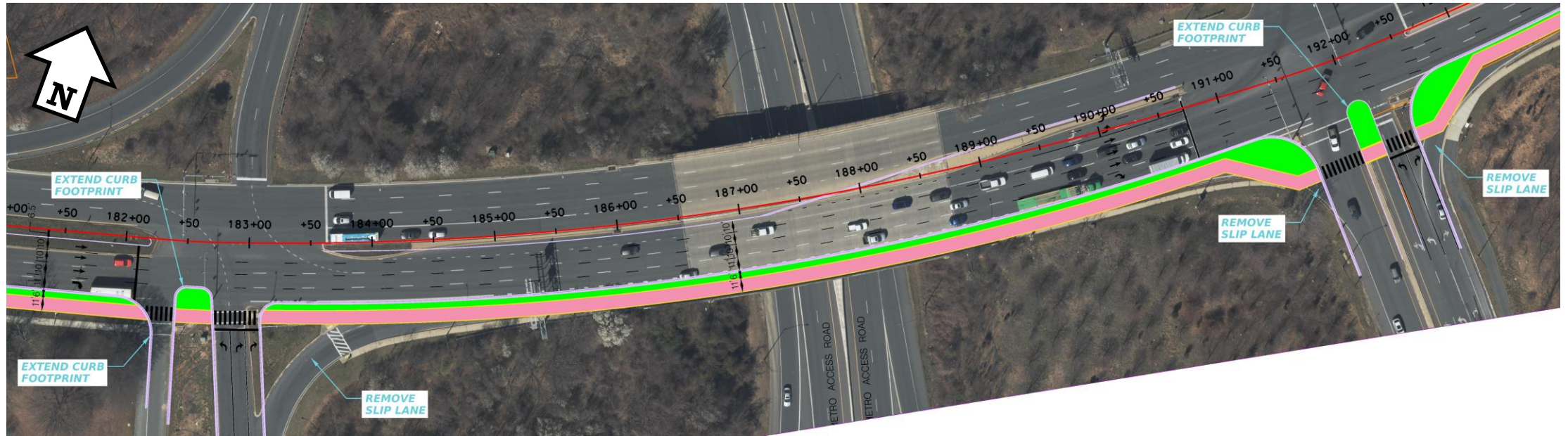

Shady Grove Road at Midcounty Highway

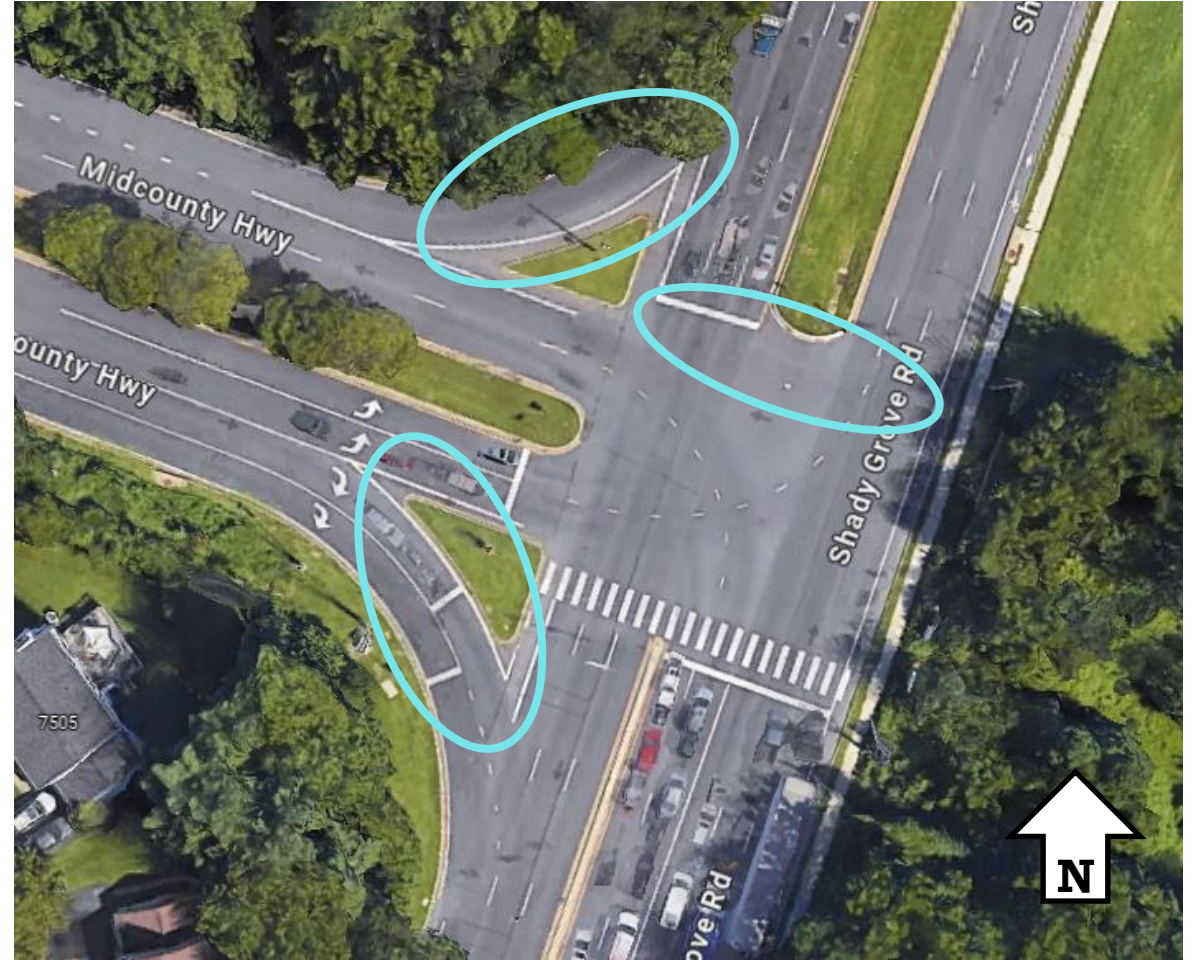

Shady Grove at Midcounty Highway - Improvements

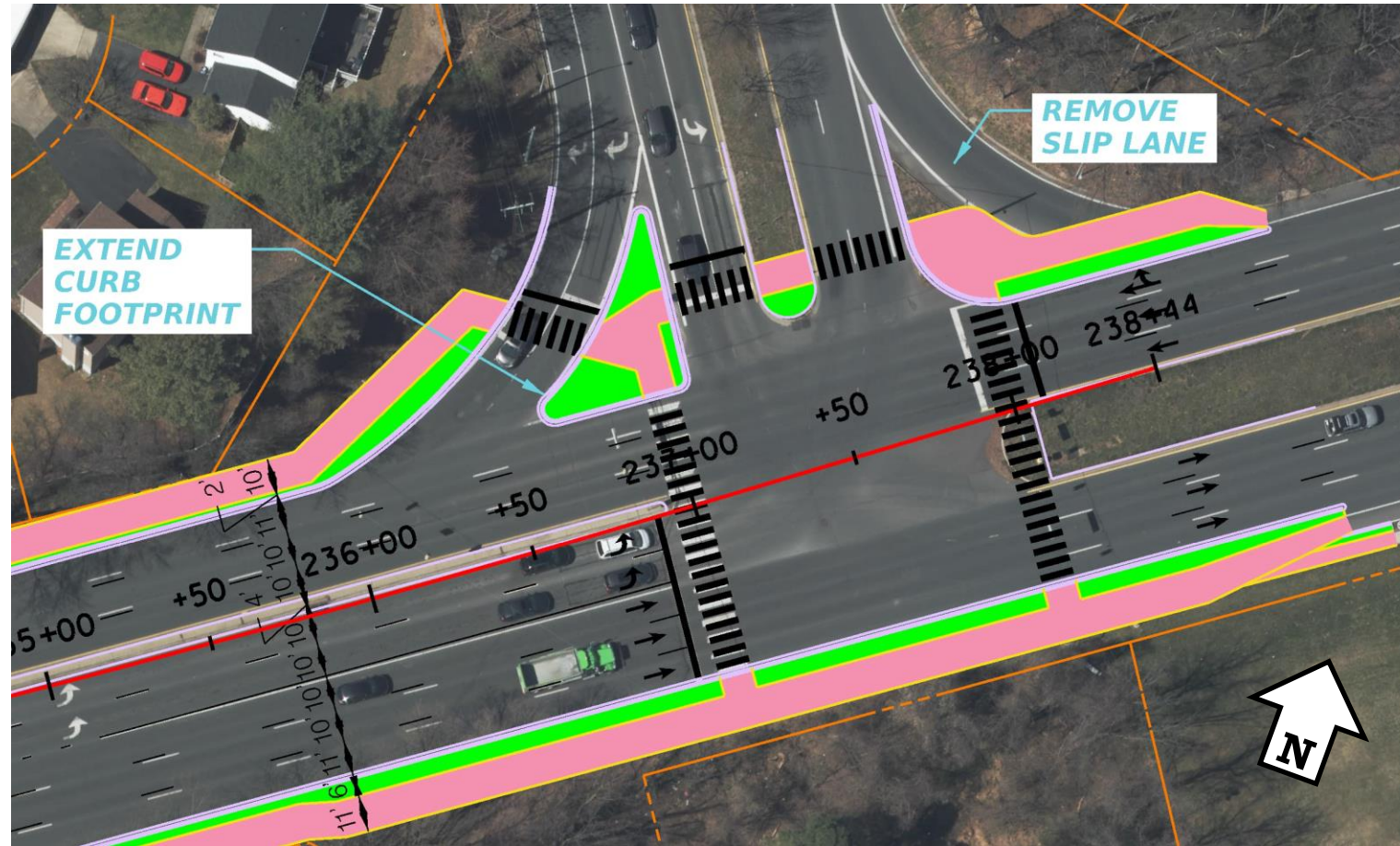

Thank You for Attending

- The Public Meeting Record will remain open for two weeks to allow any person an opportunity to have their comments included.
- Official Closing Date for Comments and Testimony is 07/23/2024
- Submissions can be made via:
 - Project Comment Form: [Project Comment Form](#)
 - Project Website: [Shady Grove Improvement Study](#)
 - E-mail ***Cameron.McAllister@MontgomeryCountyMD.gov***



Question and Answer

