

INDEX OF SHEETS		
SHEET NO.	TITLE	DPS FILE NO.
1	TITLE SHEET	
2	GEOMETRY PLAN SHEET	
3	TYPICAL SECTION	
4	ROADWAY PLAN - 1	
5	ROADWAY PLAN - 2	
6	SIGNAL PLAN	

MONTGOMERY COUNTY
DEPARTMENT OF TRANSPORTATION

NORWOOD ROAD
SHARED USE PATH

C. I. P. PROJECT NO. 502313

RELATED REQUIRED PERMITS					
IT IS THE RESPONSIBILITY OF PERMITTEE/OWNER OF THIS SITE TO OBTAIN ALL REQUIRED PERMITS PRIOR TO ISSUANCE OF THE APPROVED SEDIMENT CONTROL PERMIT					
TYPE OF PERMIT	REQD	NOT REQD	PERMIT #	EXPIRATION DATE	WORK RESTRICTION DATES
MCDPS Floodplain District		X			
WATERWAYS/WETLAND(S):					
a. Corps of Engineers	X				
b. MDE	X				
c. MDE Water Quality Certification		X			
MDE Dam Safety		X			
* DPS Roadside Trees Protection Plan	X		MCDOT BLANKET PERMIT NO. 361405	Approval Date	
N.P.D.E.S. NOTICE OF INTENT	X				DATE FILED
TOW LORR (Required Post Construction)		X			
OTHERS:					
DPS Erosion and Sediment Control	X		XXXXX		
MDCPPC Permit		X			
* A copy of the Roadside Trees Protection Plan must be delivered to the sediment control inspector at the preconstruction meeting.					
OWNER/PERMIT APPLICANT INFORMATION					
NAME: MONTGOMERY COUNTY DEPARTMENT OF TRANSPORTATION					
ADDRESS: 100 EDISON PARK DRIVE, 4TH FLOOR, GAITHERSBURG, MD 20878					
PHONE NUMBER: (240) 777-7263					
CONTACT PERSON: REBECCA PARK, P.E.					

DRAINAGE STATEMENT

I understand that DPS approval of this sediment control/stormwater management plan is for demonstrated compliance with required environmental runoff treatment standards. This DPS sediment control/stormwater management plan approval does not relieve me of professional responsibility. I have analyzed the proposed design for sediment control permit no. _____ and hereby certify that, based upon my background, training and experience, I have determined that the proposed improvements shown on this plan meet relevant laws and regulations. I further acknowledge that I have analyzed the post development drainage patterns for this project from the standpoint of my responsibilities under current Maryland Law and have determined that if permission is required from adjacent property owners, I have obtained it and have made copies of those permissions available to DPS.

Engineer's Signature _____ Date _____

Printed Name _____

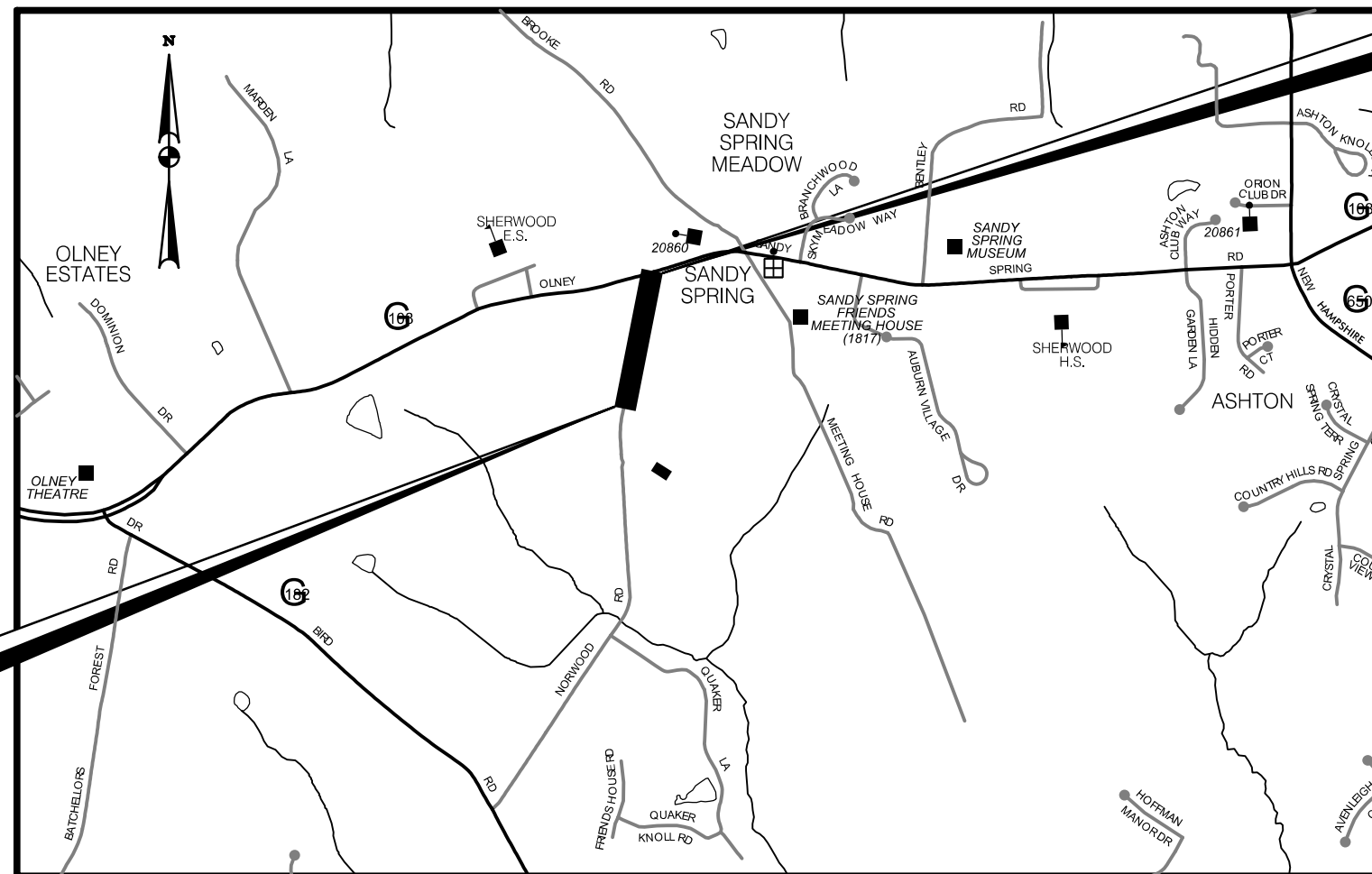

VICINITY MAP
MONTGOMERY COUNTY
LENGTH OF PROJECT
NORWOOD ROAD = 0.70 MILES
SCALE : 1" = 2000'

LIMIT OF WORK
CONTR. NO. 502313
SHARED USE PATH

LIMIT OF WORK
CONTR. NO. 502313
SHARED USE PATH

SEQUENCE OF CONSTRUCTION
I. SEE SHEET SC000X FOR SEQUENCE OF CONSTRUCTION.

GENERAL NOTES

- ALL CONSTRUCTION SHALL BE DONE IN ACCORDANCE WITH THE LATEST EDITION OF THE STANDARD SPECIFICATIONS OF THE MARYLAND STATE HIGHWAY ADMINISTRATION JULY 2022 AND MONTGOMERY COUNTY.
- INFORMATION CONCERNING UNDERGROUND UTILITIES WAS OBTAINED FROM AVAILABLE RECORDS, BUT THE CONTRACTOR MUST DETERMINE THE EXACT LOCATIONS AND ELEVATIONS OF THE LINES BY DIGGING TEST PITS BY HAND AT ALL UTILITY CROSSINGS, WELL IN ADVANCE OF TRENCHING. IF CLEARANCES ARE LESS THAN SHOWN OR SIX (6) INCHES, WHICHEVER IS LESS, CONTACT MONTGOMERY COUNTY DEPARTMENT OF TRANSPORTATION'S PROJECT INSPECTOR AND THE APPROPRIATE UTILITY OWNER BEFORE PROCEEDING WITH CONSTRUCTION.
- REPAIRS TO UTILITIES OR PROPERTY DAMAGE AS A RESULT OF THE CONTRACTOR'S NEGLIGENCE OR METHOD OF OPERATION MUST BE MADE AT THE CONTRACTOR'S EXPENSE BEFORE PROCEEDING WITH CONSTRUCTION.
- CALL "MISS UTILITY" AT 1-800-257-7777 FORTY-EIGHT (48) HOURS PRIOR TO BEGINNING EXCAVATION TO DETERMINE THE EXACT LOCATION OF EXISTING UTILITIES.
- CLEARING IS TO BE LIMITED TO THE "LIMIT OF GRADING" AS SHOWN ON THE PLANS.
- ALL GRADING SHALL BE DONE IN SUCH A MANNER AS TO PROVIDE POSITIVE DRAINAGE.
- ALL DISTURBED AREAS TO BE SEEDED AND MULCHED UNLESS OTHERWISE NOTED.
- THE CONTRACTOR SHALL OBTAIN A ROADSIDE TREE PERMIT FOR ANY MAINTENANCE, TREATMENT, PLANTING, REMOVAL, OR ROOT CUTTING ON TREES WITHIN THE PUBLIC RIGHT OF WAY. PERMIT REQUIREMENTS MAY BE OBTAINED FROM THE DEPARTMENT OF NATURAL RESOURCES, MARYLAND FOREST, PARK AND WILDLIFE SERVICE, TELEPHONE 301-854-6060.
- THE PERMITTEE SHALL REFER TO THE ATTACHED TEMPORARY TRAFFIC CONTROL PLAN (TTCP) DRAWINGS TO SELECT THE APPROPRIATE WORK ZONE TEMPORARY TRAFFIC CONTROLS FOR EACH PHASE OF CONSTRUCTION. WORK ZONE SITUATIONS WHICH ARE NOT ADDRESSED IN THE ATTACHED TTCP SHALL CONFORM TO THE GUIDELINES SET FORTH IN SECTION 6 OF THE MANUAL ON UNIFORM TRAFFIC CONTROL DEVICES FOR STREETS AND HIGHWAYS (MUTCD), MOST RECENT EDITION.
- FOR CONSTRUCTION, ALL HORIZONTAL AND VERTICAL CONTROLS SHALL BE NAD 83 (2007) AND NAVD 88 DATUM.

OWNER'S/DEVELOPER'S CERTIFICATION

I/We hereby certify that all clearing, grading, construction, and or development will be done pursuant to this plan and that any responsible personnel involved in the construction project will have a Certificate of Attendance at a Department of Natural Resources approved training program for the control of sediment and erosion before beginning the project.

DATE _____ MARICELA CORDOVA
CHIEF, DIVISION OF TRANSPORTATION ENGINEERING

DESIGN CERTIFICATION

I hereby certify that this plan has been prepared in accordance with the "2011 Maryland Standards and Specification for Soil Erosion and Sediment Control," Montgomery County Department of Permitting Services Executive Regulations 5-90, 7-02AM and 36-90, and Montgomery County Department of Public Works and Transportation "Storm Drain Design Criteria" dated August 1988.

DATE _____ MICHAEL MERCADO, P.E.
MERCADO CONSULTANTS, INC.

CERTIFICATION OF THE QUANTITIES

I hereby certify that the estimated total yards of excavation and fill as shown on this plan has been computed to 0 cubic yards of excavation, 0 cubic yards of fill and the total area to be disturbed as shown on these plans has been determined to be XX,XXX square feet.

SIGNATURE _____ DATE _____
MICHAEL MERCADO, P.E. 38931
PRINTED NAME AND TITLE REGISTRATION NUMBER

30% DESIGN SUBMISSION 4-14-2023

TECHNICAL REVIEW OF SEDIMENT CONTROL	ADMINISTRATIVE REVIEW	DPS APPROVAL OF A SEDIMENT CONTROL OR STORMWATER MANAGEMENT PLAN IS FOR DEMONSTRATED COMPLIANCE WITH MINIMUM ENVIRONMENTAL RUNOFF TREATMENT STANDARDS AND DOES NOT CREATE OR IMPLY ANY RIGHT TO DIVERT OR CONCENTRATE RUNOFF ONTO ANY ADJACENT PROPERTY WITHOUT THAT PROPERTY OWNER'S PERMISSION. IT DOES NOT RELIEVE THE DESIGN ENGINEER OR OTHER RESPONSIBLE PERSON OF PROFESSIONAL LIABILITY OR ETHICAL RESPONSIBILITY FOR THE ADEQUACY OF THE DRAINAGE DESIGN AS IT AFFECTS UPHILL OR DOWNHILL PROPERTIES.
REVIEWED _____ DATE _____	REVIEWED _____ DATE _____	
TECHNICAL REVIEW OF STORMWATER MANAGEMENT	SMALL LOT DRAINAGE APPROVAL	XXXXXX SM. FILE NO. STORMWATER MANAGEMENT
REVIEWED _____ DATE _____	REVIEWED _____ DATE _____	
MCDPS APPROVAL OF THIS PLAN WILL EXPIRE TWO YEARS FROM THE DATE OF APPROVAL IF THE PROJECT HAS NOT STARTED.	NOTE: MCDPS APPROVAL DOES NOT NEGATE THE NEED FOR A MCDPS ACCESS PERMIT.	

MONTGOMERY COUNTY DEPARTMENT OF TRANSPORTATION
DIVISION OF TRANSPORTATION ENGINEERING
GAITHERSBURG, MARYLAND

RECOMMENDED FOR APPROVAL

Chief, Design Section _____ Date _____
APPROVED

Chief, Division of Transportation Engineering _____ Date _____

Designed by : MMW Drawn by : NL Checked by : MMW

NORWOOD ROAD
SHARED USE PATH

TITLE SHEET

SCALE : AS SHOWN DATE : APRIL, 2023

Project No. : 502313 SHEET 1 of 6

TREE CANOPY REQUIREMENTS TABLE	
To be completed by the consultant and placed on the first sheet of the Sediment Control / Stormwater Management plan set for all projects.	
Exempt: Yes <input type="checkbox"/> No <input checked="" type="checkbox"/> If exempt under Section 55-5 of the Code, please check the applicable exemption category below.	
Total Property Area	Total Disturbed Area
xxx square feet	xxx square feet
Shade Trees Required	Shade Trees Proposed to be Planted
xx	0
Fee in Lieu (Trees Required - Trees Planted) x \$250	\$ x,xxx
Required Number of Shade Trees	
Area (sq. ft.) of the Limits of Disturbance	Number of Shade Trees Required
FROM TO	
1 6,000	3
6,001 8,000	6
8,001 12,000	9
12,001 14,000	12
14,001 40,000	15
If the square footage of the limits of disturbance is more than 40,000, then the number of shade trees required must be calculated using the following formula:	
(Number of Square Feet in Limits of Disturbance ÷ 40,000) × 15	
EXEMPTION CATEGORIES:	
<input type="checkbox"/> 55-5(a) any activity that is subject to Article II of Chapter 22A; <input type="checkbox"/> 55-5(b) any commercial logging or timber harvesting operation with an approved exemption from Article II of Chapter 22A; <input type="checkbox"/> 55-5(f) any activity conducted by the County Parks Department; <input type="checkbox"/> 55-5(g) routine or emergency maintenance of an existing stormwater management facility, including an existing access road, if the person performing the	<input type="checkbox"/> maintenance has obtained all required permits; <input type="checkbox"/> 55-5(h) any stream restoration project if the person performing the work has obtained all necessary permits; <input type="checkbox"/> 55-5(i) cutting or clearing any tree to comply with applicable provisions of any federal, state, or local law governing safety of dams; <input type="checkbox"/> OTHER: Specify per Section 55-5 of the Code.



NO.	REVISION	DATE	BY

PROFESSIONAL CERTIFICATION:

I HEREBY CERTIFY THAT THESE DOCUMENTS WERE PREPARED OR APPROVED BY ME, AND THAT I AM A DULY LICENSED PROFESSIONAL ENGINEER UNDER THE LAWS OF THE STATE OF MARYLAND.

LICENSE NO: 38931 EXPIRATION DATE: 12-22-2023

4/14/2023 P:\Projects\1908\1908_04_Sandy_Spring_Bikeway\05_Roadway\CADD\p05-P01_Norwood.dgn

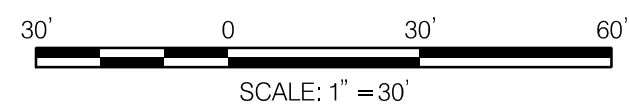

CURVE DATA						
CURVE	DELTA	Dc	RADIUS	TANGENT	LENGTH	EXTERNAL
C-1	90° 01' 21.95" RT	583° 19' 49.87"	9.8222	9.8261	15.4325	4.0712
C-2	26° 08' 15.55" RT	51° 56' 05.65"	110.3223	25.6095	50.3277	2.9334
C-3	13° 59' 54.86" LT	9° 26' 41.55"	606.6335	74.4776	148.2134	4.5548

CURVE	POINT NO.	STATION	NORTH	EAST	BEARING
		BASELINE OF CONSTRUCTION SANDY SPRING BIKE PATH			
C-1	POB	10+00.00	539861.1175	1303964.4603	
	PC	10+36.67	539870.7648	1303999.8351	N 74° 44' 43.77" E
	PI	10+46.49	539873.3501	1304009.3150	S 15° 13' 54.28" E
C-2	PCC	10+52.10	539863.8692	1304011.8966	
	PI	10+77.71	539839.1628	1304018.6727	S 15° 20' 13.99" E
	PT	11+02.43	539814.0069	1304013.8738	
	PT	12+76.42	539643.0920	1303981.2687	S 10° 48' 01.56" W
	PT	13+64.34	539556.9039	1303963.9333	S 11° 22' 20.59" W
	PT	14+73.94	539449.5058	1303942.0787	S 11° 30' 07.80" W
	PT	15+89.16	539336.4799	1303919.6925	S 11° 12' 11.32" W
	PT	16+53.67	539273.2373	1303906.9639	S 11° 22' 46.87" W
	PT	17+04.27	539223.7244	1303896.5287	S 11° 54' 04.64" W
	PT	17+62.21	539166.9015	1303885.1889	S 11° 17' 09.47" W
	PT	19+39.50	538993.3075	1303849.2153	S 11° 42' 27.35" W
	PT	19+78.93	538954.7470	1303840.9541	S 12° 05' 31.90" W
	PT	20+29.06	538905.6888	1303830.6705	S 11° 50' 20.19" W
C-3	PC	20+81.71	538854.0892	1303820.1889	
	PI	21+56.19	538781.8374	1303804.0561	S 12° 34' 37.24" W
	PT	22+29.92	538707.3828	1303805.9038	S 1° 25' 17.62" E
	PT	23+07.45	538629.5936	1303799.0041	S 5° 05' 32.61" W
POE	23+83.03	538554.3285	1303796.3187	S 2° 02' 55.60" W	

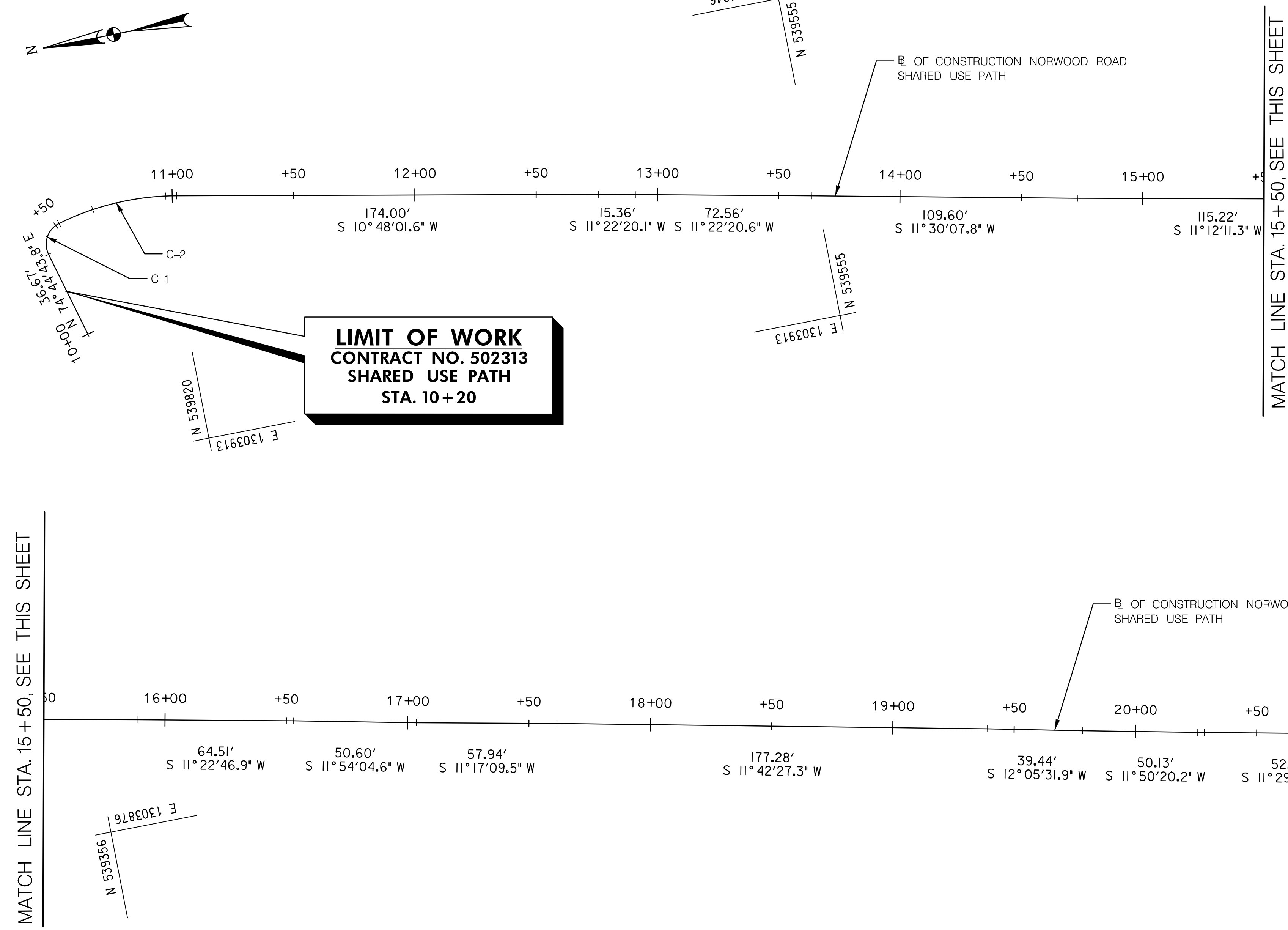

MONTGOMERY COUNTY DEPARTMENT OF TRANSPORTATION
DIVISION OF TRANSPORTATION ENGINEERING
ASHTON, MARYLAND

RECOMMENDED FOR APPROVAL

Chief, Design Section _____ Date _____
APPROVED

Chief, Division of Transportation Engineering _____ Date _____

Designed by: _____ EL _____ Drawn by: _____ EL _____ Checked by: _____ MM _____

GS-01

**NORWOOD ROAD
SHARED USE PATH**

GEOMETRY SHEET

SCALE : 1" = 30' DATE : APRIL, 2023

Project No. : 502313 SHEET 2 of 6

NO.	REVISION	DATE	BY

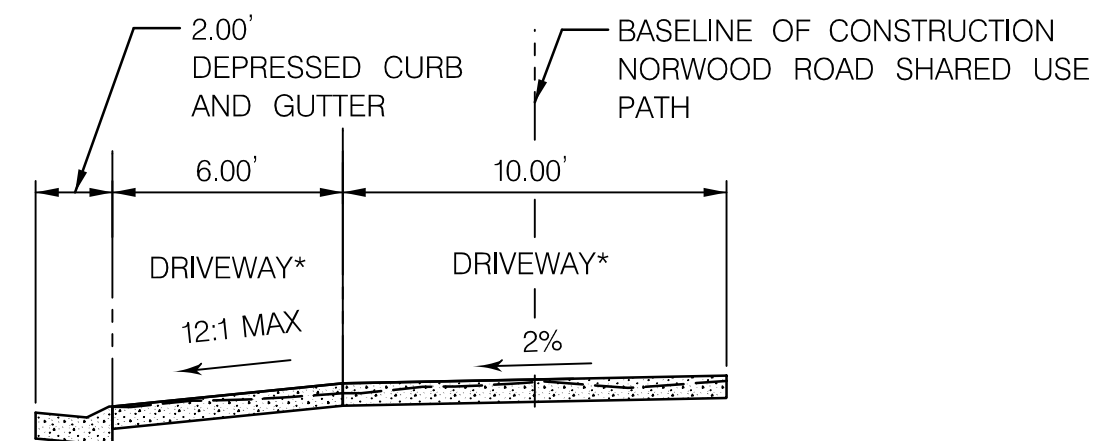
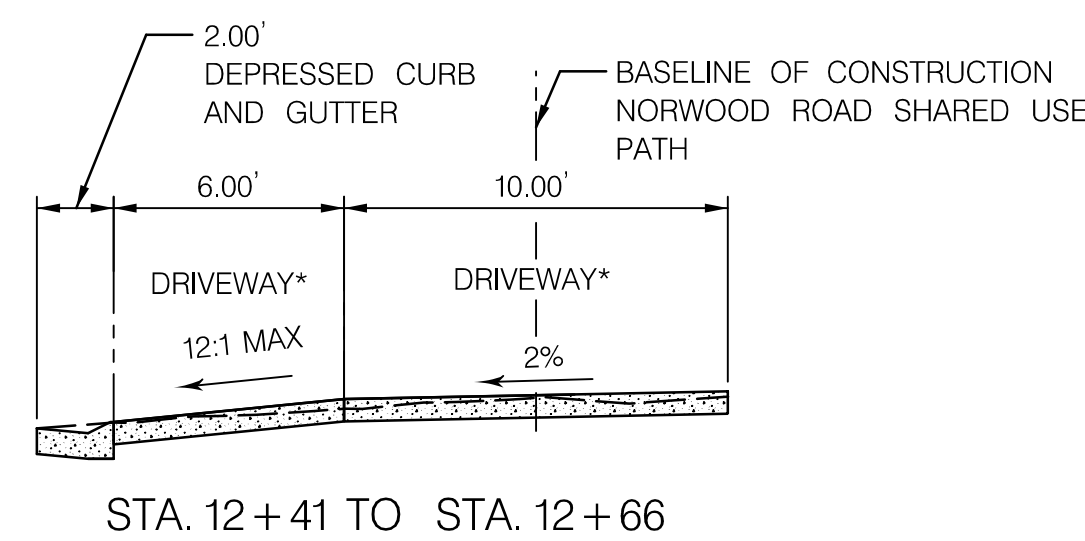
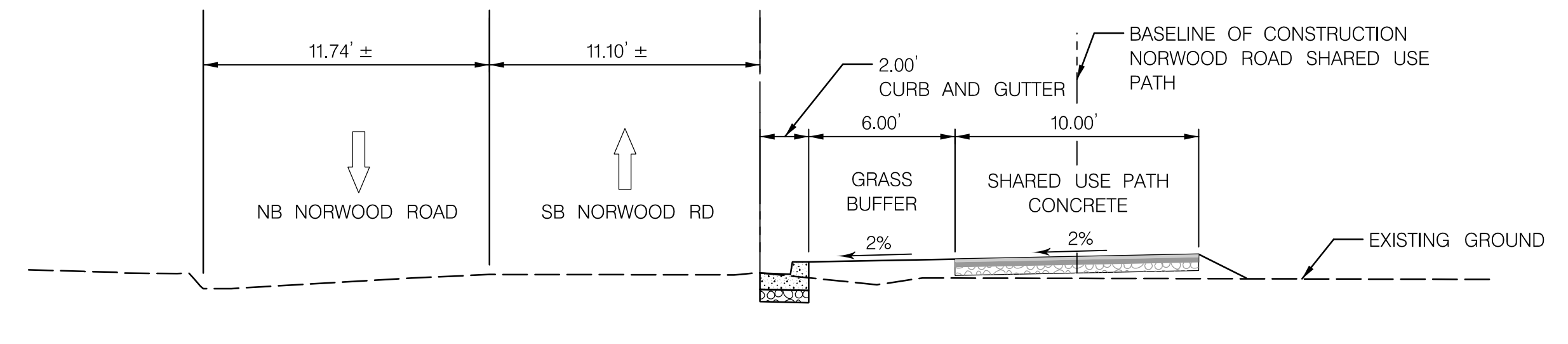
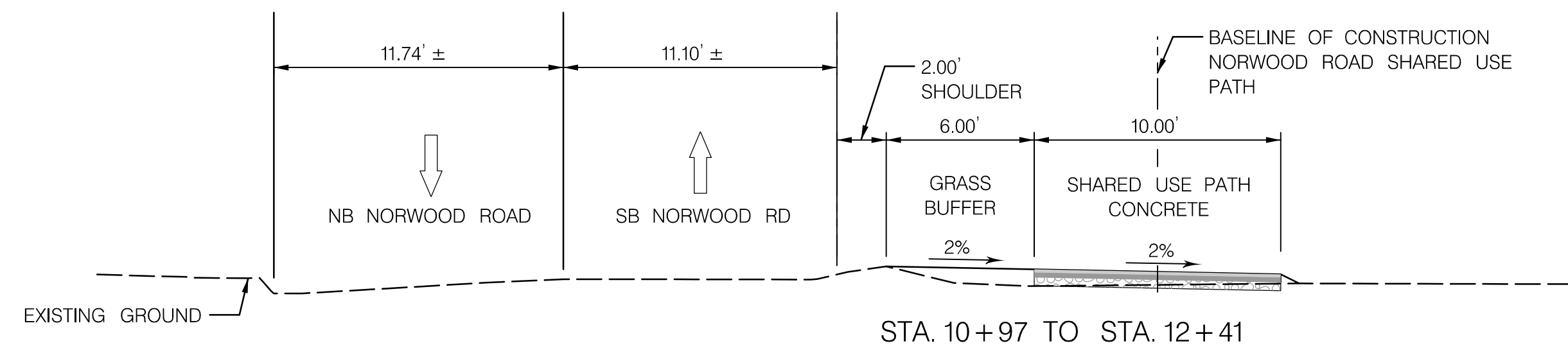
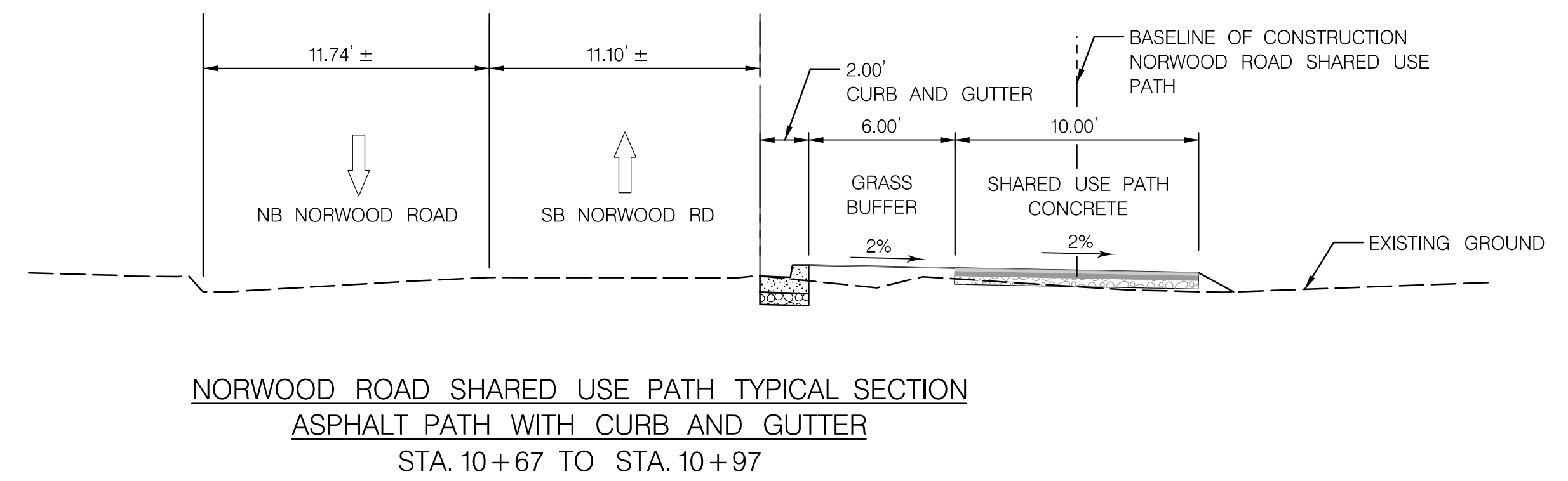
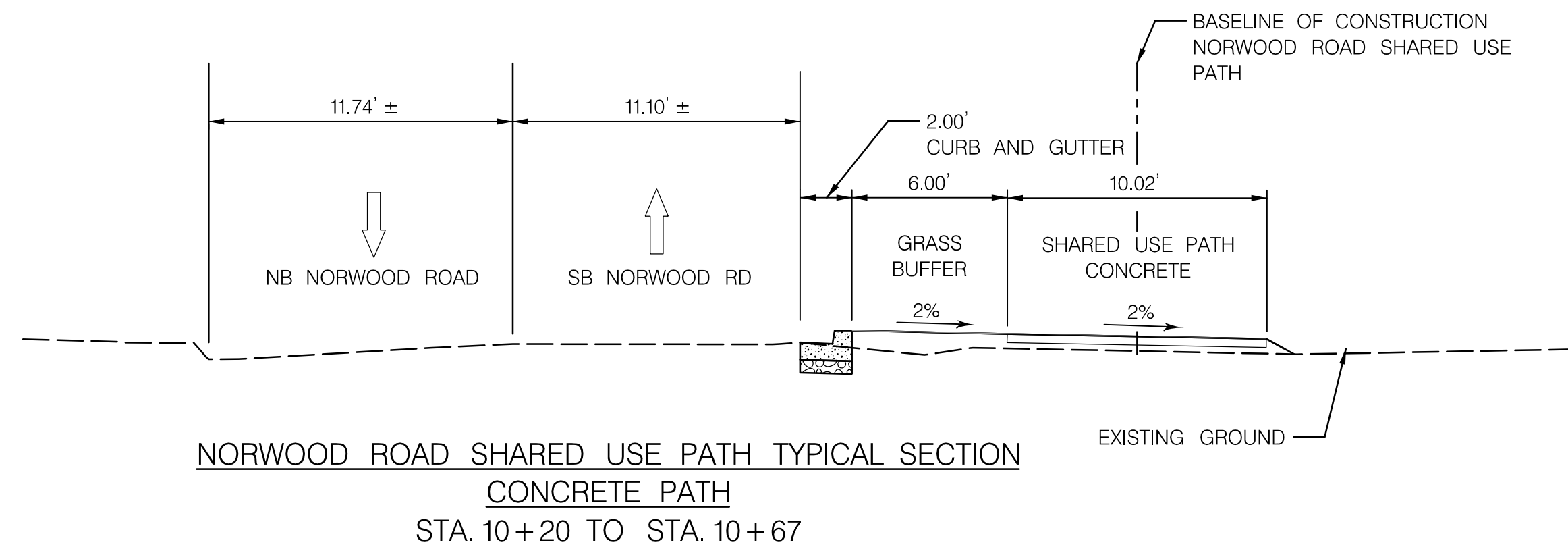

- STA. 12+41 TO STA. 12+66
- STA. 13+28 TO STA. 13+51
- STA. 13+93 TO STA. 14+03
- STA. 14+58 TO STA. 14+68
- STA. 15+62 TO STA. 15+82
- STA. 16+30 TO STA. 16+51
- STA. 17+39 TO STA. 17+54
- STA. 18+91 TO STA. 19+19
- STA. 19+72 TO STA. 19+90

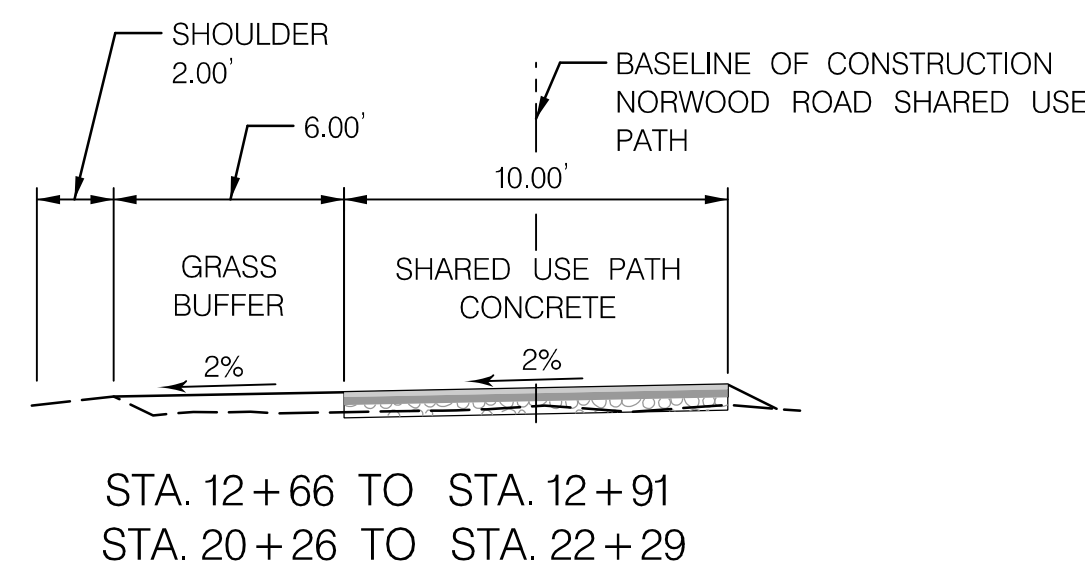
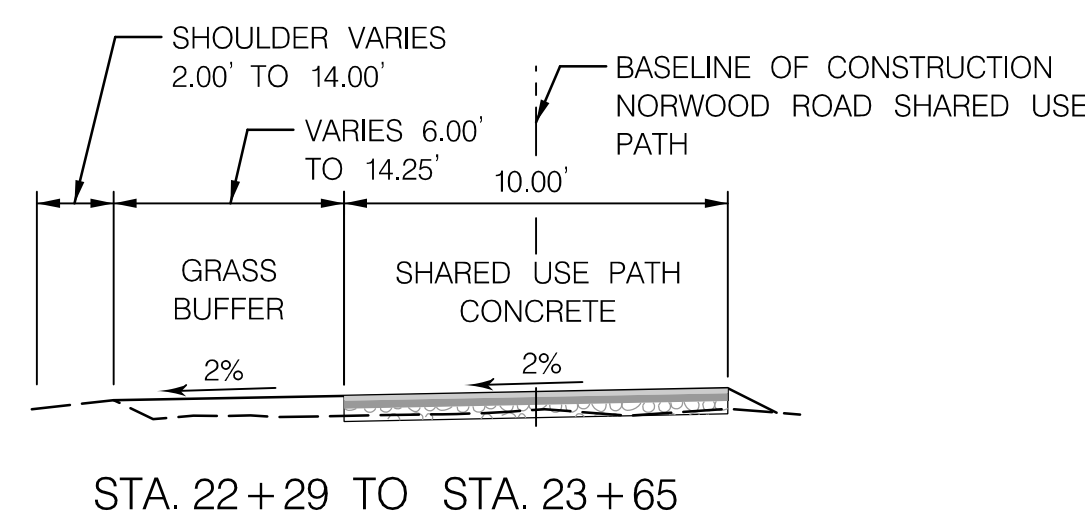

NORWOOD ROAD SHARED USE PATH TYPICAL SECTION
ASPHALT PATH
STA. 10+97 TO STA. 12+91
STA. 20+26 TO STA. 23+65

NORWOOD ROAD SHARED USE PATH TYPICAL SECTION
ASPHALT PATH WITH CURB AND GUTTER
STA. 12+91 TO STA. 20+26

PAVEMENT LEGEND

- ① 1.5" BITUMINOUS CONCRETE SURFACE COURSE (ASPHALT)
- ② 2.5" BITUMINOUS CONCRETE BASE COURSE (ASPHALT)
- ③ 4" GRADED AGGREGATE BASE
- ④ 4" CONCRETE FOR SIDEWALK
- ⑤ 7" CONCRETE FOR DRIVEWAY

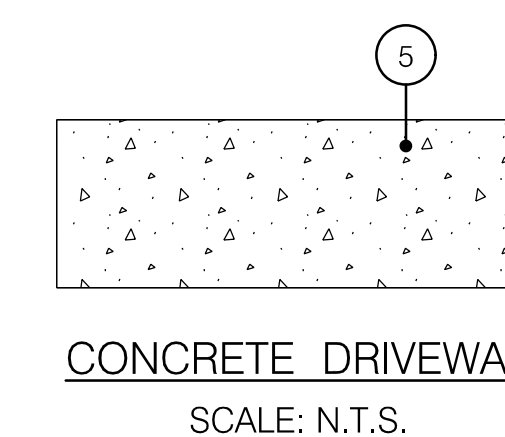
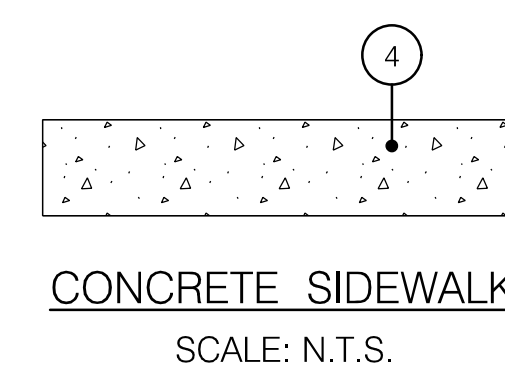
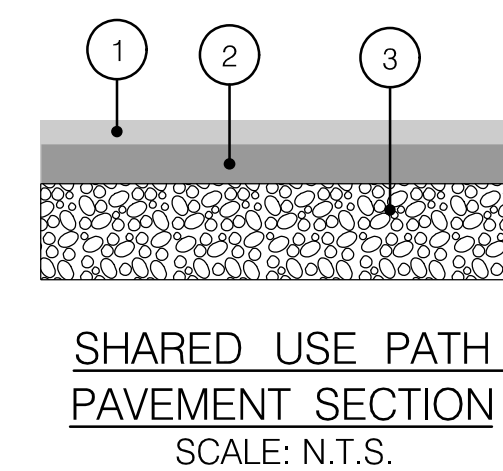

*SEE ROADWAY PLANS DRIVEWAY FOOTPRINT

NO.	REVISION	DATE	BY

MONTGOMERY COUNTY DEPARTMENT OF TRANSPORTATION DIVISION OF TRANSPORTATION ENGINEERING ASHTON, MARYLAND	
RECOMMENDED FOR APPROVAL	
Chief, Design Section	Date
APPROVED	
Chief, Division of Transportation Engineering	Date
Designed by: EL	Drawn by: RA
Checked by: MM	

NORWOOD ROAD SHARED USE PATH
TYPICAL SECTION

SCALE : 1" = 5' DATE : APRIL, 2023
Project No. : 502313 SHEET 3 of 6

TS-01

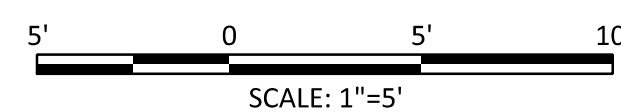

4/14/2023
 P:\Projects\1908\1908_04_Sandy_Spring_Bikeway\05_Roadway\CADD\p1d-P01_Norwood.dgn

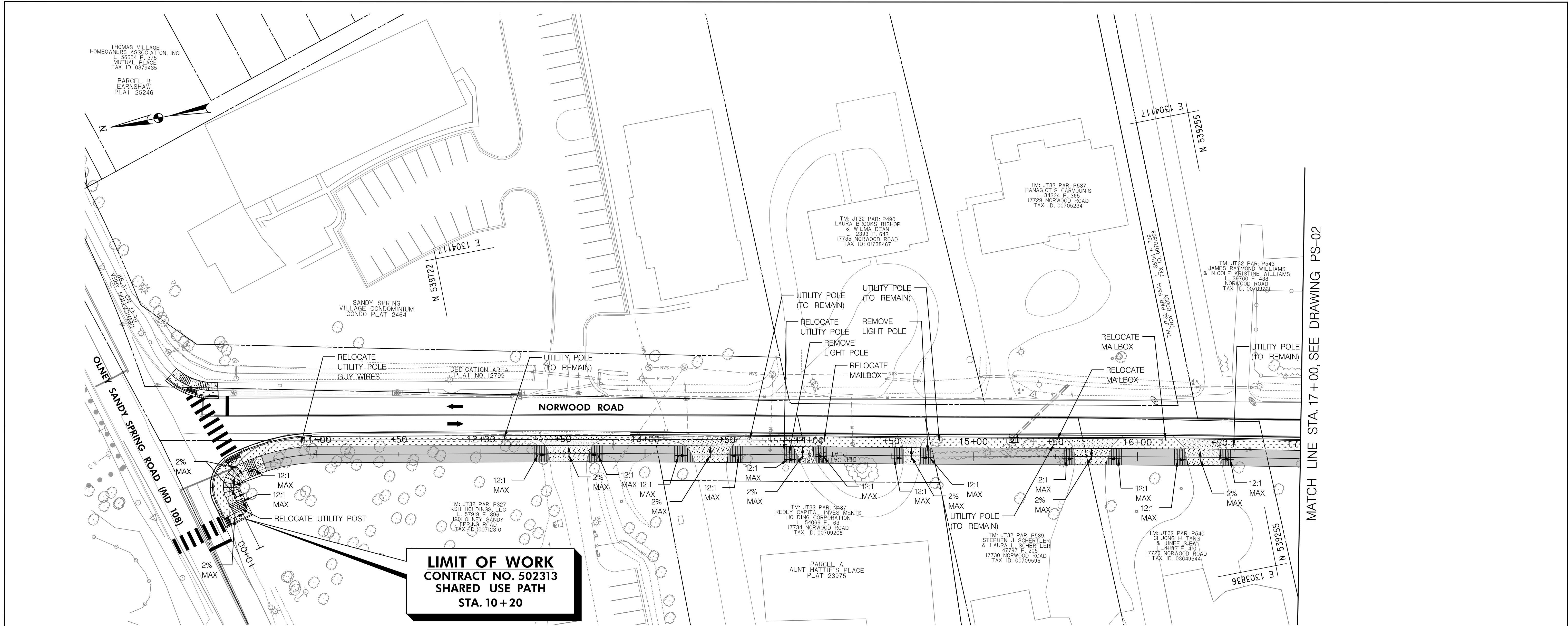

LIMIT OF WORK
CONTRACT NO. 502313
SHARED USE PATH
STA. 10+20

SHARED USE PATH PLAN
 SCALE: 1" = 30'

MATCH LINE STA. 17+00, SEE DRAWING PS-02

LEGEND	
	CONCRETE DRIVEWAY
	ASPHALT SHARED USE PATH
	GRASS BUFFER
	FILL LINE
	CUT LINE
	EX. RIGHT OF WAY
	WATER LINE
	ELECTRIC LINE
	SANITARY SEWER LINE
	GAS LINE

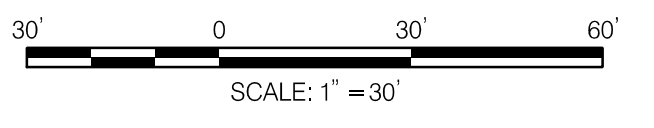

PS-01

MONTGOMERY COUNTY DEPARTMENT OF TRANSPORTATION
 DIVISION OF TRANSPORTATION ENGINEERING
 ASHTON, MARYLAND

RECOMMENDED FOR APPROVAL			
Chief, Design Section	_____	Date	_____
APPROVED			
Chief, Division of Transportation Engineering	_____	Date	_____
Designed by : EL	Drawn by : RA	Checked by : MM	

NORWOOD ROAD
SHARED USE PATH

SHARED USE PATH PLAN

SCALE : 1" = 30' DATE : APRIL, 2023

Project No. : 502313 SHEET 4 of 6

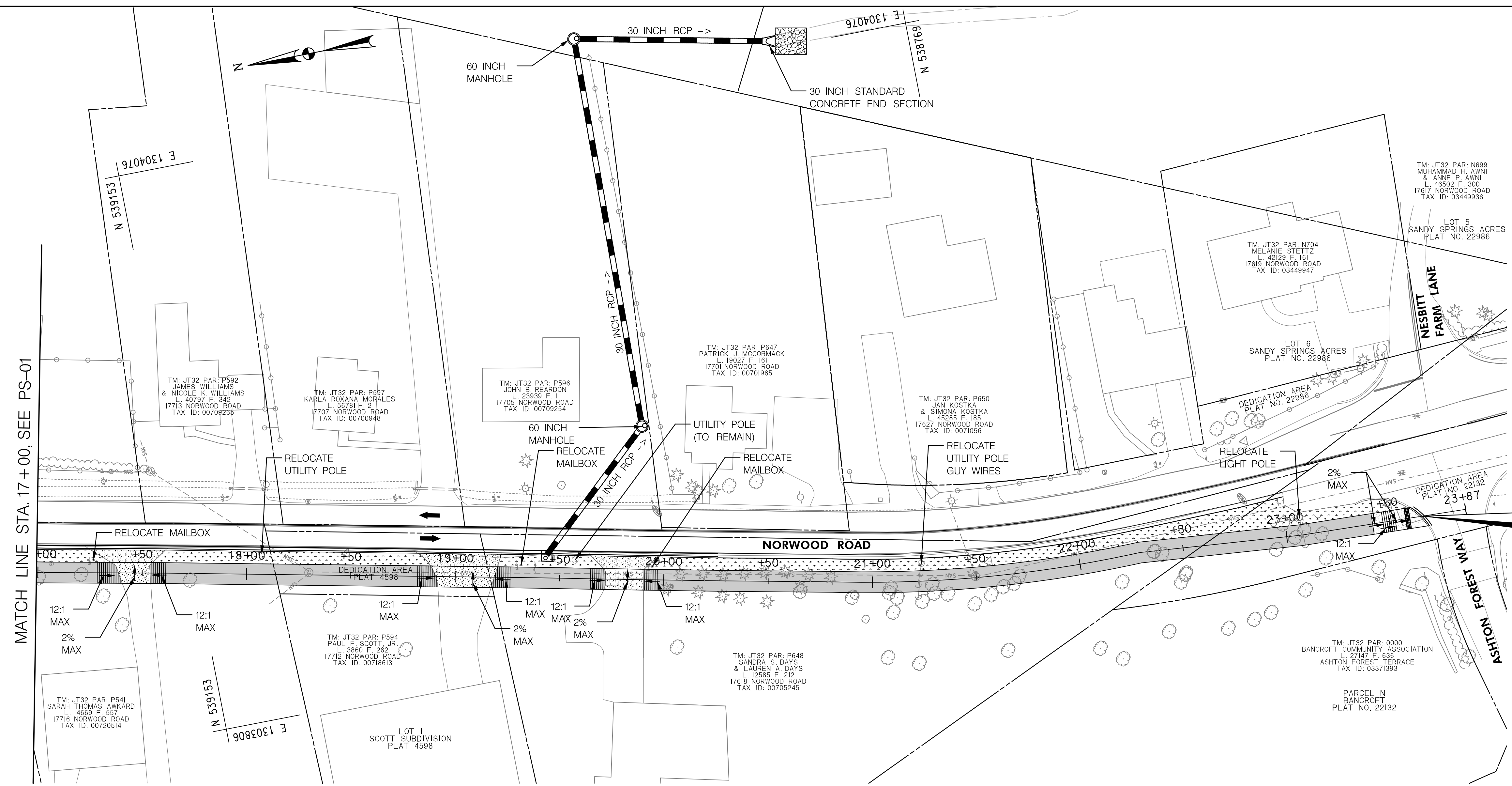

LIMIT OF WORK
CONTRACT NO. 502313
SHARED USE PATH
STA. 23+69

SHARED USE PATH PLAN
 SCALE: 1" = 30'

- LEGEND**
- CONCRETE DRIVEWAY
 - ASPHALT SHARED USE PATH
 - GRASS BUFFER
 - CLASS III RIPRAP
 - FILL LINE
 - CUT LINE
 - EX. RIGHT OF WAY
 - WATER LINE
 - ELECTRIC LINE
 - SANITARY SEWER LINE
 - GAS LINE

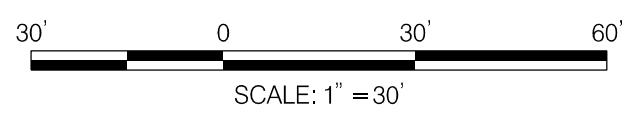

4/14/2023 P:\Projects\1908\1908_04_Sandy_Spring_Bikeway\05_Roadway\CADD\p10-P002-Norwood.dgn

PS-02

MONTGOMERY COUNTY DEPARTMENT OF TRANSPORTATION
 DIVISION OF TRANSPORTATION ENGINEERING
 ASHTON, MARYLAND

NO.	REVISION	DATE	BY

NORWOOD ROAD SHARED USE PATH

SHARED USE PATH PLAN

SCALE : 1" = 30' DATE : APRIL, 2023

Project No. : 502313 SHEET 5 of 6

RECOMMENDED FOR APPROVAL

Chief, Design Section _____ Date _____

APPROVED

Chief, Division of Transportation Engineering _____ Date _____

Designed by : EL Drawn by : RA Checked by : MM

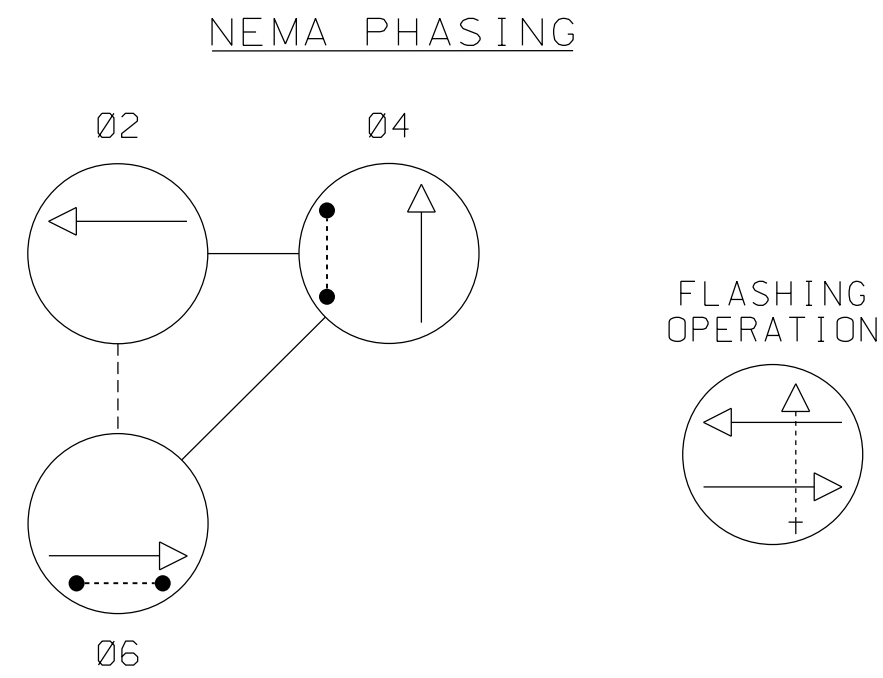
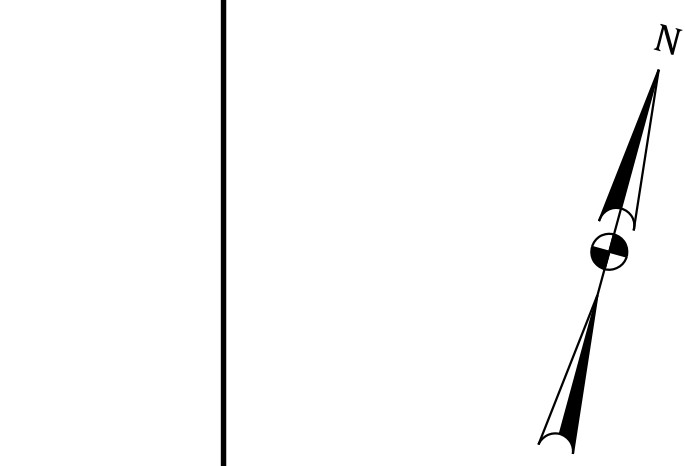

NOTE: PHASES ASSOCIATED BY A DASHED LINE WILL OPERATE CONCURRENTLY. PHASES ASSOCIATED BY A SOLID LINE WILL NOT OPERATE CONCURRENTLY.

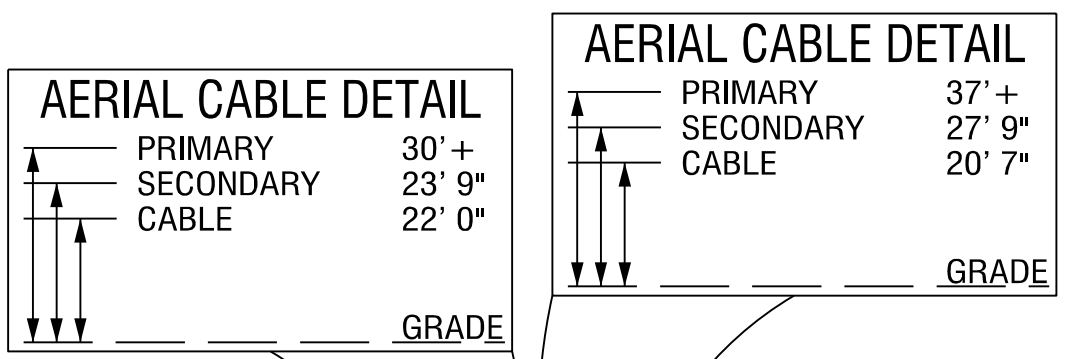
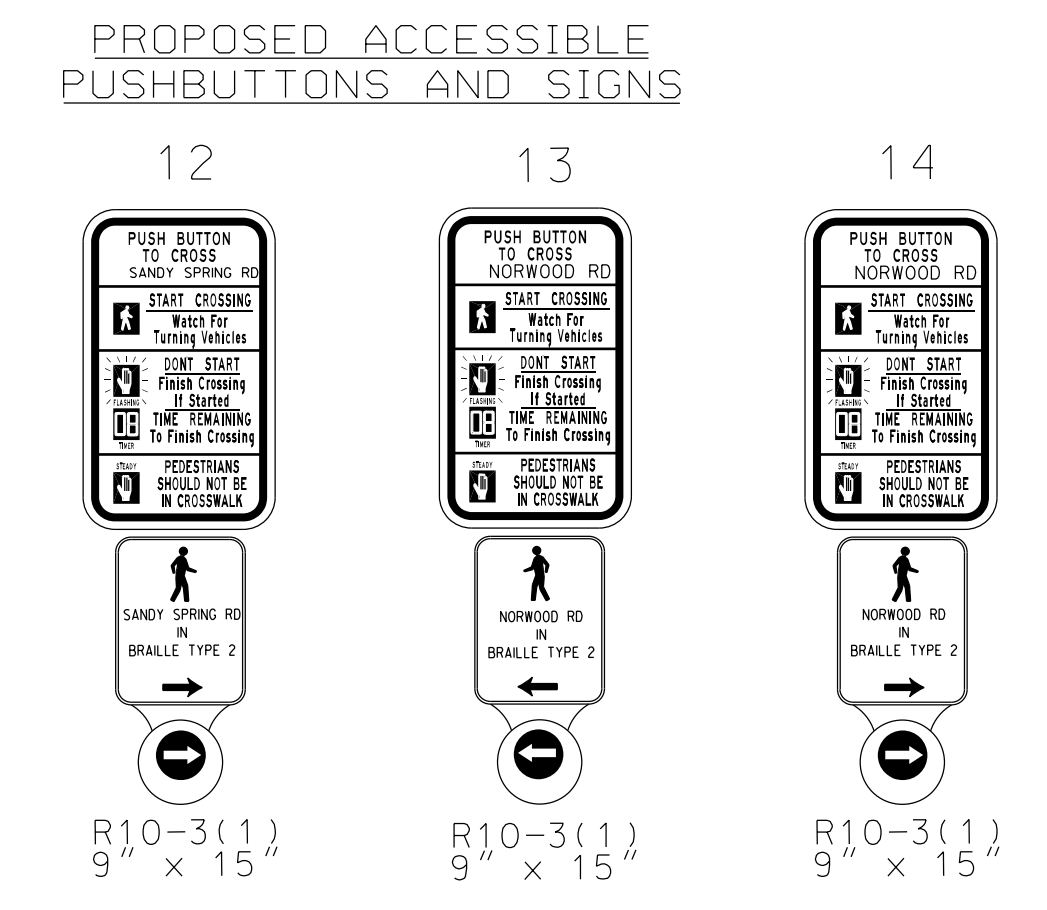
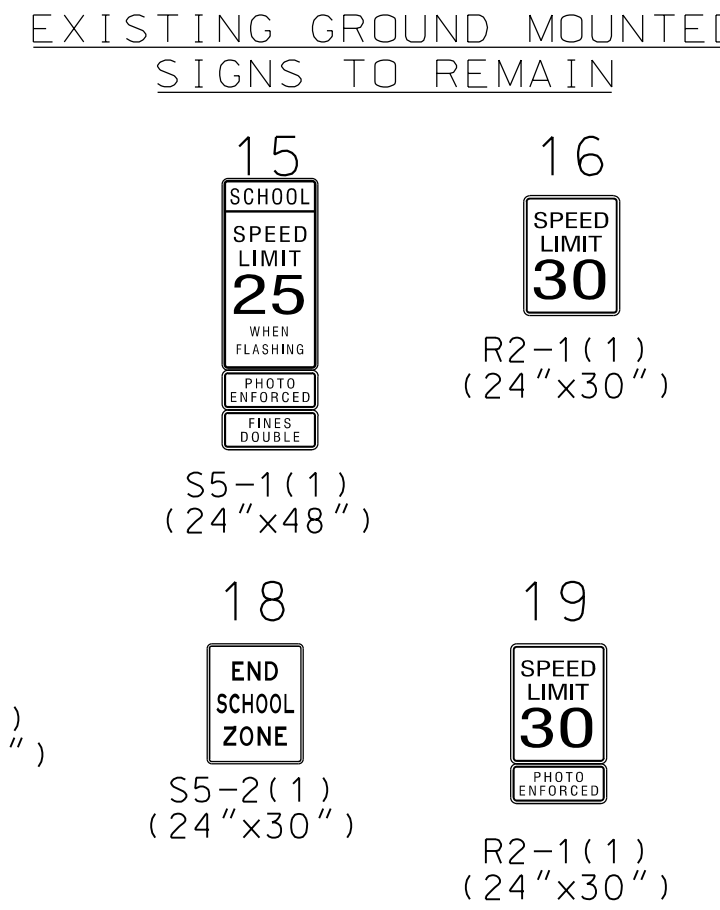
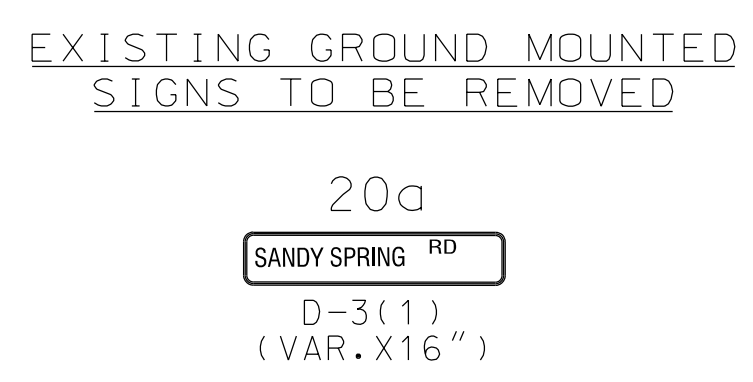
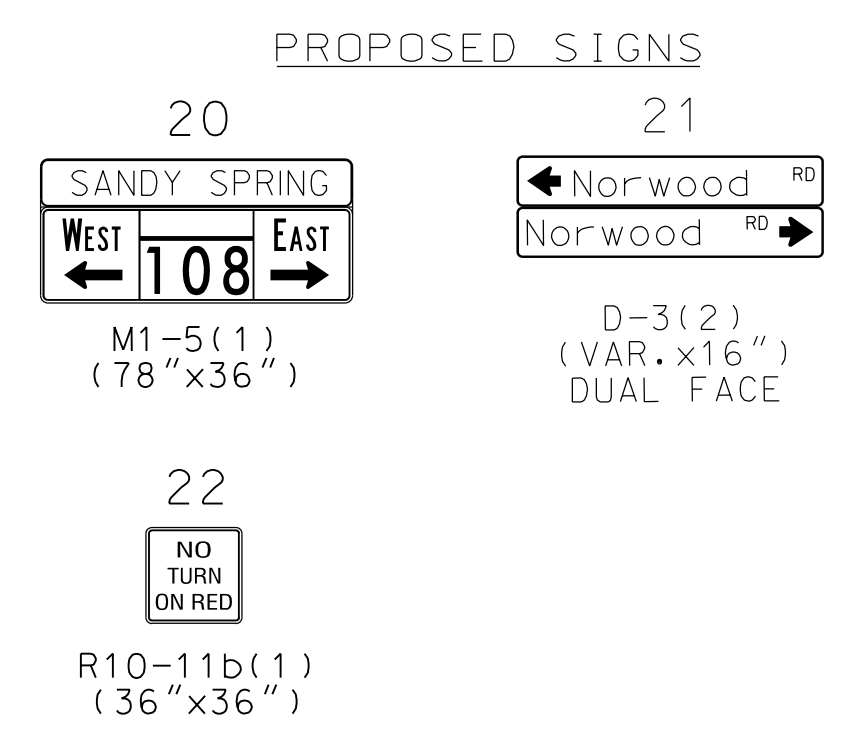

PROPOSED VIDEO DETECTION CAMERAS

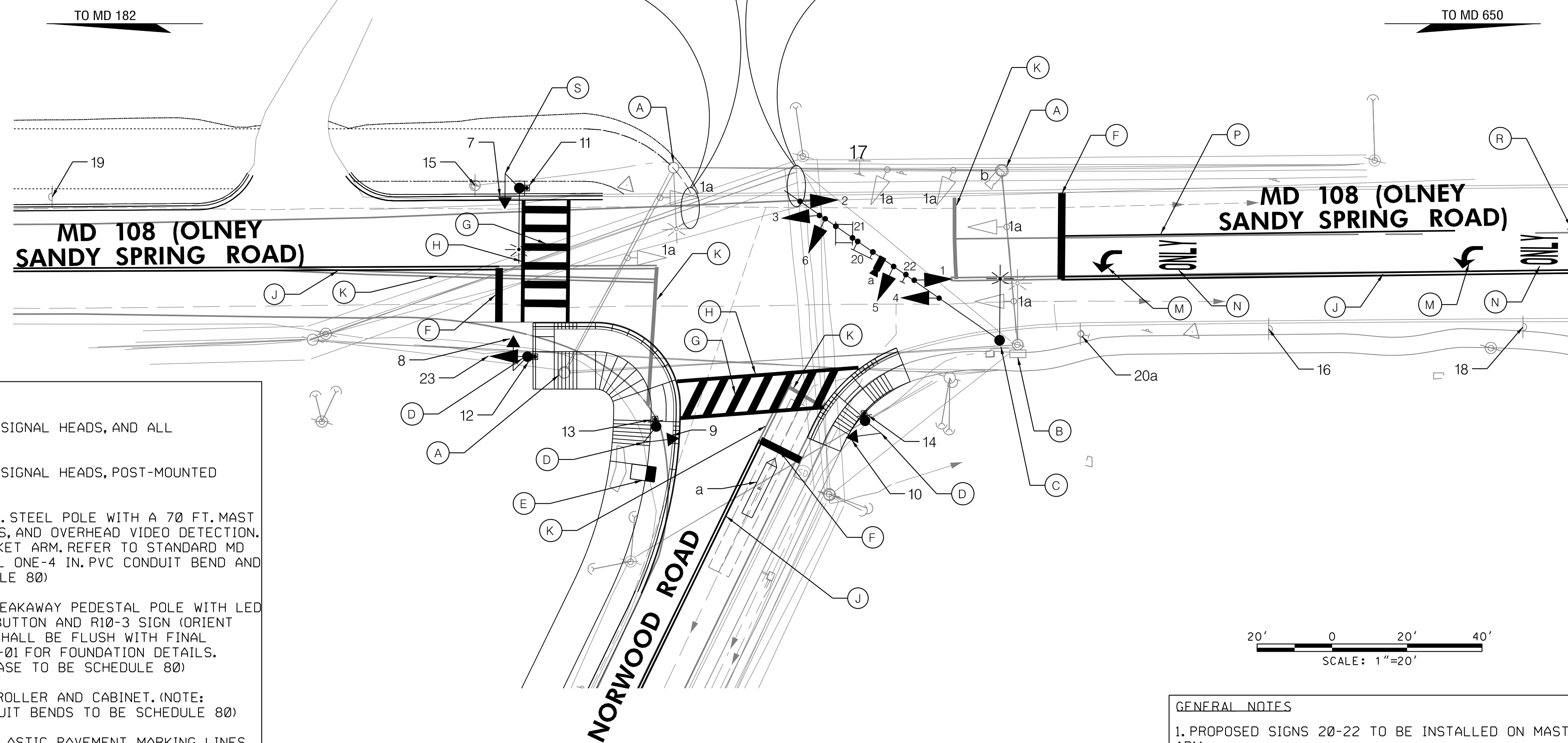
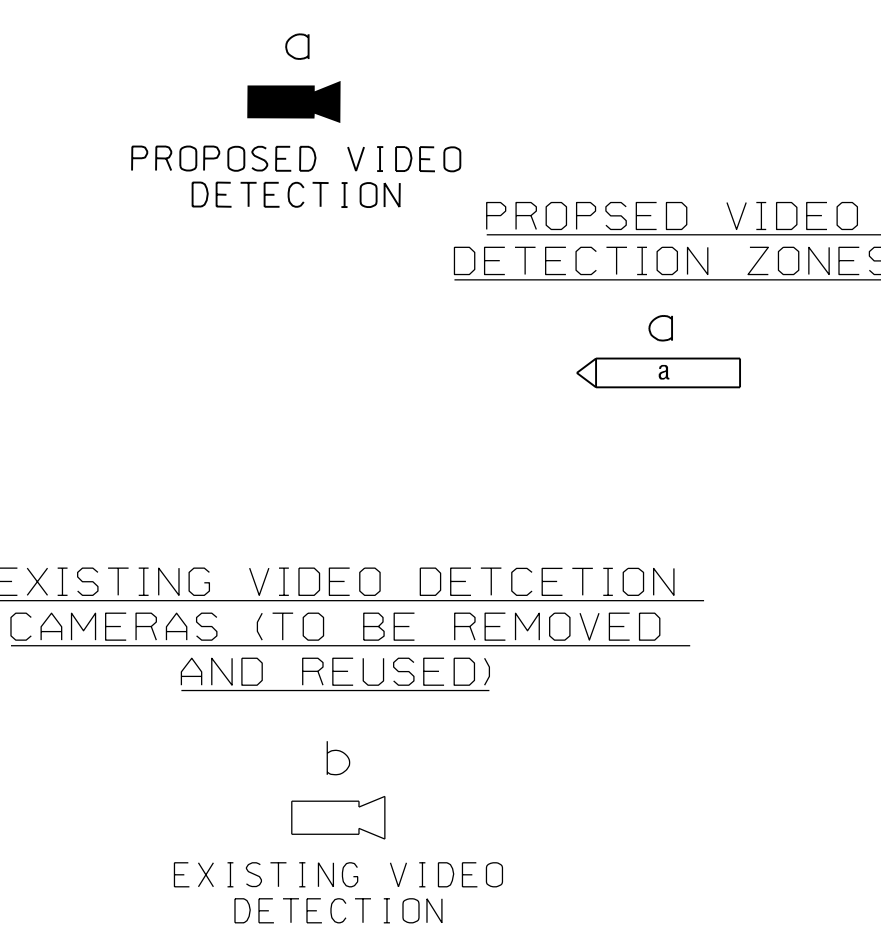

EXISTING SIGNALS TO BE REMOVED

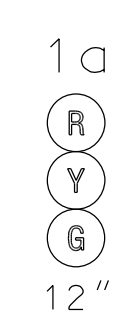

PROPOSED PED SIGNAL HEADS

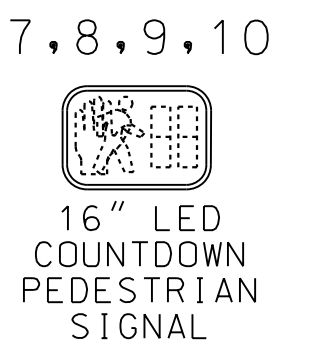

PROPOSED SIGNAL HEADS WITH BACKPLATE

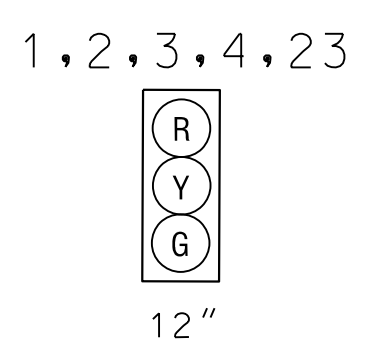

PROPOSED SIGNAL HEADS WITHOUT BACKPLATE

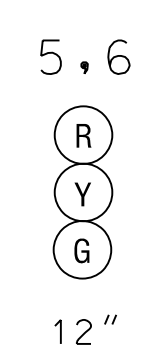

CONSTRUCTION DETAILS

- A. REMOVE STRAIN POLE, FOUNDATION, SPAN WIRE, SIGNAL HEADS, AND ALL ASSOCIATED CABLES
- B. REMOVE STRAIN POLE, FOUNDATION, SPAN WIRE, SIGNAL HEADS, POST-MOUNTED CABINET, AND ALL ASSOCIATED CABLES
- C. INSTALL CONCRETE FOUNDATION WITH A 27 FT. STEEL POLE WITH A 70 FT. MAST ARM WITH SIGNAL HEADS (AND BACKPLATES) SIGNS, AND OVERHEAD VIDEO DETECTION. LED LUMINAIRE TO BE INSTALLED WITH 15' BRACKET ARM. REFER TO STANDARD MD 801.01 FOR INSTALLATION DETAILS. (NOTE: INSTALL ONE-4 IN. PVC CONDUIT BEND AND ONE-2 IN. PVC FOR LIGHTING ARM TO BE SCHEDULE 80)
- D. INSTALL CONCRETE FOUNDATION AND 10 FT. BREAKAWAY PEDESTAL POLE WITH LED COUNTDOWN PEDESTRIAN SIGNAL HEAD, APS PUSHBUTTON AND R10-3 SIGN (ORIENT PARALLEL TO CROSSWALK). TOP OF FOUNDATION SHALL BE FLUSH WITH FINAL SIDEWALK GRADE. REFER TO STANDARD MD 801.01-01 FOR FOUNDATION DETAILS. (NOTE: INSTALL 1-2 IN. CONDUIT BEND IN POLE BASE TO BE SCHEDULE 80)
- E. INSTALL A NEMA SIZE 6 BASE MOUNTED CONTROLLER AND CABINET. (NOTE: INSTALL TWO-4 IN. PVC. AND TWO-2 IN. PVC CONDUIT BENDS TO BE SCHEDULE 80)
- F. INSTALL 24 IN. WHITE HEAT APPLIED THERMOPLASTIC PAVEMENT MARKING LINES (STOP LINE).
- G. INSTALL 24 IN. WHITE HEAT APPLIED THERMOPLASTIC PAVEMENT MARKING LINES (CROSSWALK BARS).
- H. INSTALL 12 IN. WHITE HEAT APPLIED THERMOPLASTIC PAVEMENT MARKING LINES (CROSSWALK).
- J. INSTALL 4 IN. DOUBLE YELLOW HEAT APPLIED THERMOPLASTIC PAVEMENT MARKING FOR CENTERLINE.

- K. REMOVE EXISTING PAVEMENT MARKING LINE.
- M. INSTALL WHITE HEAT APPLIED THERMOPLASTIC LEFT TURN ARROW.
- N. INSTALL WHITE HEAT APPLIED THERMOPLASTIC "ONLY" PAVEMENT MARKING.
- P. INSTALL 6 IN. WHITE HEAT APPLIED THERMOPLASTIC PAVEMENT MARKING.
- R. INSTALL 6 IN. (10'-30' SKIP) WHITE HEAT APPLIED THERMOPLASTIC PAVEMENT MARKING.

- S. INSTALL CONCRETE FOUNDATION WITH 27 FT. MAST ARM POLE WITH LED COUNTDOWN PEDESTRIAN SIGNAL HEAD, APS PUSHBUTTON, R10-3 SIGN (ORIENT PARALLEL TO CROSSWALK), AND LED LUMINAIRE WITH 15 FT. BRACKET ARM. TOP OF FOUNDATION SHALL BE FLUSH WITH FINAL SIDEWALK GRADE. REFER TO STANDARD MD 801.01-01 FOR FOUNDATION DETAILS. (NOTE: INSTALL 1-2 IN. CONDUIT BEND IN POLE BASE AND ONE-2 IN. PVC FOR LIGHTING ARM TO BE SCHEDULE 80)

GENERAL NOTES

1. PROPOSED SIGNS 20-22 TO BE INSTALLED ON MAST ARM.
2. ALL INDICATED SIGNAL HEADS INSTALLED WITH BACKPLATES TO HAVE 5"X8" BORDER.
3. SIGNAL DIMENSIONS TO BE ADDED AT 60% SUBMISSION.
4. NEAR SIDE SIGNAL 23 TO BE INSTALLED ON PEDESTAL POLE FOR EAST BOUND SANDY SPRING APPROACH. REFER TO STANDARD MD-814.04 FOR MOUNTING DETAILS.

30% DELIVERABLE - NOT FOR CONSTRUCTION

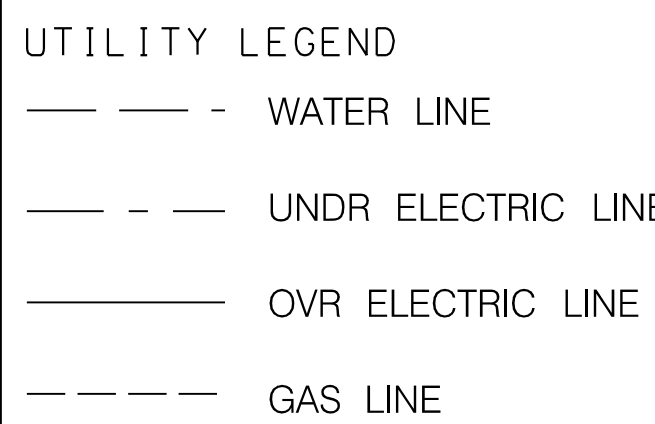

APPROVALS	REVISIONS
TEAM LEADER	REMOVAL OF SPAN WIRE SIGNAL. INSTALLATION OF DIAGONAL MAST ARM SHARED USE PATH INSTALLATION WITH NEW CROSSWALK MARKINGS AND PEDESTRIAN SIGNALS.
ASST. DIV. CHIEF	DESIGN CB DRAWN CB CHK MINJ
DIVISION CHIEF	
OFFICE DIRECTOR	

OFFICE OF TRAFFIC & SAFETY
TRAFFIC ENGINEERING DESIGN DIVISION

STATE HIGHWAY ADMINISTRATION

SANDY SPRING BIKEWAY FACILITY PLANNING
MD 108 (OLNEY SANDY SPRING ROAD)
AT NORWOOD ROAD TRAFFIC SIGNAL

SIGNALIZATION PLAN SHEET			
SCALE 1"=20'	ADVERTISED DATE 4/93	CONTRACT NO. <CONTRACT NO.>	
DESIGNED BY J.F.L. (FOR DCJ)	COUNTY MONTGOMERY		
DRAWN BY B.KENT (FOR DCJ)	LOGMILE <LOGMILE>		
CHECKED BY DOR	TIMS NO. <TIMS NO.>		
MDE/PRD <00-AA-0000>	TOD NO. <TOD NO.>		
TS NO.<TS NO.>	DRAWING SG-01 OF XX	SHEET NO. 6 OF 6	



I HEREBY CERTIFY THAT THESE DOCUMENTS WERE PREPARED OR APPROVED BY ME, AND THAT I AM A DULY LICENSED PROFESSIONAL ENGINEER UNDER THE LAWS OF THE STATE OF MARYLAND.

MD LICENSE NUMBER _____

EXPIRATION DATE _____