



# MONTGOMERY COUNTY EXECUTIVE ORDER

Offices of the County Executive • 101 Monroe Street • Rockville, Maryland 20850

Subject Fire Lane Establishment Order 2115 East Jefferson	Executive Order No. 072-25	Subject Suffix
Originating Department Montgomery County Department of Permitting Services	Department Number MCDPS 9-25	Effective Date 5/21/2025

## Fire Lane Establishment Order

Pursuant to Section 22 - 33, Montgomery County Code, 1971, as amended, you are hereby notified that a Fire Lane has been established as described in this order. You are hereby ordered to post fire lane signs and paint curbs/pavement (painting optional) as identified below. When signs and paint work (painting optional) have been completed, this order will authorize the enforcement of this Fire Lane by appropriate police and fire officials. Compliance with this order must be achieved within 30 days of receipt.

LOCATION: Lyra Dr., Cetus La., Centaurus Pl.

All areas where indicated by signs and paint.

☒ SIGNS - - (See attached diagram for location of sign placement)



\$250 FINE

FIRE LANE

Signs must be posted so that it is not possible to park a vehicle without being in sight of a sign. Signs may be no further apart than 100 feet

(Red letters on white background)

☐ PAINT - - (See attached diagram if painting).

Paint must be traffic yellow with lines of sufficient width to be readily identifiable/readable by motor vehicle operators.

*Pastora Warnick*

06/03/2025

Fire Marshal, Montgomery County Department of Permitting Services



**MONTGOMERY COUNTY FIRE AND RESCUE SERVICE**

Date: 05/16/2025

**Fire Lane Establishment Order**

Pursuant to Section 22-33, Montgomery County Code, 1971, as amended, you are hereby notified that a Fire Lane has been established as described in this order. You are hereby ordered to post fire lane signs and paint curbs/pavement as identified below. When signs or paint work has been completed, this order will authorize the enforcement of this Fire Lane by appropriate police or fire officials. Compliance with this order must be achieved within 30 days of receipt when any of the following conditions are met:

- One or more structures addressed from the subject road are occupied;
- The road or accessway is available for use and at least one building permit for an address on the subject road has been issued; or
- The road or accessway is necessary fire department access.

**LOCATION:** Lyra Drive,  
Cetus Lane, and Centaurus Place

Delineate all areas where indicated by signs and/or paint.

☒ **SIGNS** -- (See attached diagram for location of sign placement)



(Red letters on white background)



Signs must be posted so that it is not possible to park a vehicle without being in sight of a sign. Signs may be no further apart than 100 feet.

☐ **PAINT** -- (See attached diagram when painting is required)

Paint must be traffic yellow with lines of sufficient width to be readily identifiable/readable by motor vehicle operators.

LS1189

Signature of Order Writer/I.D. #

May 19, 2025

Cc: Fire Code Enforcement Section  
Attachment: Fire Lane Diagram

## FIRE LANE ESTABLISHMENT FORM

BUILDING OR SUBDIVISION NAME: 2115 East JeffersonFIRE LANE LOCATION/ADDRESS: Lyra Drive, Cetus Lane, Centaurus Place

See attached drawing for designated fire lanes:

I have received the drawing and instructions for installing the designated fire lanes on property not owned by state or local government.

NAME AND TITLE OF PROPERTY REPRESENTATIVENAME: Greg Ruff TITLE: Director of Land EntitlementSIGNATURE: PHONE: 301.803.4832 DATE: 05/16/2025

ADDRESS (where processed order will be mailed):

Tri Pointe Homes - 12435 Park Potomac Ave, Suite 600 Potomac, MD 20854-----  
The designated fire lanes are the minimum necessary for fire/rescue access and are in accordance with Section 22-33 of the Fire Safety Code.NAME: Marie LaBaw SIGNATURE: STA.#: DPS I.D.#: LS1189 DATE: May 19, 2025

Comments: \_\_\_\_\_

Fire Lane Installed Per Order

NAME: \_\_\_\_\_ DATE: \_\_\_\_\_

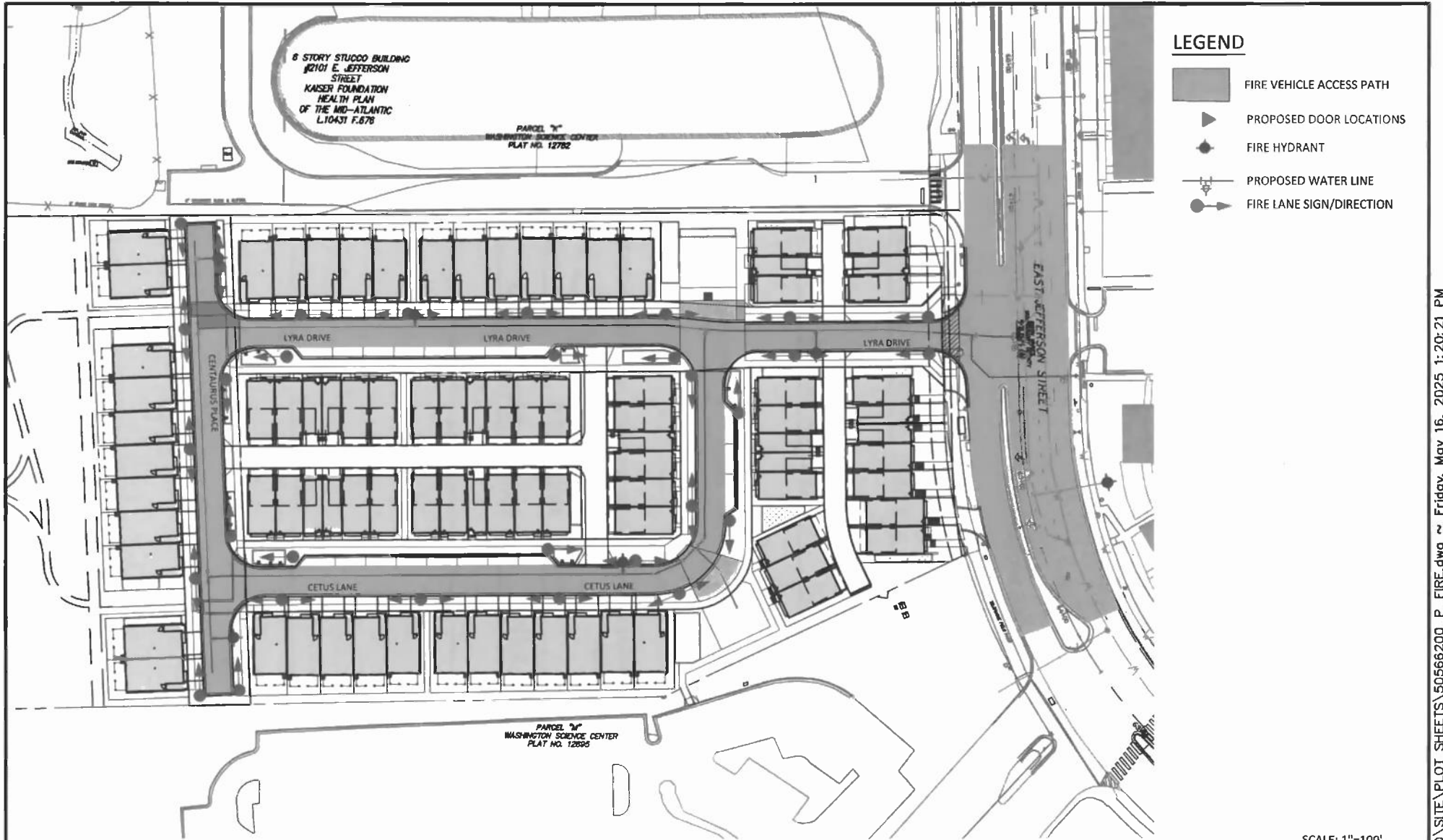

SCALE: 1"=100'

THE INFORMATION, DESIGN AND CONTENT OF THESE DRAWINGS OR DOCUMENTS ARE PROPRIETARY TO VIKA MARYLAND, LLC AND CONSTITUTE ITS PROPRIETARY INTELLECTUAL PROPERTY. THESE DRAWINGS AND/OR DOCUMENTS MUST NOT BE FORWARDED, SHARED, COPIED, DIGITALLY CONVERTED, MODIFIED OR USED FOR ANY PURPOSE, IN ANY FORMAT, WITHOUT PRIOR WRITTEN AUTHORIZATION FROM VIKA MARYLAND, LLC. VIOLATIONS MAY RESULT IN PROSECUTION. ONLY APPROVED, SIGNED AND SEALED PLANS OR DRAWINGS MAY BE UTILIZED FOR CONSTRUCTION PURPOSES. © 2019 VIKA MARYLAND, LLC

**2115 EAST JEFFERSON**  
7TH ELECTION DISTRICT  
LOCATION, MARYLAND  
WSSC GRID: 215NW06 TAX MAP: GQ56

## FIRE LANE ESTABLISHMENT ORDER



**VIKA MARYLAND, LLC**  
20251 Century Blvd., Suite 400  
Germantown, MD 20874  
301.916.4100 | [vika.com](http://vika.com)

*Our Site Set on the Future.*

DRAWN BY:	
DESIGNED BY:	
DATE ISSUED:	
PROJECT No.	VM50566C
SHEET No.	1 OF 4

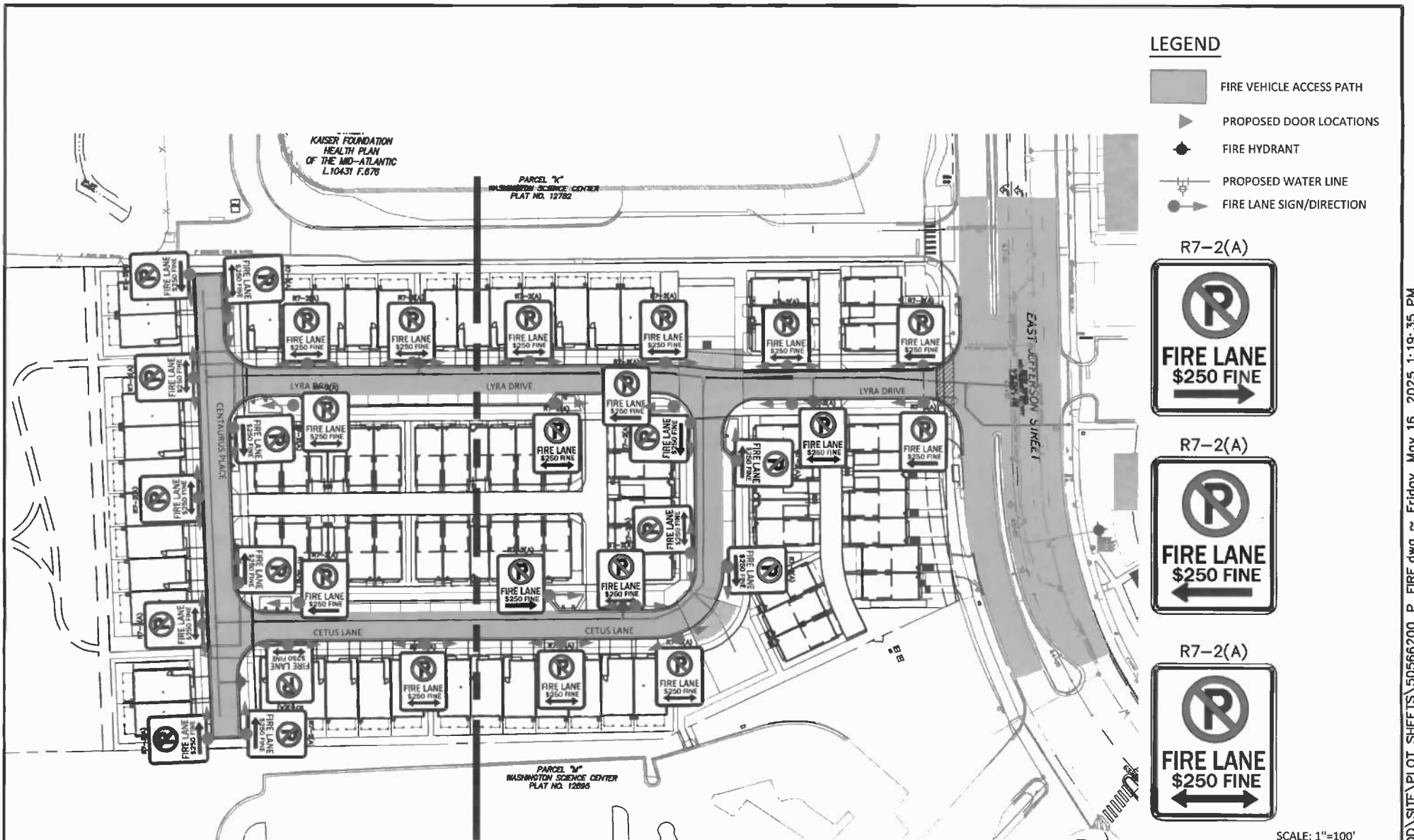

THE INFORMATION, DESIGN AND CONTENT OF THESE DRAWINGS OR DOCUMENTS ARE PROPRIETARY TO VIKA MARYLAND, LLC AND CONSTITUTE ITS PROPRIETARY INTELLECTUAL PROPERTY. THESE DRAWINGS AND/OR DOCUMENTS MUST NOT BE FORWARDED, SHARED, COPIED, DIGITALLY CONVERTED, MODIFIED OR USED FOR ANY PURPOSE, IN ANY FORMAT, WITHOUT PRIOR WRITTEN AUTHORIZATION FROM VIKA MARYLAND, LLC. VIOLATIONS MAY RESULT IN PROSECUTION. ONLY APPROVED, SIGNED AND SEALED PLANS OR DRAWINGS MAY BE UTILIZED FOR CONSTRUCTION PURPOSES. © 2019 VIKA MARYLAND, LLC

2115 EAST JEFFERSON  
7TH ELECTION DISTRICT  
LOCATION, MARYLAND  
WSSC GRID: 215NW06 TAX MAP: GQ56

FIRE LANE  
ESTABLISHMENT ORDER



VIKA MARYLAND, LLC  
20251 Century Blvd., Suite 400  
Germantown, MD 20874  
301.916.4100 | vika.com

Our Site Set on the Future.

DRAWN BY: \_\_\_\_\_  
DESIGNED BY: \_\_\_\_\_  
DATE ISSUED: \_\_\_\_\_  
PROJECT No. VM50566C  
SHEET No. 2 OF 4

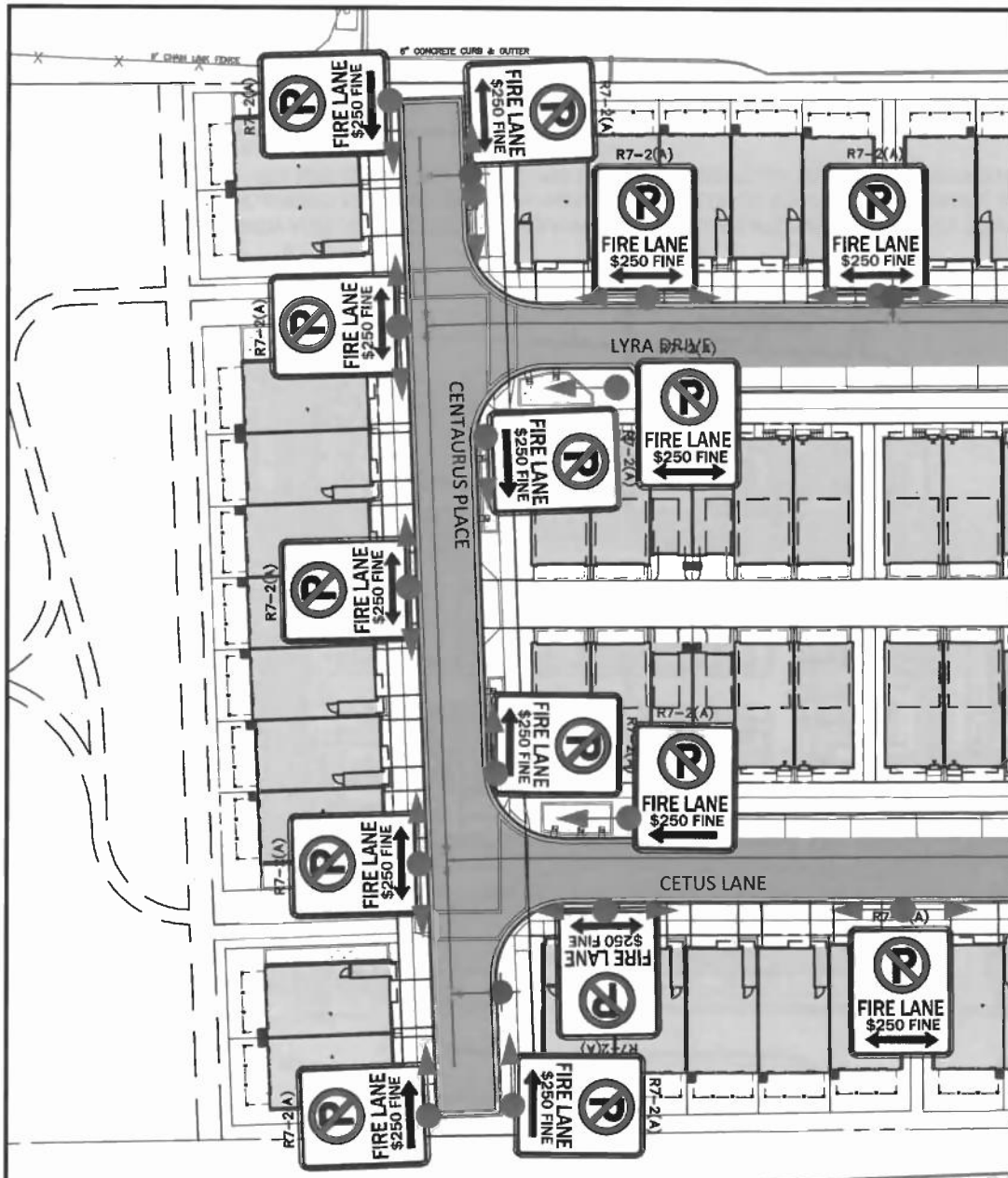

# LEGEND

- FIRE VEHICLE ACCESS PATH
- PROPOSED DOOR LOCATIONS
- FIRE HYDRANT
- PROPOSED WATER LINE
- FIRE LANE SIGN/DIRECTION



SCALE: 1"=60'

2115 EAST JEFFERSON  
7TH ELECTION DISTRICT  
LOCATION, MARYLAND  
WSSC GRID: 215NW06 TAX MAP:GQ56

## FIRE LANE ESTABLISHMENT ORDER



VIKA MARYLAND, LLC  
20251 Century Blvd., Suite 400  
Germantown, MD 20874  
301.916.4100 | [vika.com](http://vika.com)

*Our Site Set on the Future.*

DRAWN BY:	
DESIGNED BY:	
DATE ISSUED:	
PROJECT No.	VM50566C
SHEET No.	3 OF 4

