



# MONTGOMERY COUNTY EXECUTIVE ORDER

Offices of the County Executive • 101 Monroe Street • Rockville, Maryland 20850

Subject Fire Lane Establishment Order Laytonsville Veterinary Practice	Executive Order No. 095-24	Subject Suffix
Originating Department Montgomery County Department of Permitting Services	Department Number MCDPS 9-24	Effective Date 6/12/2024

### Fire Lane Establishment Order

Pursuant to Section 22 - 33, Montgomery County Code, 1971, as amended, you are hereby notified that a Fire Lane has been established as described in this order. You are hereby ordered to post fire lane signs and paint curbs/pavement (painting optional) as identified below. When signs and paint work (painting optional) have been completed, this order will authorize the enforcement of this Fire Lane by appropriate police and fire officials. Compliance with this order must be achieved within 30 days of receipt.

LOCATION: 5910 Sundown Road  
\_\_\_\_\_  
\_\_\_\_\_

All areas where indicated by signs and paint.

SIGNS - - (See attached diagram for location of sign placement)



\$250 FINE  
FIRE LANE

Signs must be posted so that it is not possible to park a vehicle without being in sight of a sign. Signs may be no further apart than 100 feet

(Red letters on white background)

PAINT - - (See attached diagram if painting).

Paint must be traffic yellow with lines of sufficient width to be readily identifiable/readable by motor vehicle operators.

*Richard E. Merck*

Fire Marshal, Montgomery County Department of Permitting Services



MONTGOMERY COUNTY FIRE AND RESCUE SERVICE

Date: 06-10-24

Fire Lane Establishment Order

Pursuant to Section 22-33, Montgomery County Code, 1971, as amended, you are hereby notified that a Fire Lane has been established as described in this order. You are hereby ordered to post fire lane signs and paint curbs/pavement as identified below. When signs or paint work has been completed, this order will authorize the enforcement of this Fire Lane by appropriate police or fire officials. Compliance with this order must be achieved within 30 days of receipt when any of the following conditions are met:

- One or more structures addressed from the subject road are occupied;
- The road or accessway is available for use and at least one building permit for an address on the subject road has been issued; or
- The road or accessway is necessary fire department access.

LOCATION: Laytonsville Veterinary Practice,  
5910 Sundown Rd, Laytonsville, MD 20882

Delineate all areas where indicated by signs and/or paint.

SIGNS -- (See attached diagram for location of sign placement)



(Red letters on white background)

Signs must be posted so that it is not possible to park a vehicle without being in sight of a sign. Signs may be no further apart than 100 feet.

PAINT -- (See attached diagram when painting is required)

Paint must be traffic yellow with lines of sufficient width to be readily identifiable/readable by motor vehicle operators.

LS1189

Signature of Order Writer/I.D. #

June 11, 2024

Cc: Fire Code Enforcement Section  
Attachment: Fire Lane Diagram

FIRE LANE ESTABLISHMENT FORM

BUILDING OR SUBDIVISION NAME: Fairhill - Lot 33, Bl. A.

FIRE LANE LOCATION/ADDRESS: Laytonsville Veterinary Practice  
at 5910 Sundown Rd, Laytonsville, MD, 20882

See attached drawing for designated fire lanes:

I have received the drawing and instructions for installing the designated fire lanes on property not owned by state or local government.

NAME AND TITLE OF PROPERTY REPRESENTATIVE

NAME: Pete Godwin TITLE: Owner

SIGNATURE: *Pete Godwin*

PHONE: (301) 351-6686 DATE: 06-10-24

ADDRESS (where processed order will be mailed):

5910 Sundown Rd, Laytonsville, MD 20882

The designated fire lanes are the minimum necessary for fire/rescue access and are in accordance with Section 22-33 of the Fire Safety Code.

NAME: Marie LaBaw SIGNATURE: *[Signature]*

STA.#: DPS I.D.#: LS1189 DATE: June 11, 2024

Comments: \_\_\_\_\_

Fire Lane Installed Per Order

NAME: \_\_\_\_\_ DATE: \_\_\_\_\_

SUNDOWN ROAD

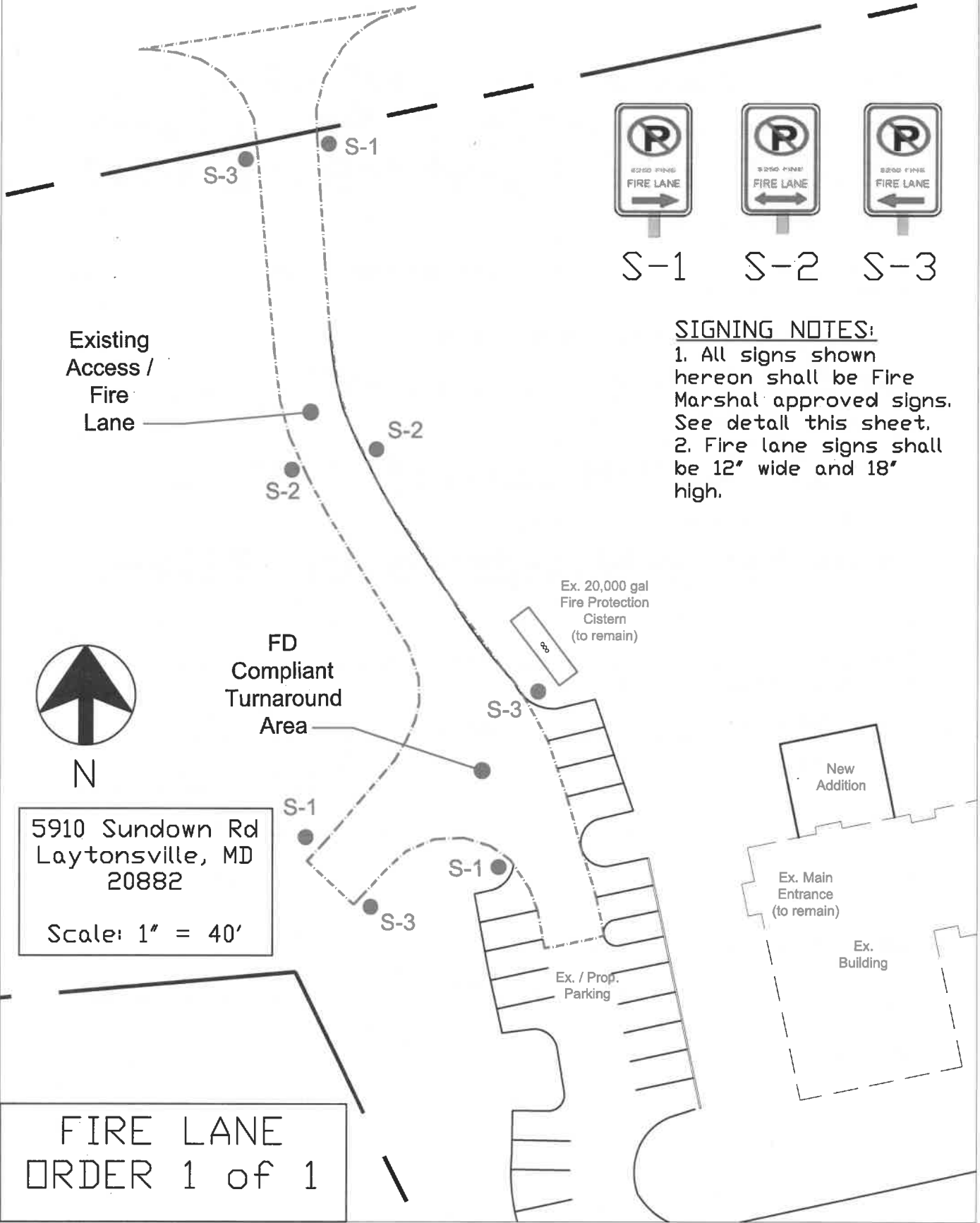

**SIGNING NOTES:**  
1. All signs shown hereon shall be Fire Marshal approved signs. See detail this sheet.  
2. Fire lane signs shall be 12" wide and 18" high.



5910 Sundown Rd  
Laytonsville, MD  
20882  
Scale: 1" = 40'

FIRE LANE  
ORDER 1 of 1

Ex. 20,000 gal  
Fire Protection  
Cistern  
(to remain)

New  
Addition  
Ex. Main  
Entrance  
(to remain)  
Ex.  
Building

Ex. / Prop.  
Parking