



MONTGOMERY COUNTY EXECUTIVE ORDER

Offices of the County Executive • 101 Monroe Street • Rockville, Maryland 20850

Subject Fire Lane Establishment Order John F. Kennedy High School	Executive Order No. 12-20	Subject Suffix
Originating Department Montgomery County Department of Permitting Services	Department Number MCDPS 1-20	Effective Date 1/15/2020

Fire Lane Establishment Order

Pursuant to Section 22 - 33, Montgomery County Code, 1971, as amended, you are hereby notified that a Fire Lane has been established as described in this order. You are hereby ordered to post fire lane signs and paint curbs/pavement (painting optional) as identified below. When signs and paint work (painting optional) have been completed, this order will authorize the enforcement of this Fire Lane by appropriate police and fire officials. Compliance with this order must be achieved within 30 days of receipt.

LOCATION: 1901 Randolph Rd.

All areas where indicated by signs and paint.

SIGNS -- (See attached diagram for location of sign placement)



\$250 FINE

FIRE LANE

Signs must be posted so that it is not possible to park a vehicle without being in sight of a sign. Signs may be no further apart than 100 feet

(Red letters on white background)

PAINT -- (See attached diagram if painting).

Paint must be traffic yellow with lines of sufficient width to be readily identifiable/readable by motor vehicle operators.



Fire Marshal, Montgomery County Department of Permitting Services

SCALE: 1" = 50'

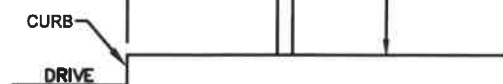
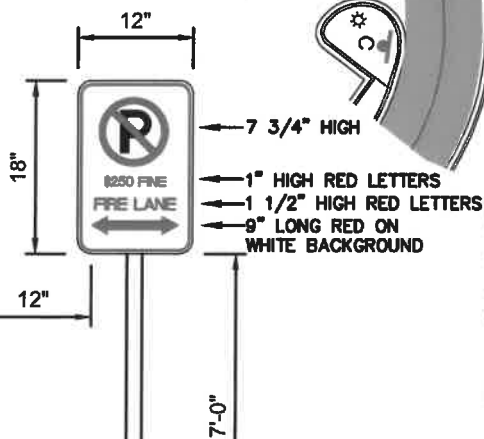
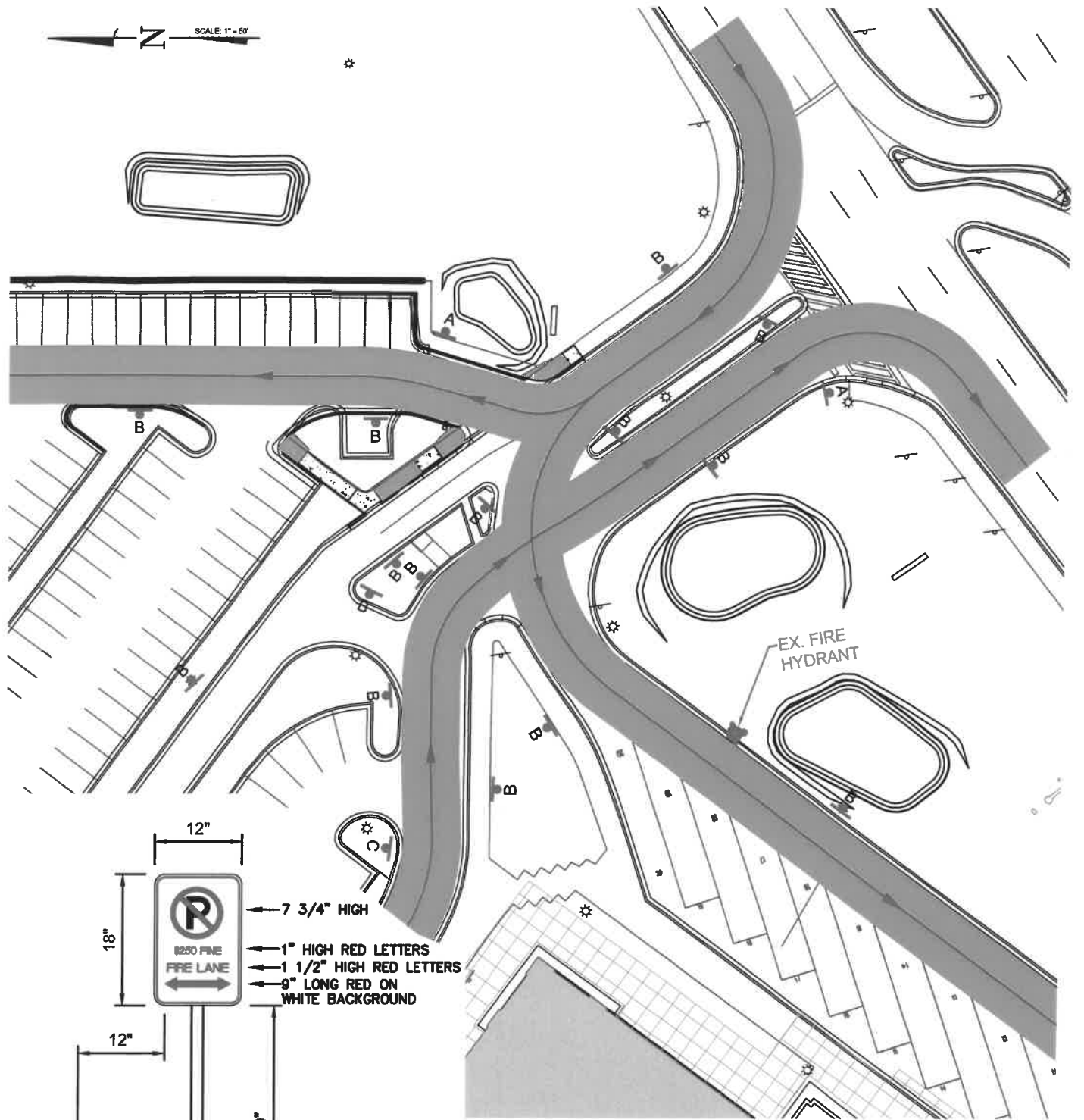

FIRE SIGN DETAIL

N.T.S.



SIGN A



SIGN B



SIGN C



MHG

Civil Engineers
Land Planners
Landscape Architects
Land Surveyors
www.mhgpa.com

FIRE LANE SIGNAGE PLAN
JOHN F. KENNEDY HIGH SCHOOL
1901 RANDOLPH RD., SILVER SPRING, MD 20902
MONTGOMERY COUNTY, MARYLAND

SHEET 1 OF 5

SCALE 1" = 50'
DATE 01.03.2020
JOB NO. 95.378.21

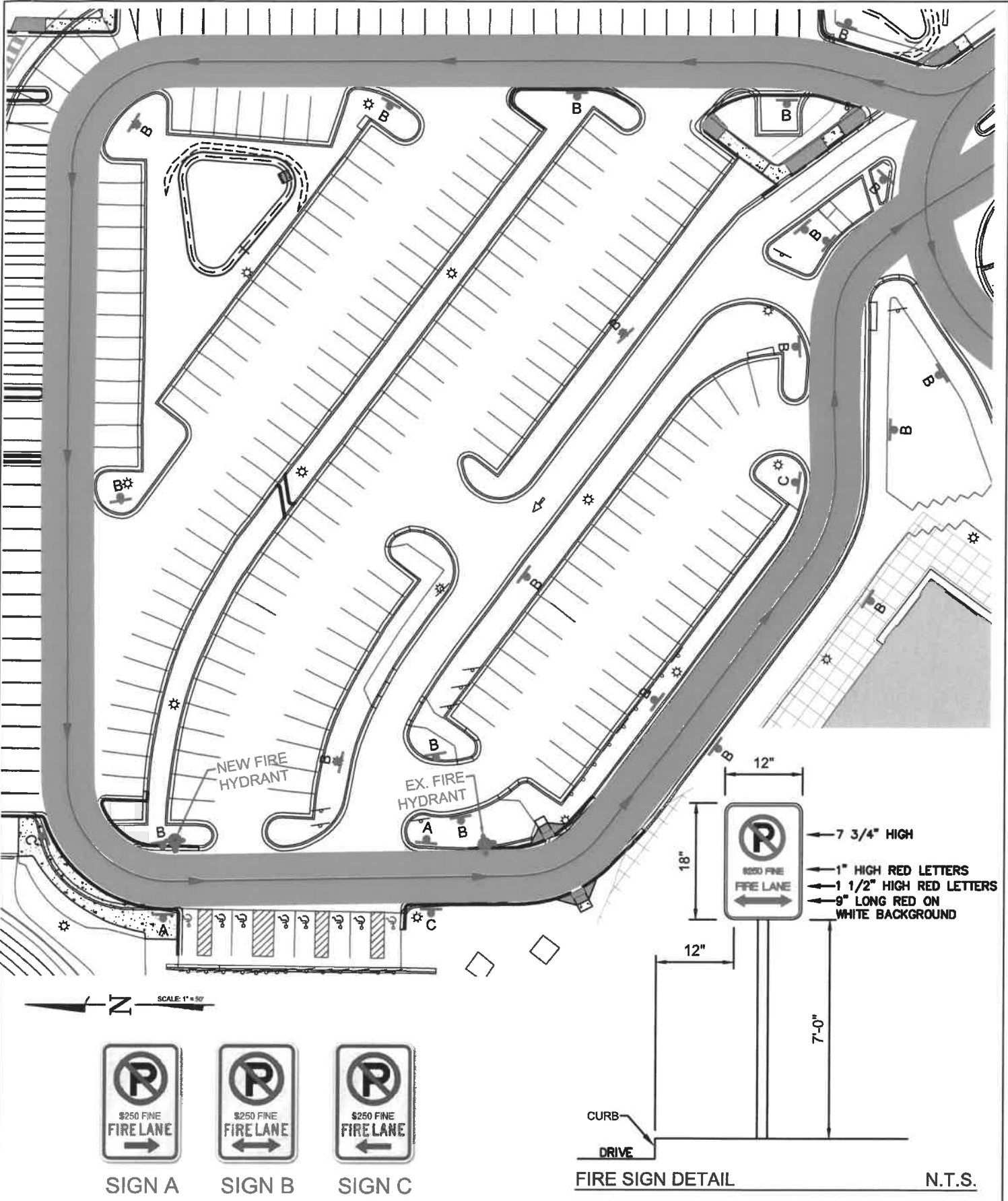

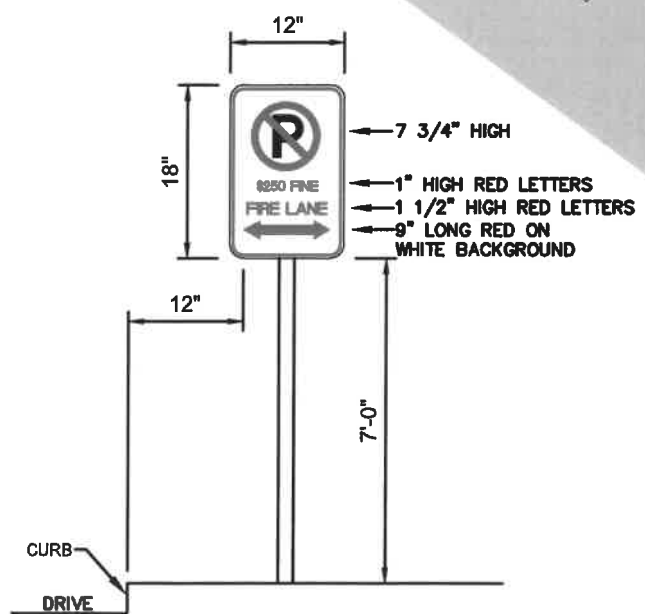
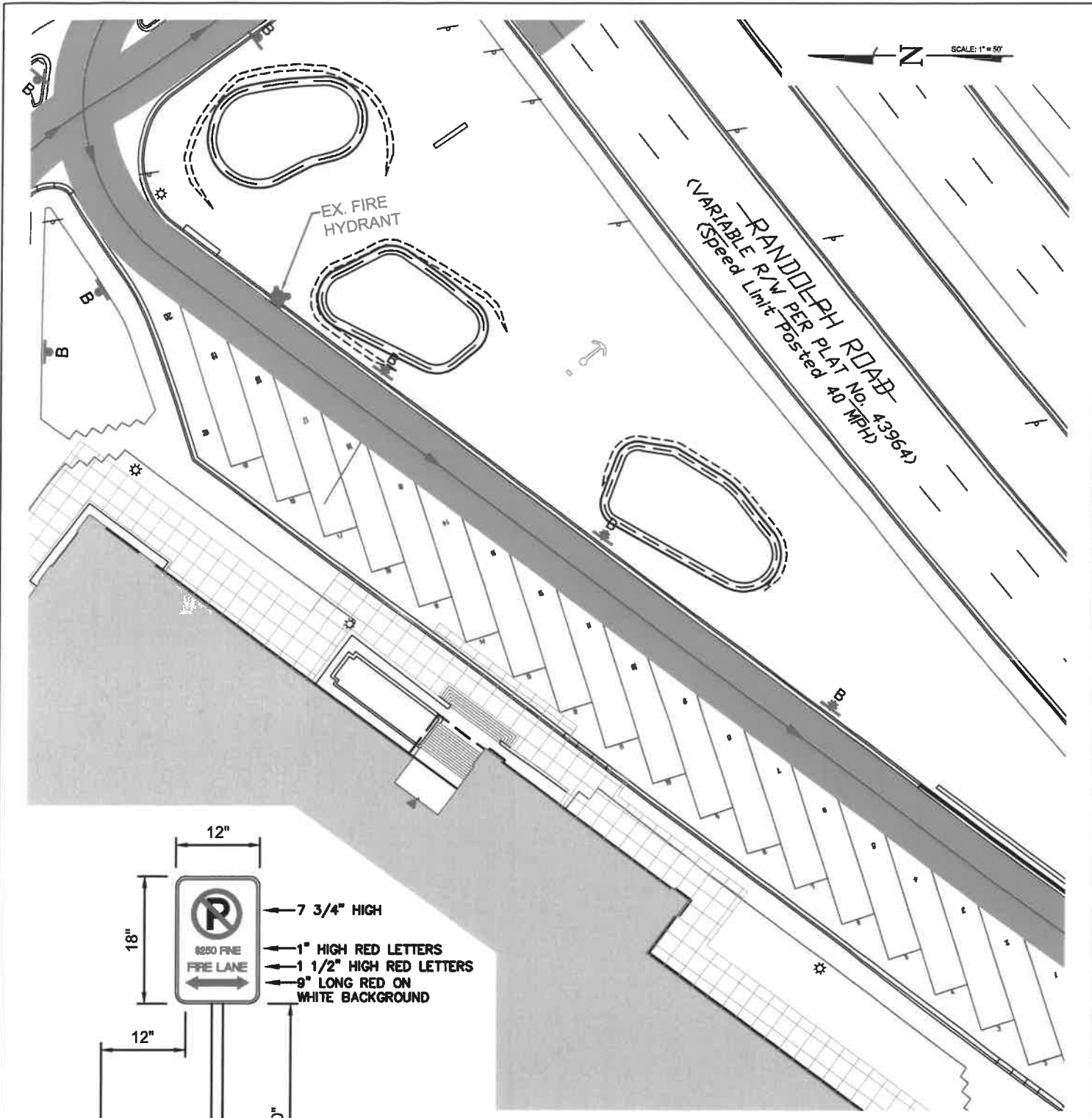

FIRE SIGN DETAIL N.T.S.



SIGN A



SIGN B



SIGN C

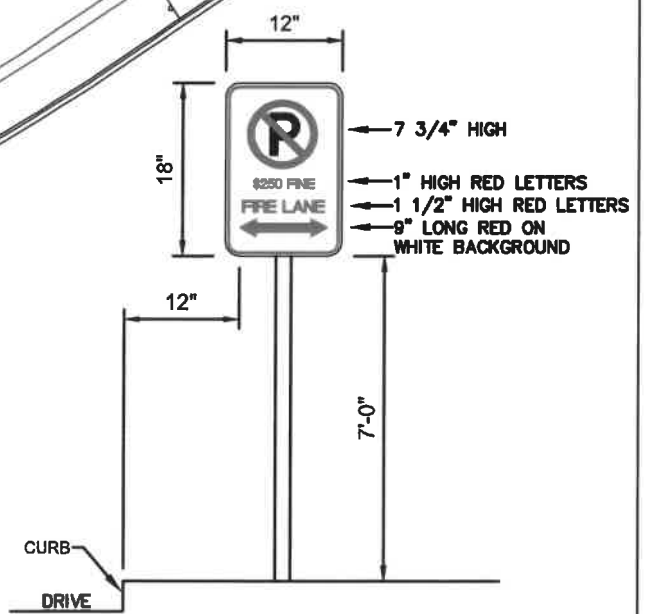
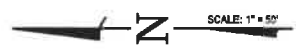
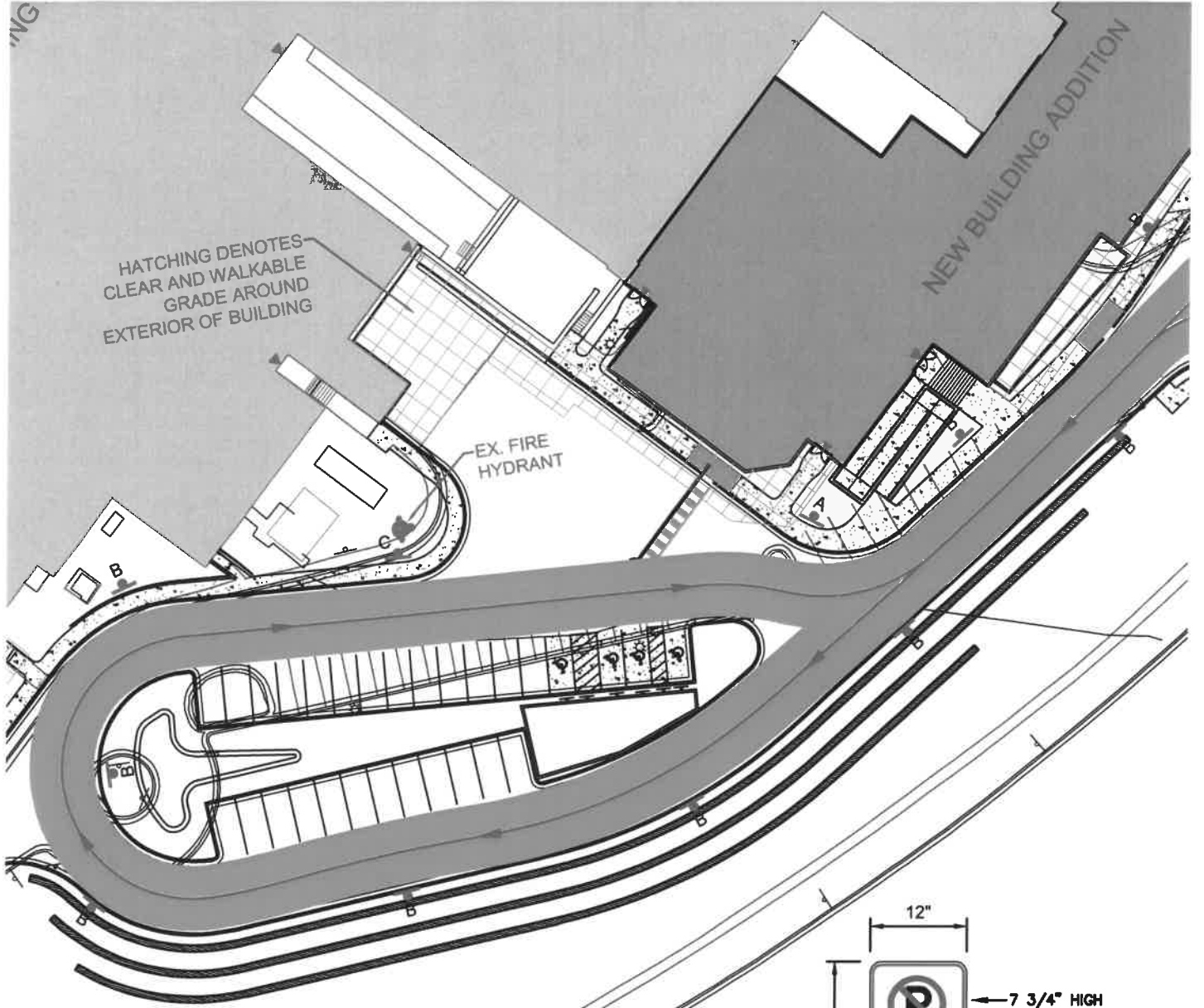

SIGN A

SIGN B

SIGN C

FIRE SIGN DETAIL

N.T.S.



Civil Engineers
Land Planners
Landscape Architects
Land Surveyors
www.mhgpa.com

FIRE LANE SIGNAGE PLAN
JOHN F. KENNEDY HIGH SCHOOL
1901 RANDOLPH RD., WHEATON, MD 20902
MONTGOMERY COUNTY, MARYLAND

SHEET 5 OF 5

SCALE 1" = 50'
DATE 01.03.2020
JOB NO. 95.378.21